

# Work Completion Report

Contractor: US HYDRO

## JOB DETAILS

Job Name	Month/Season	Completed By	Completion Date
BURCHFIELD 24-20, HSR-B/R D 8-20 (2025 Seasonal)	Spring	USHydro Reclaim1	6/13/2025

Work Summary	Reclamation Type	Land Use
Interseeded well head, access road, and tank battery Removed thistle at well head	Final Maint	Pasture

One-Call Number	Red Zone Rep	Red Zone Date

## WORK TASK

Task Name	Priority	COGCC Compliance	Task Location and Notes/Instructions
Final Reclamation Maintenance		No	Location(s): HSR-BR D 8-20; BURCHFIELD 24-20 Notes: May include innerseeding, mowing, spraying, debris clean-up. If locates and red zone are required, please notify Oxy to modify job assignment and schedule on-site meeting. If the location does not need work completed, please complete a work completion report. If location is ready for Form 4, please complete inspection and add Form 4 work task

## COMPLETION DETAILS

<p>Total Area Affected: <b>87,120 sq ft</b></p> <p>Seed Mix: <b>Dryland Pasture (30.00 lbs)</b></p> <p>Crop Type:</p> <p>Soil Type: <b>Clay Loam</b></p> <p>Stabilization Date:</p> <p>Seeding Date: <b>6/13/2025</b></p> <p>Mulch: <b>None</b></p> <p>Straw Bales: <b>NA</b></p> <p>Soil Amendment Type: <b>None</b></p> <p>Soil Amendment Rate: <b>NA</b></p> <p>Imported Top Soil: <b>NA</b></p> <p>Top Soil Source: <b>NA</b></p> <p>General Notes:</p>
---

### Description:

### Dryland Main

Noxious Weed: NONE FOUND

Coverage: 16.762 Bulk #

By acceptance of the seed, Buyer agrees the terms and conditions stated above are a benefit to the bargain and agreement between Buyer and the labeled seller. Buyer shall return the original unopened seed package to the seller within twenty days of receipt for a refund of the purchase price if not accepted under these terms.

Photo Name: Pre-Completion

Description:

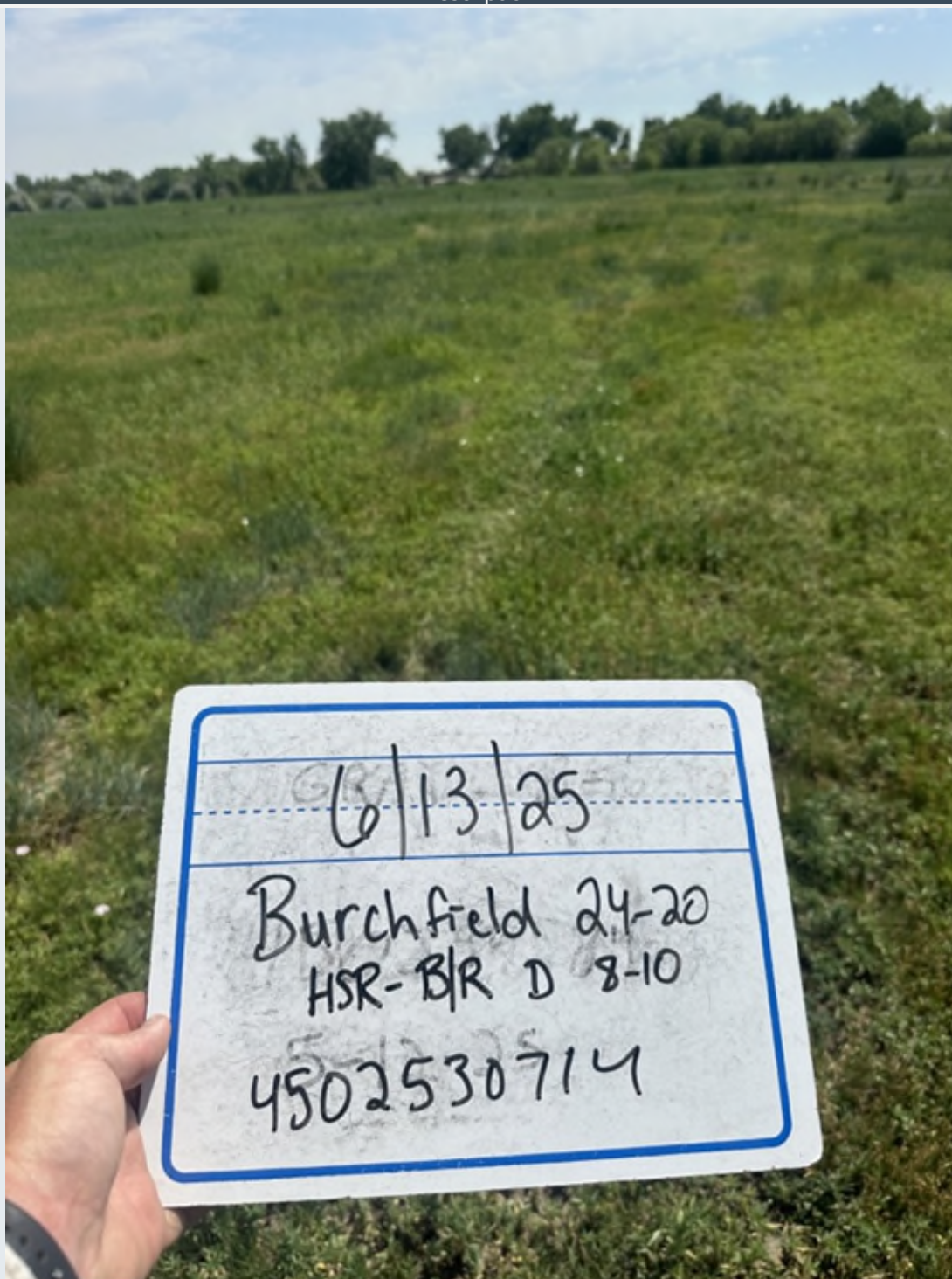



Photo Name: Post-Completion

Description:

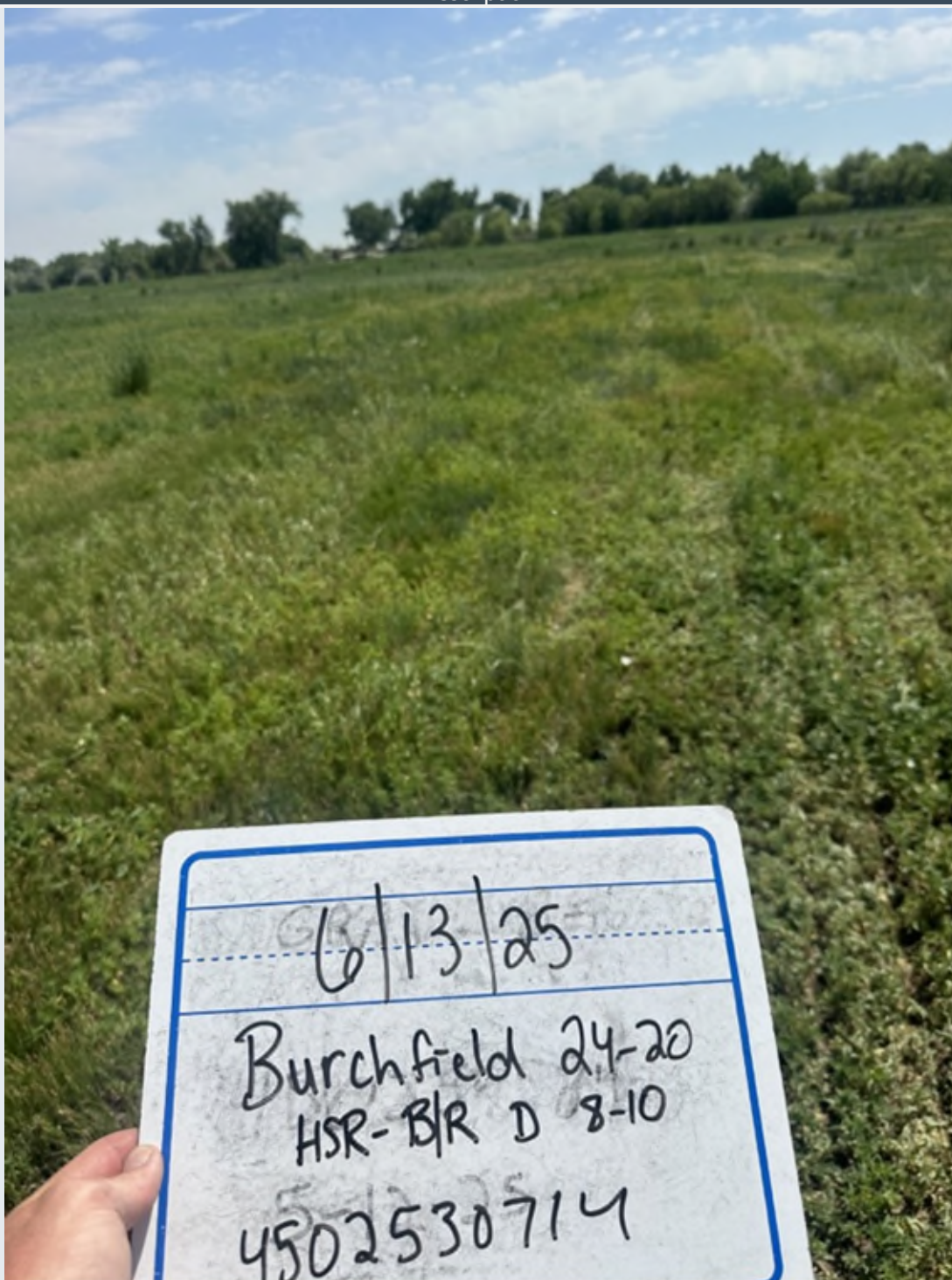

Photo Name: Interseeding well head

Description:





Photo Name: Before access road  
Description:

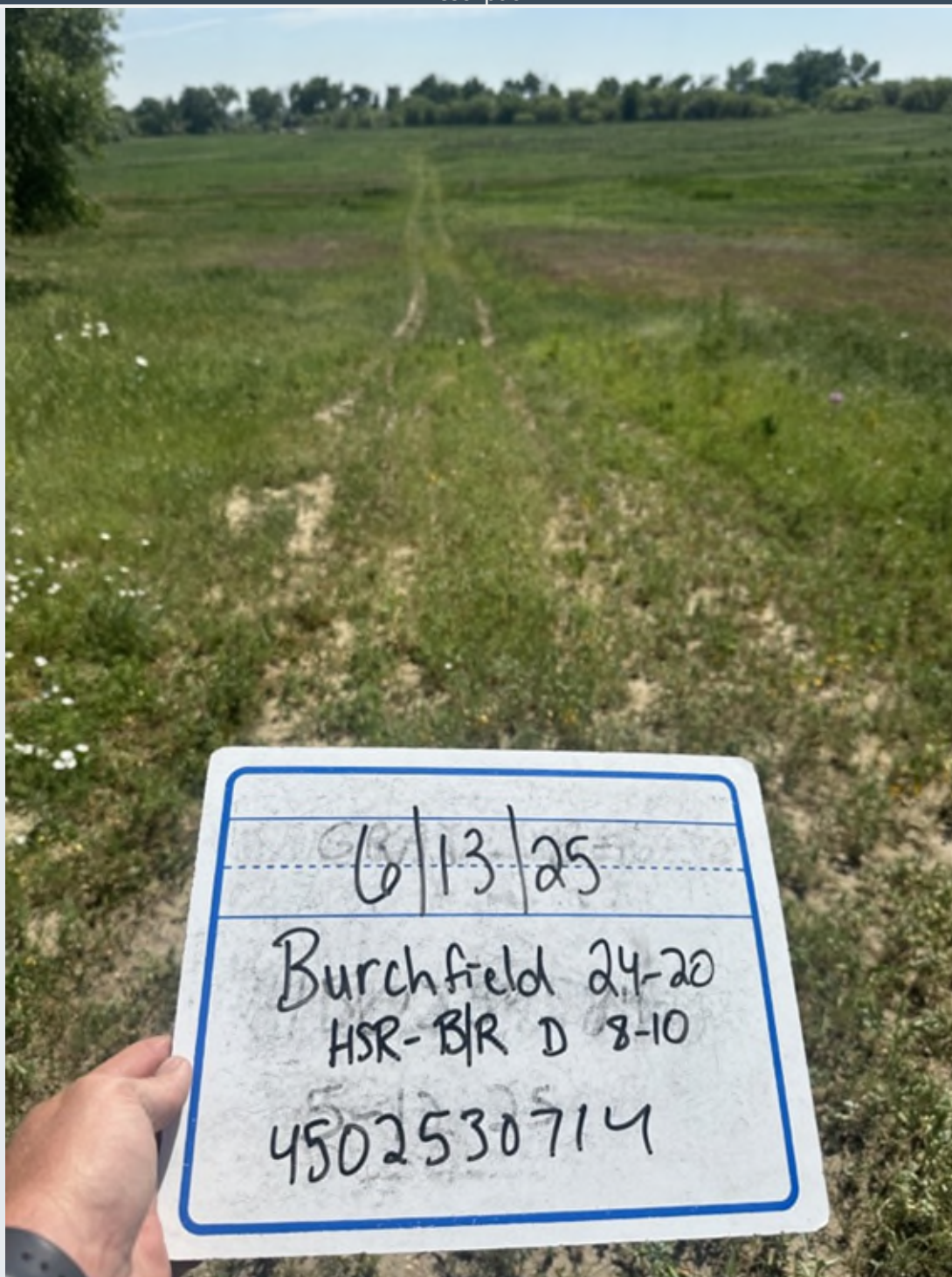

Photo Name: Interseeding access road  
Description:





Photo Name: After access road  
Description:





Photo Name: Before tank battery  
Description:

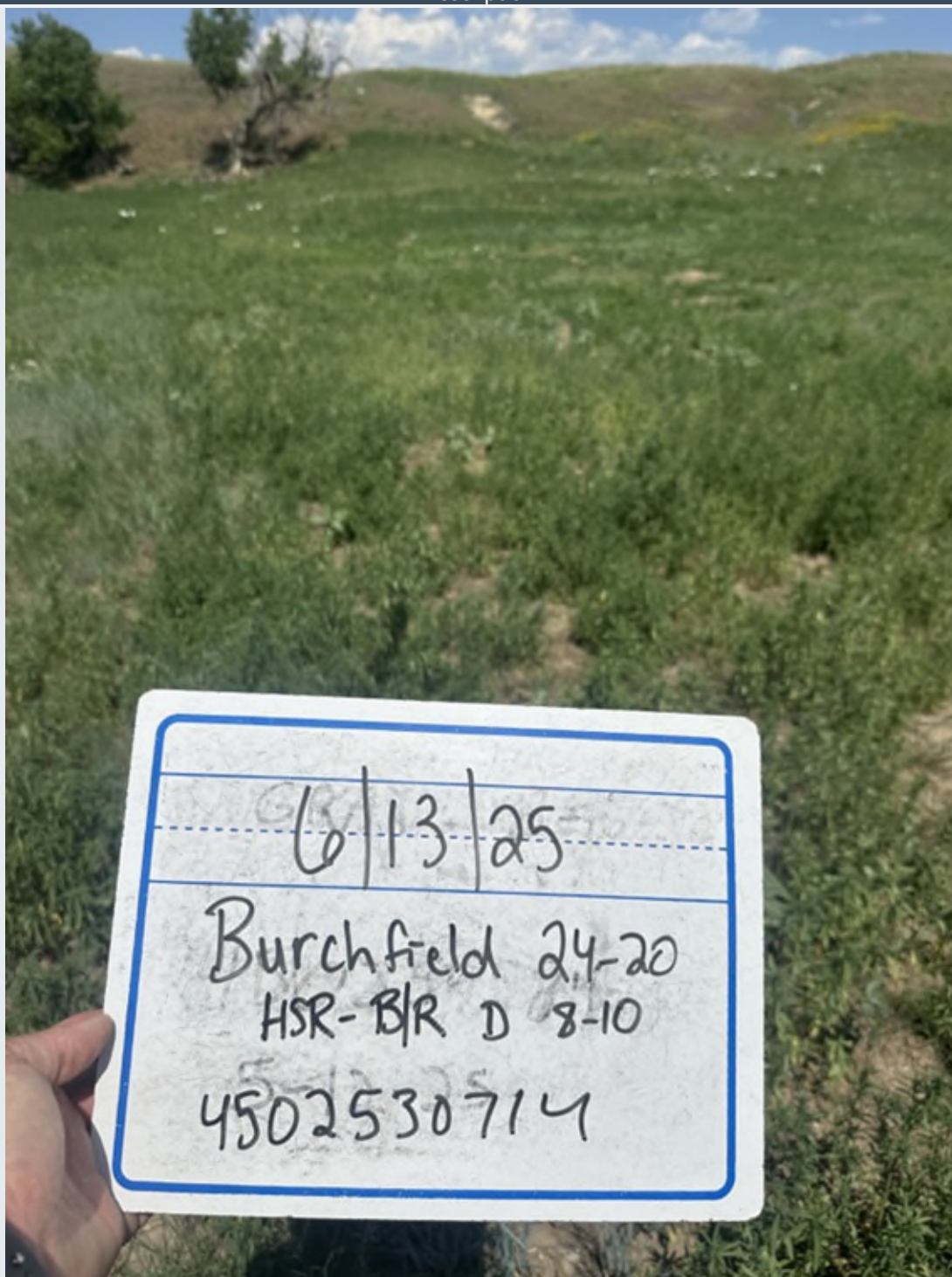

Photo Name: Interseeding tank battery  
Description:





Photo Name: After tank battery

Description:

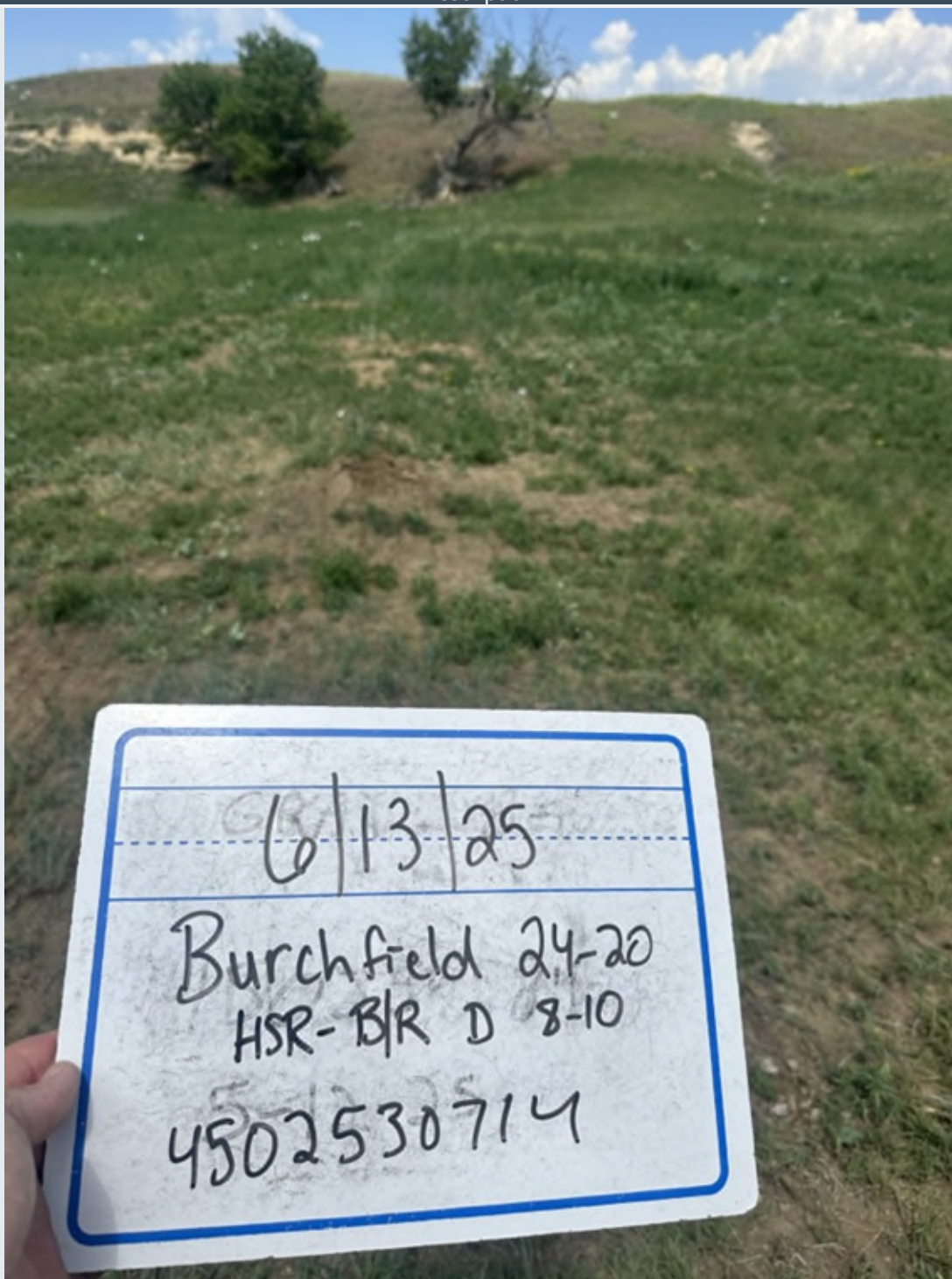

Photo Name: Removed thistle on well head

Description:

