



RECEIVED

JUN 19 1975

R. 64W

COLO. OIL & GAS CONS. COMM.



T.  
3  
S

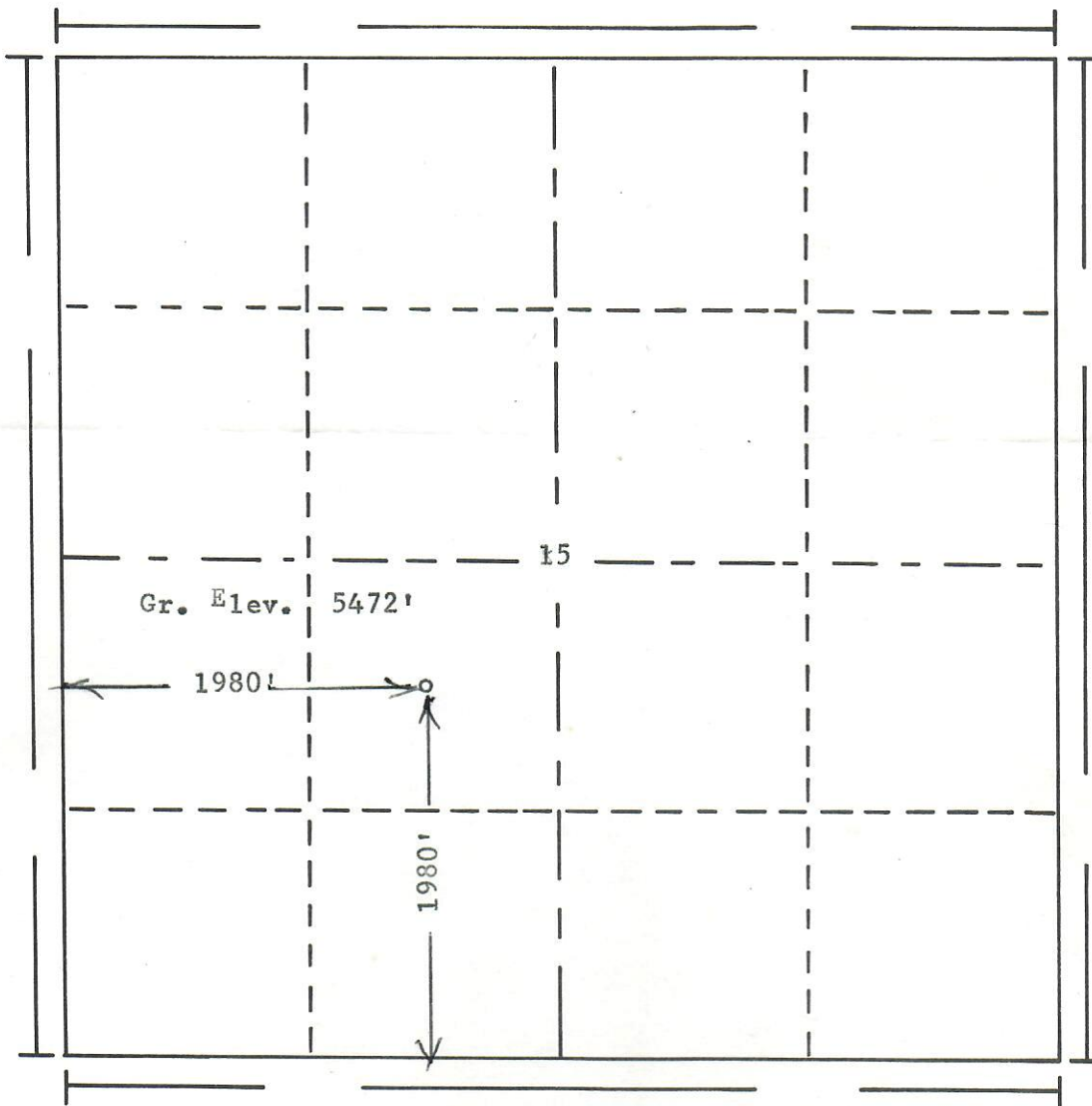

**Scale...** 1" = 1000'

**Powers Elevation Company, Inc. of Denver, Colorado**  
has in accordance with a request from Michelle  
for Summit Oil Co.  
determined the location of No. 1 Piland "A"  
to be CNE SW Section 15 Township 38  
Range 64W of the 6th Principal Meridian  
Adams County, Colorado

I hereby certify that this plat is an accurate representation of a correct survey showing the location of

Date: 6-10-75

Licensed Land Surveyor No. 2853  
State of Colorado