



FORM F-106



00385537

RECEIVED

OCT 5 1976

COLO. OIL &amp; GAS CONS. COM.

N

R. 64W

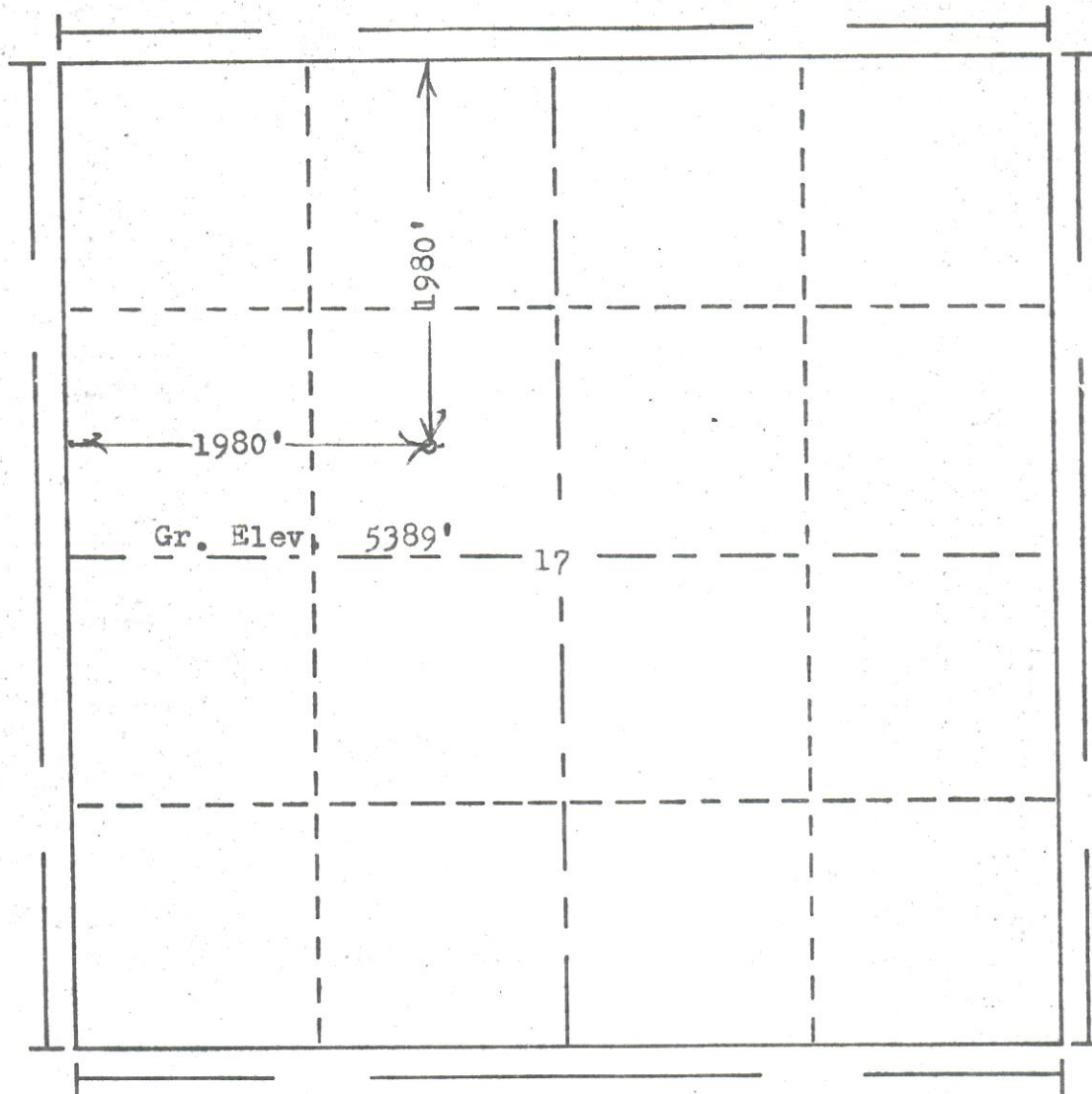

T. 3S

Scale... 1" = 1000'

Powers Elevation Company, Inc. of Denver, Colorado  
has in accordance with a request from Mr. Nichols  
for The Grayrock Corp.

determined the location of No. 1 Steele  
to be CSE NW Section 17 Township 3S  
Range 64W of the 6th Principal Meridian  
Adams County, Colorado

I hereby certify that this plat is an  
accurate representation of a correct  
survey showing the location of

Date: 9-21-76

Richard H. Holladay  
Licensed Land Surveyor No. 2853  
State of Colorado