



STATE OF
COLORADO

Focht - DNR, Sierra <sierra.focht@state.co.us>

Omimex Emergency Plugging Forms

5 messages

Abrams - DNR, Deborah <deborah.abrams@state.co.us>

Fri, Mar 28, 2025 at 10:05 AM

To: Andrew Newman - DNR <andrew.newman@state.co.us>, Brandon Marette - DNR <brandon.marette@state.co.us>

Cc: Sierra Focht - DNR <sierra.focht@state.co.us>, Mike Hickey - DNR <michael.hickey@state.co.us>

Good morning Andrew & Brandon,

OWP has a list of Omimex wells that require Emergency Plugging due to the high risk of an uncontrolled release. ECMC's LAS group has asked that we consult with CPW, based on the proximity to a Greater Prairie Chicken Production Area HPH, and the BLEDSOE 1-24-5-45 being within a Greater Prairie Chicken Lek Sites HPH.

We intend to rig up on the first well Monday, and proceed with the list in this order. Please let me know if you have any questions.

Well Name	API #	F6 NOI Doc #
FERGUSON 13-9-5-45	125-10722	404144130
FERGUSON 10-9-5-45	125-02376	404144145
FERGUSON 7-9-5-45	125-09364	404144155
BENNETT-STATE 9-16-5-45	125-09728	404144116
BLEDSOE 1-24-5-45	125-09495	404144168
BOWMAN 13-35-5-44	125-09569	404144178
BOWMAN 14-35-5-44	125-09570	404144183
ROYAL 1-33-5-43	125-10409	404144216
NIEBUR 10-33-5-43	125-10155	404144222
ROYAL 9-33-5-43	125-10151	404144223

Thanks very much!
Deb

--

Deborah Abrams
Orphaned Well Program Senior Specialist, Eastern Colorado



COLORADO
Energy & Carbon Management
Commission

Department of Natural Resources

C 720.799.4719 | O 303.894.2100 x5158 | F 303.894.2109
1120 Lincoln Street, Suite 801, Denver, CO 80203
deborah.abrams@state.co.us | www.colorado.gov/ecmc

Newman - DNR, Andrew <andrew.newman@state.co.us>

Fri, Mar 28, 2025 at 10:49 AM

To: "Abrams - DNR, Deborah" <deborah.abrams@state.co.us>

Cc: Brandon Marette - DNR <brandon.marette@state.co.us>, Sierra Focht - DNR <sierra.focht@state.co.us>, Mike Hickey - DNR <michael.hickey@state.co.us>, Josh Melby - DNR <josh.melby@state.co.us>, Todd Cozad - DNR <todd.cozad@state.co.us>, Wendy Figueroa - DNR <wendy.figueroa@state.co.us>

Thank you Deborah for reaching out to consult on these emergency plugging operations that are proposed to begin this coming Monday morning (3/31). It sounds like there is a risk of an uncontrolled release if not addressed quickly.

I have cc'd CPWs Area Manager Todd Cozad, District Wildlife Manager Josh Melby, and Area Biologist Wendy Figueroa.

I pulled the wells up in ECEM GIS to confirm the following:

Well Name	API #	District	HPH	Notes
FERGUSON 13-9-5-45	125-10722	144	GPC PA	Adjacent to ANSCW HPH
FERGUSON 10-9-5-45	125-02376	144	GPC PA	Adjacent to ANSCW HPH
FERGUSON 7-9-5-45	125-09364	144	GPC PA	Adjacent to ANSCW HPH
BENNETT-STATE 9-16-5-45	125-09728	144	GPC PA	Adjacent to ANSCW HPH
BLEDSON 1-24-5-45	125-09495	144	GPC Lek	Surrounded by GPC leks
BOWMAN 13-35-5-44	125-09569	144	none	Outside GPC PA
BOWMAN 14-35-5-44	125-09570	144	none	Outside GPC PA
ROYAL 1-33-5-43	125-10409	144	none	Outside GPC PA
NIEBUR 10-33-5-43	125-10155	144	none	Outside GPC PA
ROYAL 9-33-5-43	125-10151	144	none	Outside GPC PA

The first four wells are in GPC Production Area HPH and adjacent to Aquatic Native Species Conservation Waters HPH. The timing limitation for GPC PA HPH is: "No permitted or authorized human activities within 2.2 miles of a lek or from March 1 to June 30"

Due to the emergency nature of this effort, CPW's recommendation for these wells would be to conduct the work during daylight hours only and **at least 2 hours after local sunrise time** to avoid disturbing lekking birds.

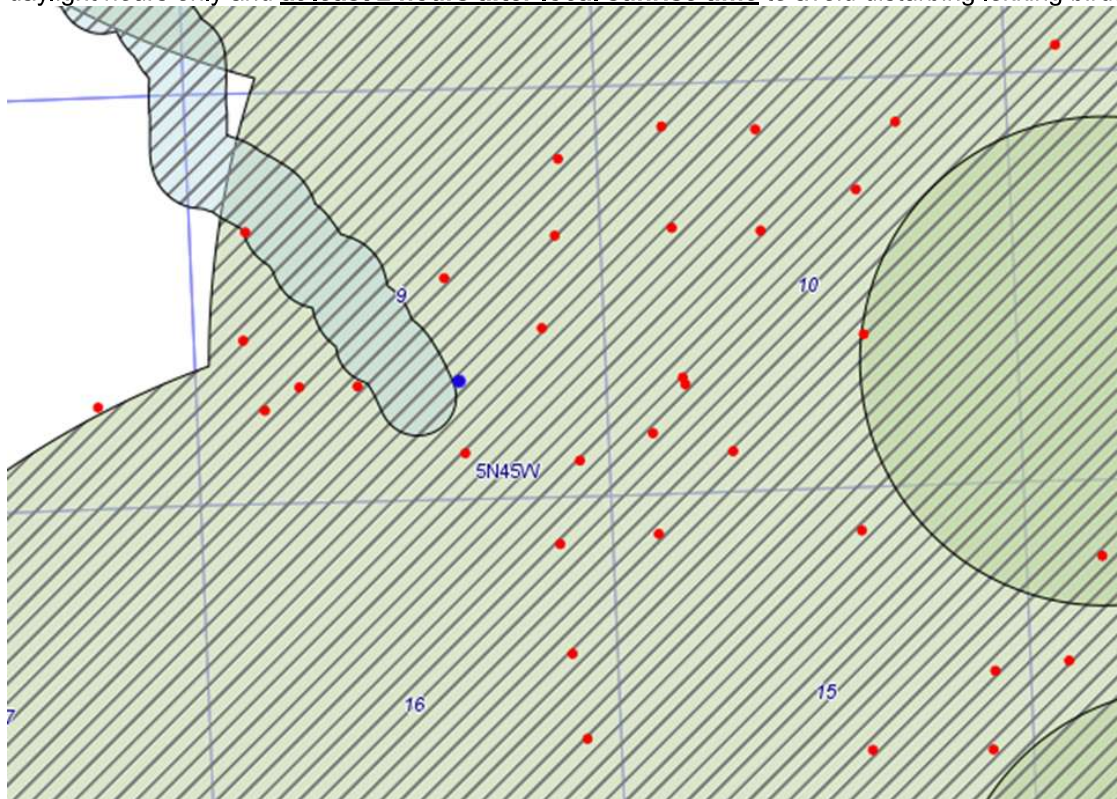

The Bledsoe 1-24-5-45 well is right in the middle of a GPC lek complex (blue dot on map). This HPH includes a year-round No Surface Occupancy (NSO) stipulation.

Due to the emergency nature of this effort, CPW's recommendation for this well would be to conduct the work during daylight hours only and **at least 2 hours after local sunrise time** to avoid disturbing lekking birds. Our Area 3 staff may have additional recommendations for resource protection measures due to the sensitive nature of this location.

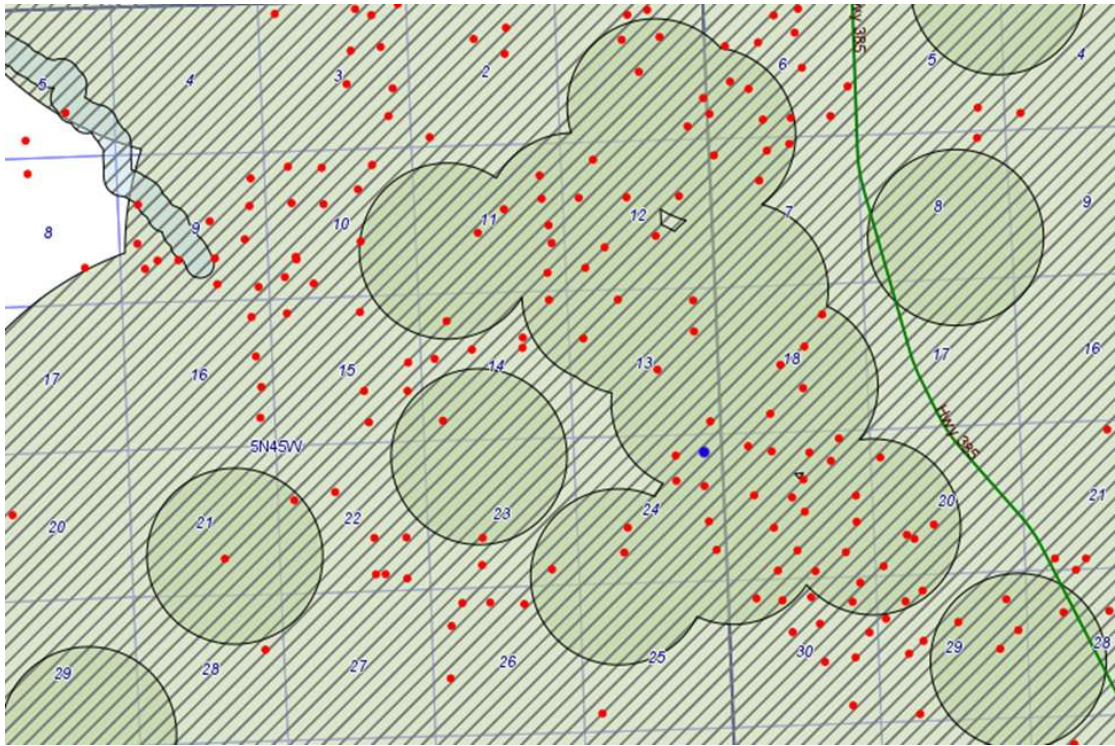

The remaining wells are all to the southeast and are located outside of HPH so those locations do not represent a concern to CPW.

Please let us know if you have any questions.

Andrew Newman
Senior Energy and Land Use Coordinator
Northeast Region



P 720.390.8823

6060 Broadway, Denver, CO 80216

andrew.newman@state.co.us | cpw.state.co.us

[CPW's Energy Webpage](http://cpw.state.co.us)



Under the Colorado Open Records Act (CORA), all messages sent by or to me on this state-owned e-mail account may be subject to public disclosure.

Upcoming Leave: 4/17-18

[Quoted text hidden]

Hickey - DNR, Mike <michael.hickey@state.co.us>

Fri, Mar 28, 2025 at 11:00 AM

To: "Newman - DNR, Andrew" <andrew.newman@state.co.us>

Cc: "Abrams - DNR, Deborah" <deborah.abrams@state.co.us>, Brandon Marette - DNR <brandon.marette@state.co.us>, Sierra Focht - DNR <sierra.focht@state.co.us>, Josh Melby - DNR <josh.melby@state.co.us>, Todd Cozad - DNR <todd.cozad@state.co.us>, Wendy Figueroa - DNR <wendy.figueroa@state.co.us>

Thank you for your prompt attention.

Michael J. Hickey PE
 Orphan Well Program Supervisor East



COLORADO
Energy & Carbon Management
Commission
 Department of Natural Resources

C - (970) 302-1024

michael.hickey@state.co.us | www.colorado.gov/cogcc

[Quoted text hidden]

Focht - DNR, Sierra <sierra.focht@state.co.us>

Fri, Mar 28, 2025 at 12:20 PM

To: "Hickey - DNR, Mike" <michael.hickey@state.co.us>

Cc: "Newman - DNR, Andrew" <andrew.newman@state.co.us>, "Abrams - DNR, Deborah" <deborah.abrams@state.co.us>, Brandon Marette - DNR <brandon.marette@state.co.us>, Josh Melby - DNR <josh.melby@state.co.us>, Todd Cozad - DNR <todd.cozad@state.co.us>, Wendy Figueroa - DNR <wendy.figueroa@state.co.us>

Thank you everyone for the quick responses. I will add the timing BMPs to the forms and finish my review.

[Quoted text hidden]

--

Sierra Focht

Location Assessment Specialist



COLORADO
Energy & Carbon Management
Commission
 Department of Natural Resources

720-916-2117

1120 Lincoln St., Suite 801, Denver, CO 80203

sierra.focht@state.co.us | www.colorado.gov/ecmc

Figueroa - DNR, Wendy <wendy.figueroa@state.co.us>

Fri, Mar 28, 2025 at 12:22 PM

To: "Newman - DNR, Andrew" <andrew.newman@state.co.us>

Cc: "Abrams - DNR, Deborah" <deborah.abrams@state.co.us>, Brandon Marette - DNR <brandon.marette@state.co.us>, Sierra Focht - DNR <sierra.focht@state.co.us>, Mike Hickey - DNR <michael.hickey@state.co.us>, Josh Melby - DNR <josh.melby@state.co.us>, Todd Cozad - DNR <todd.cozad@state.co.us>

Andrew,

Thank you for getting this out for our review. I agree that with stated exigent circumstances, the proposed procedure to start plugging activities 2 hours after local sunrise and only work during daylight hours will be acceptable.

Thank you,
 Wendy

On Fri, Mar 28, 2025 at 10:49 AM Newman - DNR, Andrew <andrew.newman@state.co.us> wrote:

[Quoted text hidden]

--

Wendy Figueroa
Wildlife Biologist



P 970.842.9006 | C 970.466.7892

3/28/25, 12:26 PM

State.co.us Executive Branch Mail - Omimex Emergency Plugging Forms

28167 CR T, Brush, CO 80723

wendy.figueroa@state.co.us | cpw.state.co.us