

Operator: 8 North

Location Name: SUSIE-610N61W/9NWNW

Loc ID: 318999

Inspection: 709100370

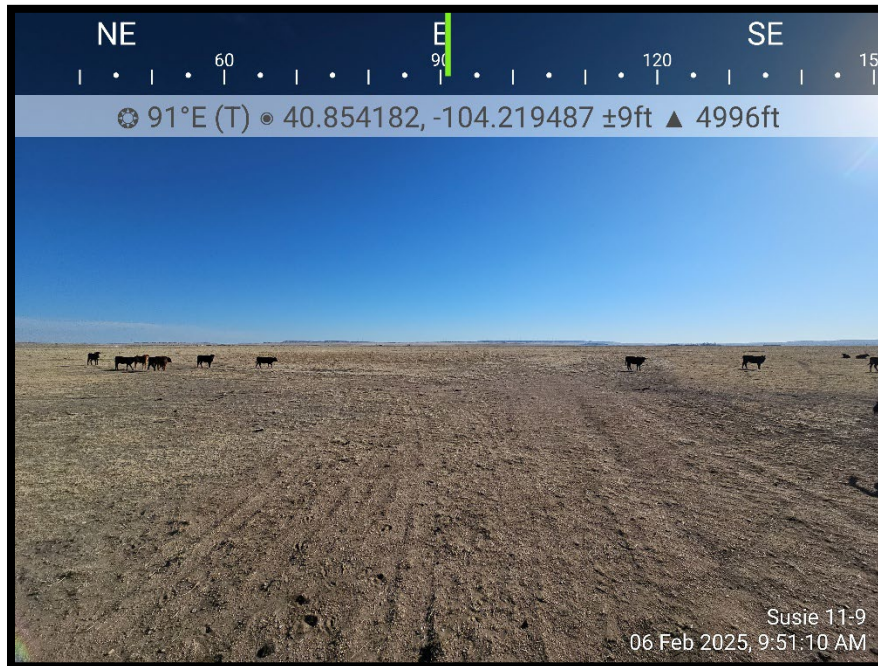

Exhibit A

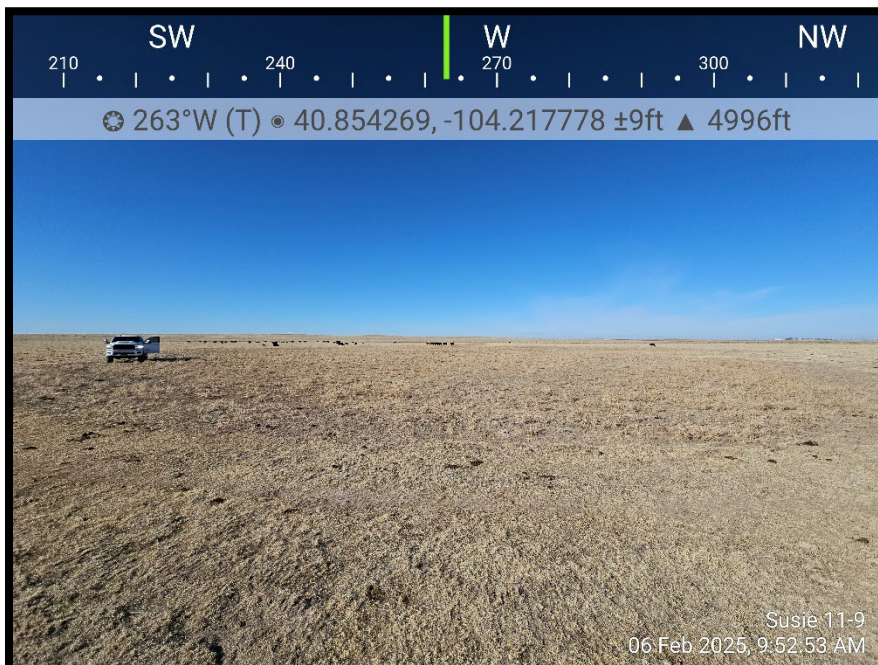

Exhibit B

CA: Location observed to have sparse vegetation growing (potential salt kill or sediment transport) south of location (photo 12 of Photo Log). Operator shall investigate the area by collecting soil sample(s) within the sparse vegetative area and compare the analytics using the Table 915-1 Protection of Groundwater Soil Screening Level Concentrations. If exceedances exist, remediate impacts to Table 915-1 standards. Documentation must include a figure showing area with sample locations plus laboratory results. This information shall be submitted within a Form 19 submittal.

CA Resolution: Operator has addressed the issue with Form 19 doc # 403092884, and it is under a current remediation # 22270, with Form 27 doc #402938857.