

## Legend

- P&A'd Wellhead
- Soil Sample
- Soil Screening
- Approximate Location of Flowline (Removed)

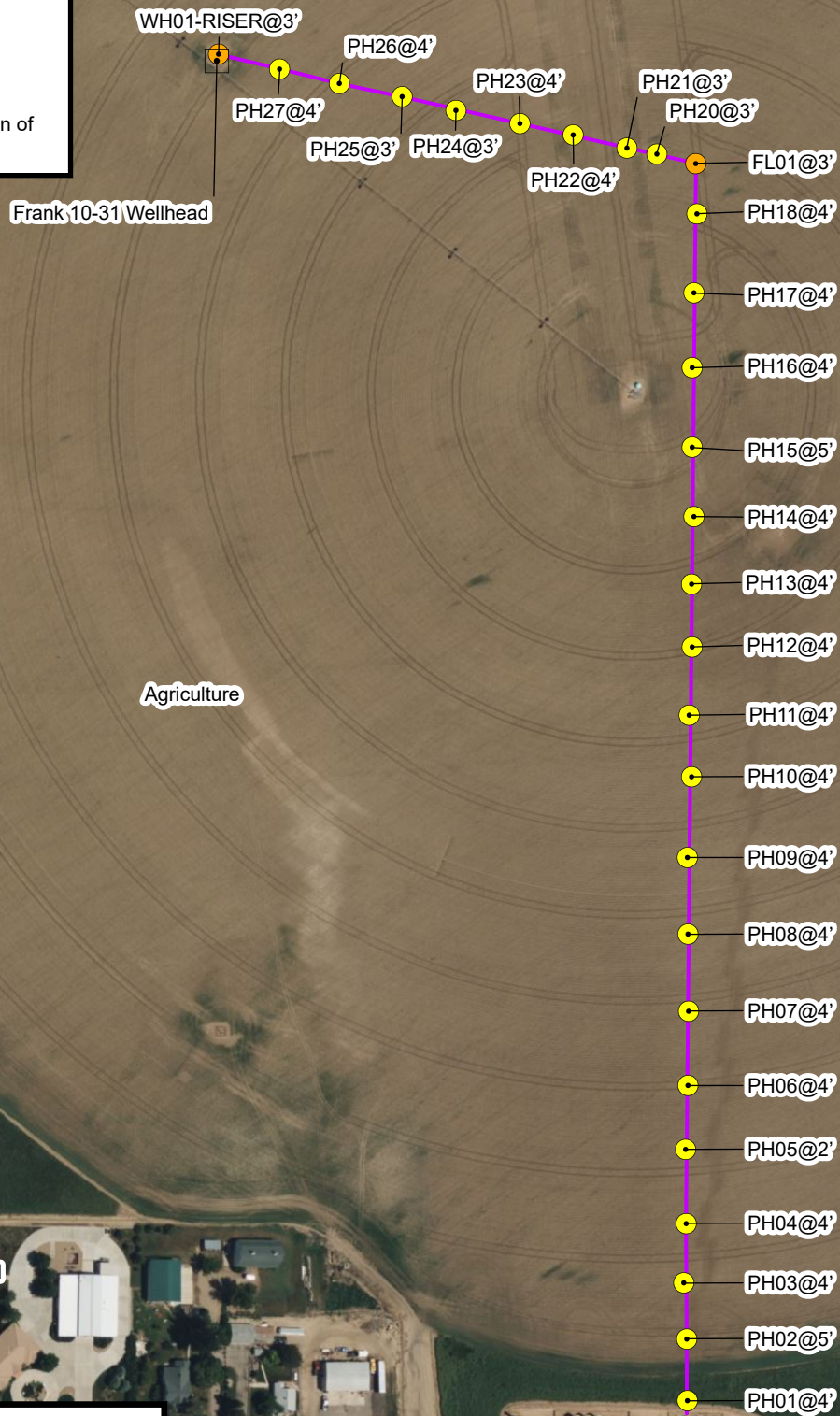

## Flowline Excavation Site Map

Frank 10-31 Wellhead  
 Kerr-McGee Oil & Gas Onshore, LP  
 NWSE SEC 31-T4N-R67W  
 Weld County, CO

Project Number: 09A1417573

FIGURE

2