



FORM F-106



00052526

RECEIVED

JUL 15 1981

BOLG. OIL & GAS CONS. COMM.

R. 92 W

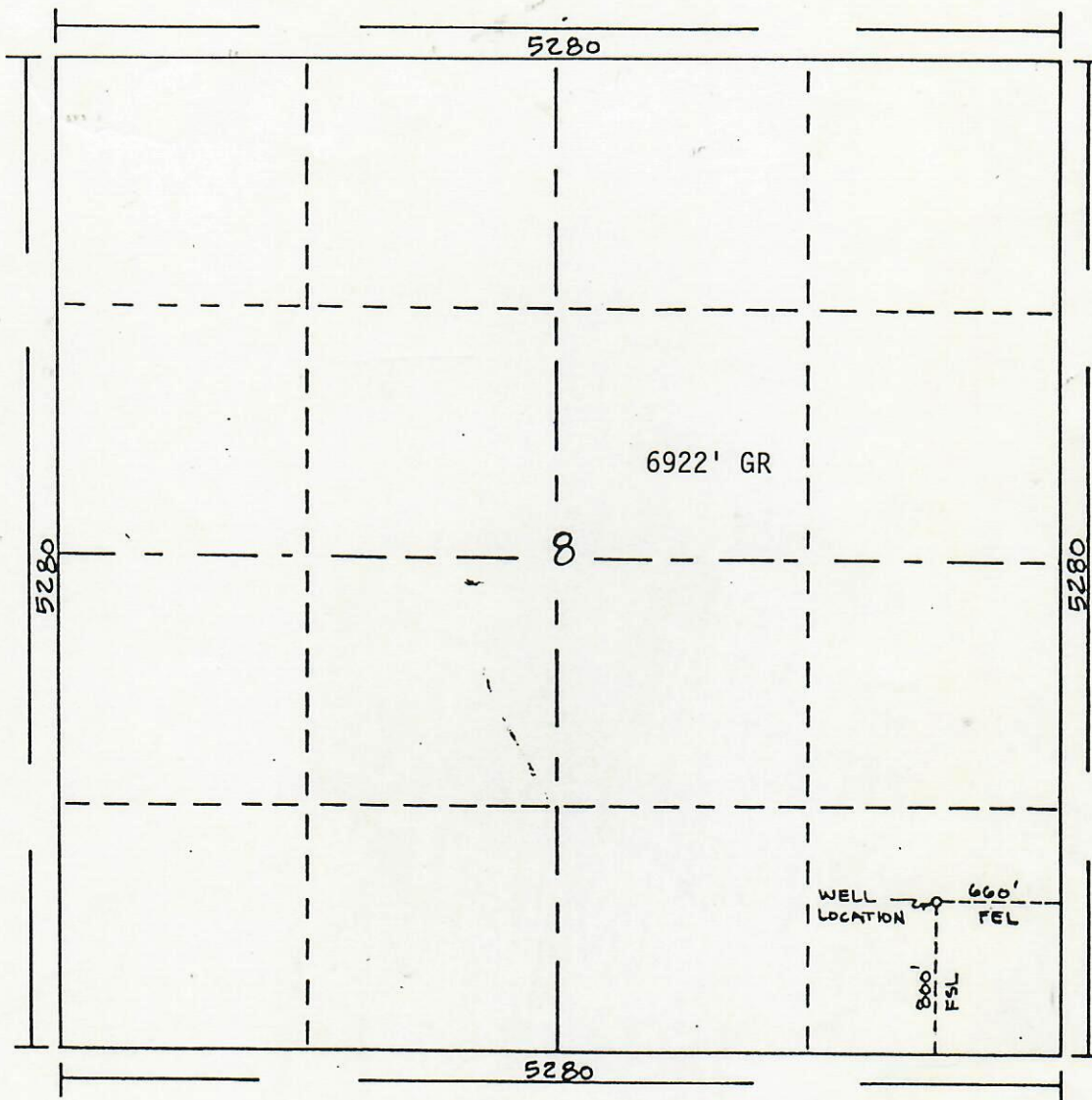
N
T
Z

Scale... 1" = 1000'

Powers Elevation of Denver, Colorado
has in accordance with a request from CAROLYN LEE
for NORTHWEST EXPLORATION COMPANY
determined the location of THEOS & SON #1
to be 800' FSL & 660' FEL of Section 8 Township 1N
Range 92W of the 6TH PRINCIPAL Meridian
RIO BLANCO County, COLORADO

I hereby certify that this plat is an
accurate representation of a correct
survey showing the location of
THEOS & SON #1

Date: APRIL 27, 1981

T. Nelson
Licensed Land Surveyor No. 2188
State of COLORADO