

BAYSWATER EXPLORATION & PRODUCTION

**WELD COUNTY
SEC 6-T7N-R66W
COALBANK 5**

OWB

Plan: PROPOSAL 1

Standard Planning Report

28 July, 2024

Project: WELD COUNTY
Site: SEC 6-T7N-R66W
Well: COALBANK 5
Wellbore: OWB
Design: PROPOSAL 1

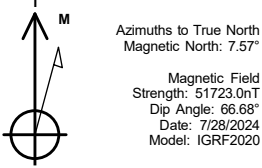

WELL DETAILS: COALBANK 5

+N/-S	+E/-W	Northing	Easting	5120.00	Latitude	Longitude	Slot
0.00	0.00	1462964.22	3190960.88		40.602202°N	104.812291°W	

ANNOTATIONS

MD	Inc	Azi	TVD	+N/-S	+E/-W	VSect	Departure	Annotation
100.00	0.00	0.00	100.00	0.00	0.00	0.00	0.00	Start Build 2.00
626.04	10.52	185.79	623.09	-47.92	-4.86	0.12	48.16	Start 6579.29 hold at 626.04 MD
7205.33	10.52	185.79	7091.77	-1243.12	-126.04	3.06	1249.49	Start DLS 10.00 TFO -97.01
8116.87	89.86	88.69	7668.00	-1335.96	447.65	583.28	1848.38	Start 10178.40 hold at 8116.87 MD
18295.28	89.86	88.69	7693.00	-1103.42	10623.37	10680.52	12026.75	TD at 18295.28

SECTION DETAILS

Sec	MD	Inc	Azi	TVD	+N/-S	+E/-W	Dleg	TFace	VSect	Target
1	0.00	0.00	0.00	0.00	0.00	0.00	0.00	0.00	0.00	
2	100.00	0.00	0.00	100.00	0.00	0.00	0.00	0.00	0.00	
3	626.04	10.52	185.79	623.09	-47.92	-4.86	2.00	185.79	0.12	
4	7205.33	10.52	185.79	7091.77	-1243.12	-126.04	0.00	0.00	3.06	
5	8116.87	89.86	88.69	7668.00	-1335.96	447.65	10.00	-97.01	583.28	LP-C
6	18295.28	89.86	88.69	7693.00	-1103.42	10623.37	0.00	0.00	10680.52	PBH

DESIGN TARGET DETAILS

Name	TVD	+N/-S	+E/-W	Northing	Easting	Latitude	Longitude	Shape
LP-COALBANK 5	7668.00	-1335.96	447.65	1461631.80	3191418.87	40.598535°N	104.810679°W	Point
- plan hits target center								
PBHL-COALBANK 5	7693.00	-1103.42	10623.37	1461943.24	3201592.23	40.599167°N	104.774036°W	Point
- plan hits target center								

PROJECT DETAILS: WELD COUNTY

Geodetic System: US State Plane 1983
Datum: North American Datum 1983
Ellipsoid: GRS 1980
Zone: Colorado Northern Zone
System Datum: Mean Sea Level

SHL:
2113' FSL, 346' FEL
Sec 6-T7N-R66W

LP:
764' FSL, 160' FWL
Sec 5-T7N-R66W

BHL:
749' FSL, 160' FEL
Sec 4-T7N-R66W

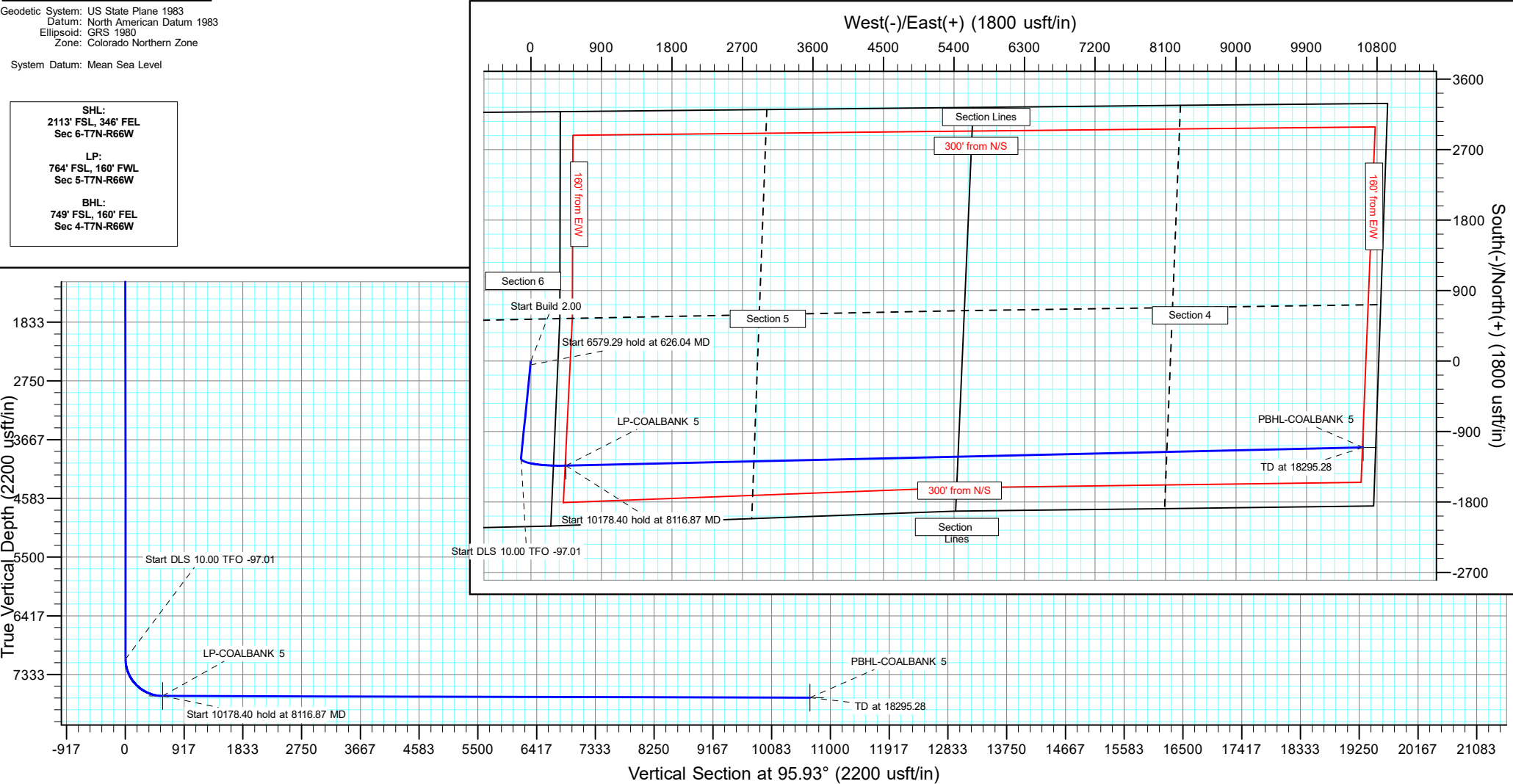

Planning Report

Database:	EDM 5000.16 Single User Db	Local Co-ordinate Reference:	Well COALBANK 5
Company:	BAYSWATER EXPLORATION & PRODUCTION	TVD Reference:	KBE 23' @ 5143.00usft
Project:	WELD COUNTY	MD Reference:	KBE 23' @ 5143.00usft
Site:	SEC 6-T7N-R66W	North Reference:	True
Well:	COALBANK 5	Survey Calculation Method:	Minimum Curvature
Wellbore:	OWB		
Design:	PROPOSAL 1		

Project	WELD COUNTY		
Map System:	US State Plane 1983	System Datum:	Mean Sea Level
Geo Datum:	North American Datum 1983		
Map Zone:	Colorado Northern Zone		Using geodetic scale factor

Site		SEC 6-T7N-R66W				
Site Position:		Northing:	1,460,687.83	usft	Latitude:	40.596067°N
From:	Lat/Long	Easting:	3,185,555.14	usft	Longitude:	104.831820°W
Position Uncertainty:		0.00	usft	Slot Radius:	13.200	in

Well	COALBANK 5					
Well Position	+N/-S	0.00 usft	Northing:	1,462,964.22 usft	Latitude:	40.602202°N
	+E/-W	0.00 usft	Easting:	3,190,960.88 usft	Longitude:	104.812291°W
Position Uncertainty		0.00 usft	Wellhead Elevation:	usft	Ground Level:	5,120.00 usft
Grid Convergence:		0.44 °				

Wellbore	OWB				
Magnetics	Model Name	Sample Date	Declination (°)	Dip Angle (°)	Field Strength (nT)
	IGRF2020	7/28/2024	7.57	66.68	51,723.01327717

Design	PROPOSAL 1			
Audit Notes:				
Version:	Phase:	PROTOTYPE	Tie On Depth:	0.00
Vertical Section:	Depth From (TVD) (usft)	+N/-S (usft)	+E/-W (usft)	Direction (°)
	0.00	0.00	0.00	95.93

Plan Survey Tool Program	Date	7/28/2024		
Depth From (usft)	Depth To (usft)	Survey (Wellbore)	Tool Name	Remarks
1	0.00	18,295.28 PROPOSAL 1 (OWB)	MWD	
			OWSG MWD - Standard	

Plan Sections										
Measured Depth (usft)	Inclination (°)	Azimuth (°)	Vertical Depth (usft)	+N/-S (usft)	+E/-W (usft)	Dogleg Rate (°/100ft)	Build Rate (°/100ft)	Turn Rate (°/100ft)	TFO (°)	Target
0.00	0.00	0.00	0.00	0.00	0.00	0.00	0.00	0.00	0.00	
100.00	0.00	0.00	100.00	0.00	0.00	0.00	0.00	0.00	0.00	
626.04	10.52	185.79	623.09	-47.92	-4.86	2.00	2.00	0.00	185.79	
7,205.33	10.52	185.79	7,091.77	-1,243.12	-126.04	0.00	0.00	0.00	0.00	
8,116.87	89.86	88.69	7,668.00	-1,335.96	447.65	10.00	8.70	-10.65	-97.01	LP-COALBANK 5
18,295.28	89.86	88.69	7,693.00	-1,103.42	10,623.37	0.00	0.00	0.00	0.00	PBHL-COALBANK 5

Planning Report

Database:	EDM 5000.16 Single User Db	Local Co-ordinate Reference:	Well COALBANK 5
Company:	BAYSWATER EXPLORATION & PRODUCTION	TVD Reference:	KBE 23' @ 5143.00usft
Project:	WELD COUNTY	MD Reference:	KBE 23' @ 5143.00usft
Site:	SEC 6-T7N-R66W	North Reference:	True
Well:	COALBANK 5	Survey Calculation Method:	Minimum Curvature
Wellbore:	OWB		
Design:	PROPOSAL 1		

Planned Survey									
Measured Depth (usft)	Inclination (°)	Azimuth (°)	Vertical Depth (usft)	+N/-S (usft)	+E/-W (usft)	Vertical Section (usft)	Dogleg Rate (°/100ft)	Build Rate (°/100ft)	Turn Rate (°/100ft)
0.00	0.00	0.00	0.00	0.00	0.00	0.00	0.00	0.00	0.00
100.00	0.00	0.00	100.00	0.00	0.00	0.00	0.00	0.00	0.00
Start Build 2.00									
200.00	2.00	185.79	199.98	-1.74	-0.18	0.00	2.00	2.00	0.00
300.00	4.00	185.79	299.84	-6.94	-0.70	0.02	2.00	2.00	0.00
400.00	6.00	185.79	399.45	-15.61	-1.58	0.04	2.00	2.00	0.00
500.00	8.00	185.79	498.70	-27.74	-2.81	0.07	2.00	2.00	0.00
600.00	10.00	185.79	597.47	-43.30	-4.39	0.11	2.00	2.00	0.00
626.04	10.52	185.79	623.09	-47.92	-4.86	0.12	2.00	2.00	0.00
Start 6579.29 hold at 626.04 MD									
700.00	10.52	185.79	695.81	-61.35	-6.22	0.15	0.00	0.00	0.00
800.00	10.52	185.79	794.12	-79.52	-8.06	0.20	0.00	0.00	0.00
900.00	10.52	185.79	892.44	-97.68	-9.90	0.24	0.00	0.00	0.00
1,000.00	10.52	185.79	990.76	-115.85	-11.75	0.29	0.00	0.00	0.00
1,100.00	10.52	185.79	1,089.08	-134.02	-13.59	0.33	0.00	0.00	0.00
1,200.00	10.52	185.79	1,187.40	-152.18	-15.43	0.37	0.00	0.00	0.00
1,300.00	10.52	185.79	1,285.72	-170.35	-17.27	0.42	0.00	0.00	0.00
1,400.00	10.52	185.79	1,384.04	-188.51	-19.11	0.46	0.00	0.00	0.00
1,500.00	10.52	185.79	1,482.36	-206.68	-20.96	0.51	0.00	0.00	0.00
1,600.00	10.52	185.79	1,580.68	-224.85	-22.80	0.55	0.00	0.00	0.00
1,700.00	10.52	185.79	1,678.99	-243.01	-24.64	0.60	0.00	0.00	0.00
1,800.00	10.52	185.79	1,777.31	-261.18	-26.48	0.64	0.00	0.00	0.00
1,900.00	10.52	185.79	1,875.63	-279.34	-28.32	0.69	0.00	0.00	0.00
2,000.00	10.52	185.79	1,973.95	-297.51	-30.17	0.73	0.00	0.00	0.00
2,100.00	10.52	185.79	2,072.27	-315.68	-32.01	0.78	0.00	0.00	0.00
2,200.00	10.52	185.79	2,170.59	-333.84	-33.85	0.82	0.00	0.00	0.00
2,300.00	10.52	185.79	2,268.91	-352.01	-35.69	0.87	0.00	0.00	0.00
2,400.00	10.52	185.79	2,367.23	-370.18	-37.53	0.91	0.00	0.00	0.00
2,500.00	10.52	185.79	2,465.55	-388.34	-39.37	0.96	0.00	0.00	0.00
2,600.00	10.52	185.79	2,563.86	-406.51	-41.22	1.00	0.00	0.00	0.00
2,700.00	10.52	185.79	2,662.18	-424.67	-43.06	1.05	0.00	0.00	0.00
2,800.00	10.52	185.79	2,760.50	-442.84	-44.90	1.09	0.00	0.00	0.00
2,900.00	10.52	185.79	2,858.82	-461.01	-46.74	1.13	0.00	0.00	0.00
3,000.00	10.52	185.79	2,957.14	-479.17	-48.58	1.18	0.00	0.00	0.00
3,100.00	10.52	185.79	3,055.46	-497.34	-50.43	1.22	0.00	0.00	0.00
3,200.00	10.52	185.79	3,153.78	-515.50	-52.27	1.27	0.00	0.00	0.00
3,300.00	10.52	185.79	3,252.10	-533.67	-54.11	1.31	0.00	0.00	0.00
3,400.00	10.52	185.79	3,350.41	-551.84	-55.95	1.36	0.00	0.00	0.00
3,500.00	10.52	185.79	3,448.73	-570.00	-57.79	1.40	0.00	0.00	0.00
3,600.00	10.52	185.79	3,547.05	-588.17	-59.64	1.45	0.00	0.00	0.00
3,700.00	10.52	185.79	3,645.37	-606.33	-61.48	1.49	0.00	0.00	0.00
3,800.00	10.52	185.79	3,743.69	-624.50	-63.32	1.54	0.00	0.00	0.00
3,900.00	10.52	185.79	3,842.01	-642.67	-65.16	1.58	0.00	0.00	0.00
4,000.00	10.52	185.79	3,940.33	-660.83	-67.00	1.63	0.00	0.00	0.00
4,100.00	10.52	185.79	4,038.65	-679.00	-68.85	1.67	0.00	0.00	0.00
4,200.00	10.52	185.79	4,136.97	-697.17	-70.69	1.72	0.00	0.00	0.00
4,300.00	10.52	185.79	4,235.28	-715.33	-72.53	1.76	0.00	0.00	0.00
4,400.00	10.52	185.79	4,333.60	-733.50	-74.37	1.81	0.00	0.00	0.00
4,500.00	10.52	185.79	4,431.92	-751.66	-76.21	1.85	0.00	0.00	0.00
4,600.00	10.52	185.79	4,530.24	-769.83	-78.06	1.90	0.00	0.00	0.00
4,700.00	10.52	185.79	4,628.56	-788.00	-79.90	1.94	0.00	0.00	0.00
4,800.00	10.52	185.79	4,726.88	-806.16	-81.74	1.98	0.00	0.00	0.00
4,900.00	10.52	185.79	4,825.20	-824.33	-83.58	2.03	0.00	0.00	0.00

Planning Report

Database:	EDM 5000.16 Single User Db	Local Co-ordinate Reference:	Well COALBANK 5
Company:	BAYSWATER EXPLORATION & PRODUCTION	TVD Reference:	KBE 23' @ 5143.00usft
Project:	WELD COUNTY	MD Reference:	KBE 23' @ 5143.00usft
Site:	SEC 6-T7N-R66W	North Reference:	True
Well:	COALBANK 5	Survey Calculation Method:	Minimum Curvature
Wellbore:	OWB		
Design:	PROPOSAL 1		

Planned Survey										
Measured Depth (usft)	Inclination (°)	Azimuth (°)	Vertical Depth (usft)	+N/-S (usft)	+E/-W (usft)	Vertical Section (usft)	Dogleg Rate (°/100ft)	Build Rate (°/100ft)	Turn Rate (°/100ft)	
5,000.00	10.52	185.79	4,923.52	-842.49	-85.42	2.07	0.00	0.00	0.00	
5,100.00	10.52	185.79	5,021.84	-860.66	-87.26	2.12	0.00	0.00	0.00	
5,200.00	10.52	185.79	5,120.15	-878.83	-89.11	2.16	0.00	0.00	0.00	
5,300.00	10.52	185.79	5,218.47	-896.99	-90.95	2.21	0.00	0.00	0.00	
5,400.00	10.52	185.79	5,316.79	-915.16	-92.79	2.25	0.00	0.00	0.00	
5,500.00	10.52	185.79	5,415.11	-933.33	-94.63	2.30	0.00	0.00	0.00	
5,600.00	10.52	185.79	5,513.43	-951.49	-96.47	2.34	0.00	0.00	0.00	
5,700.00	10.52	185.79	5,611.75	-969.66	-98.32	2.39	0.00	0.00	0.00	
5,800.00	10.52	185.79	5,710.07	-987.82	-100.16	2.43	0.00	0.00	0.00	
5,900.00	10.52	185.79	5,808.39	-1,005.99	-102.00	2.48	0.00	0.00	0.00	
6,000.00	10.52	185.79	5,906.71	-1,024.16	-103.84	2.52	0.00	0.00	0.00	
6,100.00	10.52	185.79	6,005.02	-1,042.32	-105.68	2.57	0.00	0.00	0.00	
6,200.00	10.52	185.79	6,103.34	-1,060.49	-107.53	2.61	0.00	0.00	0.00	
6,300.00	10.52	185.79	6,201.66	-1,078.65	-109.37	2.66	0.00	0.00	0.00	
6,400.00	10.52	185.79	6,299.98	-1,096.82	-111.21	2.70	0.00	0.00	0.00	
6,500.00	10.52	185.79	6,398.30	-1,114.99	-113.05	2.74	0.00	0.00	0.00	
6,600.00	10.52	185.79	6,496.62	-1,133.15	-114.89	2.79	0.00	0.00	0.00	
6,700.00	10.52	185.79	6,594.94	-1,151.32	-116.74	2.83	0.00	0.00	0.00	
6,800.00	10.52	185.79	6,693.26	-1,169.48	-118.58	2.88	0.00	0.00	0.00	
6,900.00	10.52	185.79	6,791.58	-1,187.65	-120.42	2.92	0.00	0.00	0.00	
7,000.00	10.52	185.79	6,889.89	-1,205.82	-122.26	2.97	0.00	0.00	0.00	
7,100.00	10.52	185.79	6,988.21	-1,223.98	-124.10	3.01	0.00	0.00	0.00	
7,200.00	10.52	185.79	7,086.53	-1,242.15	-125.94	3.06	0.00	0.00	0.00	
7,205.33	10.52	185.79	7,091.77	-1,243.12	-126.04	3.06	0.00	0.00	0.00	
Start DLS 10.00 TFO -97.01										
7,300.00	13.23	140.28	7,184.60	-1,260.09	-119.98	10.85	10.00	2.86	-48.07	
7,400.00	20.87	117.57	7,280.24	-1,277.18	-96.82	35.65	10.00	7.64	-22.71	
7,500.00	29.89	107.36	7,370.54	-1,292.90	-57.15	76.73	10.00	9.03	-10.21	
7,600.00	39.36	101.65	7,452.75	-1,306.77	-2.17	132.85	10.00	9.47	-5.71	
7,700.00	49.01	97.88	7,524.39	-1,318.38	66.45	202.30	10.00	9.65	-3.77	
7,800.00	58.76	95.08	7,583.26	-1,327.36	146.62	282.97	10.00	9.74	-2.79	
7,900.00	68.55	92.82	7,627.59	-1,333.45	235.91	372.41	10.00	9.79	-2.27	
8,000.00	78.37	90.84	7,656.03	-1,336.46	331.60	467.90	10.00	9.82	-1.98	
8,100.00	88.20	89.00	7,667.71	-1,336.30	430.79	566.54	10.00	9.83	-1.84	
8,116.87	89.86	88.69	7,668.00	-1,335.96	447.65	583.28	10.00	9.83	-1.81	
Start 10178.40 hold at 8116.87 MD										
8,200.00	89.86	88.69	7,668.20	-1,334.06	530.76	665.74	0.00	0.00	0.00	
8,300.00	89.86	88.69	7,668.45	-1,331.78	630.73	764.95	0.00	0.00	0.00	
8,400.00	89.86	88.69	7,668.70	-1,329.50	730.71	864.15	0.00	0.00	0.00	
8,500.00	89.86	88.69	7,668.94	-1,327.21	830.68	963.35	0.00	0.00	0.00	
8,600.00	89.86	88.69	7,669.19	-1,324.93	930.65	1,062.55	0.00	0.00	0.00	
8,700.00	89.86	88.69	7,669.43	-1,322.64	1,030.63	1,161.76	0.00	0.00	0.00	
8,800.00	89.86	88.69	7,669.68	-1,320.36	1,130.60	1,260.96	0.00	0.00	0.00	
8,900.00	89.86	88.69	7,669.92	-1,318.07	1,230.57	1,360.16	0.00	0.00	0.00	
9,000.00	89.86	88.69	7,670.17	-1,315.79	1,330.55	1,459.36	0.00	0.00	0.00	
9,100.00	89.86	88.69	7,670.41	-1,313.50	1,430.52	1,558.57	0.00	0.00	0.00	
9,200.00	89.86	88.69	7,670.66	-1,311.22	1,530.49	1,657.77	0.00	0.00	0.00	
9,300.00	89.86	88.69	7,670.91	-1,308.93	1,630.47	1,756.97	0.00	0.00	0.00	
9,400.00	89.86	88.69	7,671.15	-1,306.65	1,730.44	1,856.17	0.00	0.00	0.00	
9,500.00	89.86	88.69	7,671.40	-1,304.36	1,830.42	1,955.38	0.00	0.00	0.00	
9,600.00	89.86	88.69	7,671.64	-1,302.08	1,930.39	2,054.58	0.00	0.00	0.00	
9,700.00	89.86	88.69	7,671.89	-1,299.80	2,030.36	2,153.78	0.00	0.00	0.00	
9,800.00	89.86	88.69	7,672.13	-1,297.51	2,130.34	2,252.99	0.00	0.00	0.00	

Planning Report

Database:	EDM 5000.16 Single User Db	Local Co-ordinate Reference:	Well COALBANK 5
Company:	BAYSWATER EXPLORATION & PRODUCTION	TVD Reference:	KBE 23' @ 5143.00usft
Project:	WELD COUNTY	MD Reference:	KBE 23' @ 5143.00usft
Site:	SEC 6-T7N-R66W	North Reference:	True
Well:	COALBANK 5	Survey Calculation Method:	Minimum Curvature
Wellbore:	OWB		
Design:	PROPOSAL 1		

Planned Survey										
Measured Depth (usft)	Inclination (°)	Azimuth (°)	Vertical Depth (usft)	+N/-S (usft)	+E/-W (usft)	Vertical Section (usft)	Dogleg Rate (°/100ft)	Build Rate (°/100ft)	Turn Rate (°/100ft)	
9,900.00	89.86	88.69	7,672.38	-1,295.23	2,230.31	2,352.19	0.00	0.00	0.00	
10,000.00	89.86	88.69	7,672.63	-1,292.94	2,330.28	2,451.39	0.00	0.00	0.00	
10,100.00	89.86	88.69	7,672.87	-1,290.66	2,430.26	2,550.59	0.00	0.00	0.00	
10,200.00	89.86	88.69	7,673.12	-1,288.37	2,530.23	2,649.80	0.00	0.00	0.00	
10,300.00	89.86	88.69	7,673.36	-1,286.09	2,630.20	2,749.00	0.00	0.00	0.00	
10,400.00	89.86	88.69	7,673.61	-1,283.80	2,730.18	2,848.20	0.00	0.00	0.00	
10,500.00	89.86	88.69	7,673.85	-1,281.52	2,830.15	2,947.40	0.00	0.00	0.00	
10,600.00	89.86	88.69	7,674.10	-1,279.23	2,930.13	3,046.61	0.00	0.00	0.00	
10,700.00	89.86	88.69	7,674.34	-1,276.95	3,030.10	3,145.81	0.00	0.00	0.00	
10,800.00	89.86	88.69	7,674.59	-1,274.66	3,130.07	3,245.01	0.00	0.00	0.00	
10,900.00	89.86	88.69	7,674.84	-1,272.38	3,230.05	3,344.21	0.00	0.00	0.00	
11,000.00	89.86	88.69	7,675.08	-1,270.09	3,330.02	3,443.42	0.00	0.00	0.00	
11,100.00	89.86	88.69	7,675.33	-1,267.81	3,429.99	3,542.62	0.00	0.00	0.00	
11,200.00	89.86	88.69	7,675.57	-1,265.53	3,529.97	3,641.82	0.00	0.00	0.00	
11,300.00	89.86	88.69	7,675.82	-1,263.24	3,629.94	3,741.02	0.00	0.00	0.00	
11,400.00	89.86	88.69	7,676.06	-1,260.96	3,729.91	3,840.23	0.00	0.00	0.00	
11,500.00	89.86	88.69	7,676.31	-1,258.67	3,829.89	3,939.43	0.00	0.00	0.00	
11,600.00	89.86	88.69	7,676.56	-1,256.39	3,929.86	4,038.63	0.00	0.00	0.00	
11,700.00	89.86	88.69	7,676.80	-1,254.10	4,029.83	4,137.83	0.00	0.00	0.00	
11,800.00	89.86	88.69	7,677.05	-1,251.82	4,129.81	4,237.04	0.00	0.00	0.00	
11,900.00	89.86	88.69	7,677.29	-1,249.53	4,229.78	4,336.24	0.00	0.00	0.00	
12,000.00	89.86	88.69	7,677.54	-1,247.25	4,329.76	4,435.44	0.00	0.00	0.00	
12,100.00	89.86	88.69	7,677.78	-1,244.96	4,429.73	4,534.65	0.00	0.00	0.00	
12,200.00	89.86	88.69	7,678.03	-1,242.68	4,529.70	4,633.85	0.00	0.00	0.00	
12,300.00	89.86	88.69	7,678.27	-1,240.39	4,629.68	4,733.05	0.00	0.00	0.00	
12,400.00	89.86	88.69	7,678.52	-1,238.11	4,729.65	4,832.25	0.00	0.00	0.00	
12,500.00	89.86	88.69	7,678.77	-1,235.83	4,829.62	4,931.46	0.00	0.00	0.00	
12,600.00	89.86	88.69	7,679.01	-1,233.54	4,929.60	5,030.66	0.00	0.00	0.00	
12,700.00	89.86	88.69	7,679.26	-1,231.26	5,029.57	5,129.86	0.00	0.00	0.00	
12,800.00	89.86	88.69	7,679.50	-1,228.97	5,129.54	5,229.06	0.00	0.00	0.00	
12,900.00	89.86	88.69	7,679.75	-1,226.69	5,229.52	5,328.27	0.00	0.00	0.00	
13,000.00	89.86	88.69	7,679.99	-1,224.40	5,329.49	5,427.47	0.00	0.00	0.00	
13,100.00	89.86	88.69	7,680.24	-1,222.12	5,429.47	5,526.67	0.00	0.00	0.00	
13,200.00	89.86	88.69	7,680.49	-1,219.83	5,529.44	5,625.87	0.00	0.00	0.00	
13,300.00	89.86	88.69	7,680.73	-1,217.55	5,629.41	5,725.08	0.00	0.00	0.00	
13,400.00	89.86	88.69	7,680.98	-1,215.26	5,729.39	5,824.28	0.00	0.00	0.00	
13,500.00	89.86	88.69	7,681.22	-1,212.98	5,829.36	5,923.48	0.00	0.00	0.00	
13,600.00	89.86	88.69	7,681.47	-1,210.69	5,929.33	6,022.68	0.00	0.00	0.00	
13,700.00	89.86	88.69	7,681.71	-1,208.41	6,029.31	6,121.89	0.00	0.00	0.00	
13,800.00	89.86	88.69	7,681.96	-1,206.12	6,129.28	6,221.09	0.00	0.00	0.00	
13,900.00	89.86	88.69	7,682.20	-1,203.84	6,229.25	6,320.29	0.00	0.00	0.00	
14,000.00	89.86	88.69	7,682.45	-1,201.56	6,329.23	6,419.49	0.00	0.00	0.00	
14,100.00	89.86	88.69	7,682.70	-1,199.27	6,429.20	6,518.70	0.00	0.00	0.00	
14,200.00	89.86	88.69	7,682.94	-1,196.99	6,529.17	6,617.90	0.00	0.00	0.00	
14,300.00	89.86	88.69	7,683.19	-1,194.70	6,629.15	6,717.10	0.00	0.00	0.00	
14,400.00	89.86	88.69	7,683.43	-1,192.42	6,729.12	6,816.31	0.00	0.00	0.00	
14,500.00	89.86	88.69	7,683.68	-1,190.13	6,829.10	6,915.51	0.00	0.00	0.00	
14,600.00	89.86	88.69	7,683.92	-1,187.85	6,929.07	7,014.71	0.00	0.00	0.00	
14,700.00	89.86	88.69	7,684.17	-1,185.56	7,029.04	7,113.91	0.00	0.00	0.00	
14,800.00	89.86	88.69	7,684.42	-1,183.28	7,129.02	7,213.12	0.00	0.00	0.00	
14,900.00	89.86	88.69	7,684.66	-1,180.99	7,228.99	7,312.32	0.00	0.00	0.00	
15,000.00	89.86	88.69	7,684.91	-1,178.71	7,328.96	7,411.52	0.00	0.00	0.00	
15,100.00	89.86	88.69	7,685.15	-1,176.42	7,428.94	7,510.72	0.00	0.00	0.00	

Planning Report

Database:	EDM 5000.16 Single User Db	Local Co-ordinate Reference:	Well COALBANK 5
Company:	BAYSWATER EXPLORATION & PRODUCTION	TVD Reference:	KBE 23' @ 5143.00usft
Project:	WELD COUNTY	MD Reference:	KBE 23' @ 5143.00usft
Site:	SEC 6-T7N-R66W	North Reference:	True
Well:	COALBANK 5	Survey Calculation Method:	Minimum Curvature
Wellbore:	OWB		
Design:	PROPOSAL 1		

Planned Survey										
Measured Depth (usft)	Inclination (°)	Azimuth (°)	Vertical Depth (usft)	+N/-S (usft)	+E/-W (usft)	Vertical Section (usft)	Dogleg Rate (°/100ft)	Build Rate (°/100ft)	Turn Rate (°/100ft)	
15,200.00	89.86	88.69	7,685.40	-1,174.14	7,528.91	7,609.93	0.00	0.00	0.00	
15,300.00	89.86	88.69	7,685.64	-1,171.86	7,628.88	7,709.13	0.00	0.00	0.00	
15,400.00	89.86	88.69	7,685.89	-1,169.57	7,728.86	7,808.33	0.00	0.00	0.00	
15,500.00	89.86	88.69	7,686.13	-1,167.29	7,828.83	7,907.53	0.00	0.00	0.00	
15,600.00	89.86	88.69	7,686.38	-1,165.00	7,928.81	8,006.74	0.00	0.00	0.00	
15,700.00	89.86	88.69	7,686.63	-1,162.72	8,028.78	8,105.94	0.00	0.00	0.00	
15,800.00	89.86	88.69	7,686.87	-1,160.43	8,128.75	8,205.14	0.00	0.00	0.00	
15,900.00	89.86	88.69	7,687.12	-1,158.15	8,228.73	8,304.34	0.00	0.00	0.00	
16,000.00	89.86	88.69	7,687.36	-1,155.86	8,328.70	8,403.55	0.00	0.00	0.00	
16,100.00	89.86	88.69	7,687.61	-1,153.58	8,428.67	8,502.75	0.00	0.00	0.00	
16,200.00	89.86	88.69	7,687.85	-1,151.29	8,528.65	8,601.95	0.00	0.00	0.00	
16,300.00	89.86	88.69	7,688.10	-1,149.01	8,628.62	8,701.16	0.00	0.00	0.00	
16,400.00	89.86	88.69	7,688.35	-1,146.72	8,728.59	8,800.36	0.00	0.00	0.00	
16,500.00	89.86	88.69	7,688.59	-1,144.44	8,828.57	8,899.56	0.00	0.00	0.00	
16,600.00	89.86	88.69	7,688.84	-1,142.15	8,928.54	8,998.76	0.00	0.00	0.00	
16,700.00	89.86	88.69	7,689.08	-1,139.87	9,028.51	9,097.97	0.00	0.00	0.00	
16,800.00	89.86	88.69	7,689.33	-1,137.59	9,128.49	9,197.17	0.00	0.00	0.00	
16,900.00	89.86	88.69	7,689.57	-1,135.30	9,228.46	9,296.37	0.00	0.00	0.00	
17,000.00	89.86	88.69	7,689.82	-1,133.02	9,328.44	9,395.57	0.00	0.00	0.00	
17,100.00	89.86	88.69	7,690.06	-1,130.73	9,428.41	9,494.78	0.00	0.00	0.00	
17,200.00	89.86	88.69	7,690.31	-1,128.45	9,528.38	9,593.98	0.00	0.00	0.00	
17,300.00	89.86	88.69	7,690.56	-1,126.16	9,628.36	9,693.18	0.00	0.00	0.00	
17,400.00	89.86	88.69	7,690.80	-1,123.88	9,728.33	9,792.38	0.00	0.00	0.00	
17,500.00	89.86	88.69	7,691.05	-1,121.59	9,828.30	9,891.59	0.00	0.00	0.00	
17,600.00	89.86	88.69	7,691.29	-1,119.31	9,928.28	9,990.79	0.00	0.00	0.00	
17,700.00	89.86	88.69	7,691.54	-1,117.02	10,028.25	10,089.99	0.00	0.00	0.00	
17,800.00	89.86	88.69	7,691.78	-1,114.74	10,128.22	10,189.19	0.00	0.00	0.00	
17,900.00	89.86	88.69	7,692.03	-1,112.45	10,228.20	10,288.40	0.00	0.00	0.00	
18,000.00	89.86	88.69	7,692.27	-1,110.17	10,328.17	10,387.60	0.00	0.00	0.00	
18,100.00	89.86	88.69	7,692.52	-1,107.89	10,428.15	10,486.80	0.00	0.00	0.00	
18,200.00	89.86	88.69	7,692.77	-1,105.60	10,528.12	10,586.00	0.00	0.00	0.00	
18,295.28	89.86	88.69	7,693.00	-1,103.42	10,623.37	10,680.52	0.00	0.00	0.00	
TD at 18295.28										

Design Targets									
Target Name - hit/miss target - Shape	Dip Angle (°)	Dip Dir. (°)	TVD (usft)	+N/-S (usft)	+E/-W (usft)	Northing (usft)	Easting (usft)	Latitude	Longitude
LP-COALBANK 5 - plan hits target center - Point	0.00	0.00	7,668.00	-1,335.96	447.65	1,461,631.80	3,191,418.87	40.598535°N	104.810679°W
PBHL-COALBANK 5 - plan hits target center - Point	0.00	0.00	7,693.00	-1,103.42	10,623.37	1,461,943.24	3,201,592.23	40.599167°N	104.774036°W

Planning Report

Database:	EDM 5000.16 Single User Db	Local Co-ordinate Reference:	Well COALBANK 5
Company:	BAYSWATER EXPLORATION & PRODUCTION	TVD Reference:	KBE 23' @ 5143.00usft
Project:	WELD COUNTY	MD Reference:	KBE 23' @ 5143.00usft
Site:	SEC 6-T7N-R66W	North Reference:	True
Well:	COALBANK 5	Survey Calculation Method:	Minimum Curvature
Wellbore:	OWB		
Design:	PROPOSAL 1		

Plan Annotations				
Measured Depth (usft)	Vertical Depth (usft)	Local Coordinates		Comment
		+N/-S (usft)	+E/-W (usft)	
100.00	100.00	0.00	0.00	Start Build 2.00
626.04	623.09	-47.92	-4.86	Start 6579.29 hold at 626.04 MD
7,205.33	7,091.77	-1,243.12	-126.04	Start DLS 10.00 TFO -97.01
8,116.87	7,668.00	-1,335.96	447.65	Start 10178.40 hold at 8116.87 MD
18,295.28	7,693.00	-1,103.42	10,623.37	TD at 18295.28