



July 30, 2024

Mr. Drew Stormo
HSE Advisor
Occidental Petroleum Corporation
501 N Division Blvd
Platteville, Colorado 80651

**Subject: Form 4 Sundry Notice – Final Reclamation
Kerr-McGee Oil & Gas Onshore LP (Operator: 47120)
IVERSEN 32-10, Location ID: 392401
SENW S10-T10N-R93W
Moffat County, Colorado**

Dear Mr. Stormo:

Ensolum, LLC (Ensolum) is contracted by Kerr McGee Oil & Gas Onshore LP (Kerr-McGee) to complete final reclamation services at plugged and abandoned (P&A) well sites located in Moffat County, Colorado. The reclamation inspections were conducted in accordance with Colorado Energy and Carbon Management Commission (ECMC) Rule 1004.

FINAL RECLAMATION ASSESMENT FINDINGS

The former IVERSEN 32-10 well (API: 05-081-06927) was P&A'd on January 13, 2015, as identified in Form 6, Document Number 1174583. On July 3, 2024, Ensolum conducted a final reclamation inspection for the former IVERSEN 32-10 well pad (Location ID: 392401) and determined that the site is compliant with final reclamation requirements per ECMC Rule 1004.

The reclaimed well pad was seeded per surface owner request. The reclaimed location is situated in a rangeland per ECMC document number 243489 and has been returned to that land use. A line-point intercept (LPI) vegetation survey was conducted on the reclaimed well pad and on adjacent reference areas for comparison. Desirable, undesirable, and noxious weed occurrences were documented along transects. A total of 50 survey points along a 50-foot transect were recorded within the reclaimed disturbance area and 50 survey points along the one 50-foot transect were recorded within the reference area. This data is included as Attachment 2. Undesirable species, if present, were excluded from the vegetative coverage calculation. Survey results indicate the reclaimed area has achieved desirable vegetative cover that is 80%, which meets the vegetation coverage requirements of 80% according to ECMC rule 1004.d. The associated tank battery remains active, is located 2.9 miles west of the P&A'd well and remains in use servicing other operator wells. A general site location map is included as Figure 1; and the Site Map displaying the location of the reclaimed site on aerial imagery is included as Figure 2. A vegetative analysis by conducting a Line Point Intercept is included as Figure 3. Photographs of

the P&A location were taken facing each cardinal direction from the P&A wellhead location. The photographic log is included as Attachment 1.

Based on rule 1004.d, and the successful reclamation of the IVERSEN 32-10 site, a Form 4 Sundry Notice requesting final reclamation status has been prepared for the submittal to the ECMC. This letter will be included as an attachment to the electronic Form 4 submittal.

If you have any questions or need additional information, please do not hesitate to contact us.

Sincerely,

Ensolum, LLC



Trevor Hartwig
Project Biologist
303-817-2989
thartwig@ensolum.com



Tanna Lyon
Senior Scientist/Biologist
970-509-0947
tlyon@ensolum.com

Attachments:

Figure 1 - Site Location Map
Figure 2 - Site Map
Figure 3 – LPI Data Map
Attachment 1 – Photographic Log
Attachment 2 – LPI Data Sheet

Figure1 – Site Location Map

Path: C:\Users\peter.Rodriguez\OneDrive - ENSOLUM, LLC\Desktop\IAR_GIS\IAR Path Structure\2 - Denver\Kerr-McGee Oil & Gas Onshore, LP\09A1417848 - IVERSEN #32-10\1 - Project\Fig.1_Template\IVERSEN #32-10.aprx

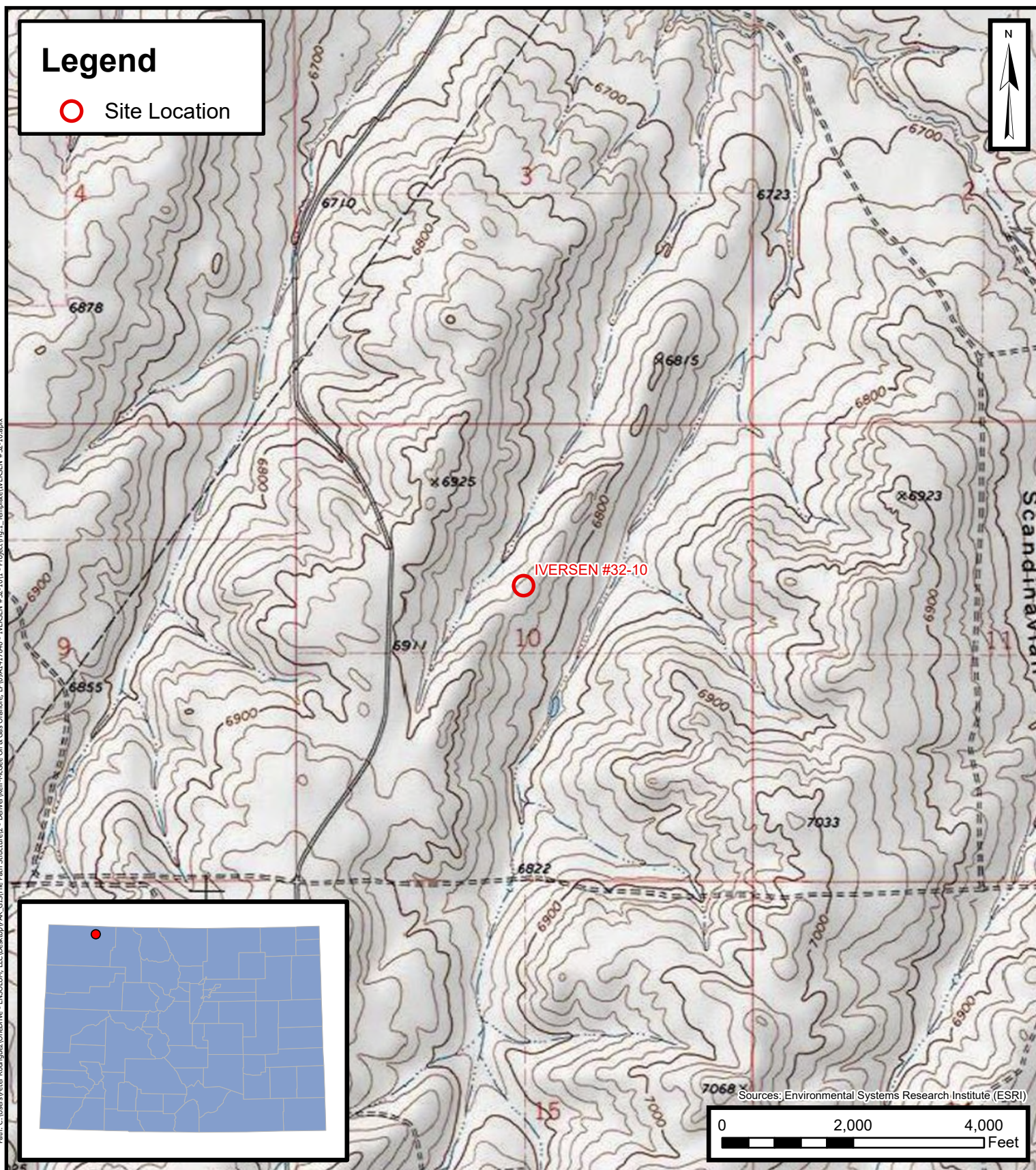

Figure 2 – Site Map

Legend

- Plugged & Abandoned Wellhead



IVERSEN #32-10
API: 05-081-06927

0 100 200
Feet

Sources:
Bing Maps



Site Map

IVERSEN #32-10
KERR-MCGEE OIL & GAS ONSHORE, LP
SENW-S10-T10N-93W
Moffat County, Colorado

Project Number: 09A1417848

FIGURE

2

Figure 3 –
LPI Data Map

Legend

- IVERSEN #32-10
Well LPI Off
- IVERSEN #32-10
Well LPI On



IVERSEN #32-10 Well LPI
80% native and 20% bare ground

End:
40.843345, -107.820972

Start:
40.843128, -107.821023

IVERSEN 32-10 Well LPI Reference
52% native and 48% bare ground

Start:
40.842222, -104.821483

End:
40.842289, -107.821325

0 100 200
Feet

Sources:
Bing Maps

LPI Data Well Location

IVERSEN #32-10
KERR-MCGEE OIL & GAS ONSHORE, LP
SENW-S10-T10N-93W
Moffat County, Colorado

Project Number: 09A1417848

FIGURE

3





ATTACHMENT 1

Photographic Log

| RECLAMATION PHOTOGRAPHIC LOG | | |
|--|--|--|
| Kerr McGee Oil & Gas Onshore LP - 47120 | IVERSEN #32-10 Weld County, Colorado | Location ID: 392401 API: 05-081-06927 |
| Date: July 3, 2024 | Photo No. 1 - North | P&A Well Stake Lat/Long: 40.842933, -107.820721 |
| <div> <div> <div>NW</div> <div>N</div> <div>NE</div> <div>E</div> </div> <div> <div>300</div> <div>330</div> <div>0</div> <div>30</div> <div>60</div> <div>90</div> </div> <div> <div>8°N (T)</div> <div>40°50'34"N, 107°49'14"W ±16ft</div> <div>▲ 6871ft</div> </div> </div> <div> <div>Well facing north</div> <div>IVERSEN #32-10 03 Jul 2024, 12:18:34</div> </div> | | |
| View facing north as required in the Colorado Energy & Carbon Management Commission (ECMC) Rule 1004. | | |

| RECLAMATION PHOTOGRAPHIC LOG | | |
|--|--|--|
| Kerr McGee Oil & Gas Onshore LP - 47120 | IVERSEN #32-10 Weld County, Colorado | Location ID: 392401 API: 05-081-06927 |
| Date: July 3, 2024 | Photo No. 2 - South | P&A Well Stake Lat/Long: 40.842933, -107.820721 |
| <div> <div> <div>E</div> <div>SE</div> <div>S</div> <div>SW</div> <div>W</div> </div> <div> <div>90</div> <div>120</div> <div>150</div> <div>180</div> <div>210</div> <div>240</div> <div>270</div> </div> <div> <div>183°S (T)</div> <div>40°50'34"N, 107°49'14"W ±16ft</div> <div>▲ 6861ft</div> </div> </div> <div> <div>Well facing south</div> <div>IVERSEN #32-10 03 Jul 2024, 12:15:45</div> </div> | | |
| View facing south as required in the Colorado Energy & Carbon Management Commission (ECMC) Rule 1004. | | |

| RECLAMATION PHOTOGRAPHIC LOG | | |
|---|--|--|
| Kerr McGee Oil & Gas Onshore LP - 47120 | IVERSEN #32-10 Weld County, Colorado | Location ID: 392401 API: 05-081-06927 |
| Date: July 3, 2024 | Photo No. 3 - East | P&A Well Stake Lat/Long: 40.842933, -107.820721 |
| <div> <div> <div>N</div> <div>NE</div> <div>E</div> <div>SE</div> <div>S</div> </div> <div> <div>0</div> <div>30</div> <div>60</div> <div>90</div> <div>120</div> <div>150</div> <div>180</div> </div> </div> <div> <div>☉ 91°E (T) ☉ 40°50'34"N, 107°49'14"W ±16ft ▲ 6860ft</div> <div>  <div>Well facing east</div> <div>IVERSON #32-10 03 Jul 2024, 12:15:21</div> </div> </div> | | |
| View facing east as required in the Colorado Energy & Carbon Management Commission (ECMC) Rule 1004. | | |

| RECLAMATION PHOTOGRAPHIC LOG | | |
|--|--|--|
| Kerr McGee Oil & Gas Onshore LP - 47120 | IVERSEN #32-10 Weld County, Colorado | Location ID: 392401 API: 05-081-06927 |
| Date: July 3, 2024 | Photo No. 4 - West | P&A Well Stake Lat/Long: 40.842933, -107.820721 |
| <div> <div> <div>S</div> <div>SW</div> <div>W</div> <div>NW</div> <div>N</div> </div> <div> <div>210</div> <div>240</div> <div>270</div> <div>300</div> <div>330</div> <div>0</div> </div> </div> <div> <div>☉ 275°W (T) ☉ 40°50'34"N, 107°49'14"W ±16ft ▲ 6864ft</div> <div>  <div>Well facing west</div> <div>IVERSON #32-10 03 Jul 2024, 12:16:16</div> </div> </div> | | |
| View facing west as required in the Colorado Energy & Carbon Management Commission (ECMC) Rule 1004. | | |

RECLAMATION PHOTOGRAPHIC LOG

Kerr McGee Oil & Gas
Onshore LP - 47120

IVERSEN #32-10
Weld County, Colorado

Location ID: 392401
API: 05-081-06927

Date: July 3, 2024

Photo No. 5 – Overall Site

P&A Well Stake Lat/Long:
40.842933, -107.820721

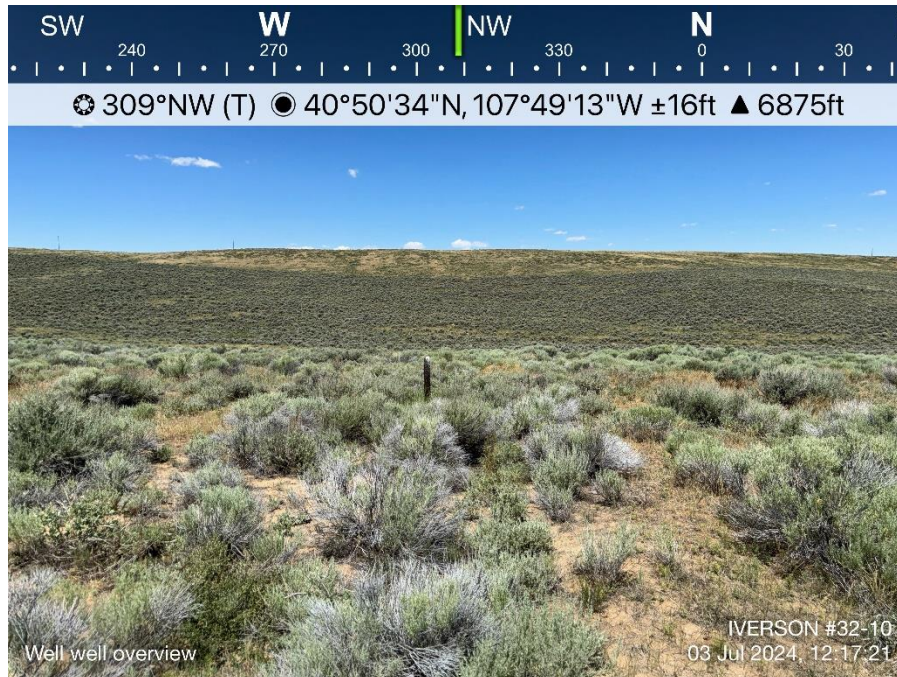

Overall site view as required in the Colorado Energy & Carbon Management Commission (ECMC) Rule 1004.

RECLAMATION PHOTOGRAPHIC LOG

Kerr McGee Oil & Gas
Onshore LP - 47120

IVERSEN #32-10
Weld County, Colorado

Location ID: 392401
API: 05-081-06927

Date: July 3, 2024

**Photo No. 6 –
Overall Active Tank Battery**

P&A Well Stake Lat/Long:
40.842933, -107.820721



Overall active tank battery view as required in the Colorado Energy & Carbon Management Commission (ECMC) Rule 1004.

ATTACHMENT 2

LPI Data Sheet

Line-point Intercept Data Form

Page 1 of 2

Shaded cells for calculations

Plot: Iverson 32-10 Line #: 1 Observer: Trevor H Recorder: Trevor H

Direction: 30° Date: 7/3/24 Intercept (Point) Spacing Interval = cm (12 in)

| Pt. | Top layer | Lower layers | | | Soil surface | Pt. | Top layer | Lower layers | | | Soil surface |
|-----|-----------|--------------|--------|--------|--------------|-----|-----------|--------------|--------|--------|--------------|
| | | Code 1 | Code 2 | Code 3 | | | | Code 1 | Code 2 | Code 3 | |
| 1 | ARTR2 | | | | | 26 | ARTR2 | | | | |
| 2 | None | | | | | 27 | ARTR2 | | | | |
| 3 | None | | | | | 28 | None | | | | |
| 4 | None | | | | | 29 | ARTR2 | | | | |
| 5 | ARTR2 | | | | | 30 | None | | | | |
| 6 | ERNA10 | | | | | 31 | ARTR2 | | | | |
| 7 | None | | | | | 32 | ARTR2 | | | | |
| 8 | ERNA10 | | | | | 33 | ARTR2 | | | | |
| 9 | ERNA10 | | | | | 34 | ARTR2 | | | | |
| 10 | ERNA10 | | | | | 35 | ARTR2 | | | | |
| 11 | ERNA10 | | | | | 36 | ARTR2 | | | | |
| 12 | ERNA10 | | | | | 37 | ARTR2 | | | | |
| 13 | ERNA10 | | | | | 38 | ERNA10 | | | | |
| 14 | ERNA10 | | | | | 39 | ERNA10 | | | | |
| 15 | ERNA10 | | | | | 40 | LOPE | | | | |
| 16 | ERNA10 | | | | | 41 | ERNA10 | | | | |
| 17 | ARTR2 | | | | | 42 | ERNA10 | | | | |
| 18 | ARTR2 | | | | | 43 | LOPE | | | | |
| 19 | ARTR2 | | | | | 44 | ERNA10 | | | | |
| 20 | ERNA10 | | | | | 45 | None | | | | |
| 21 | None | | | | | 46 | ARTR2 | | | | |
| 22 | None | | | | | 47 | ARTR2 | | | | |
| 23 | ERNA10 | | | | | 48 | ARTR2 | | | | |
| 24 | ARTR2 | | | | | 49 | ARTR2 | | | | |
| 25 | ARTR2 | | | | | 50 | ARTR2 | | | | |

% foliar cover = $\frac{40}{100}$ top layer pts (1st col) $\times 2 = 80\%$
 % bare ground* = $\frac{10}{100}$ pts (w/NONE over S) $\times 2 = 20\%$
 % basal cover = $\frac{\quad}{100}$ plant base pts (last col) $\times 2 = \quad\%$

Top layer codes: Species code, common name, or NONE (no cover).

Lower layers codes: Species code, common name, L (herbaceous litter), WL (woody litter, >5 mm (~1/4 in) diameter).

Unknown Species Codes:

AF# = annual forb
 PF# = perennial forb
 AG# = annual graminoid
 PG# = perennial graminoid
 SH# = shrub
 TR# = tree

Soil Surface (do not use litter):

Species Code (for basal intercept)
 R = rock fragment (>5 mm (~1/4 in) diameter)
 BR = bedrock, M = moss
 LC = visible biotic crust on soil
 S = soil without any other soil surface code
 EL = embedded litter (see page 10)
 D = duff

*Bare ground occurs ONLY when Top layer = NONE, Lower layers are empty (no L), and Soil surface = S.

Desirable: 80%
 Undesirable: 0%
 Noxious Weeds: 0%

Line-point Intercept Data Form

Page 2 of 2

Shaded cells for calculations

Plot: IVERSON 32-10 Line #: 2 Observer: _____ Recorder: _____

Direction: 270° Date: 7/3/24 Intercept (Point) Spacing Interval = _____ cm (12 in)

| Pt. | Top layer | Lower layers | | | Soil surface | Pt. | Top layer | Lower layers | | | Soil surface |
|-----|-----------|--------------|--------|--------|--------------|-----|-----------|--------------|--------|--------|--------------|
| | | Code 1 | Code 2 | Code 3 | | | | Code 1 | Code 2 | Code 3 | |
| 1 | VUOCO | | | | | 26 | ARTR2 | | | | |
| 2 | None | | | | | 27 | None | | | | |
| 3 | None | | | | | 28 | None | | | | |
| 4 | None | | | | | 29 | ERNA10 | | | | |
| 5 | None | | | | | 30 | None | | | | |
| 6 | VUOCO | | | | | 31 | None | | | | |
| 7 | ARTR2 | | | | | 32 | VUOCO | | | | |
| 8 | VUOCO | | | | | 33 | ARTR2 | | | | |
| 9 | ERNA10 | | | | | 34 | ARTR2 | | | | |
| 10 | None | | | | | 35 | None | | | | |
| 11 | ARTR2 | | | | | 36 | VUOCO | | | | |
| 12 | ARTR2 | | | | | 37 | None | | | | |
| 13 | None | | | | | 38 | None | | | | |
| 14 | ERNA10 | | | | | 39 | ARTR2 | | | | |
| 15 | None | | | | | 40 | None | | | | |
| 16 | ARTR2 | | | | | 41 | VUOCO | | | | |
| 17 | ARTR2 | | | | | 42 | VUOCO | | | | |
| 18 | ARTR2 | | | | | 43 | VUOCO | | | | |
| 19 | VUOCO | | | | | 44 | VUOCO | | | | |
| 20 | ARTR2 | | | | | 45 | None | | | | |
| 21 | None | | | | | 46 | None | | | | |
| 22 | None | | | | | 47 | ERNA10 | | | | |
| 23 | None | | | | | 48 | None | | | | |
| 24 | None | | | | | 49 | None | | | | |
| 25 | ARTR2 | | | | | 50 | None | | | | |

% foliar cover = 26 top layer pts (1st col) x 2 = 52 %
 % bare ground* = 24 pts (w/NONE over S) x 2 = 48 %
 % basal cover = _____ plant base pts (last col) x 2 = _____ %

Top layer codes: Species code, common name, or NONE (no cover).

Lower layers codes: Species code, common name, L (herbaceous litter), WL (woody litter, >5 mm (~1/4 in) diameter).

Unknown Species Codes:

AF# = annual forb
 PF# = perennial forb
 AG# = annual graminoid
 PG# = perennial graminoid
 SH# = shrub
 TR# = tree

Soil Surface (do not use litter):

Species Code (for basal intercept)
 R = rock fragment (>5 mm (~1/4 in) diameter)
 BR = bedrock, M = moss
 LC = visible biotic crust on soil
 S = soil without any other soil surface code
 EL = embedded litter (see page 10)
 D = duff

*Bare ground occurs ONLY when Top layer = NONE, Lower layers are empty (no L), and Soil surface = S.