

# **BAYSWATER EXPLORATION & PRODUCTION**

**WELD COUNTY  
SEC 6-T7N-R66W  
OPAL 6**

**OWB**

**Plan: PROPOSAL 1**

## **Standard Planning Report**

**28 July, 2024**

Project: WELD COUNTY  
Site: SEC 6-T7N-R66W  
Well: OPAL 6  
Wellbore: OWB  
Design: PROPOSAL 1

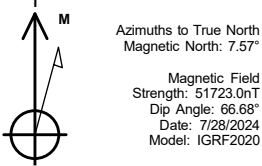

WELL DETAILS: OPAL 6

+N/-S	+E/-W	Northing	Easting	5119.00 Latitude	Longitude	Slot
0.00	0.00	1462951.53	3190969.30	40.602167°N	104.812261°W	

ANNOTATIONS

MD	Inc	Azi	TVD	+N/-S	+E/-W	VSect	Departure	Annotation
100.00	0.00	0.00	100.00	0.00	0.00	0.00	0.00	Start Build 2.00
813.11	14.26	154.71	805.77	-79.84	37.72	-23.61	88.30	Start 6306.11 hold at 813.11 MD
7119.22	14.26	154.71	6917.51	-1484.56	701.32	-439.11	1641.88	Start DLS 10.00 TFO 113.04
8106.45	92.96	269.09	7530.00	-1643.82	104.97	175.62	2294.36	Start 10639.52 hold at 8106.45 MD
18745.97	92.96	269.09	6980.00	-1812.08	-10518.99	10673.93	12919.65	TD at 18745.97

SECTION DETAILS

Sec	MD	Inc	Azi	TVD	+N/-S	+E/-W	Dleg	TFace	VSect	Target
1	0.00	0.00	0.00	0.00	0.00	0.00	0.00	0.00	0.00	
2	100.00	0.00	0.00	100.00	0.00	0.00	0.00	0.00	0.00	
3	813.11	14.26	154.71	805.77	-79.84	37.72	2.00	154.71	-23.61	
4	7119.22	14.26	154.71	6917.51	-1484.56	701.32	0.00	0.00	-439.11	
5	8106.45	92.96	269.09	7530.00	-1643.82	104.97	10.00	113.04	175.62	LP-C
6	18745.97	92.96	269.09	6980.00	-1812.08	-10518.99	0.00	0.00	10673.93	PBH

DESIGN TARGET DETAILS

Name	TVD	+N/-S	+E/-W	Northing	Easting	Latitude	Longitude	Shape
PBHL-OPAL 6	6980.00	-1812.08	-10518.99	1461057.97	3180464.95	40.597187°N	104.850139°W	Point
- plan hits target center								
LP-OPAL 6	7530.00	-1643.82	104.97	1461308.61	3191087.02	40.597655°N	104.811883°W	Point
- plan hits target center								

PROJECT DETAILS: WELD COUNTY

Geodetic System: US State Plane 1983  
Datum: North American Datum 1983  
Ellipsoid: GRS 1980  
Zone: Colorado Northern Zone  
System Datum: Mean Sea Level

SHL:  
2100' FSL, 337' FEL  
Sec 6-T7N-R66W

LP:  
454' FSL, 160' FEL  
Sec 6-T7N-R66W

BHL:  
454' FSL, 160' FWL  
Sec 1-T7N-R67W

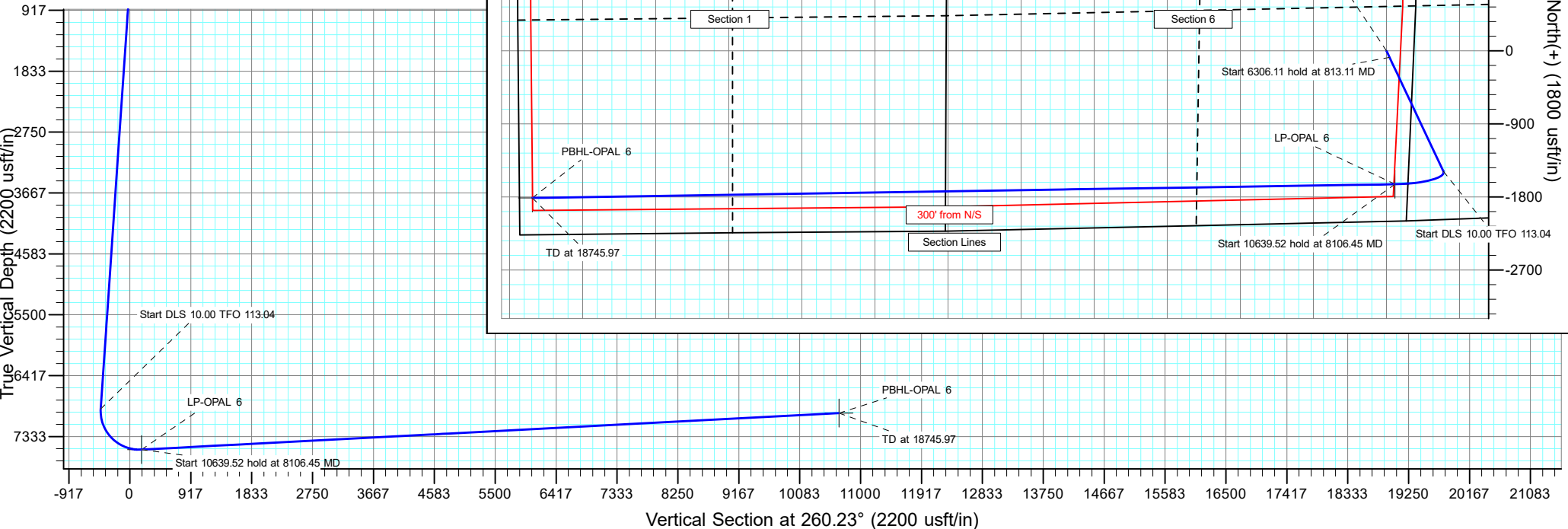

## Planning Report

<b>Database:</b>	EDM 5000.16 Single User Db	<b>Local Co-ordinate Reference:</b>	Well OPAL 6
<b>Company:</b>	BAYSWATER EXPLORATION & PRODUCTION	<b>TVD Reference:</b>	KBE 23' @ 5142.00usft
<b>Project:</b>	WELD COUNTY	<b>MD Reference:</b>	KBE 23' @ 5142.00usft
<b>Site:</b>	SEC 6-T7N-R66W	<b>North Reference:</b>	True
<b>Well:</b>	OPAL 6	<b>Survey Calculation Method:</b>	Minimum Curvature
<b>Wellbore:</b>	OWB		
<b>Design:</b>	PROPOSAL 1		

<b>Project</b>	WELD COUNTY		
<b>Map System:</b>	US State Plane 1983	<b>System Datum:</b>	Mean Sea Level
<b>Geo Datum:</b>	North American Datum 1983		
<b>Map Zone:</b>	Colorado Northern Zone		Using geodetic scale factor

<b>Site</b>	SEC 6-T7N-R66W		
<b>Site Position:</b>		<b>Northing:</b>	1,460,687.83 usft
<b>From:</b>	Lat/Long	<b>Easting:</b>	3,185,555.14 usft
<b>Position Uncertainty:</b>	0.00 usft	<b>Slot Radius:</b>	13.200 in
		<b>Latitude:</b>	40.596067°N
		<b>Longitude:</b>	104.831820°W

Well		OPAL 6				
Well Position	+N/-S	0.00 usft	Northing:	1,462,951.54 usft	Latitude:	40.602167°N
	+E/-W	0.00 usft	Easting:	3,190,969.31 usft	Longitude:	104.812261°W
Position Uncertainty		0.00 usft	Wellhead Elevation:	usft	Ground Level:	5,119.00 usft
Grid Convergence:		0.44 °				

<b>Wellbore</b>	OWB				
<b>Magnetics</b>	<b>Model Name</b>	<b>Sample Date</b>	<b>Declination (°)</b>	<b>Dip Angle (°)</b>	<b>Field Strength (nT)</b>
	IGRF2020	7/28/2024	7.57	66.68	51,723.00610821

<b>Design</b>	PROPOSAL 1			
<b>Audit Notes:</b>				
<b>Version:</b>	<b>Phase:</b>	PROTOTYPE	<b>Tie On Depth:</b>	0.00
<b>Vertical Section:</b>	<b>Depth From (TVD) (usft)</b>	<b>+N/-S (usft)</b>	<b>+E/-W (usft)</b>	<b>Direction (°)</b>
	0.00	0.00	0.00	260.23

<b>Plan Survey Tool Program</b>	<b>Date</b>	7/28/2024		
<b>Depth From (usft)</b>	<b>Depth To (usft)</b>	<b>Survey (Wellbore)</b>	<b>Tool Name</b>	<b>Remarks</b>
1	0.00	18,745.97	PROPOSAL 1 (OWB)	MWD
				OWSG MWD - Standard

<b>Plan Sections</b>										
<b>Measured Depth (usft)</b>	<b>Inclination (°)</b>	<b>Azimuth (°)</b>	<b>Vertical Depth (usft)</b>	<b>+N/-S (usft)</b>	<b>+E/-W (usft)</b>	<b>Dogleg Rate (°/100ft)</b>	<b>Build Rate (°/100ft)</b>	<b>Turn Rate (°/100ft)</b>	<b>TFO (°)</b>	<b>Target</b>
0.00	0.00	0.00	0.00	0.00	0.00	0.00	0.00	0.00	0.00	
100.00	0.00	0.00	100.00	0.00	0.00	0.00	0.00	0.00	0.00	
813.11	14.26	154.71	805.77	-79.84	37.72	2.00	2.00	0.00	154.71	
7,119.22	14.26	154.71	6,917.52	-1,484.56	701.32	0.00	0.00	0.00	0.00	
8,106.45	92.96	269.09	7,530.00	-1,643.82	104.97	10.00	7.97	11.59	113.04	LP-OPAL 6
18,745.97	92.96	269.09	6,980.00	-1,812.08	-10,518.99	0.00	0.00	0.00	0.00	PBHL-OPAL 6

# Planning Report

<b>Database:</b>	EDM 5000.16 Single User Db	<b>Local Co-ordinate Reference:</b>	Well OPAL 6
<b>Company:</b>	BAYSWATER EXPLORATION & PRODUCTION	<b>TVD Reference:</b>	KBE 23' @ 5142.00usft
<b>Project:</b>	WELD COUNTY	<b>MD Reference:</b>	KBE 23' @ 5142.00usft
<b>Site:</b>	SEC 6-T7N-R66W	<b>North Reference:</b>	True
<b>Well:</b>	OPAL 6	<b>Survey Calculation Method:</b>	Minimum Curvature
<b>Wellbore:</b>	OWB		
<b>Design:</b>	PROPOSAL 1		

Planned Survey									
Measured Depth (usft)	Inclination (°)	Azimuth (°)	Vertical Depth (usft)	+N/-S (usft)	+E/-W (usft)	Vertical Section (usft)	Dogleg Rate (°/100ft)	Build Rate (°/100ft)	Turn Rate (°/100ft)
0.00	0.00	0.00	0.00	0.00	0.00	0.00	0.00	0.00	0.00
100.00	0.00	0.00	100.00	0.00	0.00	0.00	0.00	0.00	0.00
Start Build 2.00									
200.00	2.00	154.71	199.98	-1.58	0.75	-0.47	2.00	2.00	0.00
300.00	4.00	154.71	299.84	-6.31	2.98	-1.87	2.00	2.00	0.00
400.00	6.00	154.71	399.45	-14.19	6.70	-4.20	2.00	2.00	0.00
500.00	8.00	154.71	498.70	-25.21	11.91	-7.46	2.00	2.00	0.00
600.00	10.00	154.71	597.47	-39.35	18.59	-11.64	2.00	2.00	0.00
700.00	12.00	154.71	695.62	-56.60	26.74	-16.74	2.00	2.00	0.00
800.00	14.00	154.71	793.06	-76.94	36.35	-22.76	2.00	2.00	0.00
813.11	14.26	154.71	805.77	-79.84	37.72	-23.61	2.00	2.00	0.00
Start 6306.11 hold at 813.11 MD									
900.00	14.26	154.71	889.98	-99.19	46.86	-29.34	0.00	0.00	0.00
1,000.00	14.26	154.71	986.90	-121.47	57.38	-35.93	0.00	0.00	0.00
1,100.00	14.26	154.71	1,083.82	-143.74	67.91	-42.52	0.00	0.00	0.00
1,200.00	14.26	154.71	1,180.73	-166.02	78.43	-49.11	0.00	0.00	0.00
1,300.00	14.26	154.71	1,277.65	-188.29	88.95	-55.69	0.00	0.00	0.00
1,400.00	14.26	154.71	1,374.57	-210.57	99.47	-62.28	0.00	0.00	0.00
1,500.00	14.26	154.71	1,471.49	-232.85	110.00	-68.87	0.00	0.00	0.00
1,600.00	14.26	154.71	1,568.41	-255.12	120.52	-75.46	0.00	0.00	0.00
1,700.00	14.26	154.71	1,665.32	-277.40	131.04	-82.05	0.00	0.00	0.00
1,800.00	14.26	154.71	1,762.24	-299.67	141.57	-88.64	0.00	0.00	0.00
1,900.00	14.26	154.71	1,859.16	-321.95	152.09	-95.23	0.00	0.00	0.00
2,000.00	14.26	154.71	1,956.08	-344.22	162.61	-101.82	0.00	0.00	0.00
2,100.00	14.26	154.71	2,052.99	-366.50	173.14	-108.40	0.00	0.00	0.00
2,200.00	14.26	154.71	2,149.91	-388.77	183.66	-114.99	0.00	0.00	0.00
2,300.00	14.26	154.71	2,246.83	-411.05	194.18	-121.58	0.00	0.00	0.00
2,400.00	14.26	154.71	2,343.75	-433.33	204.71	-128.17	0.00	0.00	0.00
2,500.00	14.26	154.71	2,440.67	-455.60	215.23	-134.76	0.00	0.00	0.00
2,600.00	14.26	154.71	2,537.58	-477.88	225.75	-141.35	0.00	0.00	0.00
2,700.00	14.26	154.71	2,634.50	-500.15	236.28	-147.94	0.00	0.00	0.00
2,800.00	14.26	154.71	2,731.42	-522.43	246.80	-154.53	0.00	0.00	0.00
2,900.00	14.26	154.71	2,828.34	-544.70	257.32	-161.11	0.00	0.00	0.00
3,000.00	14.26	154.71	2,925.25	-566.98	267.85	-167.70	0.00	0.00	0.00
3,100.00	14.26	154.71	3,022.17	-589.25	278.37	-174.29	0.00	0.00	0.00
3,200.00	14.26	154.71	3,119.09	-611.53	288.89	-180.88	0.00	0.00	0.00
3,300.00	14.26	154.71	3,216.01	-633.81	299.41	-187.47	0.00	0.00	0.00
3,400.00	14.26	154.71	3,312.93	-656.08	309.94	-194.06	0.00	0.00	0.00
3,500.00	14.26	154.71	3,409.84	-678.36	320.46	-200.65	0.00	0.00	0.00
3,600.00	14.26	154.71	3,506.76	-700.63	330.98	-207.24	0.00	0.00	0.00
3,700.00	14.26	154.71	3,603.68	-722.91	341.51	-213.82	0.00	0.00	0.00
3,800.00	14.26	154.71	3,700.60	-745.18	352.03	-220.41	0.00	0.00	0.00
3,900.00	14.26	154.71	3,797.51	-767.46	362.55	-227.00	0.00	0.00	0.00
4,000.00	14.26	154.71	3,894.43	-789.73	373.08	-233.59	0.00	0.00	0.00
4,100.00	14.26	154.71	3,991.35	-812.01	383.60	-240.18	0.00	0.00	0.00
4,200.00	14.26	154.71	4,088.27	-834.29	394.12	-246.77	0.00	0.00	0.00
4,300.00	14.26	154.71	4,185.19	-856.56	404.65	-253.36	0.00	0.00	0.00
4,400.00	14.26	154.71	4,282.10	-878.84	415.17	-259.95	0.00	0.00	0.00
4,500.00	14.26	154.71	4,379.02	-901.11	425.69	-266.53	0.00	0.00	0.00
4,600.00	14.26	154.71	4,475.94	-923.39	436.22	-273.12	0.00	0.00	0.00
4,700.00	14.26	154.71	4,572.86	-945.66	446.74	-279.71	0.00	0.00	0.00
4,800.00	14.26	154.71	4,669.78	-967.94	457.26	-286.30	0.00	0.00	0.00
4,900.00	14.26	154.71	4,766.69	-990.21	467.79	-292.89	0.00	0.00	0.00

# Planning Report

<b>Database:</b>	EDM 5000.16 Single User Db	<b>Local Co-ordinate Reference:</b>	Well OPAL 6
<b>Company:</b>	BAYSWATER EXPLORATION & PRODUCTION	<b>TVD Reference:</b>	KBE 23' @ 5142.00usft
<b>Project:</b>	WELD COUNTY	<b>MD Reference:</b>	KBE 23' @ 5142.00usft
<b>Site:</b>	SEC 6-T7N-R66W	<b>North Reference:</b>	True
<b>Well:</b>	OPAL 6	<b>Survey Calculation Method:</b>	Minimum Curvature
<b>Wellbore:</b>	OWB		
<b>Design:</b>	PROPOSAL 1		

Planned Survey										
Measured Depth (usft)	Inclination (°)	Azimuth (°)	Vertical Depth (usft)	+N/-S (usft)	+E/-W (usft)	Vertical Section (usft)	Dogleg Rate (°/100ft)	Build Rate (°/100ft)	Turn Rate (°/100ft)	
5,000.00	14.26	154.71	4,863.61	-1,012.49	478.31	-299.48	0.00	0.00	0.00	
5,100.00	14.26	154.71	4,960.53	-1,034.77	488.83	-306.07	0.00	0.00	0.00	
5,200.00	14.26	154.71	5,057.45	-1,057.04	499.35	-312.66	0.00	0.00	0.00	
5,300.00	14.26	154.71	5,154.36	-1,079.32	509.88	-319.24	0.00	0.00	0.00	
5,400.00	14.26	154.71	5,251.28	-1,101.59	520.40	-325.83	0.00	0.00	0.00	
5,500.00	14.26	154.71	5,348.20	-1,123.87	530.92	-332.42	0.00	0.00	0.00	
5,600.00	14.26	154.71	5,445.12	-1,146.14	541.45	-339.01	0.00	0.00	0.00	
5,700.00	14.26	154.71	5,542.04	-1,168.42	551.97	-345.60	0.00	0.00	0.00	
5,800.00	14.26	154.71	5,638.95	-1,190.69	562.49	-352.19	0.00	0.00	0.00	
5,900.00	14.26	154.71	5,735.87	-1,212.97	573.02	-358.78	0.00	0.00	0.00	
6,000.00	14.26	154.71	5,832.79	-1,235.25	583.54	-365.37	0.00	0.00	0.00	
6,100.00	14.26	154.71	5,929.71	-1,257.52	594.06	-371.95	0.00	0.00	0.00	
6,200.00	14.26	154.71	6,026.62	-1,279.80	604.59	-378.54	0.00	0.00	0.00	
6,300.00	14.26	154.71	6,123.54	-1,302.07	615.11	-385.13	0.00	0.00	0.00	
6,400.00	14.26	154.71	6,220.46	-1,324.35	625.63	-391.72	0.00	0.00	0.00	
6,500.00	14.26	154.71	6,317.38	-1,346.62	636.16	-398.31	0.00	0.00	0.00	
6,600.00	14.26	154.71	6,414.30	-1,368.90	646.68	-404.90	0.00	0.00	0.00	
6,700.00	14.26	154.71	6,511.21	-1,391.17	657.20	-411.49	0.00	0.00	0.00	
6,800.00	14.26	154.71	6,608.13	-1,413.45	667.72	-418.08	0.00	0.00	0.00	
6,900.00	14.26	154.71	6,705.05	-1,435.73	678.25	-424.66	0.00	0.00	0.00	
7,000.00	14.26	154.71	6,801.97	-1,458.00	688.77	-431.25	0.00	0.00	0.00	
7,100.00	14.26	154.71	6,898.88	-1,480.28	699.29	-437.84	0.00	0.00	0.00	
7,119.22	14.26	154.71	6,917.52	-1,484.56	701.32	-439.11	0.00	0.00	0.00	
Start DLS 10.00 TFO 113.04										
7,200.00	13.32	188.86	6,996.09	-1,502.78	704.14	-438.80	10.00	-1.17	42.28	
7,300.00	17.96	222.52	7,092.55	-1,525.58	691.91	-422.87	10.00	4.65	33.65	
7,400.00	25.78	239.59	7,185.38	-1,548.01	662.66	-390.24	10.00	7.81	17.07	
7,500.00	34.68	248.74	7,271.74	-1,569.39	617.28	-341.89	10.00	8.90	9.16	
7,600.00	44.01	254.46	7,349.02	-1,589.06	557.15	-279.29	10.00	9.33	5.72	
7,700.00	53.54	258.50	7,414.86	-1,606.43	484.09	-204.35	10.00	9.53	4.04	
7,800.00	63.17	261.64	7,467.27	-1,620.98	400.33	-119.33	10.00	9.64	3.14	
7,900.00	72.87	264.29	7,504.66	-1,632.25	308.41	-26.83	10.00	9.70	2.65	
8,000.00	82.60	266.67	7,525.88	-1,639.90	211.12	70.35	10.00	9.73	2.38	
8,100.00	92.34	268.95	7,530.30	-1,643.71	111.41	169.25	10.00	9.74	2.28	
8,106.45	92.96	269.09	7,530.00	-1,643.82	104.97	175.62	10.00	9.74	2.27	
Start 10639.52 hold at 8106.45 MD										
8,200.00	92.96	269.09	7,525.16	-1,645.30	11.56	267.93	0.00	0.00	0.00	
8,300.00	92.96	269.09	7,519.99	-1,646.88	-88.29	366.60	0.00	0.00	0.00	
8,400.00	92.96	269.09	7,514.83	-1,648.46	-188.15	465.27	0.00	0.00	0.00	
8,500.00	92.96	269.09	7,509.66	-1,650.05	-288.00	563.94	0.00	0.00	0.00	
8,600.00	92.96	269.09	7,504.49	-1,651.63	-387.86	662.62	0.00	0.00	0.00	
8,700.00	92.96	269.09	7,499.32	-1,653.21	-487.71	761.29	0.00	0.00	0.00	
8,800.00	92.96	269.09	7,494.15	-1,654.79	-587.56	859.96	0.00	0.00	0.00	
8,900.00	92.96	269.09	7,488.98	-1,656.37	-687.42	958.64	0.00	0.00	0.00	
9,000.00	92.96	269.09	7,483.81	-1,657.95	-787.27	1,057.31	0.00	0.00	0.00	
9,100.00	92.96	269.09	7,478.64	-1,659.53	-887.13	1,155.98	0.00	0.00	0.00	
9,200.00	92.96	269.09	7,473.47	-1,661.12	-986.98	1,254.65	0.00	0.00	0.00	
9,300.00	92.96	269.09	7,468.30	-1,662.70	-1,086.83	1,353.33	0.00	0.00	0.00	
9,400.00	92.96	269.09	7,463.13	-1,664.28	-1,186.69	1,452.00	0.00	0.00	0.00	
9,500.00	92.96	269.09	7,457.96	-1,665.86	-1,286.54	1,550.67	0.00	0.00	0.00	
9,600.00	92.96	269.09	7,452.79	-1,667.44	-1,386.39	1,649.35	0.00	0.00	0.00	
9,700.00	92.96	269.09	7,447.62	-1,669.02	-1,486.25	1,748.02	0.00	0.00	0.00	
9,800.00	92.96	269.09	7,442.45	-1,670.60	-1,586.10	1,846.69	0.00	0.00	0.00	

## Planning Report

<b>Database:</b>	EDM 5000.16 Single User Db	<b>Local Co-ordinate Reference:</b>	Well OPAL 6
<b>Company:</b>	BAYSWATER EXPLORATION & PRODUCTION	<b>TVD Reference:</b>	KBE 23' @ 5142.00usft
<b>Project:</b>	WELD COUNTY	<b>MD Reference:</b>	KBE 23' @ 5142.00usft
<b>Site:</b>	SEC 6-T7N-R66W	<b>North Reference:</b>	True
<b>Well:</b>	OPAL 6	<b>Survey Calculation Method:</b>	Minimum Curvature
<b>Wellbore:</b>	OWB		
<b>Design:</b>	PROPOSAL 1		

Planned Survey										
Measured Depth (usft)	Inclination (°)	Azimuth (°)	Vertical Depth (usft)	+N/-S (usft)	+E/-W (usft)	Vertical Section (usft)	Dogleg Rate (°/100ft)	Build Rate (°/100ft)	Turn Rate (°/100ft)	
9,900.00	92.96	269.09	7,437.28	-1,672.19	-1,685.96	1,945.36	0.00	0.00	0.00	
10,000.00	92.96	269.09	7,432.11	-1,673.77	-1,785.81	2,044.04	0.00	0.00	0.00	
10,100.00	92.96	269.09	7,426.95	-1,675.35	-1,885.66	2,142.71	0.00	0.00	0.00	
10,200.00	92.96	269.09	7,421.78	-1,676.93	-1,985.52	2,241.38	0.00	0.00	0.00	
10,300.00	92.96	269.09	7,416.61	-1,678.51	-2,085.37	2,340.06	0.00	0.00	0.00	
10,400.00	92.96	269.09	7,411.44	-1,680.09	-2,185.22	2,438.73	0.00	0.00	0.00	
10,500.00	92.96	269.09	7,406.27	-1,681.67	-2,285.08	2,537.40	0.00	0.00	0.00	
10,600.00	92.96	269.09	7,401.10	-1,683.26	-2,384.93	2,636.07	0.00	0.00	0.00	
10,700.00	92.96	269.09	7,395.93	-1,684.84	-2,484.79	2,734.75	0.00	0.00	0.00	
10,800.00	92.96	269.09	7,390.76	-1,686.42	-2,584.64	2,833.42	0.00	0.00	0.00	
10,900.00	92.96	269.09	7,385.59	-1,688.00	-2,684.49	2,932.09	0.00	0.00	0.00	
11,000.00	92.96	269.09	7,380.42	-1,689.58	-2,784.35	3,030.76	0.00	0.00	0.00	
11,100.00	92.96	269.09	7,375.25	-1,691.16	-2,884.20	3,129.44	0.00	0.00	0.00	
11,200.00	92.96	269.09	7,370.08	-1,692.74	-2,984.05	3,228.11	0.00	0.00	0.00	
11,300.00	92.96	269.09	7,364.91	-1,694.33	-3,083.91	3,326.78	0.00	0.00	0.00	
11,400.00	92.96	269.09	7,359.74	-1,695.91	-3,183.76	3,425.46	0.00	0.00	0.00	
11,500.00	92.96	269.09	7,354.57	-1,697.49	-3,283.62	3,524.13	0.00	0.00	0.00	
11,600.00	92.96	269.09	7,349.40	-1,699.07	-3,383.47	3,622.80	0.00	0.00	0.00	
11,700.00	92.96	269.09	7,344.23	-1,700.65	-3,483.32	3,721.47	0.00	0.00	0.00	
11,800.00	92.96	269.09	7,339.07	-1,702.23	-3,583.18	3,820.15	0.00	0.00	0.00	
11,900.00	92.96	269.09	7,333.90	-1,703.81	-3,683.03	3,918.82	0.00	0.00	0.00	
12,000.00	92.96	269.09	7,328.73	-1,705.40	-3,782.88	4,017.49	0.00	0.00	0.00	
12,100.00	92.96	269.09	7,323.56	-1,706.98	-3,882.74	4,116.17	0.00	0.00	0.00	
12,200.00	92.96	269.09	7,318.39	-1,708.56	-3,982.59	4,214.84	0.00	0.00	0.00	
12,300.00	92.96	269.09	7,313.22	-1,710.14	-4,082.45	4,313.51	0.00	0.00	0.00	
12,400.00	92.96	269.09	7,308.05	-1,711.72	-4,182.30	4,412.18	0.00	0.00	0.00	
12,500.00	92.96	269.09	7,302.88	-1,713.30	-4,282.15	4,510.86	0.00	0.00	0.00	
12,600.00	92.96	269.09	7,297.71	-1,714.88	-4,382.01	4,609.53	0.00	0.00	0.00	
12,700.00	92.96	269.09	7,292.54	-1,716.47	-4,481.86	4,708.20	0.00	0.00	0.00	
12,800.00	92.96	269.09	7,287.37	-1,718.05	-4,581.71	4,806.88	0.00	0.00	0.00	
12,900.00	92.96	269.09	7,282.20	-1,719.63	-4,681.57	4,905.55	0.00	0.00	0.00	
13,000.00	92.96	269.09	7,277.03	-1,721.21	-4,781.42	5,004.22	0.00	0.00	0.00	
13,100.00	92.96	269.09	7,271.86	-1,722.79	-4,881.28	5,102.89	0.00	0.00	0.00	
13,200.00	92.96	269.09	7,266.69	-1,724.37	-4,981.13	5,201.57	0.00	0.00	0.00	
13,300.00	92.96	269.09	7,261.52	-1,725.95	-5,080.98	5,300.24	0.00	0.00	0.00	
13,400.00	92.96	269.09	7,256.35	-1,727.54	-5,180.84	5,398.91	0.00	0.00	0.00	
13,500.00	92.96	269.09	7,251.19	-1,729.12	-5,280.69	5,497.58	0.00	0.00	0.00	
13,600.00	92.96	269.09	7,246.02	-1,730.70	-5,380.55	5,596.26	0.00	0.00	0.00	
13,700.00	92.96	269.09	7,240.85	-1,732.28	-5,480.40	5,694.93	0.00	0.00	0.00	
13,800.00	92.96	269.09	7,235.68	-1,733.86	-5,580.25	5,793.60	0.00	0.00	0.00	
13,900.00	92.96	269.09	7,230.51	-1,735.44	-5,680.11	5,892.28	0.00	0.00	0.00	
14,000.00	92.96	269.09	7,225.34	-1,737.02	-5,779.96	5,990.95	0.00	0.00	0.00	
14,100.00	92.96	269.09	7,220.17	-1,738.61	-5,879.81	6,089.62	0.00	0.00	0.00	
14,200.00	92.96	269.09	7,215.00	-1,740.19	-5,979.67	6,188.29	0.00	0.00	0.00	
14,300.00	92.96	269.09	7,209.83	-1,741.77	-6,079.52	6,286.97	0.00	0.00	0.00	
14,400.00	92.96	269.09	7,204.66	-1,743.35	-6,179.38	6,385.64	0.00	0.00	0.00	
14,500.00	92.96	269.09	7,199.49	-1,744.93	-6,279.23	6,484.31	0.00	0.00	0.00	
14,600.00	92.96	269.09	7,194.32	-1,746.51	-6,379.08	6,582.99	0.00	0.00	0.00	
14,700.00	92.96	269.09	7,189.15	-1,748.09	-6,478.94	6,681.66	0.00	0.00	0.00	
14,800.00	92.96	269.09	7,183.98	-1,749.68	-6,578.79	6,780.33	0.00	0.00	0.00	
14,900.00	92.96	269.09	7,178.81	-1,751.26	-6,678.64	6,879.00	0.00	0.00	0.00	
15,000.00	92.96	269.09	7,173.64	-1,752.84	-6,778.50	6,977.68	0.00	0.00	0.00	
15,100.00	92.96	269.09	7,168.48	-1,754.42	-6,878.35	7,076.35	0.00	0.00	0.00	

## Planning Report

<b>Database:</b>	EDM 5000.16 Single User Db	<b>Local Co-ordinate Reference:</b>	Well OPAL 6
<b>Company:</b>	BAYSWATER EXPLORATION & PRODUCTION	<b>TVD Reference:</b>	KBE 23' @ 5142.00usft
<b>Project:</b>	WELD COUNTY	<b>MD Reference:</b>	KBE 23' @ 5142.00usft
<b>Site:</b>	SEC 6-T7N-R66W	<b>North Reference:</b>	True
<b>Well:</b>	OPAL 6	<b>Survey Calculation Method:</b>	Minimum Curvature
<b>Wellbore:</b>	OWB		
<b>Design:</b>	PROPOSAL 1		

Planned Survey										
Measured Depth (usft)	Inclination (°)	Azimuth (°)	Vertical Depth (usft)	+N/-S (usft)	+E/-W (usft)	Vertical Section (usft)	Dogleg Rate (°/100ft)	Build Rate (°/100ft)	Turn Rate (°/100ft)	
15,200.00	92.96	269.09	7,163.31	-1,756.00	-6,978.21	7,175.02	0.00	0.00	0.00	
15,300.00	92.96	269.09	7,158.14	-1,757.58	-7,078.06	7,273.70	0.00	0.00	0.00	
15,400.00	92.96	269.09	7,152.97	-1,759.16	-7,177.91	7,372.37	0.00	0.00	0.00	
15,500.00	92.96	269.09	7,147.80	-1,760.75	-7,277.77	7,471.04	0.00	0.00	0.00	
15,600.00	92.96	269.09	7,142.63	-1,762.33	-7,377.62	7,569.71	0.00	0.00	0.00	
15,700.00	92.96	269.09	7,137.46	-1,763.91	-7,477.47	7,668.39	0.00	0.00	0.00	
15,800.00	92.96	269.09	7,132.29	-1,765.49	-7,577.33	7,767.06	0.00	0.00	0.00	
15,900.00	92.96	269.09	7,127.12	-1,767.07	-7,677.18	7,865.73	0.00	0.00	0.00	
16,000.00	92.96	269.09	7,121.95	-1,768.65	-7,777.04	7,964.40	0.00	0.00	0.00	
16,100.00	92.96	269.09	7,116.78	-1,770.23	-7,876.89	8,063.08	0.00	0.00	0.00	
16,200.00	92.96	269.09	7,111.61	-1,771.82	-7,976.74	8,161.75	0.00	0.00	0.00	
16,300.00	92.96	269.09	7,106.44	-1,773.40	-8,076.60	8,260.42	0.00	0.00	0.00	
16,400.00	92.96	269.09	7,101.27	-1,774.98	-8,176.45	8,359.10	0.00	0.00	0.00	
16,500.00	92.96	269.09	7,096.10	-1,776.56	-8,276.30	8,457.77	0.00	0.00	0.00	
16,600.00	92.96	269.09	7,090.93	-1,778.14	-8,376.16	8,556.44	0.00	0.00	0.00	
16,700.00	92.96	269.09	7,085.76	-1,779.72	-8,476.01	8,655.11	0.00	0.00	0.00	
16,800.00	92.96	269.09	7,080.60	-1,781.30	-8,575.87	8,753.79	0.00	0.00	0.00	
16,900.00	92.96	269.09	7,075.43	-1,782.89	-8,675.72	8,852.46	0.00	0.00	0.00	
17,000.00	92.96	269.09	7,070.26	-1,784.47	-8,775.57	8,951.13	0.00	0.00	0.00	
17,100.00	92.96	269.09	7,065.09	-1,786.05	-8,875.43	9,049.81	0.00	0.00	0.00	
17,200.00	92.96	269.09	7,059.92	-1,787.63	-8,975.28	9,148.48	0.00	0.00	0.00	
17,300.00	92.96	269.09	7,054.75	-1,789.21	-9,075.13	9,247.15	0.00	0.00	0.00	
17,400.00	92.96	269.09	7,049.58	-1,790.79	-9,174.99	9,345.82	0.00	0.00	0.00	
17,500.00	92.96	269.09	7,044.41	-1,792.37	-9,274.84	9,444.50	0.00	0.00	0.00	
17,600.00	92.96	269.09	7,039.24	-1,793.96	-9,374.70	9,543.17	0.00	0.00	0.00	
17,700.00	92.96	269.09	7,034.07	-1,795.54	-9,474.55	9,641.84	0.00	0.00	0.00	
17,800.00	92.96	269.09	7,028.90	-1,797.12	-9,574.40	9,740.52	0.00	0.00	0.00	
17,900.00	92.96	269.09	7,023.73	-1,798.70	-9,674.26	9,839.19	0.00	0.00	0.00	
18,000.00	92.96	269.09	7,018.56	-1,800.28	-9,774.11	9,937.86	0.00	0.00	0.00	
18,100.00	92.96	269.09	7,013.39	-1,801.86	-9,873.97	10,036.53	0.00	0.00	0.00	
18,200.00	92.96	269.09	7,008.22	-1,803.44	-9,973.82	10,135.21	0.00	0.00	0.00	
18,300.00	92.96	269.09	7,003.05	-1,805.03	-10,073.67	10,233.88	0.00	0.00	0.00	
18,400.00	92.96	269.09	6,997.88	-1,806.61	-10,173.53	10,332.55	0.00	0.00	0.00	
18,500.00	92.96	269.09	6,992.72	-1,808.19	-10,273.38	10,431.22	0.00	0.00	0.00	
18,600.00	92.96	269.09	6,987.55	-1,809.77	-10,373.23	10,529.90	0.00	0.00	0.00	
18,700.00	92.96	269.09	6,982.38	-1,811.35	-10,473.09	10,628.57	0.00	0.00	0.00	
18,745.97	92.96	269.09	6,980.00	-1,812.08	-10,518.99	10,673.93	0.00	0.00	0.00	
TD at 18745.97										

Design Targets									
Target Name	Dip Angle (°)	Dip Dir. (°)	TVD (usft)	+N/-S (usft)	+E/-W (usft)	Northing (usft)	Easting (usft)	Latitude	Longitude
- hit/miss target									
- Shape									
PBHL-OPAL 6	0.00	0.00	6,980.00	-1,812.08	-10,518.99	1,461,057.98	3,180,464.95	40.597187°N	104.850139°W
- plan hits target center									
- Point									
LP-OPAL 6	0.00	0.00	7,530.00	-1,643.82	104.97	1,461,308.62	3,191,087.02	40.597655°N	104.811883°W
- plan hits target center									
- Point									

Planning Report

Database:	EDM 5000.16 Single User Db	Local Co-ordinate Reference:	Well OPAL 6
Company:	BAYSWATER EXPLORATION & PRODUCTION	TVD Reference:	KBE 23' @ 5142.00usft
Project:	WELD COUNTY	MD Reference:	KBE 23' @ 5142.00usft
Site:	SEC 6-T7N-R66W	North Reference:	True
Well:	OPAL 6	Survey Calculation Method:	Minimum Curvature
Wellbore:	OWB		
Design:	PROPOSAL 1		

Plan Annotations				
Measured Depth (usft)	Vertical Depth (usft)	Local Coordinates		Comment
		+N/-S (usft)	+E/-W (usft)	
100.00	100.00	0.00	0.00	Start Build 2.00
813.11	805.77	-79.84	37.72	Start 6306.11 hold at 813.11 MD
7,119.22	6,917.52	-1,484.56	701.32	Start DLS 10.00 TFO 113.04
8,106.45	7,530.00	-1,643.82	104.97	Start 10639.52 hold at 8106.45 MD
18,745.97	6,980.00	-1,812.08	-10,518.99	TD at 18745.97