

WALLSTREET FED 8-3HZ CONSTRUCTION LAYOUT DRAWING - PLAN VIEW

QUANTITIES AND DESIGN PARAMETERS	
EXISTING GRADE @ CENTER OF PAD = 4781.5'	
FINISHED GRADE ELEVATION = 4780.4' (WITH PLATING)	
CUT/FILL SLOPES = 4:1	
SHRINKAGE FACTOR = 1.10	
SWELL FACTOR = 1.00	
GRADED PAD SURFACE AREA = 8.71 ACRES	
TOTAL PAD AREA = 9.64 ACRES	
TOTAL FENCED AREA = 15.95 ACRES	
PROPOSED OIL & GAS LOCATION = 16.60 ACRES	

PAD QUANTITIES	
TOTAL CUT FOR PAD = 17,633 C.Y.	
TOTAL FILL FOR PAD = 17,633 C.Y.	
TOPSOIL @ 6" DEPTH = 7,777 C.Y.	
STRONGBACK PLATING MATERIAL = 2,720 C.Y.	
PLATING MATERIAL @ 8" DEPTH = 10,163 C.Y.	
TOTAL PLATING MATERIAL = 12,883 C.Y.	
TOTAL DISTURBANCE AREA	
OIL & GAS LOCATION = 16.60 ACRES	
WORKING PAD SURFACE = 8.71 ACRES	
IMPROVED ACCESS ROAD = SEE NOTE 2	
NEW ACCESS ROAD = 0.44 ACRES	
PIPELINE/UTILITY CORRIDOR = SEE NOTE 1	

WALLSTREET FED 8-3HZ

CONSTRUCTION LAYOUT DRAWING - PLAN VIEW
WALLSTREET FED 3-1HZ, WALLSTREET FED 3-2HZ,
WALLSTREET FED 3-3HZ, WALLSTREET FED 3-4HZ, WALLSTREET FED 3-5HZ,
WALLSTREET FED 3-6HZ, WALLSTREET FED 3-7HZ, WALLSTREET FED 3-8HZ,
WALLSTREET FED 3-9HZ, WALLSTREET FED 3-10HZ, WALLSTREET FED 3-11HZ,
WALLSTREET FED 3-12HZ, WALLSTREET FED 3-13HZ, WALLSTREET FED 3-14HZ,
WALLSTREET FED 3-15HZ, WALLSTREET FED 3-16HZ & WALLSTREET FED 3-17HZ
LOCATED IN SECTION 3, T3N, R63W, 6TH P.M.
WELD COUNTY, COLORADO

Kerr-McGee Oil &
Gas Onshore LP

1099 18th Street
Denver, Colorado 80202

609

LOVELAND OFFICE
6706 North Franklin Avenue
Loveland, Colorado 80538
Phone 970-776-4331

SHERIDAN OFFICE
1095 Saberton Avenue
Sheridan, Wyoming 82801
Phone 307-674-0609

CONSULTING, LLC

LEGEND

○

EXISTING WELL LOCATION

●

PROPOSED WELL LOCATION

EXISTING CONTOURS (2' INTERVAL)

PROPOSED CONTOURS (2' INTERVAL)

EPL

EXISTING PIPELINE

WORKING PAD SURFACE

PROPOSED SOUND MITIGATION

EXISTING FENCE

PROPOSED FENCE

DIVERSION DITCH AND/OR BERM

0

50'

100'

HORIZONTAL

2' CONTOURS

SCALE: 1"=100' DATE: 11/8/23 SHEET NO: 1 OF 1

REVISED: SRS 12/11/23

\\10.0.76\company\ADARCO\01012017_197_CERVL\BANCH_T4N_R63W\DWG\05_WALLSTREET\05_WALLSTREET.dwg, 11/29/2023 11:55:08 AM, cfrnk

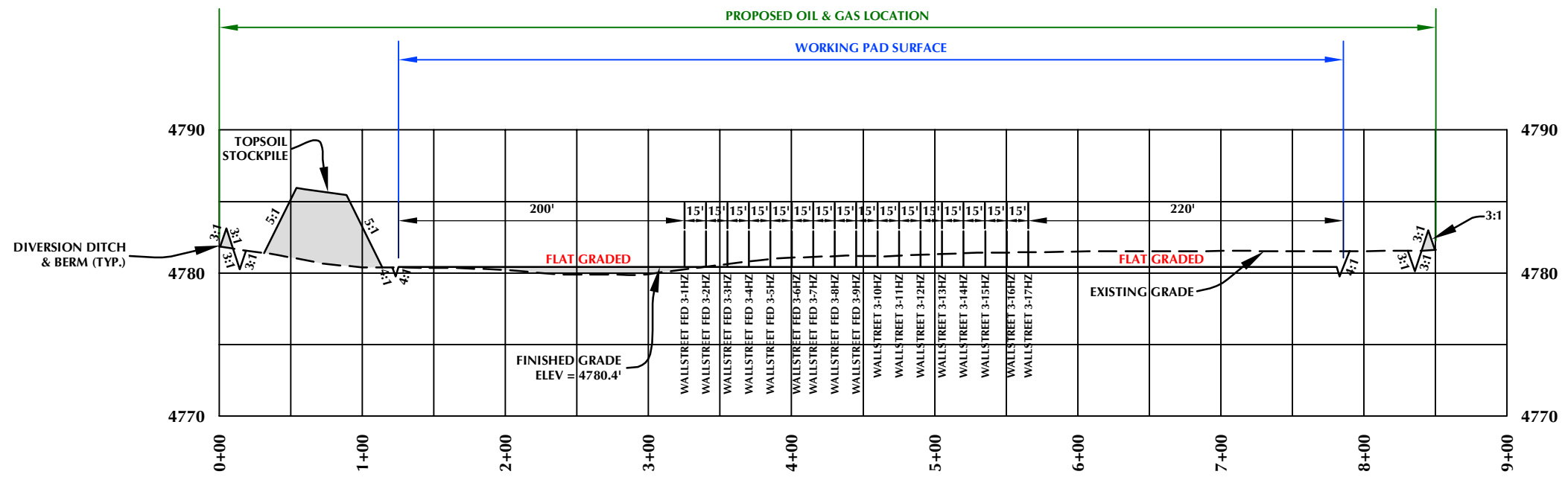

CROSS SECTION A-A'

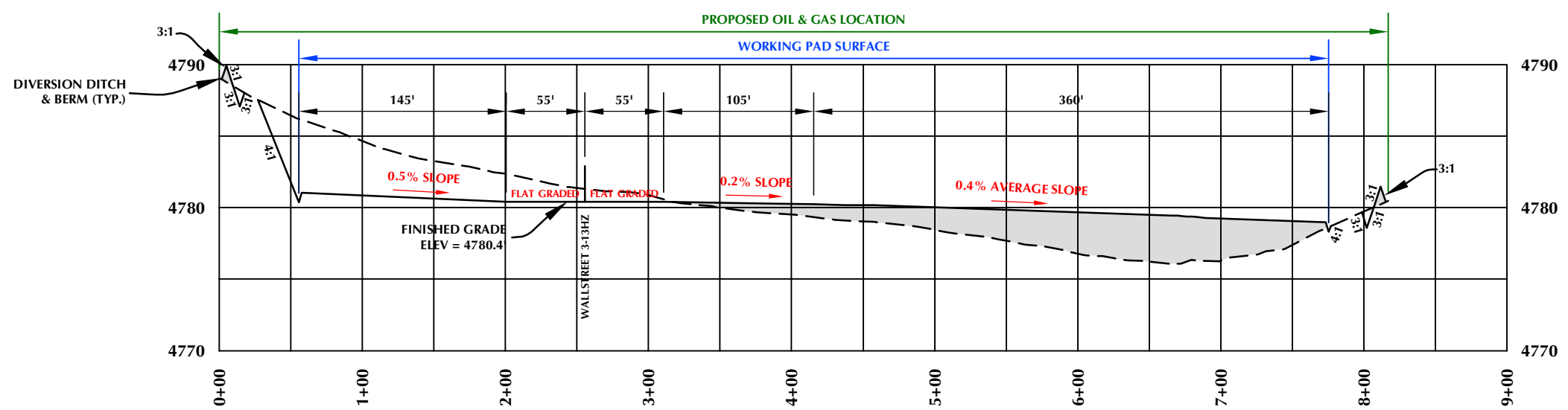

CROSS SECTION B-B'

WALLSTREET FED 8-3HZ

WALLSTREET FED 3-1HZ, WALLSTREET FED 3-2HZ,
WALLSTREET FED 3-3HZ, WALLSTREET FED 3-4HZ, WALLSTREET FED 3-5HZ,
WALLSTREET FED 3-6HZ, WALLSTREET FED 3-7HZ, WALLSTREET FED 3-8HZ,
WALLSTREET FED 3-9HZ, WALLSTREET FED 3-10HZ, WALLSTREET FED 3-11HZ,
WALLSTREET FED 3-12HZ, WALLSTREET FED 3-13HZ, WALLSTREET FED 3-14HZ,
WALLSTREET FED 3-15HZ, WALLSTREET FED 3-16HZ & WALLSTREET FED 3-17HZ
LOCATED IN SECTION 3, T3N, R63W, 6TH P.M.
WELD COUNTY, COLORADO

CONSTRUCTION LAYOUT DRAWING - CROSS SECTIONS

Kerr-McGee Oil &
Gas Onshore LP
1099 18th Street
Denver, Colorado 80202



LOVELAND OFFICE
6706 North Franklin Avenue
Loveland, Colorado 80538
Phone 970-776-4331
SHERIDAN OFFICE
1095 Saberton Avenue
Sheridan, Wyoming 82801
Phone 307-674-0609

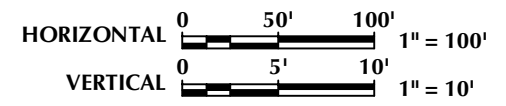

SCALE: 1"=100'	DATE: 11/8/23	SHEET NO:
REVISED:	HJL 11/30/23	1 OF 1

PRELIMINARY RIG LAYOUT DRAWING
WALLSTREET FED 8-3HZ
SE1/4 NE1/4 SECTION 3, TOWNSHIP 3 NORTH, RANGE 63 WEST, 6TH P.M., WELD COUNTY, COLORADO

PROPOSED
OIL & GAS
LOCATION

CASING & DRILL
PIPE STORAGE

CHEMICAL SKID

CHEMICAL SKID

RIG CAMP
AREA

PROPOSED
SOUND
MITIGATION
(TYP.)

WALLSTREET FED 3-17HZ
WALLSTREET 3-16HZ
WALLSTREET 3-15HZ
WALLSTREET 3-14HZ
WALLSTREET 3-13HZ
WALLSTREET 3-12HZ
WALLSTREET 3-11HZ
WALLSTREET 3-10HZ
WALLSTREET FED 3-9HZ
WALLSTREET FED 3-8HZ
WALLSTREET FED 3-7HZ
WALLSTREET FED 3-6HZ
WALLSTREET FED 3-5HZ
WALLSTREET FED 3-4HZ
WALLSTREET FED 3-3HZ
WALLSTREET FED 3-2HZ
WALLSTREET FED 3-1HZ

PIPEHANDLER CATWALK

FLARE BOX / FLARE LINE

CEMENT SILO
(450 SKS)

UPRIGHT
WATER TANK
(350 BBL)

SLOP
TANK
(200
BBL)
FRAC TANK
(500 BBL)
FRAC TANK
(500 BBL)
FRAC TANK
(500 BBL)

HOUSE
RIG
#461

SHAKER TANK
(326 BBL)
THREE SIDED
TANK (150 C.Y.)

CENTRIFUGES (2)
VCD
SHACK

THREE SIDED
TANK (150 C.Y.)
THREE SIDED
TANK (150 C.Y.)

BAR SILO
(48 TONS)

OBM UPRIGHT
STORAGE TANKS
(350 BBL EACH) (8)

ACTIVE MUD TANK
(1075 BBL)
ACTIVE MUD TANK
(1075 BBL)
ACTIVE MUD TANK
(1075 BBL)

PUMP HOUSE

COMPLEX DRIVEHOUSE

GENERATOR
GENERATOR
GENERATOR

WATER TANK
(400 BBL)

CHANGE SHACK
RIG
VAC

OBM DIESEL TANK
(1780 GAL)

OBM DIESEL TANK
(1780 GAL)

OBM DIESEL TANK
(1780 GAL)

CERTIFICATES
TRAILER (300 ACFT)
CERTIFICATES
TRAILER (300 ACFT)

PROPOSED
WALLSTREET FED 8-3HZ
FACILITY PAD

PROPOSED
WALLSTREET FED 8-3HZ
WORKING PAD
SURFACE

PROPOSED
ACCESS ROAD

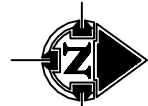

0 30' 60'
1" = 60'

- LEGEND
- PROPOSED WELL
 - EXISTING WELL
 - PROPOSED OIL & GAS LOCATION
 - PROPOSED WORKING PAD SURFACE
 - PROPOSED 2' CONTOUR



LOVELAND OFFICE
6706 North Franklin Avenue
Loveland, Colorado 80538
Phone 970-776-4331

SHERIDAN OFFICE
1095 Saberton Avenue
Sheridan, Wyoming 82801
Phone 307-674-0609

Kerr-McGee Oil &
Gas Onshore LP
1099 18th Street
Denver, Colorado 80202

SCALE: 1" = 60'
DATE SURVEYED: 9/27/23
DATE: 11/8/23
DRAFTER: GLK
REVISED: 11/30/23

NOTE:
1. RIG PROFILE IS APPROXIMATE AND SUBJECT TO MODIFICATION DUE TO SPECIFIC CIRCUMSTANCES.

PRELIMINARY WELL COMPLETION AND STIMULATION LAYOUT DRAWING
WALLSTREET FED 8-3HZ
SE1/4 NE1/4 SECTION 3, TOWNSHIP 3 NORTH, RANGE 63 WEST, 6TH P.M., WELD COUNTY, COLORADO

PROPOSED
OIL & GAS
LOCATION

EQUIPMENT	CAPACITY
ACID TRANSPORT	4,000 GAL CAPACITY
HCR SYNTHETIC ACID TRANSPORT	4,000 GAL CAPACITY
FRICTION REDUCER ISO	4,500 GAL CAPACITY
BIOCIDE ISO	6,000 GAL CAPACITY
DEF TANK	2,200 GAL DEF TANK
DIESEL TANK	16,000 GAL DIESEL TANK
ROUND WATER TANK	3,600 BBL CAPACITY
STORAGE TANK (OPEN TOP, CLOSED TOP, WATER)	500 BBL CAPACITY
WATER RECYCLE TANK	500 BBL CAPACITY

LEGEND
● PROPOSED WELL
○ EXISTING WELL
- - - PROPOSED OIL & GAS LOCATION
- - - PROPOSED WORKING PAD SURFACE
- - - PROPOSED 2' CONTOUR



LOVELAND OFFICE
6706 North Franklin Avenue
Loveland, Colorado 80538
Phone 970-776-4331

SHERIDAN OFFICE
1095 Saberton Avenue
Sheridan, Wyoming 82801
Phone 307-674-0609

**Kerr-McGee Oil &
Gas Onshore LP**
1099 18th Street
Denver, Colorado 80202

SCALE: 1" = 60'
DATE SURVEYED: 9/27/23
DATE: 11/8/23
DRAFTER: GLK
REVISED: 11/30/23

NOTE:
1. COMPLETION AND STIMULATION LAYOUT IS APPROXIMATE AND
SUBJECT TO MODIFICATION DUE TO SPECIFIC CIRCUMSTANCES.

K:\ANDARQ\2017\2017_197_CERVO_RANCH_TN_R63W\DWG\5_WALLSTREET.dwg, 11/30/2023 10:00:27 AM, saundberg

SE1/4 NE1/4 SECTION 3, TOWNSHIP 3 NORTH, RANGE 63 WEST, 6TH P.M., WELD COUNTY, COLORADO

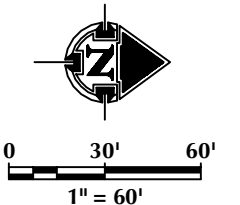

NOTE:
-WELLHEADS WILL REMAIN PERMANENTLY AFTER FLOWBACK IS COMPLETE.
ALL OTHER EQUIPMENT DISPLAYED IS TEMPORARY AND WILL BE REMOVED
FOLLOWING FLOWBACK OPERATIONS.

DISTANCE FROM WORKING PAD SURFACE TO:

BUILDING	5280'+ N
RESIDENTIAL BUILDING UNIT (RBU)	5280'+ SE
HIGH OCCUPANCY BUILDING UNIT (HOBV)	5280'+ SE
DESIGNATED OUTSIDE ACTIVITY AREA	5280'+ SW
PUBLIC ROAD	5280'+ N
ABOVE GROUND UTILITY	±132' E
RAILROAD	5280'+ N
PROPERTY LINE	±275' E
SCHOOL FACILITY	5280'+ SW
CHILD CARE CENTER	5280'+ SW
DISPROPORTIONATELY IMPACTED (DI) COMMUNITY	±0'
RBU, HOBV, OR SCHOOL FACILITY WITHIN A DI COMMUNITY	5280'+ NW

DISTANCE FROM NEAREST WELL TO:

TEST SEPARATOR	±314' E
TEMPORARY SAND TANK	±216' E
TEMPORARY ECD	±259' E
TEMPORARY PURGE FLARE	±172' E
WORKING PAD SURFACE	±198' W

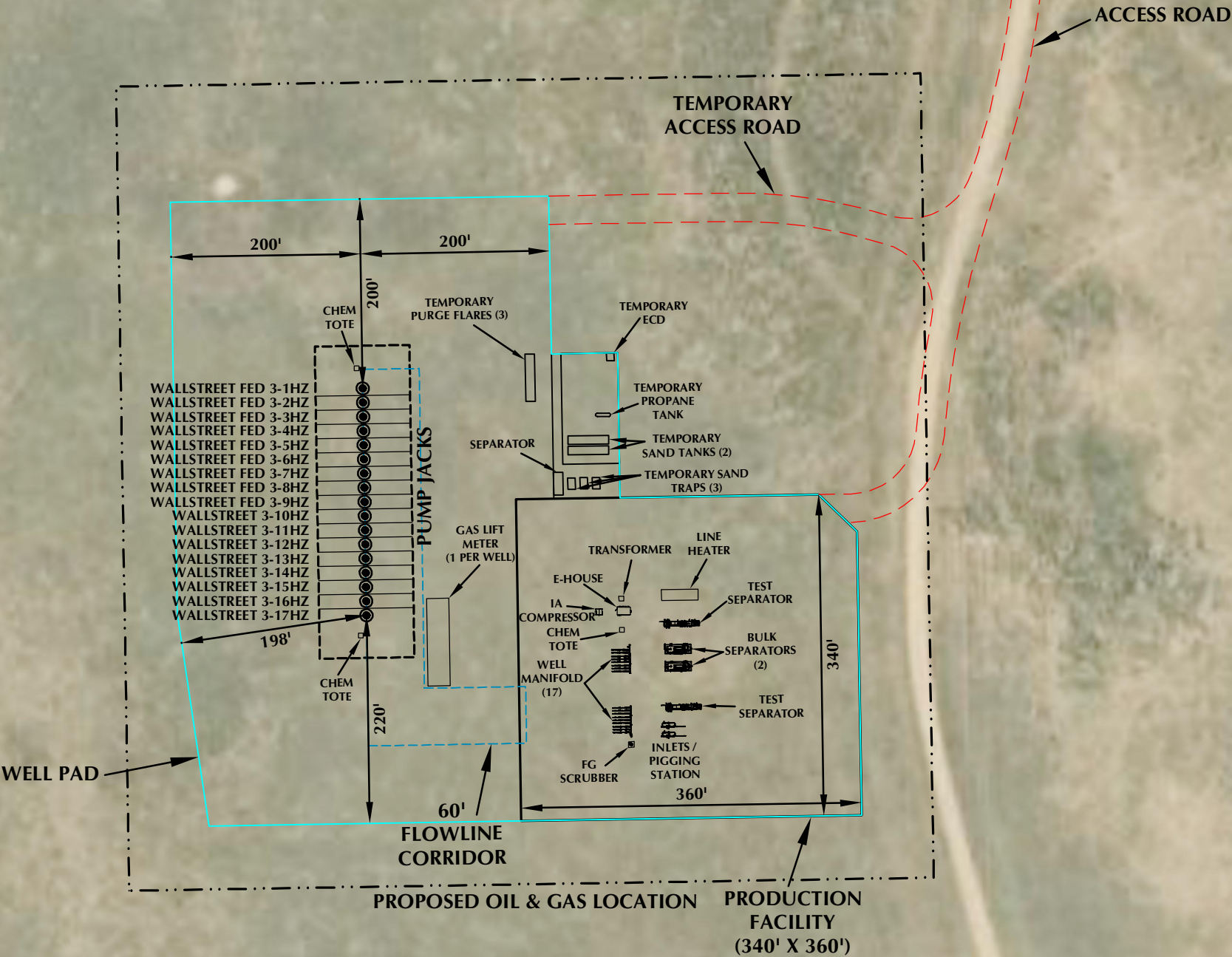

LEGEND:		
PROPOSED WELL	PROPOSED OIL & GAS LOCATION	
ROAD PROPOSED	PROPOSED FLOWLINE CORRIDOR	
WORKING PAD SURFACE		

- NOTES:**
- EQUIPMENT PLACEMENT IS APPROXIMATE AND SUBJECT TO MINOR MODIFICATION DUE TO SPECIFIC CIRCUMSTANCES.
 - FLOWLINE CORRIDOR IS APPROXIMATE AND SUBJECT TO MINOR MODIFICATION DUE TO SPECIFIC CIRCUMSTANCES.

FACILITY COORDINATES:
LAT: 40.256410° LONG: -104.416328° (NAD83)

DATA SOURCES:
- AERIAL COURTESY OF NAIP.



LOVELAND OFFICE
6706 North Franklin Avenue
Loveland, Colorado 80538
Phone 970-776-4331

SHERIDAN OFFICE
1095 Saberton Avenue
Sheridan, Wyoming 82801
Phone 307-674-0609

**Kerr-McGee Oil &
Gas Onshore LP**
1099 18th Street
Denver, Colorado 80202

SCALE: 1" = 150'
DATE SURVEYED: 9/27/23
DATE: 11/8/23
DRAFTER: AMPZ
REVISED: 12/11/23

FACILITY LAYOUT DRAWING
WALLSTREET FED 8-3HZ
LOCATED IN SECTION 3, T3N, R63W, 6TH P.M.
WELD COUNTY, COLORADO

