

# Interim Reclamation and Stormwater Inspection

Date: 05/02/2024

Operator: WESTERN OPERATING COMPANY - 95620

Location ID: 312292

Inspection Document #: 708201241

Logan County, CO

Dylan Edwardson  
Reclamation Specialist, ECMC



**COLORADO**  
Energy & Carbon Management  
Commission  
Department of Natural Resources

Inspection Photos  
Location Name: Propst 2  
Location ID: 312292



**Photo 1.** Free hydrocarbons previously observed within the tank battery secondary containment have been removed and the tank battery area has been excavated. Refer to Environmental FIR (doc #709100276) photo log from 04/29/2024 for additional.



Inspection Photos  
Location Name: Propst 2  
Location ID: 312292



**Photo 2.** Facing northwest at tank battery; see comments in Photo 1.



Inspection Photos  
Location Name: Propst 2  
Location ID: 312292



**Photo 3.** Facing west at tank battery; see comments in Photo 1.





**Photo 4.** Facing southwest at tank battery; see comments in Photo 1.





**Photo 5.** Facing northeast at tank battery; see comments in Photo 1.





**Photo 6.** Taken east of the tank battery, facing south. Photo illustrates hydrocarbon impacts from spill/misting onto adjacent areas. It appears that the impacted area was mowed at the time of this inspection.

Inspection Photos  
Location Name: Propst 2  
Location ID: 312292

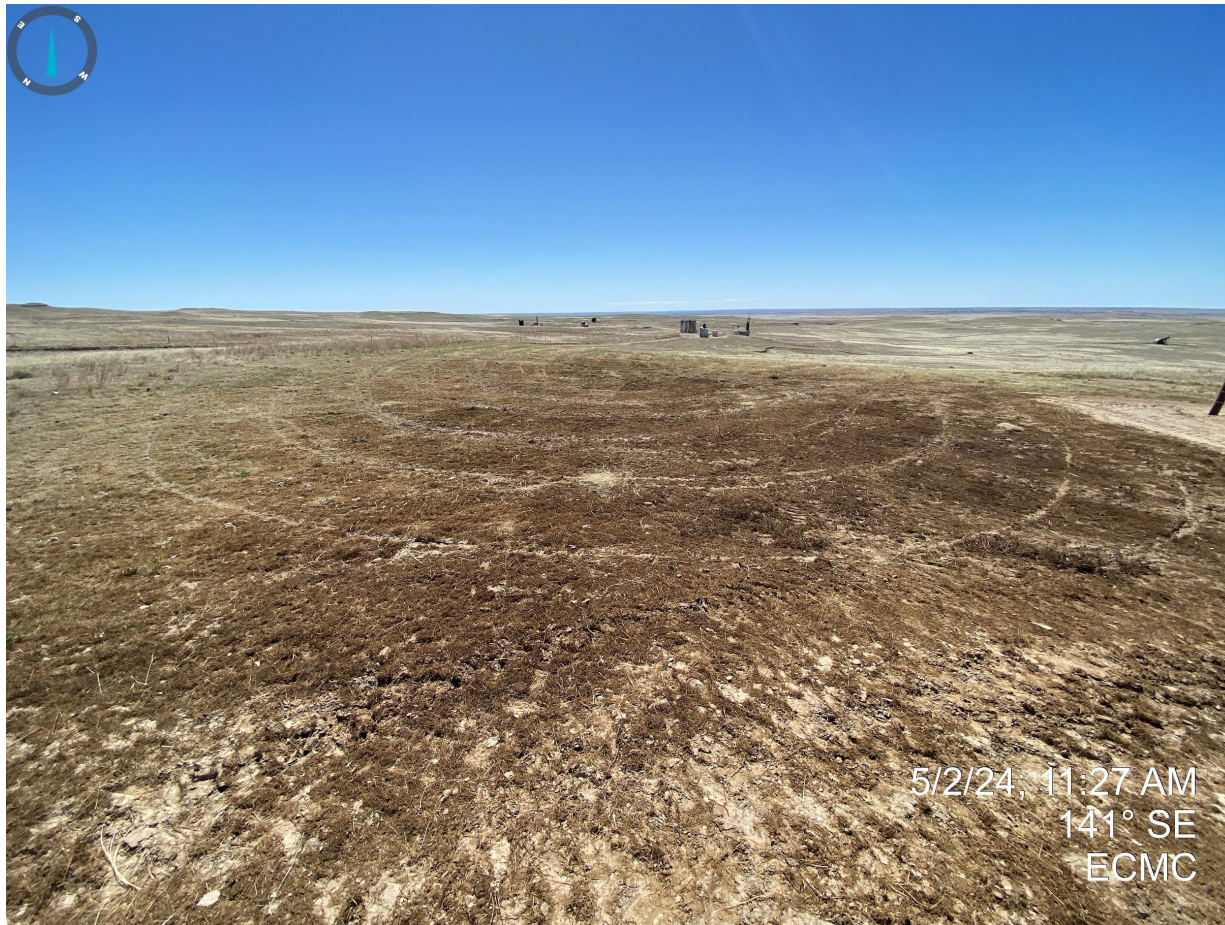

**Photo 7.** Facing southeast; see comments in Photo 6.





**Photo 8.** Hydrocarbon impacts observed east/southeast of the tank battery.

Inspection Photos  
Location Name: Propst 2  
Location ID: 312292



**Photo 9.** Taken near the tank battery, facing east. See comments in Photo 8.



Inspection Photos  
Location Name: Propst 2  
Location ID: 312292



**Photo 10.** Hydrocarbon impacts previously observed on the production areas/access road appear to have been removed.

Inspection Photos  
Location Name: Propst 2  
Location ID: 312292



5/2/24, 11:26 AM  
302° NW  
ECMC

**Photo 11.** Taken south of the vertical heater treater. Hydrocarbon impacts previously observed appear to have been removed.



Inspection Photos  
Location Name: Propst 2  
Location ID: 312292



**Photo 12.** Examples of cigarette butt observed on location, south of the vertical heater treater.



Inspection Photos  
Location Name: Propst 2  
Location ID: 312292

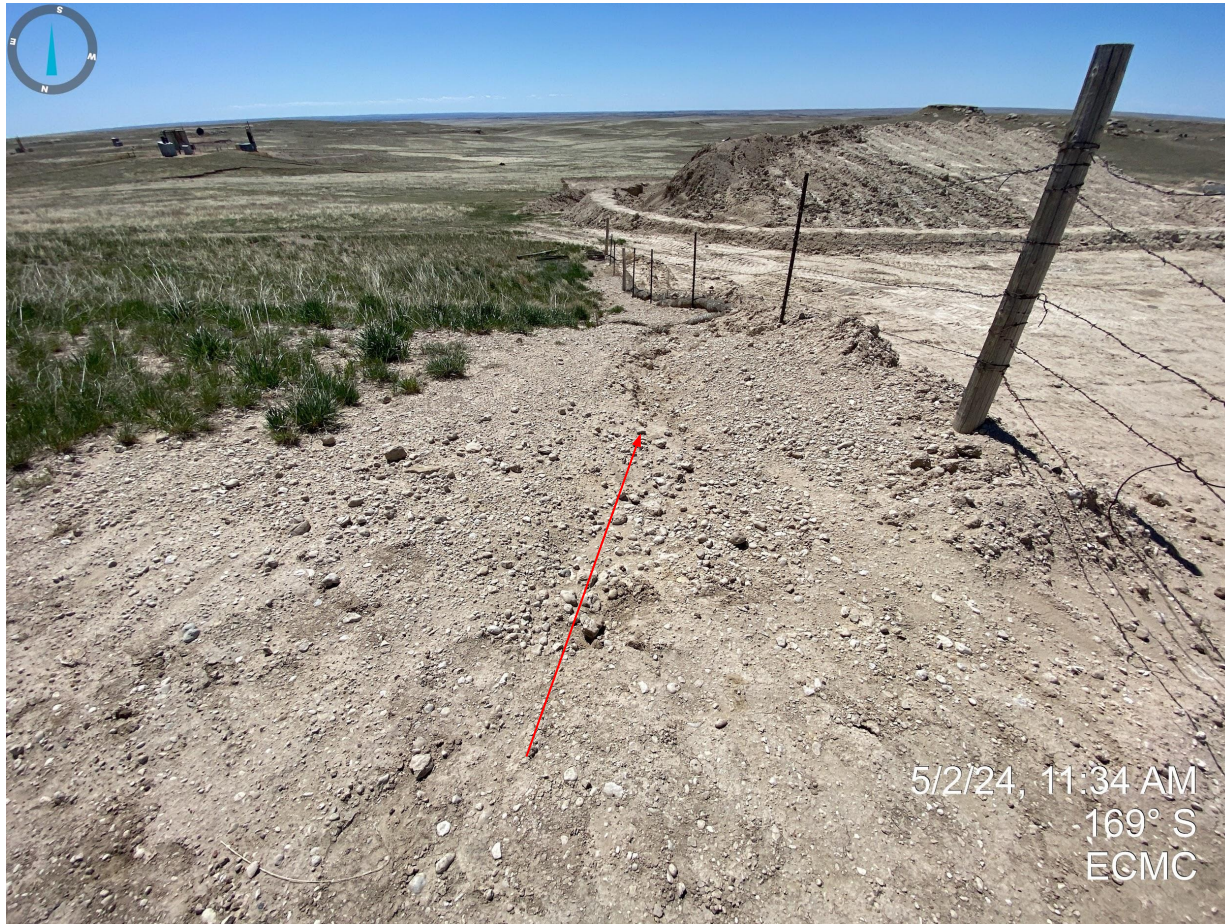

**Photo 13.** Erosion degradation on the east side of the pit. No stormwater control measures/BMPs observed.





**Photo 14.** Erosion degradation on the east side of the pit.



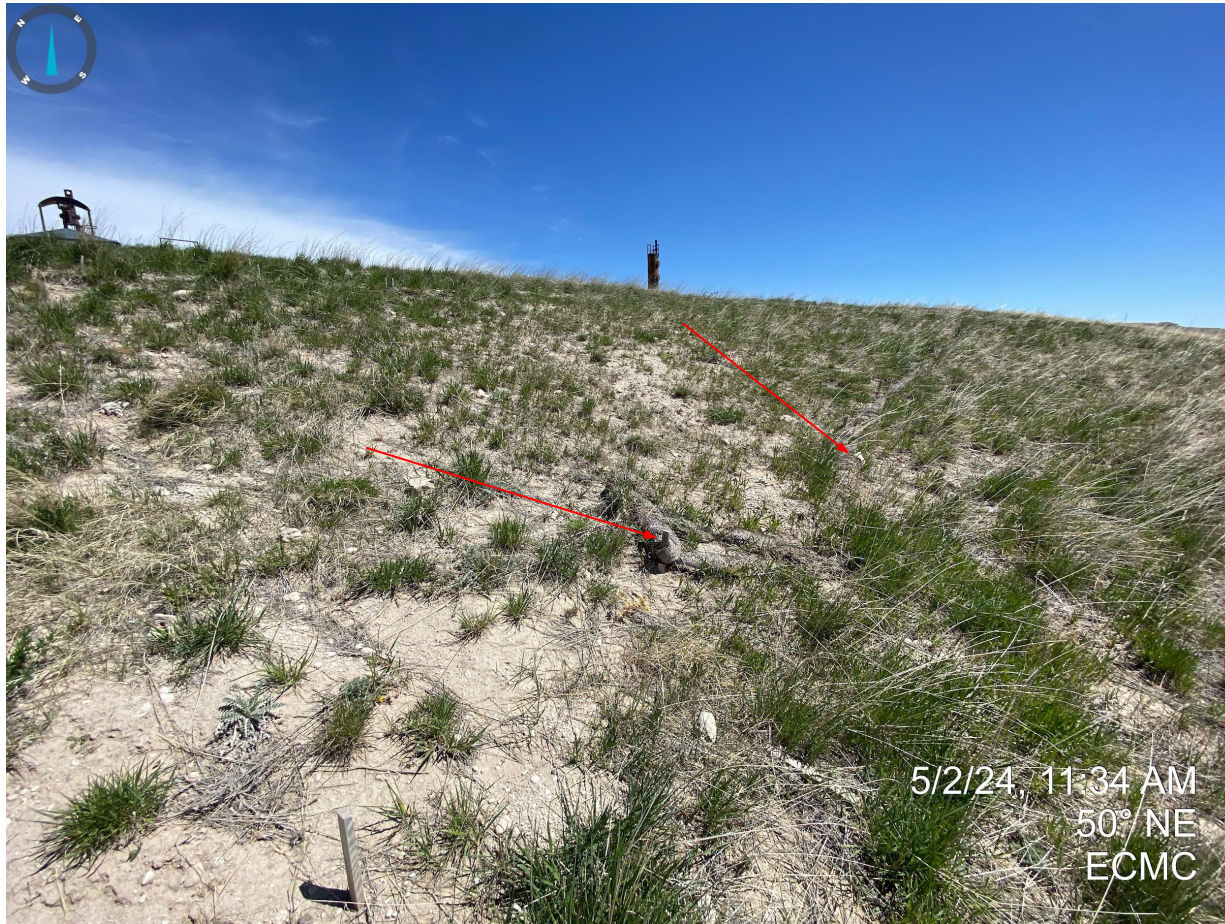

**Photo 15.** Degraded straw wattles are considered debris as they're beginning to fill with sediment and are no longer adequate or in proper working condition.



Inspection Photos  
Location Name: Propst 2  
Location ID: 312292



**Photo 16.** Fencing materials are considered unused equipment/debris and need to be removed or returned to service.





**Photo 17.** East side of stockpiled pit soils. Photo illustrates that both the stockpile and berms have been left unconsolidated. Unconsolidated materials can become a potential pollution source as it is not properly stabilized. Berms also appear to be built out of impacted material from the salt kill/pit excavation.





**Photo 18.** Close up of unconsolidated soils; see comments in Photo 17.



**Photo 19.** An area approximately 0.50 acres in size has been excavated south of the pit and stockpile. No evidence of stormwater controls measures were observed around the perimeter of the excavated salt kill impacted area.





**Photo 20.** West side of the southern topsoil stockpile; see comments in Photo 17.





**Photo 21.** Additional disturbance observed south of the salt kill impacted areas. Any disturbance will need to be reclaimed per the reclamation rules as the area is now susceptible to wind and water erosion degradation.





**Photo 22.** Overview of excavated pit and salt kill area. Soils do not appear to be properly stabilized from wind and water erosion degradation. The open excavation is not properly fenced to exclude wildlife, livestock or unauthorized personnel.





**Photo 23.** Overview of excavated pit and salt kill area. Soils do not appear to be properly stabilized from wind and water erosion degradation. The open excavation is not properly fenced to exclude wildlife, livestock or unauthorized personnel.





**Photo 24.** Western stockpiled material is not properly stabilized with evidence of unconsolidated materials.





**Photo 25.** Overview of western most excavation area. The open excavation is not properly fenced to exclude wildlife, livestock or unauthorized personnel.





**Photo 26.** North side of excavation. No stormwater control measures were observed around the perimeter of the excavated area that would prevent off location stormwater discharge from entering nearby drainage (indicated by red arrow).





**Photo 27.** Continued from Photo 26, facing southwest.





**Photo 28.** Unused fencing material needs to be removed from the location or returned to service as it poses a potential hazard to personnel, livestock and wildlife resources.





**Photo 29.** Taken from the north side of the pit. It does not appear that any erosion degradation has been properly stabilized or repaired, and stormwater control measure remain inadequate as the straw wattles are either degraded or not installed properly.