

RECEIVED



00225648

FEB 02 1989

R58W

COLO. OIL &amp; GAS CONS. COMMISSION

T7N

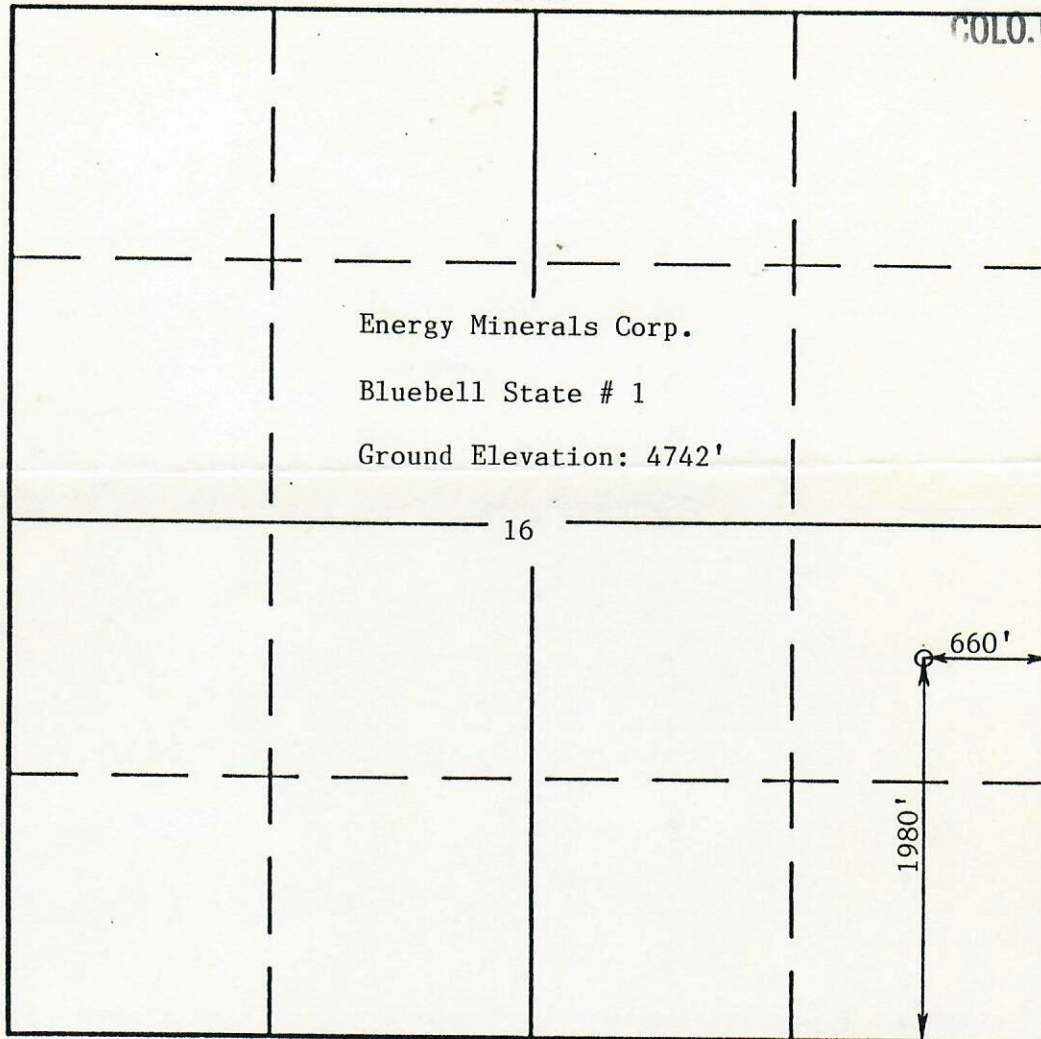

NORTH

## WELL LOCATION PLAT

Flatirons Surveying, Inc., in accordance with a request from Energy Minerals Corp., has determined the location of the Bluebell State # 1 to be 1980' FSL and 660' FEL, in the NE 1/4 of the SE 1/4 of Section 16, T7N, R58W of the 6<sup>th</sup> Principal Meridian, Weld County, Colorado.

### SURVEYOR'S CERTIFICATE

I, John B. Guyton, a Professional Land Surveyor in the State of Colorado do hereby certify that this survey was made under my direct supervision, and that this plat represents said survey.

*John B. Guyton*  
 John B. Guyton  
 Colorado P.L.S. #16406



DATE: January 27, 1988  
 FSI NO: 88-10579

*Flatirons Surveying, Inc.*  
 Boulder, Colorado