

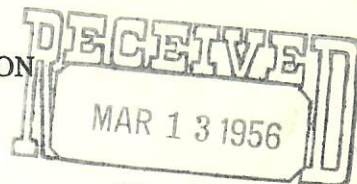

COLORADO OIL AND GAS CONSERVATION COMMISSION DRY NOTICES AND REPORTS OF WELLS



(Indicate nature of data by checking below)

☒ Notice of intention to drill (attach plat)
☐ Notice of intention to change plans
☐ Notice of date for test of water shut-off
☐ Report on result of test of water shut-off
☐ Notice of intention to re-drill or repair well
☐ Notice of intention to clean out well
☐ Statement of shooting
☐ Statement of perforating
☐ Notice to pull or otherwise alter casing
☐ Notice of intention to abandon well
☐ Report of work done on well since previous report

OIL & GAS
 CONSERVATION COMMISSION

Locate Well Correctly

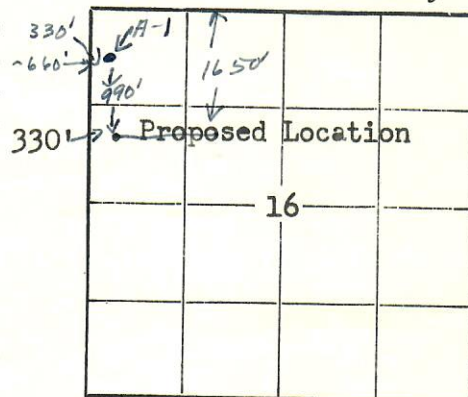

Notice to do work ☐
 Report of work done ☐

Land: Fee and Patented ☐
 State ☐

Lease No. 55/406

Colorado
 State

Weld
 County

Cotton Valley
 Field

A-2 State NWSWNW 16 9N 56W 6th P.M
 (Well No.) (Lease) (1/4 Sec.) (Sec.) (Twp.) (Range) (Meridian)

The Well is located 1650 Ft. ~~(N)~~ of Section Line and 330 Ft. (E) of Section Line.
 (S) ~~(W)~~

The elevation above sea level is 4525 Ft. G.L. est. from adjoining well.

Details of Plan of Work: (State names of and expected depths to objective sands. Show sizes, weights, and length of proposed casings; indicate mudding jobs, cementing points, and all other important proposed work.)

"D" est. 5770
 #J" est. 5860
 TD est. 6050

9-5/8" surface csg. to be set at approx. 160' and cemented w/150 sx in 15" hole.

5 1/2" O.D.Csg. to be set through the "J" sand and cemented w/approx. 150 SX in 7-7/8" hole.

AJJ	
DVR	
FJK	
WRS	
HHM	
AH	
JJD	
FILE	

This Notice is hereby approved subject to an investigation to determine any advantage which the L. L. Gage interests may have over other producers by reason of the drilling of a well at the location defined on this Notice, and the Commission shall take such action as will offset the advantage as determined.

Approved: March 14, 1956

[Signature]
 Director

Date 3-13-56

Company L.L. Gage

Address 3195 So. Bellaire, Denver

By J.W. Hudson

Title Agent

Submit reports of proposed work, for approval, on this form in Duplicate for patented lands and in Triplicate for school and state lands.