



2615 Grape Street
Denver, CO 80207

October 9, 2023

Rio Blanco County
Attn: Mr. Eddie Smercina, Natural Resources Manager
Natural Resources Department
555 Main Street
Meeker, CO 81641

Electronic Mail with Electronic Receipt

**RE: Revised Notice of Oil and Gas Development Plan
Anschutz Exploration Corporation's Mohee Fed 0297-17 Well Pad
SWNE Section 17, T2N R97W
Rio Blanco County, Colorado**

Dear Mr. Smercina

On August 31, 2023 Anschutz Exploration Corporation (Anschutz) notified Rio Blanco County of intent to submit an Oil and Gas Development Plan (OGDP) pursuant to Rules 302.e and 303e.(3) of the Energy Carbon Management Commission (ECMC) for the Mohee Fed 0297-17 Well Pad. Anschutz wishes to make a minor clarification as a result of further review of the location and a recent acquisition of certain lands pertaining to the location. The Mohee Fed 0297-17 Well Pad will be situated in the SWNE of Section 17, Township 2 North, Range 97 West, 6th Principal Meridian, of Rio Blanco County, Colorado. As a result of a recent acquisition of lands Anschutz will be utilizing an existing access road which will lead to the new lease access road that will be constructed. As a result, please find an edited Notice of Oil and Gas Development Plan.

Per the requirements set forth in ECMC Rules 302 and 303, Anschutz, as operator, is providing the following contact information to which the public may direct questions and comments:

Anschutz Exploration Corp.
555 17th Street, Suite 2400
Denver, CO 80202
Phone: (303) 298-1000
Email: Jennifer.Bland@aec-denver.com

Energy Carbon Management Commission
1120 Lincoln Street, Suite 801
Denver, Colorado 80203
Phone: (303) 894-2100
Website: <https://ecmc.state.co.us/#/home>



2615 Grape Street
Denver, CO 80207

Rio Blanco County, Natural Resources Department

555 Main Street

Meeker, Colorado 81641

Phone: (970)-878-9431

Website: <https://ecmc.state.co.us/#/home>

Should you have any questions or require further information, please contact the undersigned. Should any information change throughout the course of permitting the OGD, Anschutz will communicate any changes and updates via electronic mail with a read receipt.

Respectfully,

Holly Hill

**NOTICE TO RELEVANT AND PROXIMATE LOCAL GOVERNMENT OF OIL AND GAS
DEVELOPMENT PLAN PURSUANT TO RULE 302.E**

Anschutz Exploration Corporation (Anschutz) (Operator No. 3104) will submit an Application to the Energy Carbon Management Commission (ECMC) for an order to approve an Oil and Gas Development Plan (OGDP) for approximately 6.1 ~~14.4~~ long-term acres pursuant to ECMC Rule 303 and Rule 503.g.(1) for the following Application Lands for the production of oil, and associated hydrocarbons for up to eight (8) oil wells drilled from the Mohee Fed 0297- 17 Well Pad as further described below:

Mohee Fed 0297-17 Well Pad:

Federal Surface Location: SWNE Section 17, T2N R97W

Approximate Mineral Development: 2560 acres of federal minerals committed to a Federal Unit:

Township 2 North, Range 97 West, 6th PM

Section 8: ALL

Section 17: ALL

Section 20: ALL

Section 29: ALL

Rio Blanco County, CO

Cross Roads: Rio Blanco County Road 77 & Existing Lease Access Road for Mohee Fed 0297-17

The OGDP is anticipated to commence construction and drilling for the Mohee Fed 0297-17 OGDP as listed below. These timeframes are the best estimate at this time and are subject to personnel availability, wildlife stipulations, weather and rig availability.

Location Name	Estimated Construction Start Date	Estimated Drilling Start Date
Mohee Fed 0297-17	May 1, 2024 July 15, 2024	September 1, 2024

The following operational phases to be expected:

- 1) **Pre-Production/Construction Phase:** Anschutz would need to construct a new Well Pad, lease access road, and pipeline corridor in accordance with Bureau of Land Management construction requirements. The Well Pad will be built to accommodate up to eight (8) oil wells on federal surface including the following actions:
 - Build a new lease access road beginning in the NENW of Section 17, T2N R97W ~~SENE of Section 4, T2N R97W~~ which would be approximately 1,985-feet in length ~~13,615-feet in length~~ with a 50-foot wide ~~70-foot wide~~ construction Right-of-Way (ROW), reclaimed back to 30-feet in width, with a road-running width of 24-feet, which will lead to the Well Pad.
 - Installation of a pipeline corridor approximately 1,960-feet in length with a ROW width of 30-feet which will be co-located with the lease access road starting in the NENW of Section 17 T2N R97W and ending at the Well Pad. The pipeline corridor may contain up to four (4) buried pipelines for the transportation of natural gas and/or gas lift to an existing line in the NENW of Section 17, T2N R97W, and/or produced water take-away.

- Installation of a temporary lay-flat line to transport freshwater for operations which will reside in the access road ROW.
- 2) **Drilling, Completions and Flowback Phase:** Drilling operations consist of mobilizing a high efficiency rig, including power supply generators, drill pipe, casing pipe, fresh water and drilling mud tanks, temporary living quarters and additional facilities and equipment on location after construction has occurred. Drilling operations include drilling multiple stages and installing well casing. Once drilling a well commences the rig will “skid” or move to the next well, repeating the process for each well. Completions will consist of pumping freshwater mixed with a small percentage of proppant agents down each well hole. Anschutz estimates that 560K bbls of freshwater will be utilized to complete one (1) well. After completions commences flowback fluid is generated from the wells which produces produced water, oil, and some residual gas. Oil will be hauled off for sales and produced water will also be hauled off for injection at an approved facility or pumped through an injection line buried in the pipeline corridor.
- 3) **Production and Interim Reclamation Phase:** Once all of the wells are placed on long-term production each well will be equipped with a wellhead. Oil production will be routed to the 24 (750 bbl) crude oil tanks on location, produced water will be routed to the 8 (750 bbl) produced water tanks on location and gas will be separated and routed through the natural gas meter on location. Oil will be hauled off for sales. Produced water will either flow through a produced water injection line in the pipeline corridor or be hauled off location for injection at an approved facility. Each wellhead will be equipped with a telemetry system which allows for real time monitoring and automatic shut-in capabilities. Interim reclamation will occur within six (6) months of the last well completed on location, weather depending. After which the location will be routinely inspected to ensure reclamation standards and stormwater compliance are maintained throughout the life of the wells.

The anticipated truck traffic volumes are listed below for each phase and traffic and hauling will occur on State Highway 64, Rio Blanco County Road 77 and lease roads depicted on the attached road diagrams.

Phase	Maximum Anticipated Truck Trips
Construction	210
Drill rig mobilization	225
Drilling	750
Completions & Flowback Mobilization and Demobilization	60
Completions & Flowback	252
Production & Interim Reclamation	400

Any questions regarding this notice can be directed to Ms. Jennifer Bland at 303-298-1000 or Jennifer.Bland@aec-denver.com.

The Energy Carbon Management Commission can be reached at 303-894-2100 and the website can be found at <https://ecmc.state.co.us/#/home>.

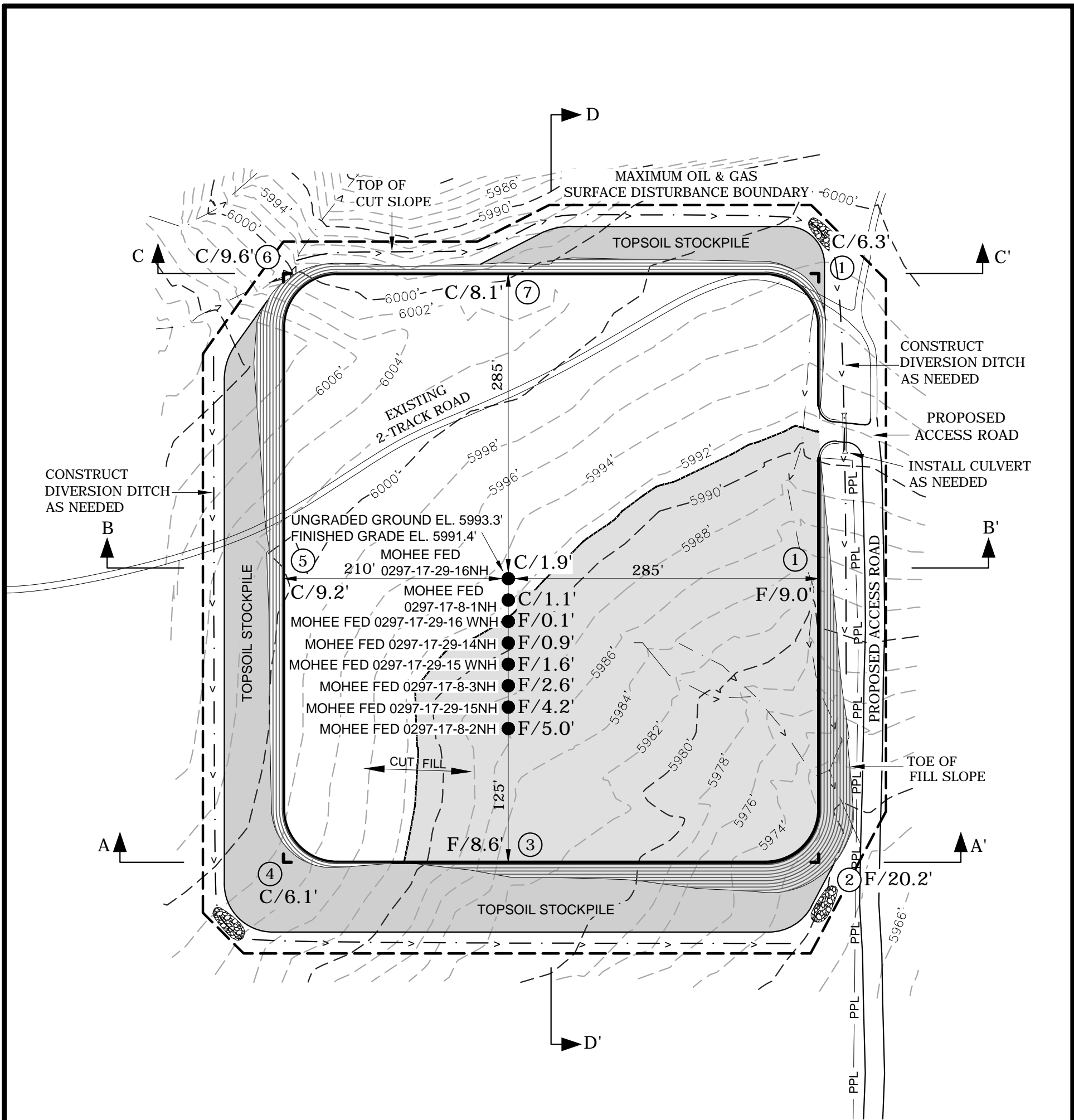

NOTE:
UNLESS OTHERWISE NOTED ALL
CUT/FILL SLOPES ARE AT 1.5:1

LEGEND

- = CENTER OF LOCATION
- - - - = EXISTING CONTOURS (2' INTERVALS)
- = PROPOSED CONTOURS (2' INTERVALS)
- - - - > - - - = EXISTING DRAINAGE
- ⊗ = WATER SETTLEMENT TRAP.
INSTALL RIP-RAP AS NEEDED

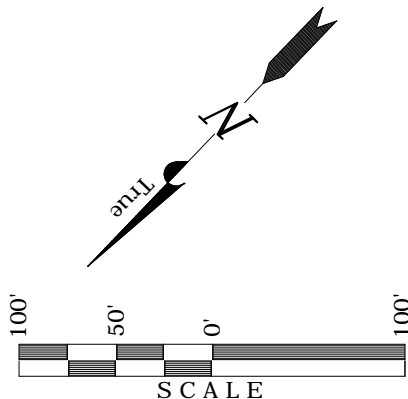

ANSCHUTZ
EXPLORATION CORPORATION
555 17th Street, Suite 2400 - Denver, Colorado 80202

PAD FOOTPRINT AREA = ±6.264 ACRES
PAD DISTURBANCE AREA (Cut/Fill Slopes, Stockpiles) = ±8.267 ACRES
AREA WITHIN MAXIMUM OIL & GAS SURFACE DISTURBANCE BOUNDARY = ±9.745 ACRES
ACCESS ROAD TEMPORARY DISTURBANCE = ±2.278 ACRES
ACCESS ROAD PERMANENT DISTURBANCE = ±1.367 ACRES
PIPELINE TEMPORARY DISTURBANCE = ±3.150 ACRES
PIPELINE PERMANENT DISTURBANCE = ±0.000 ACRES

WELL PAD - LOCATION LAYOUT

WELLS - MOHEE FED 0297-17-8-1NH, MOHEE FED 0297-17-29-16NH,
MOHEE FED 0297-17-29-16 WNH, MOHEE FED 0297-17-8-3NH,
MOHEE FED 0297-17-29-14NH, MOHEE FED 0297-17-29-15 WNH,
MOHEE FED 0297-17-8-2NH, MOHEE FED 0297-17-29-15NH
LOCATED IN SECTION 17, T2N, R97W, 6th P.M.,
RIO BLANCO COUNTY, COLORADO

ESTIMATED EARTHWORK QUANTITIES
(No shrink or swell adjustments have been used)
(Expressed in Cubic Yards)

6" Topsoil Stripping = 5,600
Remaining Cut = 37,060
TOTAL CUT = 42,660
FILL = 37,060
Excess Material = 0

TIMBERLINE

(435) 789-1365

ENGINEERING & LAND SURVEYING, INC.
209 NORTH 300 WEST - VERNAL, UTAH 84078

DATE SURVEYED:
7-11-23

SURVEYED BY: C.S.

SHEET

DATE DRAWN:
7-11-23

DRAWN BY: S.A.

13

SCALE: 1" = 100'

Date Last Revised:
10-4-23

OF 39

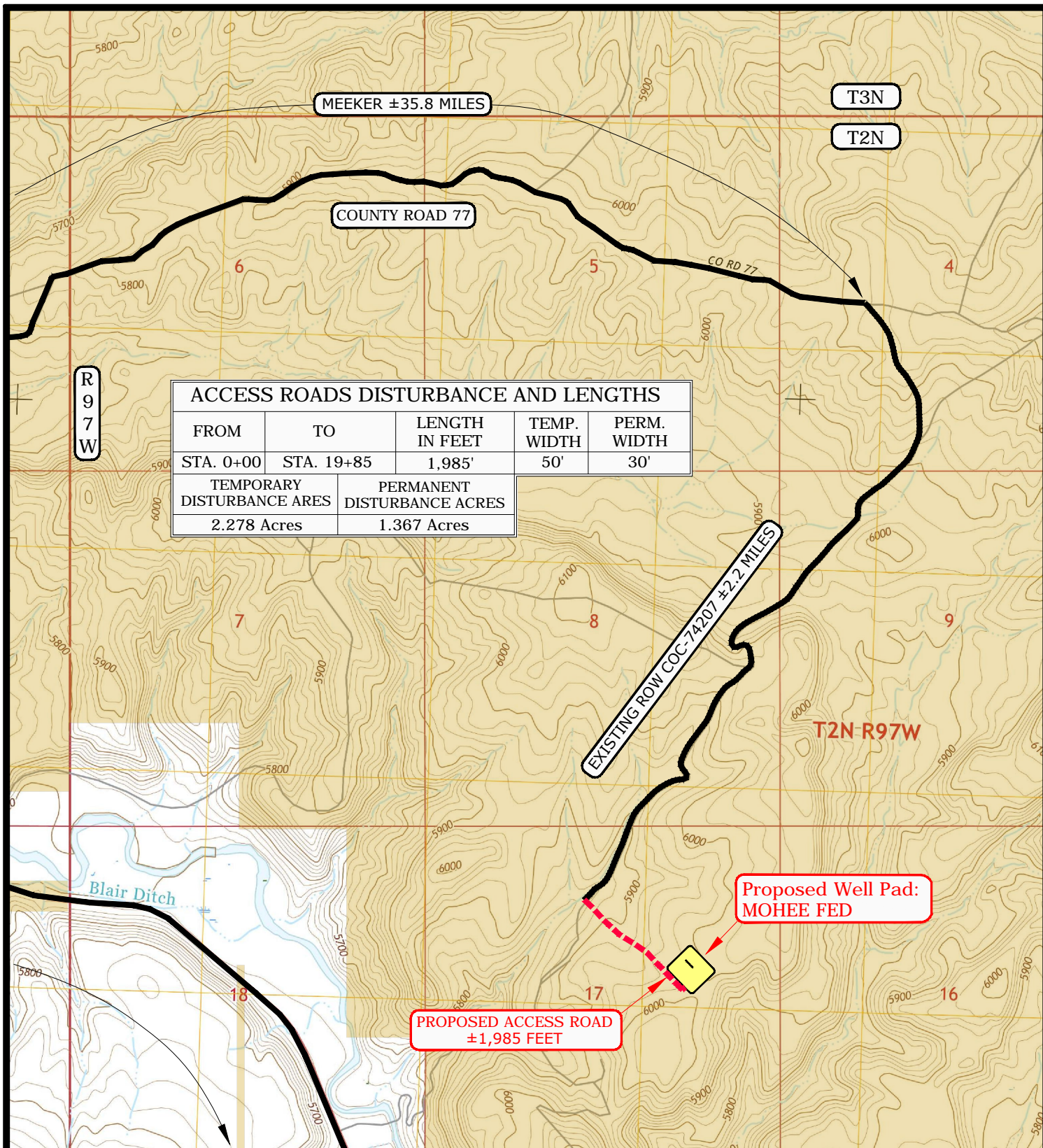

LEGEND

- PROPOSED ACCESS ROAD
 ■■■■ = SUBJECT WELL
 ■■■■ = OTHER WELLS
 — = EXISTING ROAD
 — = EXISTING ROAD (TO BE IMPROVED)
- (B-5460) = COUNTY ROAD CLASS & NUMBER
 — = LEASE LINE AND / OR PROPERTY LINE
 ■ = B.L.M. LANDS
 ■ = FEE

ANSCHUTZ EXPLORATION CORPORATION

555 17th Street, Suite 1800 - Denver, Colorado 80202

WELLS - MOHEE FED 0297-17-8-1NH, MOHEE FED 0297-17-29-16NH,
 MOHEE FED 0297-17-29-16 WNH, MOHEE FED 0297-17-8-3NH,
 MOHEE FED 0297-17-29-14NH, MOHEE FED 0297-17-29-15 WNH,
 MOHEE FED 0297-17-8-2NH, MOHEE FED 0297-17-29-15NH
 LOCATED IN SECTION 17, T2N, R97W, 6th P.M.,
 RIO BLANCO COUNTY, COLORADO

TOPOGRAPHIC MAP "B"

DATE SURVEYED: 7-11-23

DATE DRAWN: 7-20-23

SCALE: 1" = 2000'

DRAWN BY: S.A.

REVISED: 10-4-23

TIMBERLINE

(435) 789-1365

ENGINEERING & LAND SURVEYING, INC.
 209 NORTH 300 WEST - VERNAL, UTAH 84078

SHEET
21
 OF 39

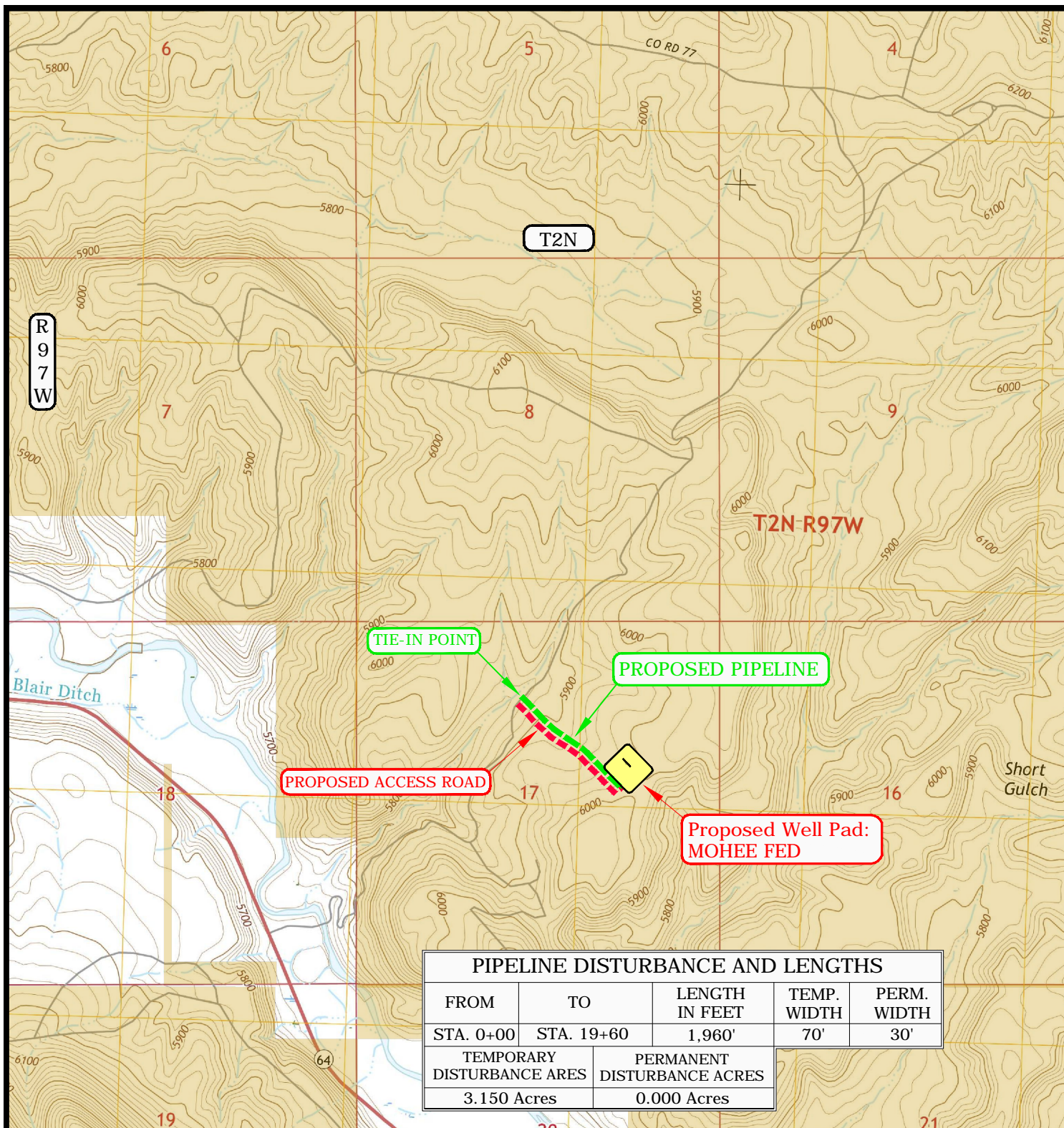

APPROXIMATE PIPELINE LENGTH = ±1,960 FEET

LEGEND

- = PROPOSED PIPELINE
- = OTHER PIPELINE
- = PROPOSED ACCESS ROAD
- = SUBJECT WELL
- = OTHER WELLS
- = LEASE LINE AND / OR PROPERTY LINE
- = PROPOSED WELL
- = B.L.M. LANDS
- = FEE

ANSCHUTZ EXPLORATION CORPORATION

555 17th Street, Suite 1800 - Denver, Colorado 80202

WELLS - MOHEE FED 0297-17-8-1NH, MOHEE FED 0297-17-29-16NH,
MOHEE FED 0297-17-29-16 WNH, MOHEE FED 0297-17-8-3NH,
MOHEE FED 0297-17-29-14NH, MOHEE FED 0297-17-29-15 WNH,
MOHEE FED 0297-17-8-2NH, MOHEE FED 0297-17-29-15NH
LOCATED IN SECTION 17, T2N, R97W, 6th P.M.,
RIO BLANCO COUNTY, COLORADO

TOPOGRAPHIC MAP "D"

DATE SURVEYED: 7-11-23

DATE DRAWN: 7-20-23

REVISED: 10-4-23

SCALE: 1" = 2000'

DRAWN BY: S.A.

TIMBERLINE

(435) 789-1365

ENGINEERING & LAND SURVEYING, INC.
209 NORTH 300 WEST - VERNAL, UTAH 84078

SHEET
30
OF 39