



1 F-106

*See correct copy*

RECEIVED

DEC 3 1971

R. 56W

COLO. OIL & GAS CORP. COMM.

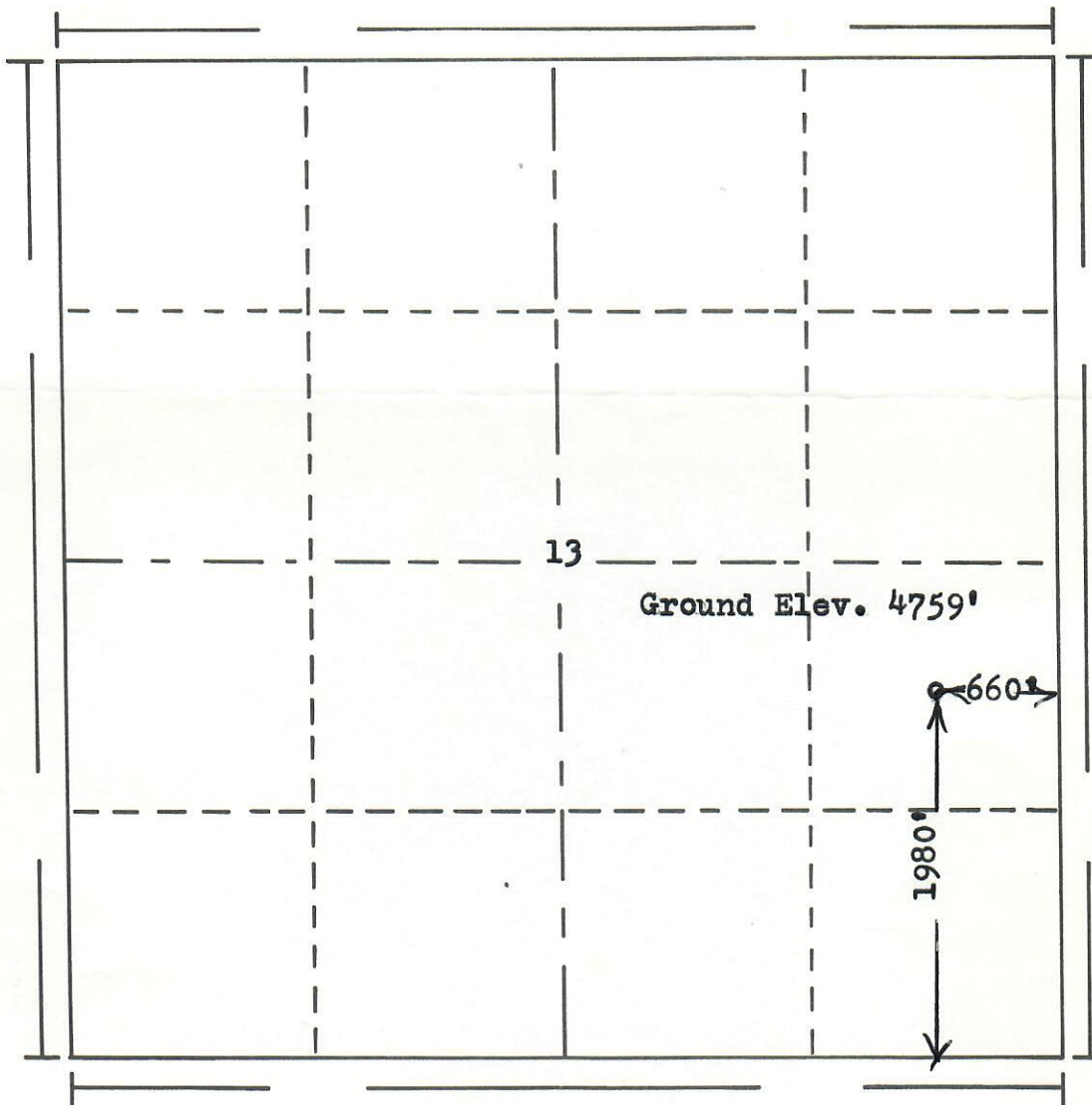
T.
3
S

Scale... 1" = 1000'

Powers Elevation Company, Inc. of Denver, Colorado
has in accordance with a request from Mr. Vickory
for Petro-Lewis Corp.

determined the location of No.1 Wright
to be CNE SE Section 13 Township 3S
Range 56W of the 6th Principal Meridian
Washington County, Colorado

I hereby certify that this plat is an
accurate representation of a correct
survey showing the location of

Date: 11-5-71

Ernest T. Hallman

Licensed Land Surveyor No. 2853
State of Colorado