

Interim Reclamation and Stormwater Inspection

Date: 01/24/2024

Operator: WESTERN OPERATING COMPANY - 95620

Location ID: 312229

Inspection Document #: 708200896

Logan County, CO

Dylan Edwardson
Reclamation Specialist, ECMC



COLORADO
Energy & Carbon Management
Commission
Department of Natural Resources

Inspection Photos
Location Name: Propst B3X
Location ID: 312229



Photo 1. Erosion degradation occurring along the production areas and the access road leading to the well.



Photo 2. Stormwater control measure/BMPs does not appear to be properly installed per good engineering practices (e.g. trenched and backfilled).

Inspection Photos
Location Name: Propst B3X
Location ID: 312229



Photo 3. Erosion degradation occurring along the access road to the well location.

Inspection Photos
Location Name: Propst B3X
Location ID: 312229



Photo 4. Trash and debris observed southwest of the tank battery.



Photo 5. NFPA placard has not been replaced at shed and stormwater erosion degradation observed along the north side of the pit.



Photo 6. Tumbleweed accumulations near the pit are considered debris and require removal.

Inspection Photos
Location Name: Propst B3X
Location ID: 312229



Photo 7. Erosion degradation occurring from the pit areas leading into the adjacent reference areas.

Inspection Photos
Location Name: Propst B3X
Location ID: 312229

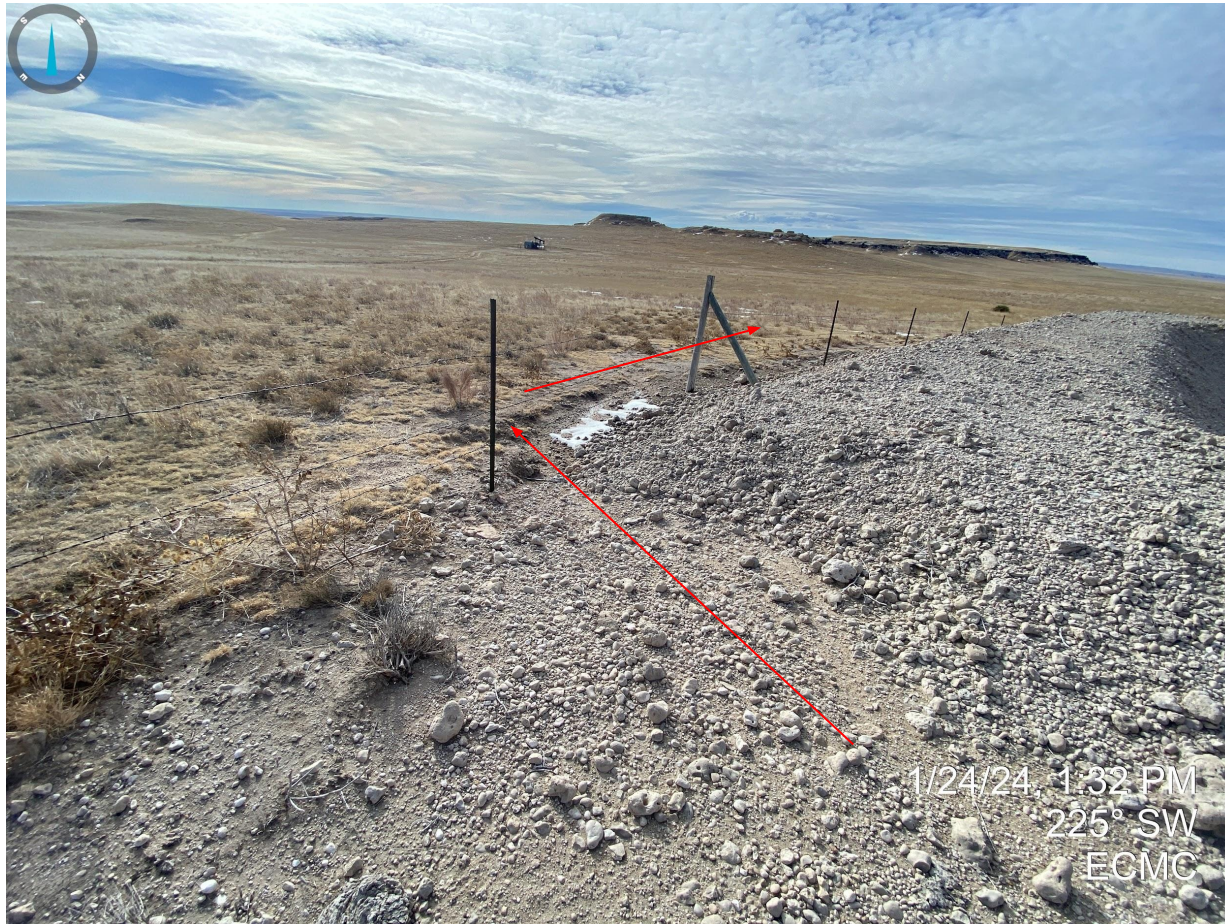

Photo 8. Continued from Photo 7, facing southwest.



Photo 9. Debris/trash within pit area.

Inspection Photos
Location Name: Propst B3X
Location ID: 312229



Photos 10 & 11. Erosion degradation occurring north of the meter shed. No visible stormwater control measures observed.

Inspection Photos
Location Name: Propst B3X
Location ID: 312229



Photo 12. Stained soil previously observed near pumpjack exhaust does not appear to have been cleaned up (red circle); other discoloration is likely from snowmelt.

Inspection Photos
Location Name: Propst B3X
Location ID: 312229



Photos 13 & 14. Stained soil observed near wellhead and fittings.



Photo 15. Northwest guyline anchor has been installed.