

# **CRESTONE PEAK RESOURCES**

**ADAMS COUNTY**

**SEC 28-T3S-R65W**

**FLORIDA 3-65 27-26 4BH**

**OWB**

**Plan: PROPOSAL 1**

## **Standard Planning Report**

**24 August, 2023**

Project: ADAMS COUNTY  
Site: SEC 28-T3S-R65W  
Well: FLORIDA 3-65 27-26 4BH  
Wellbore: OWB  
Design: PROPOSAL 1



Azimuths to True North  
Magnetic North: 7.51°  
Magnetic Field  
Strength: 51391.5nT  
Dip Angle: 66.07°  
Date: 8/22/2023  
Model: IGRF2020

WELL DETAILS: FLORIDA 3-65 27-26 4BH

+N/-S	+E/-W	Northing	Easting	5586.00	Latitude	Longitude	Slot
0.00	0.00	1156231.41	3235876.82	39.759159°N	104.660995°W		

SECTION DETAILS

Sec	MD	Inc	Azi	TVD	+N/-S	+E/-W	Dleg	TFace	VSec	Target
1	0.00	0.00	0.00	0.00	0.00	0.00	0.00	0.00	0.00	
2	200.00	0.00	0.00	200.00	0.00	0.00	0.00	0.00	0.00	
3	716.11	10.32	170.72	713.33	-45.76	7.48	2.00	170.72	13.22	
4	7251.56	10.32	170.72	7142.99	-1201.48	196.35	0.00	0.00	347.02	
5	8134.35	90.00	90.37	7690.00	-1303.35	768.41	10.00	-80.51	927.38	LP-FLORIDA 3-65 27-26 4BH
6	18063.44	90.00	90.37	7690.00	-1366.63	10697.30	0.00	0.00	10784.25	PBHL-FLORIDA 3-65 27-26 4BH

ANNOTATIONS

MD	Inc	Azi	TVD	+N/-S	+E/-W	VSec	Departure	Annotation
200.00	0.00	0.00	200.00	0.00	0.00	0.00	0.00	Start Build 2.00
716.11	10.32	170.72	713.33	-45.76	7.48	13.22	46.37	Start 6535.44 hold at 716.11 MD
7251.56	10.32	170.72	7142.99	-1201.48	196.35	347.02	1217.42	Start DLS 10.00 TFO -80.51
8134.35	90.00	90.37	7690.00	-1303.35	768.41	927.38	1811.25	Start 9929.10 hold at 8134.35 MD
18063.44	90.00	90.37	7690.00	-1366.63	10697.30	10784.25	11740.34	TD at 18063.44

DESIGN TARGET DETAILS

Name	TVD	+N/-S	+E/-W	Northing	Easting	Latitude	Longitude	Shape
LP-FLORIDA 3-65 27-26 4BH	7690.00	-1303.35	768.41	1154935.40	3236657.52	39.755581°N	104.658262°W	Point
- plan hits target center								
PBHL-FLORIDA 3-65 27-26 4BH	7690.00	-1366.63	10697.30	1154966.06	3246586.51	39.755401°N	104.622948°W	Point
- plan hits target center								

PROJECT DETAILS: ADAMS COUNTY

Geodetic System: US State Plane 1983  
Datum: North American Datum 1983  
Ellipsoid: GRS 1980  
Zone: Colorado Northern Zone

System Datum: Mean Sea Level

SHL:  
1698' FSL, 435' FEL  
Sec 28-T3S-R65W

LP:  
400' FSL, 330' FWL  
Sec 27-T3S-R65W

BHL:  
400' FSL, 330' FEL  
Sec 26-T3S-R65W

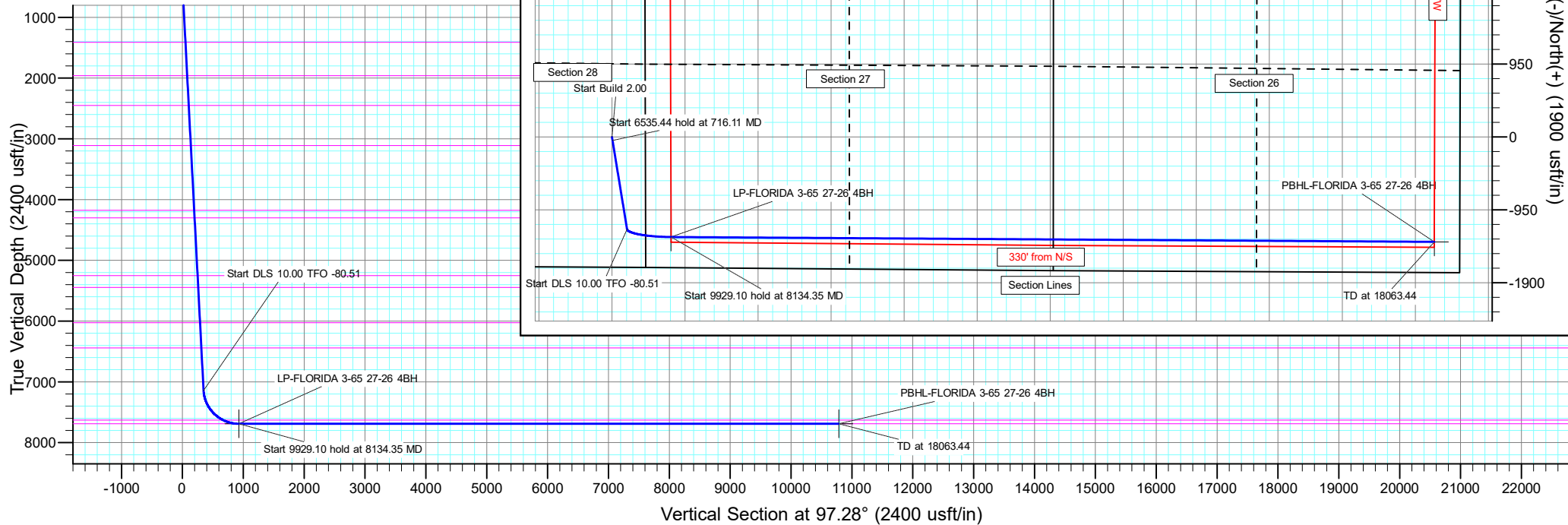

# Civitas Resources

## Planning Report

<b>Database:</b>	EDM	<b>Local Co-ordinate Reference:</b>	Well FLORIDA 3-65 27-26 4BH
<b>Company:</b>	CRESTONE PEAK RESOURCES	<b>TVD Reference:</b>	KB 25' @ 5611.00usft
<b>Project:</b>	ADAMS COUNTY	<b>MD Reference:</b>	KB 25' @ 5611.00usft
<b>Site:</b>	SEC 28-T3S-R65W	<b>North Reference:</b>	True
<b>Well:</b>	FLORIDA 3-65 27-26 4BH	<b>Survey Calculation Method:</b>	Minimum Curvature
<b>Wellbore:</b>	OWB		
<b>Design:</b>	PROPOSAL 1		

<b>Project</b>	ADAMS COUNTY		
<b>Map System:</b>	US State Plane 1983	<b>System Datum:</b>	Mean Sea Level
<b>Geo Datum:</b>	North American Datum 1983		
<b>Map Zone:</b>	Colorado Northern Zone		Using geodetic scale factor

<b>Site</b>	SEC 28-T3S-R65W		
<b>Site Position:</b>		<b>Northing:</b>	1,154,535.24 usft
<b>From:</b>	Lat/Long	<b>Easting:</b>	3,236,332.63 usft
<b>Position Uncertainty:</b>	0.00 usft	<b>Slot Radius:</b>	13.200 in
		<b>Latitude:</b>	39.754491°N
		<b>Longitude:</b>	104.659431°W
		<b>Grid Convergence:</b>	0.54 °

Well	FLORIDA 3-65 27-26 4BH					
Well Position	+N/-S	1,700.42 usft	Northing:	1,156,231.40 usft	Latitude:	39.759159°N
	+E/-W	-439.71 usft	Easting:	3,235,876.82 usft	Longitude:	104.660995°W
Position Uncertainty		0.00 usft	Wellhead Elevation:		Ground Level:	5,586.00 usft

<b>Wellbore</b>	OWB				
<b>Magnetics</b>	<b>Model Name</b>	<b>Sample Date</b>	<b>Declination (°)</b>	<b>Dip Angle (°)</b>	<b>Field Strength (nT)</b>
	IGRF2020	8/22/2023	7.51	66.07	51,391.49943993

<b>Design</b>	PROPOSAL 1			
<b>Audit Notes:</b>				
<b>Version:</b>	<b>Phase:</b>	PROTOTYPE	<b>Tie On Depth:</b>	0.00
<b>Vertical Section:</b>	<b>Depth From (TVD) (usft)</b>	<b>+N/-S (usft)</b>	<b>+E/-W (usft)</b>	<b>Direction (°)</b>
	0.00	0.00	0.00	97.28

<b>Plan Survey Tool Program</b>	<b>Date</b>	8/24/2023		
<b>Depth From (usft)</b>	<b>Depth To (usft)</b>	<b>Survey (Wellbore)</b>	<b>Tool Name</b>	<b>Remarks</b>
1	0.00	18,063.44	PROPOSAL 1 (OWB)	MWD OWSG
				OWSG MWD - Standard

<b>Plan Sections</b>										
<b>Measured Depth (usft)</b>	<b>Inclination (°)</b>	<b>Azimuth (°)</b>	<b>Vertical Depth (usft)</b>	<b>+N/-S (usft)</b>	<b>+E/-W (usft)</b>	<b>Dogleg Rate (°/100ft)</b>	<b>Build Rate (°/100ft)</b>	<b>Turn Rate (°/100ft)</b>	<b>TFO (°)</b>	<b>Target</b>
0.00	0.00	0.00	0.00	0.00	0.00	0.00	0.00	0.00	0.00	
200.00	0.00	0.00	200.00	0.00	0.00	0.00	0.00	0.00	0.00	
716.11	10.32	170.72	713.33	-45.76	7.48	2.00	2.00	0.00	170.72	
7,251.56	10.32	170.72	7,143.00	-1,201.48	196.35	0.00	0.00	0.00	0.00	
8,134.35	90.00	90.37	7,690.00	-1,303.35	768.41	10.00	9.03	-9.10	-80.51	LP-FLORIDA 3-65 27
18,063.44	90.00	90.37	7,690.00	-1,366.63	10,697.30	0.00	0.00	0.00	0.00	PBHL-FLORIDA 3-65

# Civitas Resources

## Planning Report

<b>Database:</b>	EDM	<b>Local Co-ordinate Reference:</b>	Well FLORIDA 3-65 27-26 4BH
<b>Company:</b>	CRESTONE PEAK RESOURCES	<b>TVD Reference:</b>	KB 25' @ 5611.00usft
<b>Project:</b>	ADAMS COUNTY	<b>MD Reference:</b>	KB 25' @ 5611.00usft
<b>Site:</b>	SEC 28-T3S-R65W	<b>North Reference:</b>	True
<b>Well:</b>	FLORIDA 3-65 27-26 4BH	<b>Survey Calculation Method:</b>	Minimum Curvature
<b>Wellbore:</b>	OWB		
<b>Design:</b>	PROPOSAL 1		

Planned Survey									
Measured Depth (usft)	Inclination (°)	Azimuth (°)	Vertical Depth (usft)	+N/-S (usft)	+E/-W (usft)	Vertical Section (usft)	Dogleg Rate (°/100ft)	Build Rate (°/100ft)	Turn Rate (°/100ft)
0.00	0.00	0.00	0.00	0.00	0.00	0.00	0.00	0.00	0.00
24.00	0.00	0.00	24.00	0.00	0.00	0.00	0.00	0.00	0.00
Denver									
100.00	0.00	0.00	100.00	0.00	0.00	0.00	0.00	0.00	0.00
200.00	0.00	0.00	200.00	0.00	0.00	0.00	0.00	0.00	0.00
Start Build 2.00									
300.00	2.00	170.72	299.98	-1.72	0.28	0.50	2.00	2.00	0.00
400.00	4.00	170.72	399.84	-6.89	1.13	1.99	2.00	2.00	0.00
500.00	6.00	170.72	499.45	-15.49	2.53	4.47	2.00	2.00	0.00
600.00	8.00	170.72	598.70	-27.51	4.50	7.95	2.00	2.00	0.00
700.00	10.00	170.72	697.47	-42.95	7.02	12.41	2.00	2.00	0.00
716.11	10.32	170.72	713.33	-45.76	7.48	13.22	2.00	2.00	0.00
Start 6535.44 hold at 716.11 MD									
763.56	10.32	170.72	760.00	-54.15	8.85	15.64	0.00	0.00	0.00
Arapahoe									
800.00	10.32	170.72	795.85	-60.59	9.90	17.50	0.00	0.00	0.00
900.00	10.32	170.72	894.24	-78.28	12.79	22.61	0.00	0.00	0.00
1,000.00	10.32	170.72	992.62	-95.96	15.68	27.72	0.00	0.00	0.00
1,100.00	10.32	170.72	1,091.00	-113.64	18.57	32.82	0.00	0.00	0.00
1,200.00	10.32	170.72	1,189.38	-131.33	21.46	37.93	0.00	0.00	0.00
1,300.00	10.32	170.72	1,287.76	-149.01	24.35	43.04	0.00	0.00	0.00
1,400.00	10.32	170.72	1,386.14	-166.70	27.24	48.15	0.00	0.00	0.00
1,424.25	10.32	170.72	1,410.00	-170.98	27.94	49.39	0.00	0.00	0.00
Laramie-Fox Hills Formation									
1,500.00	10.32	170.72	1,484.53	-184.38	30.13	53.25	0.00	0.00	0.00
1,600.00	10.32	170.72	1,582.91	-202.06	33.02	58.36	0.00	0.00	0.00
1,700.00	10.32	170.72	1,681.29	-219.75	35.91	63.47	0.00	0.00	0.00
1,800.00	10.32	170.72	1,779.67	-237.43	38.80	68.58	0.00	0.00	0.00
1,900.00	10.32	170.72	1,878.05	-255.12	41.69	73.68	0.00	0.00	0.00
1,983.30	10.32	170.72	1,960.00	-269.85	44.10	77.94	0.00	0.00	0.00
Pierre Formation									
2,000.00	10.32	170.72	1,976.43	-272.80	44.58	78.79	0.00	0.00	0.00
2,100.00	10.32	170.72	2,074.82	-290.48	47.47	83.90	0.00	0.00	0.00
2,200.00	10.32	170.72	2,173.20	-308.17	50.36	89.01	0.00	0.00	0.00
2,300.00	10.32	170.72	2,271.58	-325.85	53.25	94.12	0.00	0.00	0.00
2,400.00	10.32	170.72	2,369.96	-343.53	56.14	99.22	0.00	0.00	0.00
2,481.36	10.32	170.72	2,450.00	-357.92	58.49	103.38	0.00	0.00	0.00
Upper Pierre aquifer									
2,500.00	10.32	170.72	2,468.34	-361.22	59.03	104.33	0.00	0.00	0.00
2,600.00	10.32	170.72	2,566.72	-378.90	61.92	109.44	0.00	0.00	0.00
2,700.00	10.32	170.72	2,665.10	-396.59	64.81	114.55	0.00	0.00	0.00
2,800.00	10.32	170.72	2,763.49	-414.27	67.70	119.65	0.00	0.00	0.00
2,900.00	10.32	170.72	2,861.87	-431.95	70.59	124.76	0.00	0.00	0.00
3,000.00	10.32	170.72	2,960.25	-449.64	73.48	129.87	0.00	0.00	0.00
3,100.00	10.32	170.72	3,058.63	-467.32	76.37	134.98	0.00	0.00	0.00
3,152.21	10.32	170.72	3,110.00	-476.56	77.88	137.64	0.00	0.00	0.00
Base of Upper Pierre aquifer									
3,200.00	10.32	170.72	3,157.01	-485.01	79.26	140.08	0.00	0.00	0.00
3,300.00	10.32	170.72	3,255.39	-502.69	82.15	145.19	0.00	0.00	0.00
3,400.00	10.32	170.72	3,353.78	-520.37	85.04	150.30	0.00	0.00	0.00
3,500.00	10.32	170.72	3,452.16	-538.06	87.93	155.41	0.00	0.00	0.00
3,600.00	10.32	170.72	3,550.54	-555.74	90.82	160.51	0.00	0.00	0.00
3,700.00	10.32	170.72	3,648.92	-573.43	93.71	165.62	0.00	0.00	0.00

# Civitas Resources

## Planning Report

<b>Database:</b>	EDM	<b>Local Co-ordinate Reference:</b>	Well FLORIDA 3-65 27-26 4BH
<b>Company:</b>	CRESTONE PEAK RESOURCES	<b>TVD Reference:</b>	KB 25' @ 5611.00usft
<b>Project:</b>	ADAMS COUNTY	<b>MD Reference:</b>	KB 25' @ 5611.00usft
<b>Site:</b>	SEC 28-T3S-R65W	<b>North Reference:</b>	True
<b>Well:</b>	FLORIDA 3-65 27-26 4BH	<b>Survey Calculation Method:</b>	Minimum Curvature
<b>Wellbore:</b>	OWB		
<b>Design:</b>	PROPOSAL 1		

Planned Survey									
Measured Depth (usft)	Inclination (°)	Azimuth (°)	Vertical Depth (usft)	+N/-S (usft)	+E/-W (usft)	Vertical Section (usft)	Dogleg Rate (°/100ft)	Build Rate (°/100ft)	Turn Rate (°/100ft)
3,800.00	10.32	170.72	3,747.30	-591.11	96.60	170.73	0.00	0.00	0.00
3,900.00	10.32	170.72	3,845.68	-608.79	99.49	175.84	0.00	0.00	0.00
4,000.00	10.32	170.72	3,944.06	-626.48	102.38	180.95	0.00	0.00	0.00
4,100.00	10.32	170.72	4,042.45	-644.16	105.27	186.05	0.00	0.00	0.00
4,200.00	10.32	170.72	4,140.83	-661.84	108.16	191.16	0.00	0.00	0.00
4,234.73	10.32	170.72	4,175.00	-667.99	109.16	192.93	0.00	0.00	0.00
Larimer ("Parkman") sandstone									
4,300.00	10.32	170.72	4,239.21	-679.53	111.05	196.27	0.00	0.00	0.00
4,361.79	10.32	170.72	4,300.00	-690.46	112.84	199.42	0.00	0.00	0.00
Pierre Formation									
4,400.00	10.32	170.72	4,337.59	-697.21	113.94	201.38	0.00	0.00	0.00
4,500.00	10.32	170.72	4,435.97	-714.90	116.83	206.48	0.00	0.00	0.00
4,600.00	10.32	170.72	4,534.35	-732.58	119.72	211.59	0.00	0.00	0.00
4,700.00	10.32	170.72	4,632.74	-750.26	122.61	216.70	0.00	0.00	0.00
4,800.00	10.32	170.72	4,731.12	-767.95	125.50	221.81	0.00	0.00	0.00
4,900.00	10.32	170.72	4,829.50	-785.63	128.39	226.91	0.00	0.00	0.00
5,000.00	10.32	170.72	4,927.88	-803.32	131.28	232.02	0.00	0.00	0.00
5,100.00	10.32	170.72	5,026.26	-821.00	134.17	237.13	0.00	0.00	0.00
5,200.00	10.32	170.72	5,124.64	-838.68	137.06	242.24	0.00	0.00	0.00
5,300.00	10.32	170.72	5,223.02	-856.37	139.95	247.34	0.00	0.00	0.00
5,327.42	10.32	170.72	5,250.00	-861.22	140.74	248.74	0.00	0.00	0.00
Terry ("Sussex") sandstone									
5,400.00	10.32	170.72	5,321.41	-874.05	142.84	252.45	0.00	0.00	0.00
5,500.00	10.32	170.72	5,419.79	-891.74	145.73	257.56	0.00	0.00	0.00
5,525.63	10.32	170.72	5,445.00	-896.27	146.47	258.87	0.00	0.00	0.00
Pierre Formation									
5,600.00	10.32	170.72	5,518.17	-909.42	148.62	262.67	0.00	0.00	0.00
5,700.00	10.32	170.72	5,616.55	-927.10	151.51	267.77	0.00	0.00	0.00
5,800.00	10.32	170.72	5,714.93	-944.79	154.40	272.88	0.00	0.00	0.00
5,900.00	10.32	170.72	5,813.31	-962.47	157.29	277.99	0.00	0.00	0.00
6,000.00	10.32	170.72	5,911.70	-980.15	160.18	283.10	0.00	0.00	0.00
6,100.00	10.32	170.72	6,010.08	-997.84	163.07	288.21	0.00	0.00	0.00
6,115.17	10.32	170.72	6,025.00	-1,000.52	163.51	288.98	0.00	0.00	0.00
Hygiene ("Shannon") sandstone									
6,200.00	10.32	170.72	6,108.46	-1,015.52	165.96	293.31	0.00	0.00	0.00
6,300.00	10.32	170.72	6,206.84	-1,033.21	168.85	298.42	0.00	0.00	0.00
6,400.00	10.32	170.72	6,305.22	-1,050.89	171.74	303.53	0.00	0.00	0.00
6,500.00	10.32	170.72	6,403.60	-1,068.57	174.63	308.64	0.00	0.00	0.00
6,537.00	10.32	170.72	6,440.00	-1,075.12	175.70	310.53	0.00	0.00	0.00
Pierre Formation									
6,600.00	10.32	170.72	6,501.98	-1,086.26	177.52	313.74	0.00	0.00	0.00
6,700.00	10.32	170.72	6,600.37	-1,103.94	180.41	318.85	0.00	0.00	0.00
6,800.00	10.32	170.72	6,698.75	-1,121.63	183.30	323.96	0.00	0.00	0.00
6,900.00	10.32	170.72	6,797.13	-1,139.31	186.19	329.07	0.00	0.00	0.00
7,000.00	10.32	170.72	6,895.51	-1,156.99	189.08	334.17	0.00	0.00	0.00
7,100.00	10.32	170.72	6,993.89	-1,174.68	191.97	339.28	0.00	0.00	0.00
7,200.00	10.32	170.72	7,092.27	-1,192.36	194.86	344.39	0.00	0.00	0.00
7,251.56	10.32	170.72	7,143.00	-1,201.48	196.35	347.02	0.00	0.00	0.00
Start DLS 10.00 TFO -80.51									
7,300.00	12.09	147.29	7,190.54	-1,210.04	199.79	351.52	10.00	3.66	-48.36
7,350.00	15.36	131.18	7,239.12	-1,218.81	207.61	360.39	10.00	6.53	-32.23
7,400.00	19.37	121.08	7,286.84	-1,227.46	219.70	373.48	10.00	8.01	-20.20
7,450.00	23.74	114.46	7,333.34	-1,235.91	235.98	390.70	10.00	8.75	-13.25

# Civitas Resources

## Planning Report

<b>Database:</b>	EDM	<b>Local Co-ordinate Reference:</b>	Well FLORIDA 3-65 27-26 4BH
<b>Company:</b>	CRESTONE PEAK RESOURCES	<b>TVD Reference:</b>	KB 25' @ 5611.00usft
<b>Project:</b>	ADAMS COUNTY	<b>MD Reference:</b>	KB 25' @ 5611.00usft
<b>Site:</b>	SEC 28-T3S-R65W	<b>North Reference:</b>	True
<b>Well:</b>	FLORIDA 3-65 27-26 4BH	<b>Survey Calculation Method:</b>	Minimum Curvature
<b>Wellbore:</b>	OWB		
<b>Design:</b>	PROPOSAL 1		

Planned Survey									
Measured Depth (usft)	Inclination (°)	Azimuth (°)	Vertical Depth (usft)	+N/-S (usft)	+E/-W (usft)	Vertical Section (usft)	Dogleg Rate (°/100ft)	Build Rate (°/100ft)	Turn Rate (°/100ft)
7,500.00	28.32	109.83	7,378.26	-1,244.11	256.31	411.90	10.00	9.15	-9.25
7,550.00	33.00	106.41	7,421.27	-1,251.98	280.54	436.94	10.00	9.38	-6.84
7,600.00	37.76	103.77	7,462.02	-1,259.48	308.49	465.61	10.00	9.52	-5.29
7,650.00	42.57	101.64	7,500.22	-1,266.54	339.95	497.71	10.00	9.62	-4.26
7,700.00	47.41	99.86	7,535.57	-1,273.11	374.67	532.98	10.00	9.68	-3.54
7,750.00	52.28	98.35	7,567.80	-1,279.13	412.39	571.17	10.00	9.73	-3.03
7,800.00	57.16	97.02	7,596.68	-1,284.58	452.83	611.97	10.00	9.76	-2.66
7,850.00	62.05	95.83	7,621.97	-1,289.39	495.67	655.08	10.00	9.79	-2.38
7,867.65	63.78	95.44	7,630.00	-1,290.93	511.31	670.78	10.00	9.80	-2.23
Sharon Springs Member									
7,900.00	66.96	94.75	7,643.48	-1,293.54	540.60	700.16	10.00	9.81	-2.14
7,950.00	71.87	93.74	7,661.06	-1,296.99	587.26	746.89	10.00	9.82	-2.02
8,000.00	76.78	92.78	7,674.57	-1,299.73	635.31	794.90	10.00	9.83	-1.91
8,050.00	81.70	91.87	7,683.90	-1,301.71	684.37	843.82	10.00	9.84	-1.83
8,100.00	86.62	90.97	7,688.99	-1,302.94	734.08	893.28	10.00	9.84	-1.79
8,134.35	90.00	90.37	7,690.00	-1,303.35	768.41	927.38	10.00	9.84	-1.77
Start 9929.10 hold at 8134.35 MD - Niobrara Formation									
8,200.00	90.00	90.37	7,690.00	-1,303.76	834.06	992.56	0.00	0.00	0.00
8,300.00	90.00	90.37	7,690.00	-1,304.40	934.06	1,091.83	0.00	0.00	0.00
8,400.00	90.00	90.37	7,690.00	-1,305.04	1,034.06	1,191.10	0.00	0.00	0.00
8,500.00	90.00	90.37	7,690.00	-1,305.68	1,134.05	1,290.37	0.00	0.00	0.00
8,600.00	90.00	90.37	7,690.00	-1,306.31	1,234.05	1,389.65	0.00	0.00	0.00
8,700.00	90.00	90.37	7,690.00	-1,306.95	1,334.05	1,488.92	0.00	0.00	0.00
8,800.00	90.00	90.37	7,690.00	-1,307.59	1,434.05	1,588.19	0.00	0.00	0.00
8,900.00	90.00	90.37	7,690.00	-1,308.23	1,534.05	1,687.46	0.00	0.00	0.00
9,000.00	90.00	90.37	7,690.00	-1,308.86	1,634.04	1,786.74	0.00	0.00	0.00
9,100.00	90.00	90.37	7,690.00	-1,309.50	1,734.04	1,886.01	0.00	0.00	0.00
9,200.00	90.00	90.37	7,690.00	-1,310.14	1,834.04	1,985.28	0.00	0.00	0.00
9,300.00	90.00	90.37	7,690.00	-1,310.77	1,934.04	2,084.55	0.00	0.00	0.00
9,400.00	90.00	90.37	7,690.00	-1,311.41	2,034.04	2,183.83	0.00	0.00	0.00
9,500.00	90.00	90.37	7,690.00	-1,312.05	2,134.03	2,283.10	0.00	0.00	0.00
9,600.00	90.00	90.37	7,690.00	-1,312.69	2,234.03	2,382.37	0.00	0.00	0.00
9,700.00	90.00	90.37	7,690.00	-1,313.32	2,334.03	2,481.64	0.00	0.00	0.00
9,800.00	90.00	90.37	7,690.00	-1,313.96	2,434.03	2,580.92	0.00	0.00	0.00
9,900.00	90.00	90.37	7,690.00	-1,314.60	2,534.03	2,680.19	0.00	0.00	0.00
10,000.00	90.00	90.37	7,690.00	-1,315.24	2,634.02	2,779.46	0.00	0.00	0.00
10,100.00	90.00	90.37	7,690.00	-1,315.87	2,734.02	2,878.73	0.00	0.00	0.00
10,200.00	90.00	90.37	7,690.00	-1,316.51	2,834.02	2,978.01	0.00	0.00	0.00
10,300.00	90.00	90.37	7,690.00	-1,317.15	2,934.02	3,077.28	0.00	0.00	0.00
10,400.00	90.00	90.37	7,690.00	-1,317.79	3,034.02	3,176.55	0.00	0.00	0.00
10,500.00	90.00	90.37	7,690.00	-1,318.42	3,134.01	3,275.82	0.00	0.00	0.00
10,600.00	90.00	90.37	7,690.00	-1,319.06	3,234.01	3,375.10	0.00	0.00	0.00
10,700.00	90.00	90.37	7,690.00	-1,319.70	3,334.01	3,474.37	0.00	0.00	0.00
10,800.00	90.00	90.37	7,690.00	-1,320.34	3,434.01	3,573.64	0.00	0.00	0.00
10,900.00	90.00	90.37	7,690.00	-1,320.97	3,534.01	3,672.91	0.00	0.00	0.00
11,000.00	90.00	90.37	7,690.00	-1,321.61	3,634.00	3,772.19	0.00	0.00	0.00
11,100.00	90.00	90.37	7,690.00	-1,322.25	3,734.00	3,871.46	0.00	0.00	0.00
11,200.00	90.00	90.37	7,690.00	-1,322.89	3,834.00	3,970.73	0.00	0.00	0.00
11,300.00	90.00	90.37	7,690.00	-1,323.52	3,934.00	4,070.00	0.00	0.00	0.00
11,400.00	90.00	90.37	7,690.00	-1,324.16	4,034.00	4,169.28	0.00	0.00	0.00
11,500.00	90.00	90.37	7,690.00	-1,324.80	4,133.99	4,268.55	0.00	0.00	0.00
11,600.00	90.00	90.37	7,690.00	-1,325.43	4,233.99	4,367.82	0.00	0.00	0.00
11,700.00	90.00	90.37	7,690.00	-1,326.07	4,333.99	4,467.09	0.00	0.00	0.00
11,800.00	90.00	90.37	7,690.00	-1,326.71	4,433.99	4,566.37	0.00	0.00	0.00

# Civitas Resources

## Planning Report

<b>Database:</b>	EDM	<b>Local Co-ordinate Reference:</b>	Well FLORIDA 3-65 27-26 4BH
<b>Company:</b>	CRESTONE PEAK RESOURCES	<b>TVD Reference:</b>	KB 25' @ 5611.00usft
<b>Project:</b>	ADAMS COUNTY	<b>MD Reference:</b>	KB 25' @ 5611.00usft
<b>Site:</b>	SEC 28-T3S-R65W	<b>North Reference:</b>	True
<b>Well:</b>	FLORIDA 3-65 27-26 4BH	<b>Survey Calculation Method:</b>	Minimum Curvature
<b>Wellbore:</b>	OWB		
<b>Design:</b>	PROPOSAL 1		

Planned Survey										
Measured Depth (usft)	Inclination (°)	Azimuth (°)	Vertical Depth (usft)	+N/-S (usft)	+E/-W (usft)	Vertical Section (usft)	Dogleg Rate (°/100ft)	Build Rate (°/100ft)	Turn Rate (°/100ft)	
11,900.00	90.00	90.37	7,690.00	-1,327.35	4,533.99	4,665.64	0.00	0.00	0.00	
12,000.00	90.00	90.37	7,690.00	-1,327.98	4,633.98	4,764.91	0.00	0.00	0.00	
12,100.00	90.00	90.37	7,690.00	-1,328.62	4,733.98	4,864.18	0.00	0.00	0.00	
12,200.00	90.00	90.37	7,690.00	-1,329.26	4,833.98	4,963.46	0.00	0.00	0.00	
12,300.00	90.00	90.37	7,690.00	-1,329.90	4,933.98	5,062.73	0.00	0.00	0.00	
12,400.00	90.00	90.37	7,690.00	-1,330.53	5,033.97	5,162.00	0.00	0.00	0.00	
12,500.00	90.00	90.37	7,690.00	-1,331.17	5,133.97	5,261.27	0.00	0.00	0.00	
12,600.00	90.00	90.37	7,690.00	-1,331.81	5,233.97	5,360.55	0.00	0.00	0.00	
12,700.00	90.00	90.37	7,690.00	-1,332.45	5,333.97	5,459.82	0.00	0.00	0.00	
12,800.00	90.00	90.37	7,690.00	-1,333.08	5,433.97	5,559.09	0.00	0.00	0.00	
12,900.00	90.00	90.37	7,690.00	-1,333.72	5,533.96	5,658.36	0.00	0.00	0.00	
13,000.00	90.00	90.37	7,690.00	-1,334.36	5,633.96	5,757.64	0.00	0.00	0.00	
13,100.00	90.00	90.37	7,690.00	-1,335.00	5,733.96	5,856.91	0.00	0.00	0.00	
13,200.00	90.00	90.37	7,690.00	-1,335.63	5,833.96	5,956.18	0.00	0.00	0.00	
13,300.00	90.00	90.37	7,690.00	-1,336.27	5,933.96	6,055.46	0.00	0.00	0.00	
13,400.00	90.00	90.37	7,690.00	-1,336.91	6,033.95	6,154.73	0.00	0.00	0.00	
13,500.00	90.00	90.37	7,690.00	-1,337.54	6,133.95	6,254.00	0.00	0.00	0.00	
13,600.00	90.00	90.37	7,690.00	-1,338.18	6,233.95	6,353.27	0.00	0.00	0.00	
13,700.00	90.00	90.37	7,690.00	-1,338.82	6,333.95	6,452.55	0.00	0.00	0.00	
13,800.00	90.00	90.37	7,690.00	-1,339.46	6,433.95	6,551.82	0.00	0.00	0.00	
13,900.00	90.00	90.37	7,690.00	-1,340.09	6,533.94	6,651.09	0.00	0.00	0.00	
14,000.00	90.00	90.37	7,690.00	-1,340.73	6,633.94	6,750.36	0.00	0.00	0.00	
14,100.00	90.00	90.37	7,690.00	-1,341.37	6,733.94	6,849.64	0.00	0.00	0.00	
14,200.00	90.00	90.37	7,690.00	-1,342.01	6,833.94	6,948.91	0.00	0.00	0.00	
14,300.00	90.00	90.37	7,690.00	-1,342.64	6,933.94	7,048.18	0.00	0.00	0.00	
14,400.00	90.00	90.37	7,690.00	-1,343.28	7,033.93	7,147.45	0.00	0.00	0.00	
14,500.00	90.00	90.37	7,690.00	-1,343.92	7,133.93	7,246.73	0.00	0.00	0.00	
14,600.00	90.00	90.37	7,690.00	-1,344.56	7,233.93	7,346.00	0.00	0.00	0.00	
14,700.00	90.00	90.37	7,690.00	-1,345.19	7,333.93	7,445.27	0.00	0.00	0.00	
14,800.00	90.00	90.37	7,690.00	-1,345.83	7,433.93	7,544.54	0.00	0.00	0.00	
14,900.00	90.00	90.37	7,690.00	-1,346.47	7,533.92	7,643.82	0.00	0.00	0.00	
15,000.00	90.00	90.37	7,690.00	-1,347.11	7,633.92	7,743.09	0.00	0.00	0.00	
15,100.00	90.00	90.37	7,690.00	-1,347.74	7,733.92	7,842.36	0.00	0.00	0.00	
15,200.00	90.00	90.37	7,690.00	-1,348.38	7,833.92	7,941.63	0.00	0.00	0.00	
15,300.00	90.00	90.37	7,690.00	-1,349.02	7,933.92	8,040.91	0.00	0.00	0.00	
15,400.00	90.00	90.37	7,690.00	-1,349.65	8,033.91	8,140.18	0.00	0.00	0.00	
15,500.00	90.00	90.37	7,690.00	-1,350.29	8,133.91	8,239.45	0.00	0.00	0.00	
15,600.00	90.00	90.37	7,690.00	-1,350.93	8,233.91	8,338.72	0.00	0.00	0.00	
15,700.00	90.00	90.37	7,690.00	-1,351.57	8,333.91	8,438.00	0.00	0.00	0.00	
15,800.00	90.00	90.37	7,690.00	-1,352.20	8,433.91	8,537.27	0.00	0.00	0.00	
15,900.00	90.00	90.37	7,690.00	-1,352.84	8,533.90	8,636.54	0.00	0.00	0.00	
16,000.00	90.00	90.37	7,690.00	-1,353.48	8,633.90	8,735.81	0.00	0.00	0.00	
16,100.00	90.00	90.37	7,690.00	-1,354.12	8,733.90	8,835.09	0.00	0.00	0.00	
16,200.00	90.00	90.37	7,690.00	-1,354.75	8,833.90	8,934.36	0.00	0.00	0.00	
16,300.00	90.00	90.37	7,690.00	-1,355.39	8,933.90	9,033.63	0.00	0.00	0.00	
16,400.00	90.00	90.37	7,690.00	-1,356.03	9,033.89	9,132.90	0.00	0.00	0.00	
16,500.00	90.00	90.37	7,690.00	-1,356.67	9,133.89	9,232.18	0.00	0.00	0.00	
16,600.00	90.00	90.37	7,690.00	-1,357.30	9,233.89	9,331.45	0.00	0.00	0.00	
16,700.00	90.00	90.37	7,690.00	-1,357.94	9,333.89	9,430.72	0.00	0.00	0.00	
16,800.00	90.00	90.37	7,690.00	-1,358.58	9,433.89	9,529.99	0.00	0.00	0.00	
16,900.00	90.00	90.37	7,690.00	-1,359.22	9,533.88	9,629.27	0.00	0.00	0.00	
17,000.00	90.00	90.37	7,690.00	-1,359.85	9,633.88	9,728.54	0.00	0.00	0.00	
17,100.00	90.00	90.37	7,690.00	-1,360.49	9,733.88	9,827.81	0.00	0.00	0.00	
17,200.00	90.00	90.37	7,690.00	-1,361.13	9,833.88	9,927.08	0.00	0.00	0.00	

# Civitas Resources

## Planning Report

<b>Database:</b>	EDM	<b>Local Co-ordinate Reference:</b>	Well FLORIDA 3-65 27-26 4BH
<b>Company:</b>	CRESTONE PEAK RESOURCES	<b>TVD Reference:</b>	KB 25' @ 5611.00usft
<b>Project:</b>	ADAMS COUNTY	<b>MD Reference:</b>	KB 25' @ 5611.00usft
<b>Site:</b>	SEC 28-T3S-R65W	<b>North Reference:</b>	True
<b>Well:</b>	FLORIDA 3-65 27-26 4BH	<b>Survey Calculation Method:</b>	Minimum Curvature
<b>Wellbore:</b>	OWB		
<b>Design:</b>	PROPOSAL 1		

Planned Survey										
Measured Depth (usft)	Inclination (°)	Azimuth (°)	Vertical Depth (usft)	+N/-S (usft)	+E/-W (usft)	Vertical Section (usft)	Dogleg Rate (°/100ft)	Build Rate (°/100ft)	Turn Rate (°/100ft)	
17,300.00	90.00	90.37	7,690.00	-1,361.76	9,933.88	10,026.36	0.00	0.00	0.00	
17,400.00	90.00	90.37	7,690.00	-1,362.40	10,033.87	10,125.63	0.00	0.00	0.00	
17,500.00	90.00	90.37	7,690.00	-1,363.04	10,133.87	10,224.90	0.00	0.00	0.00	
17,600.00	90.00	90.37	7,690.00	-1,363.68	10,233.87	10,324.17	0.00	0.00	0.00	
17,700.00	90.00	90.37	7,690.00	-1,364.31	10,333.87	10,423.45	0.00	0.00	0.00	
17,800.00	90.00	90.37	7,690.00	-1,364.95	10,433.87	10,522.72	0.00	0.00	0.00	
17,900.00	90.00	90.37	7,690.00	-1,365.59	10,533.86	10,621.99	0.00	0.00	0.00	
18,000.00	90.00	90.37	7,690.00	-1,366.23	10,633.86	10,721.27	0.00	0.00	0.00	
18,063.44	90.00	90.37	7,690.00	-1,366.63	10,697.30	10,784.25	0.00	0.00	0.00	
TD at 18063.44										

Design Targets										
Target Name	Dip Angle (°)	Dip Dir. (°)	TVD (usft)	+N/-S (usft)	+E/-W (usft)	Northing (usft)	Easting (usft)	Latitude	Longitude	
- hit/miss target										
- Shape										
LP-FLORIDA 3-65 27-26	0.00	0.00	7,690.00	-1,303.35	768.41	1,154,935.39	3,236,657.53	39.755581°N	104.658262°W	
- plan hits target center										
- Point										
PBHL-FLORIDA 3-65 27	0.00	0.00	7,690.00	-1,366.63	10,697.30	1,154,966.05	3,246,586.51	39.755401°N	104.622948°W	
- plan hits target center										
- Point										

Formations						
Measured Depth (usft)	Vertical Depth (usft)	Name	Lithology	Dip (°)	Dip Direction (°)	
24.00	24.00	Denver				
763.56	760.00	Arapahoe				
1,424.25	1,410.00	Laramie-Fox Hills Formation				
1,983.30	1,960.00	Pierre Formation				
2,481.36	2,450.00	Upper Pierre aquifer				
3,152.21	3,110.00	Base of Upper Pierre aquifer				
4,234.73	4,175.00	Larimer ("Parkman") sandstone				
4,361.79	4,300.00	Pierre Formation				
5,327.42	5,250.00	Terry ("Sussex") sandstone				
5,525.63	5,445.00	Pierre Formation				
6,115.17	6,025.00	Hygiene ("Shannon") sandstone				
6,537.00	6,440.00	Pierre Formation				
7,867.65	7,630.00	Sharon Springs Member				
8,134.35	7,690.00	Niobrara Formation				



# Civitas Resources

## Planning Report

<b>Database:</b>	EDM	<b>Local Co-ordinate Reference:</b>	Well FLORIDA 3-65 27-26 4BH
<b>Company:</b>	CRESTONE PEAK RESOURCES	<b>TVD Reference:</b>	KB 25' @ 5611.00usft
<b>Project:</b>	ADAMS COUNTY	<b>MD Reference:</b>	KB 25' @ 5611.00usft
<b>Site:</b>	SEC 28-T3S-R65W	<b>North Reference:</b>	True
<b>Well:</b>	FLORIDA 3-65 27-26 4BH	<b>Survey Calculation Method:</b>	Minimum Curvature
<b>Wellbore:</b>	OWB		
<b>Design:</b>	PROPOSAL 1		

Plan Annotations				
Measured Depth (usft)	Vertical Depth (usft)	Local Coordinates		Comment
		+N/-S (usft)	+E/-W (usft)	
200.00	200.00	0.00	0.00	Start Build 2.00
716.11	713.33	-45.76	7.48	Start 6535.44 hold at 716.11 MD
7,251.56	7,143.00	-1,201.48	196.35	Start DLS 10.00 TFO -80.51
8,134.35	7,690.00	-1,303.35	768.41	Start 9929.10 hold at 8134.35 MD
18,063.44	7,690.00	-1,366.63	10,697.30	TD at 18063.44