

CRESTONE PEAK RESOURCES

ADAMS COUNTY

SEC 28-T3S-R65W

FLORIDA 3-65 27-26 1BH

OWB

Plan: PROPOSAL 1

Standard Planning Report

26 October, 2023

Project: ADAMS COUNTY
Site: SEC 28-T3S-R65W
Well: FLORIDA 3-65 27-26 1BH
Wellbore: OWB
Design: PROPOSAL 1



Azimuths to True North
Magnetic North: 7.51°
Magnetic Field
Strength: 51391.8nT
Dip Angle: 66.07°
Date: 8/22/2023
Model: IGRF2020

WELL DETAILS: FLORIDA 3-65 27-26 1BH

+N/-S	+E/-W	Northing	Easting	5585.00 Latitude	Longitude	Slot
0.00	0.00	1156411.34	3235874.56	39.759653°N	104.660997°W	

SECTION DETAILS

Sec	MD	Inc	Azi	TVD	+N/-S	+E/-W	Dieg	TFace	VSect	Target
1	0.00	0.00	0.00	0.00	0.00	0.00	0.00	0.00	0.00	
2	500.00	0.00	0.00	500.00	0.00	0.00	0.00	0.00	0.00	
3	1427.63	18.55	4.88	1411.51	148.34	12.66	2.00	4.88	35.16	
4	7482.56	18.55	4.88	7151.77	2067.89	176.54	0.00	0.00	490.21	
5	8377.31	90.00	93.23	7690.00	2215.88	758.74	10.00	88.44	1088.17	LP-FLORIDA 3-65 27-26 1BH
6	18341.87	90.00	93.23	7690.00	1654.28	10707.46	0.00	0.00	10834.49	PBHL-FLORIDA 3-65 27-26 1BH

ANNOTATIONS

MD	Inc	Azi	TVD	+N/-S	+E/-W	VSect	Departure	Annotation
500.00	0.00	0.00	500.00	0.00	0.00	0.00	0.00	Start Build 2.00
1427.63	18.55	4.88	1411.51	148.34	12.66	35.16	148.88	Start 6054.93 hold at 1427.63 MD
7482.56	18.55	4.88	7151.77	2067.89	176.54	490.21	2075.42	Start DLS 10.00 TFO 88.44
8377.31	90.00	93.23	7690.00	2215.88	758.74	1088.17	2707.55	Start 9964.56 hold at 8377.31 MD
18341.87	90.00	93.23	7690.00	1654.28	10707.46	10834.49	12672.11	TD at 18341.87

DESIGN TARGET DETAILS

Name	TVD	+N/-S	+E/-W	Northing	Easting	Latitude	Longitude	Shape
LP-FLORIDA 3-65 27-26 1BH - plan hits target center	7690.00	2215.88	758.74	1158634.28	3236612.29	39.765736°N	104.658298°W	Point
PBHL-FLORIDA 3-65 27-26 1BH - plan hits target center	7690.00	1654.28	10707.46	1158166.84	3246565.81	39.764188°N	104.622909°W	Point

PROJECT DETAILS: ADAMS COUNTY

Geodetic System: US State Plane 1983
Datum: North American Datum 1983
Ellipsoid: GRS 1980
Zone: Colorado Northern Zone

System Datum: Mean Sea Level

SHL:
1878' FSL, 435' FEL
Sec 28-T3S-R65W

LP:
1200' FNL, 330' FWL
Sec 27-T3S-R65W

BHL:
1670' FNL, 330' FEL
Sec 26-T3S-R65W

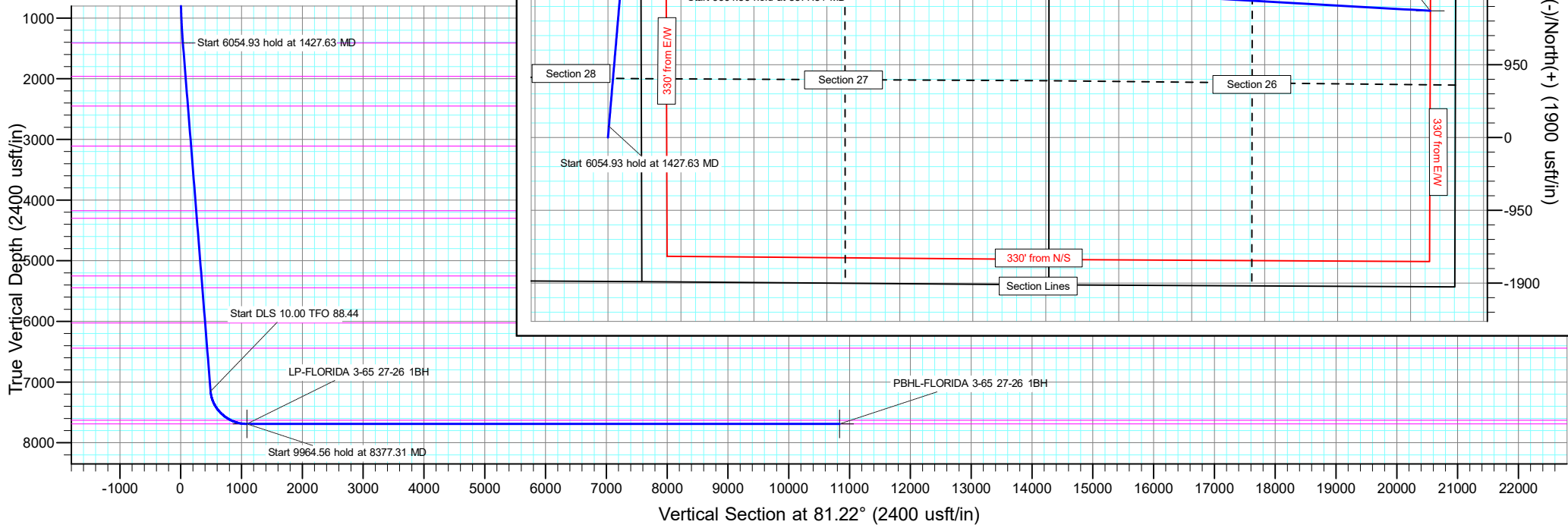

Civitas Resources

Planning Report

Database:	EDM	Local Co-ordinate Reference:	Well FLORIDA 3-65 27-26 1BH
Company:	CRESTONE PEAK RESOURCES	TVD Reference:	KBE 25' @ 5610.00usft
Project:	ADAMS COUNTY	MD Reference:	KBE 25' @ 5610.00usft
Site:	SEC 28-T3S-R65W	North Reference:	True
Well:	FLORIDA 3-65 27-26 1BH	Survey Calculation Method:	Minimum Curvature
Wellbore:	OWB		
Design:	PROPOSAL 1		

Project	ADAMS COUNTY		
Map System:	US State Plane 1983	System Datum:	Mean Sea Level
Geo Datum:	North American Datum 1983		
Map Zone:	Colorado Northern Zone		Using geodetic scale factor

Site	SEC 28-T3S-R65W		
Site Position:		Northing:	1,154,535.24 usft
From:	Lat/Long	Easting:	3,236,332.63 usft
Position Uncertainty:	0.00 usft	Slot Radius:	13.200 in
		Latitude:	39.754491°N
		Longitude:	104.659431°W
		Grid Convergence:	0.54 °

Well	FLORIDA 3-65 27-26 1BH					
Well Position	+N/-S	1,880.36 usft	Northing:	1,156,411.33 usft	Latitude:	39.759653°N
	+E/-W	-440.27 usft	Easting:	3,235,874.56 usft	Longitude:	104.660997°W
Position Uncertainty		0.00 usft	Wellhead Elevation:		Ground Level:	5,585.00 usft

Wellbore	OWB				
Magnetics	Model Name	Sample Date	Declination (°)	Dip Angle (°)	Field Strength (nT)
	IGRF2020	8/22/2023	7.51	66.07	51,391.76085741

Design	PROPOSAL 1			
Audit Notes:				
Version:	Phase:	PROTOTYPE	Tie On Depth:	0.00
Vertical Section:	Depth From (TVD) (usft)	+N/-S (usft)	+E/-W (usft)	Direction (°)
	0.00	0.00	0.00	81.22

Plan Survey Tool Program	Date	10/26/2023			
Depth From (usft)	Depth To (usft)	Survey (Wellbore)	Tool Name	Remarks	
1	0.00	18,340.92	PROPOSAL 1 (OWB)	MWD OWSG	
				OWSG MWD - Standard	

Plan Sections										
Measured Depth (usft)	Inclination (°)	Azimuth (°)	Vertical Depth (usft)	+N/-S (usft)	+E/-W (usft)	Dogleg Rate (°/100ft)	Build Rate (°/100ft)	Turn Rate (°/100ft)	TFO (°)	Target
0.00	0.00	0.00	0.00	0.00	0.00	0.00	0.00	0.00	0.00	
500.00	0.00	0.00	500.00	0.00	0.00	0.00	0.00	0.00	0.00	
1,427.63	18.55	4.88	1,411.51	148.34	12.66	2.00	2.00	0.00	4.88	
7,482.56	18.55	4.88	7,151.77	2,067.89	176.54	0.00	0.00	0.00	0.00	
8,377.31	90.00	93.23	7,690.00	2,215.88	758.74	10.00	7.99	9.87	88.44	LP-FLORIDA 3-65 27-
18,341.87	90.00	93.23	7,690.00	1,654.28	10,707.46	0.00	0.00	0.00	0.00	PBHL-FLORIDA 3-65

Civitas Resources

Planning Report

Database:	EDM	Local Co-ordinate Reference:	Well FLORIDA 3-65 27-26 1BH
Company:	CRESTONE PEAK RESOURCES	TVD Reference:	KBE 25' @ 5610.00usft
Project:	ADAMS COUNTY	MD Reference:	KBE 25' @ 5610.00usft
Site:	SEC 28-T3S-R65W	North Reference:	True
Well:	FLORIDA 3-65 27-26 1BH	Survey Calculation Method:	Minimum Curvature
Wellbore:	OWB		
Design:	PROPOSAL 1		

Planned Survey									
Measured Depth (usft)	Inclination (°)	Azimuth (°)	Vertical Depth (usft)	+N/-S (usft)	+E/-W (usft)	Vertical Section (usft)	Dogleg Rate (°/100ft)	Build Rate (°/100ft)	Turn Rate (°/100ft)
0.00	0.00	0.00	0.00	0.00	0.00	0.00	0.00	0.00	0.00
24.00	0.00	0.00	24.00	0.00	0.00	0.00	0.00	0.00	0.00
Denver									
100.00	0.00	0.00	100.00	0.00	0.00	0.00	0.00	0.00	0.00
200.00	0.00	0.00	200.00	0.00	0.00	0.00	0.00	0.00	0.00
300.00	0.00	0.00	300.00	0.00	0.00	0.00	0.00	0.00	0.00
400.00	0.00	0.00	400.00	0.00	0.00	0.00	0.00	0.00	0.00
500.00	0.00	0.00	500.00	0.00	0.00	0.00	0.00	0.00	0.00
Start Build 2.00									
600.00	2.00	4.88	599.98	1.74	0.15	0.41	2.00	2.00	0.00
700.00	4.00	4.88	699.84	6.95	0.59	1.65	2.00	2.00	0.00
760.36	5.21	4.88	760.00	11.78	1.01	2.79	2.00	2.00	0.00
Arapahoe									
800.00	6.00	4.88	799.45	15.64	1.33	3.71	2.00	2.00	0.00
900.00	8.00	4.88	898.70	27.78	2.37	6.59	2.00	2.00	0.00
1,000.00	10.00	4.88	997.47	43.36	3.70	10.28	2.00	2.00	0.00
1,100.00	12.00	4.88	1,095.62	62.38	5.33	14.79	2.00	2.00	0.00
1,200.00	14.00	4.88	1,193.06	84.79	7.24	20.10	2.00	2.00	0.00
1,300.00	16.00	4.88	1,289.64	110.58	9.44	26.21	2.00	2.00	0.00
1,400.00	18.00	4.88	1,385.27	139.70	11.93	33.12	2.00	2.00	0.00
1,426.04	18.52	4.88	1,410.00	147.84	12.62	35.05	2.00	2.00	0.00
Laramie-Fox Hills Formation									
1,427.63	18.55	4.88	1,411.51	148.34	12.66	35.16	2.00	2.00	0.00
Start 6054.93 hold at 1427.63 MD									
1,500.00	18.55	4.88	1,480.11	171.28	14.62	40.60	0.00	0.00	0.00
1,600.00	18.55	4.88	1,574.92	202.98	17.33	48.12	0.00	0.00	0.00
1,700.00	18.55	4.88	1,669.72	234.69	20.04	55.63	0.00	0.00	0.00
1,800.00	18.55	4.88	1,764.52	266.39	22.74	63.15	0.00	0.00	0.00
1,900.00	18.55	4.88	1,859.33	298.09	25.45	70.66	0.00	0.00	0.00
2,000.00	18.55	4.88	1,954.13	329.79	28.16	78.18	0.00	0.00	0.00
2,006.19	18.55	4.88	1,960.00	331.76	28.32	78.65	0.00	0.00	0.00
Pierre Formation									
2,100.00	18.55	4.88	2,048.93	361.50	30.86	85.69	0.00	0.00	0.00
2,200.00	18.55	4.88	2,143.74	393.20	33.57	93.21	0.00	0.00	0.00
2,300.00	18.55	4.88	2,238.54	424.90	36.27	100.73	0.00	0.00	0.00
2,400.00	18.55	4.88	2,333.34	456.60	38.98	108.24	0.00	0.00	0.00
2,500.00	18.55	4.88	2,428.15	488.30	41.69	115.76	0.00	0.00	0.00
2,523.05	18.55	4.88	2,450.00	495.61	42.31	117.49	0.00	0.00	0.00
Upper Pierre aquifer									
2,600.00	18.55	4.88	2,522.95	520.01	44.39	123.27	0.00	0.00	0.00
2,700.00	18.55	4.88	2,617.75	551.71	47.10	130.79	0.00	0.00	0.00
2,800.00	18.55	4.88	2,712.55	583.41	49.81	138.30	0.00	0.00	0.00
2,900.00	18.55	4.88	2,807.36	615.11	52.51	145.82	0.00	0.00	0.00
3,000.00	18.55	4.88	2,902.16	646.82	55.22	153.33	0.00	0.00	0.00
3,100.00	18.55	4.88	2,996.96	678.52	57.93	160.85	0.00	0.00	0.00
3,200.00	18.55	4.88	3,091.77	710.22	60.63	168.36	0.00	0.00	0.00
3,219.23	18.55	4.88	3,110.00	716.32	61.15	169.81	0.00	0.00	0.00
Base of Upper Pierre aquifer									
3,300.00	18.55	4.88	3,186.57	741.92	63.34	175.88	0.00	0.00	0.00
3,400.00	18.55	4.88	3,281.37	773.63	66.05	183.39	0.00	0.00	0.00
3,500.00	18.55	4.88	3,376.18	805.33	68.75	190.91	0.00	0.00	0.00
3,600.00	18.55	4.88	3,470.98	837.03	71.46	198.42	0.00	0.00	0.00
3,700.00	18.55	4.88	3,565.78	868.73	74.17	205.94	0.00	0.00	0.00

Civitas Resources

Planning Report

Database:	EDM	Local Co-ordinate Reference:	Well FLORIDA 3-65 27-26 1BH
Company:	CRESTONE PEAK RESOURCES	TVD Reference:	KBE 25' @ 5610.00usft
Project:	ADAMS COUNTY	MD Reference:	KBE 25' @ 5610.00usft
Site:	SEC 28-T3S-R65W	North Reference:	True
Well:	FLORIDA 3-65 27-26 1BH	Survey Calculation Method:	Minimum Curvature
Wellbore:	OWB		
Design:	PROPOSAL 1		

Planned Survey										
Measured Depth (usft)	Inclination (°)	Azimuth (°)	Vertical Depth (usft)	+N/-S (usft)	+E/-W (usft)	Vertical Section (usft)	Dogleg Rate (°/100ft)	Build Rate (°/100ft)	Turn Rate (°/100ft)	
3,800.00	18.55	4.88	3,660.59	900.44	76.87	213.45	0.00	0.00	0.00	
3,900.00	18.55	4.88	3,755.39	932.14	79.58	220.97	0.00	0.00	0.00	
4,000.00	18.55	4.88	3,850.19	963.84	82.28	228.48	0.00	0.00	0.00	
4,100.00	18.55	4.88	3,945.00	995.54	84.99	236.00	0.00	0.00	0.00	
4,200.00	18.55	4.88	4,039.80	1,027.24	87.70	243.52	0.00	0.00	0.00	
4,300.00	18.55	4.88	4,134.60	1,058.95	90.40	251.03	0.00	0.00	0.00	
4,342.61	18.55	4.88	4,175.00	1,072.46	91.56	254.23	0.00	0.00	0.00	
Larimer ("Parkman") sandstone										
4,400.00	18.55	4.88	4,229.40	1,090.65	93.11	258.55	0.00	0.00	0.00	
4,474.47	18.55	4.88	4,300.00	1,114.26	95.13	264.14	0.00	0.00	0.00	
Pierre Formation										
4,500.00	18.55	4.88	4,324.21	1,122.35	95.82	266.06	0.00	0.00	0.00	
4,600.00	18.55	4.88	4,419.01	1,154.05	98.52	273.58	0.00	0.00	0.00	
4,700.00	18.55	4.88	4,513.81	1,185.76	101.23	281.09	0.00	0.00	0.00	
4,800.00	18.55	4.88	4,608.62	1,217.46	103.94	288.61	0.00	0.00	0.00	
4,900.00	18.55	4.88	4,703.42	1,249.16	106.64	296.12	0.00	0.00	0.00	
5,000.00	18.55	4.88	4,798.22	1,280.86	109.35	303.64	0.00	0.00	0.00	
5,100.00	18.55	4.88	4,893.03	1,312.57	112.06	311.15	0.00	0.00	0.00	
5,200.00	18.55	4.88	4,987.83	1,344.27	114.76	318.67	0.00	0.00	0.00	
5,300.00	18.55	4.88	5,082.63	1,375.97	117.47	326.18	0.00	0.00	0.00	
5,400.00	18.55	4.88	5,177.44	1,407.67	120.18	333.70	0.00	0.00	0.00	
5,476.54	18.55	4.88	5,250.00	1,431.94	122.25	339.45	0.00	0.00	0.00	
Terry ("Sussex") sandstone										
5,500.00	18.55	4.88	5,272.24	1,439.37	122.88	341.21	0.00	0.00	0.00	
5,600.00	18.55	4.88	5,367.04	1,471.08	125.59	348.73	0.00	0.00	0.00	
5,682.23	18.55	4.88	5,445.00	1,497.15	127.81	354.91	0.00	0.00	0.00	
Pierre Formation										
5,700.00	18.55	4.88	5,461.85	1,502.78	128.30	356.24	0.00	0.00	0.00	
5,800.00	18.55	4.88	5,556.65	1,534.48	131.00	363.76	0.00	0.00	0.00	
5,900.00	18.55	4.88	5,651.45	1,566.18	133.71	371.27	0.00	0.00	0.00	
6,000.00	18.55	4.88	5,746.26	1,597.89	136.41	378.79	0.00	0.00	0.00	
6,100.00	18.55	4.88	5,841.06	1,629.59	139.12	386.31	0.00	0.00	0.00	
6,200.00	18.55	4.88	5,935.86	1,661.29	141.83	393.82	0.00	0.00	0.00	
6,294.03	18.55	4.88	6,025.00	1,691.10	144.37	400.89	0.00	0.00	0.00	
Hygiene ("Shannon") sandstone										
6,300.00	18.55	4.88	6,030.66	1,692.99	144.53	401.34	0.00	0.00	0.00	
6,400.00	18.55	4.88	6,125.47	1,724.70	147.24	408.85	0.00	0.00	0.00	
6,500.00	18.55	4.88	6,220.27	1,756.40	149.95	416.37	0.00	0.00	0.00	
6,600.00	18.55	4.88	6,315.07	1,788.10	152.65	423.88	0.00	0.00	0.00	
6,700.00	18.55	4.88	6,409.88	1,819.80	155.36	431.40	0.00	0.00	0.00	
6,731.77	18.55	4.88	6,440.00	1,829.88	156.22	433.78	0.00	0.00	0.00	
Pierre Formation										
6,800.00	18.55	4.88	6,504.68	1,851.51	158.07	438.91	0.00	0.00	0.00	
6,900.00	18.55	4.88	6,599.48	1,883.21	160.77	446.43	0.00	0.00	0.00	
7,000.00	18.55	4.88	6,694.29	1,914.91	163.48	453.94	0.00	0.00	0.00	
7,100.00	18.55	4.88	6,789.09	1,946.61	166.19	461.46	0.00	0.00	0.00	
7,200.00	18.55	4.88	6,883.89	1,978.31	168.89	468.97	0.00	0.00	0.00	
7,300.00	18.55	4.88	6,978.70	2,010.02	171.60	476.49	0.00	0.00	0.00	
7,400.00	18.55	4.88	7,073.50	2,041.72	174.31	484.00	0.00	0.00	0.00	
7,482.56	18.55	4.88	7,151.77	2,067.89	176.54	490.21	0.00	0.00	0.00	
Start DLS 10.00 TFO 88.44										
7,500.00	18.68	10.33	7,168.30	2,073.41	177.28	491.78	10.00	0.72	31.25	
7,550.00	19.87	25.08	7,215.52	2,088.99	182.32	499.14	10.00	2.39	29.50	

Civitas Resources

Planning Report

Database:	EDM	Local Co-ordinate Reference:	Well FLORIDA 3-65 27-26 1BH
Company:	CRESTONE PEAK RESOURCES	TVD Reference:	KBE 25' @ 5610.00usft
Project:	ADAMS COUNTY	MD Reference:	KBE 25' @ 5610.00usft
Site:	SEC 28-T3S-R65W	North Reference:	True
Well:	FLORIDA 3-65 27-26 1BH	Survey Calculation Method:	Minimum Curvature
Wellbore:	OWB		
Design:	PROPOSAL 1		

Planned Survey										
Measured Depth (usft)	Inclination (°)	Azimuth (°)	Vertical Depth (usft)	+N/-S (usft)	+E/-W (usft)	Vertical Section (usft)	Dogleg Rate (°/100ft)	Build Rate (°/100ft)	Turn Rate (°/100ft)	
7,600.00	22.12	37.59	7,262.22	2,104.15	191.67	510.70	10.00	4.49	25.02	
7,650.00	25.13	47.58	7,308.05	2,118.78	205.26	526.36	10.00	6.03	19.97	
7,700.00	28.67	55.39	7,352.64	2,132.77	222.98	546.01	10.00	7.09	15.64	
7,750.00	32.57	61.55	7,395.67	2,146.00	244.70	569.49	10.00	7.80	12.32	
7,800.00	36.71	66.49	7,436.81	2,158.38	270.25	596.64	10.00	8.28	9.88	
7,850.00	41.02	70.55	7,475.73	2,169.81	299.45	627.24	10.00	8.62	8.10	
7,900.00	45.45	73.94	7,512.16	2,180.21	332.06	661.06	10.00	8.85	6.80	
7,950.00	49.96	76.86	7,545.80	2,189.49	367.84	697.83	10.00	9.03	5.83	
8,000.00	54.54	79.40	7,576.41	2,197.60	406.52	737.30	10.00	9.15	5.10	
8,050.00	59.16	81.68	7,603.75	2,204.45	447.80	779.14	10.00	9.25	4.54	
8,100.00	63.82	83.74	7,627.61	2,210.01	491.37	823.05	10.00	9.32	4.12	
8,105.47	64.33	83.95	7,630.00	2,210.54	496.26	827.96	10.00	9.35	3.93	
Sharon Springs Member										
8,150.00	68.51	85.64	7,647.81	2,214.23	536.89	868.68	10.00	9.38	3.79	
8,200.00	73.22	87.42	7,664.20	2,217.07	584.03	915.70	10.00	9.42	3.57	
8,250.00	77.94	89.12	7,676.65	2,218.52	632.42	963.74	10.00	9.44	3.39	
8,300.00	82.67	90.76	7,685.06	2,218.57	681.69	1,012.44	10.00	9.46	3.28	
8,350.00	87.41	92.36	7,689.38	2,217.21	731.47	1,061.43	10.00	9.48	3.21	
8,377.31	90.00	93.23	7,690.00	2,215.88	758.74	1,088.17	10.00	9.48	3.18	
Start 9964.56 hold at 8377.31 MD - Niobrara Formation										
8,400.00	90.00	93.23	7,690.00	2,214.60	781.39	1,110.36	0.00	0.00	0.00	
8,500.00	90.00	93.23	7,690.00	2,208.97	881.23	1,208.17	0.00	0.00	0.00	
8,600.00	90.00	93.23	7,690.00	2,203.33	981.07	1,305.98	0.00	0.00	0.00	
8,700.00	90.00	93.23	7,690.00	2,197.69	1,080.91	1,403.79	0.00	0.00	0.00	
8,800.00	90.00	93.23	7,690.00	2,192.06	1,180.75	1,501.60	0.00	0.00	0.00	
8,900.00	90.00	93.23	7,690.00	2,186.42	1,280.59	1,599.41	0.00	0.00	0.00	
9,000.00	90.00	93.23	7,690.00	2,180.79	1,380.43	1,697.22	0.00	0.00	0.00	
9,100.00	90.00	93.23	7,690.00	2,175.15	1,480.27	1,795.03	0.00	0.00	0.00	
9,200.00	90.00	93.23	7,690.00	2,169.51	1,580.12	1,892.84	0.00	0.00	0.00	
9,300.00	90.00	93.23	7,690.00	2,163.88	1,679.96	1,990.65	0.00	0.00	0.00	
9,400.00	90.00	93.23	7,690.00	2,158.24	1,779.80	2,088.46	0.00	0.00	0.00	
9,500.00	90.00	93.23	7,690.00	2,152.61	1,879.64	2,186.27	0.00	0.00	0.00	
9,600.00	90.00	93.23	7,690.00	2,146.97	1,979.48	2,284.08	0.00	0.00	0.00	
9,700.00	90.00	93.23	7,690.00	2,141.33	2,079.32	2,381.89	0.00	0.00	0.00	
9,800.00	90.00	93.23	7,690.00	2,135.70	2,179.16	2,479.70	0.00	0.00	0.00	
9,900.00	90.00	93.23	7,690.00	2,130.06	2,279.00	2,577.51	0.00	0.00	0.00	
10,000.00	90.00	93.23	7,690.00	2,124.43	2,378.84	2,675.32	0.00	0.00	0.00	
10,100.00	90.00	93.23	7,690.00	2,118.79	2,478.69	2,773.13	0.00	0.00	0.00	
10,200.00	90.00	93.23	7,690.00	2,113.15	2,578.53	2,870.94	0.00	0.00	0.00	
10,300.00	90.00	93.23	7,690.00	2,107.52	2,678.37	2,968.75	0.00	0.00	0.00	
10,400.00	90.00	93.23	7,690.00	2,101.88	2,778.21	3,066.56	0.00	0.00	0.00	
10,500.00	90.00	93.23	7,690.00	2,096.25	2,878.05	3,164.37	0.00	0.00	0.00	
10,600.00	90.00	93.23	7,690.00	2,090.61	2,977.89	3,262.18	0.00	0.00	0.00	
10,700.00	90.00	93.23	7,690.00	2,084.97	3,077.73	3,359.99	0.00	0.00	0.00	
10,800.00	90.00	93.23	7,690.00	2,079.34	3,177.57	3,457.80	0.00	0.00	0.00	
10,900.00	90.00	93.23	7,690.00	2,073.70	3,277.41	3,555.61	0.00	0.00	0.00	
11,000.00	90.00	93.23	7,690.00	2,068.07	3,377.25	3,653.42	0.00	0.00	0.00	
11,100.00	90.00	93.23	7,690.00	2,062.43	3,477.10	3,751.23	0.00	0.00	0.00	
11,200.00	90.00	93.23	7,690.00	2,056.79	3,576.94	3,849.04	0.00	0.00	0.00	
11,300.00	90.00	93.23	7,690.00	2,051.16	3,676.78	3,946.85	0.00	0.00	0.00	
11,400.00	90.00	93.23	7,690.00	2,045.52	3,776.62	4,044.66	0.00	0.00	0.00	
11,500.00	90.00	93.23	7,690.00	2,039.89	3,876.46	4,142.47	0.00	0.00	0.00	
11,600.00	90.00	93.23	7,690.00	2,034.25	3,976.30	4,240.28	0.00	0.00	0.00	
11,700.00	90.00	93.23	7,690.00	2,028.61	4,076.14	4,338.09	0.00	0.00	0.00	

Civitas Resources

Planning Report

Database:	EDM	Local Co-ordinate Reference:	Well FLORIDA 3-65 27-26 1BH
Company:	CRESTONE PEAK RESOURCES	TVD Reference:	KBE 25' @ 5610.00usft
Project:	ADAMS COUNTY	MD Reference:	KBE 25' @ 5610.00usft
Site:	SEC 28-T3S-R65W	North Reference:	True
Well:	FLORIDA 3-65 27-26 1BH	Survey Calculation Method:	Minimum Curvature
Wellbore:	OWB		
Design:	PROPOSAL 1		

Planned Survey										
Measured Depth (usft)	Inclination (°)	Azimuth (°)	Vertical Depth (usft)	+N/-S (usft)	+E/-W (usft)	Vertical Section (usft)	Dogleg Rate (°/100ft)	Build Rate (°/100ft)	Turn Rate (°/100ft)	
11,800.00	90.00	93.23	7,690.00	2,022.98	4,175.98	4,435.90	0.00	0.00	0.00	
11,900.00	90.00	93.23	7,690.00	2,017.34	4,275.82	4,533.71	0.00	0.00	0.00	
12,000.00	90.00	93.23	7,690.00	2,011.71	4,375.67	4,631.52	0.00	0.00	0.00	
12,100.00	90.00	93.23	7,690.00	2,006.07	4,475.51	4,729.33	0.00	0.00	0.00	
12,200.00	90.00	93.23	7,690.00	2,000.43	4,575.35	4,827.14	0.00	0.00	0.00	
12,300.00	90.00	93.23	7,690.00	1,994.80	4,675.19	4,924.95	0.00	0.00	0.00	
12,400.00	90.00	93.23	7,690.00	1,989.16	4,775.03	5,022.76	0.00	0.00	0.00	
12,500.00	90.00	93.23	7,690.00	1,983.53	4,874.87	5,120.57	0.00	0.00	0.00	
12,600.00	90.00	93.23	7,690.00	1,977.89	4,974.71	5,218.38	0.00	0.00	0.00	
12,700.00	90.00	93.23	7,690.00	1,972.25	5,074.55	5,316.19	0.00	0.00	0.00	
12,800.00	90.00	93.23	7,690.00	1,966.62	5,174.39	5,414.00	0.00	0.00	0.00	
12,900.00	90.00	93.23	7,690.00	1,960.98	5,274.23	5,511.81	0.00	0.00	0.00	
13,000.00	90.00	93.23	7,690.00	1,955.35	5,374.08	5,609.62	0.00	0.00	0.00	
13,100.00	90.00	93.23	7,690.00	1,949.71	5,473.92	5,707.43	0.00	0.00	0.00	
13,200.00	90.00	93.23	7,690.00	1,944.07	5,573.76	5,805.24	0.00	0.00	0.00	
13,300.00	90.00	93.23	7,690.00	1,938.44	5,673.60	5,903.05	0.00	0.00	0.00	
13,400.00	90.00	93.23	7,690.00	1,932.80	5,773.44	6,000.86	0.00	0.00	0.00	
13,500.00	90.00	93.23	7,690.00	1,927.17	5,873.28	6,098.67	0.00	0.00	0.00	
13,600.00	90.00	93.23	7,690.00	1,921.53	5,973.12	6,196.48	0.00	0.00	0.00	
13,700.00	90.00	93.23	7,690.00	1,915.89	6,072.96	6,294.29	0.00	0.00	0.00	
13,800.00	90.00	93.23	7,690.00	1,910.26	6,172.80	6,392.10	0.00	0.00	0.00	
13,900.00	90.00	93.23	7,690.00	1,904.62	6,272.65	6,489.91	0.00	0.00	0.00	
14,000.00	90.00	93.23	7,690.00	1,898.99	6,372.49	6,587.72	0.00	0.00	0.00	
14,100.00	90.00	93.23	7,690.00	1,893.35	6,472.33	6,685.53	0.00	0.00	0.00	
14,200.00	90.00	93.23	7,690.00	1,887.71	6,572.17	6,783.34	0.00	0.00	0.00	
14,300.00	90.00	93.23	7,690.00	1,882.08	6,672.01	6,881.15	0.00	0.00	0.00	
14,400.00	90.00	93.23	7,690.00	1,876.44	6,771.85	6,978.96	0.00	0.00	0.00	
14,500.00	90.00	93.23	7,690.00	1,870.81	6,871.69	7,076.77	0.00	0.00	0.00	
14,600.00	90.00	93.23	7,690.00	1,865.17	6,971.53	7,174.58	0.00	0.00	0.00	
14,700.00	90.00	93.23	7,690.00	1,859.53	7,071.37	7,272.39	0.00	0.00	0.00	
14,800.00	90.00	93.23	7,690.00	1,853.90	7,171.21	7,370.19	0.00	0.00	0.00	
14,900.00	90.00	93.23	7,690.00	1,848.26	7,271.06	7,468.00	0.00	0.00	0.00	
15,000.00	90.00	93.23	7,690.00	1,842.63	7,370.90	7,565.81	0.00	0.00	0.00	
15,100.00	90.00	93.23	7,690.00	1,836.99	7,470.74	7,663.62	0.00	0.00	0.00	
15,200.00	90.00	93.23	7,690.00	1,831.35	7,570.58	7,761.43	0.00	0.00	0.00	
15,300.00	90.00	93.23	7,690.00	1,825.72	7,670.42	7,859.24	0.00	0.00	0.00	
15,400.00	90.00	93.23	7,690.00	1,820.08	7,770.26	7,957.05	0.00	0.00	0.00	
15,500.00	90.00	93.23	7,690.00	1,814.45	7,870.10	8,054.86	0.00	0.00	0.00	
15,600.00	90.00	93.23	7,690.00	1,808.81	7,969.94	8,152.67	0.00	0.00	0.00	
15,700.00	90.00	93.23	7,690.00	1,803.17	8,069.78	8,250.48	0.00	0.00	0.00	
15,800.00	90.00	93.23	7,690.00	1,797.54	8,169.63	8,348.29	0.00	0.00	0.00	
15,900.00	90.00	93.23	7,690.00	1,791.90	8,269.47	8,446.10	0.00	0.00	0.00	
16,000.00	90.00	93.23	7,690.00	1,786.27	8,369.31	8,543.91	0.00	0.00	0.00	
16,100.00	90.00	93.23	7,690.00	1,780.63	8,469.15	8,641.72	0.00	0.00	0.00	
16,200.00	90.00	93.23	7,690.00	1,774.99	8,568.99	8,739.53	0.00	0.00	0.00	
16,300.00	90.00	93.23	7,690.00	1,769.36	8,668.83	8,837.34	0.00	0.00	0.00	
16,400.00	90.00	93.23	7,690.00	1,763.72	8,768.67	8,935.15	0.00	0.00	0.00	
16,500.00	90.00	93.23	7,690.00	1,758.09	8,868.51	9,032.96	0.00	0.00	0.00	
16,600.00	90.00	93.23	7,690.00	1,752.45	8,968.35	9,130.77	0.00	0.00	0.00	
16,700.00	90.00	93.23	7,690.00	1,746.81	9,068.19	9,228.58	0.00	0.00	0.00	
16,800.00	90.00	93.23	7,690.00	1,741.18	9,168.04	9,326.39	0.00	0.00	0.00	
16,900.00	90.00	93.23	7,690.00	1,735.54	9,267.88	9,424.20	0.00	0.00	0.00	
17,000.00	90.00	93.23	7,690.00	1,729.91	9,367.72	9,522.01	0.00	0.00	0.00	
17,100.00	90.00	93.23	7,690.00	1,724.27	9,467.56	9,619.82	0.00	0.00	0.00	

Civitas Resources

Planning Report

Database:	EDM	Local Co-ordinate Reference:	Well FLORIDA 3-65 27-26 1BH
Company:	CRESTONE PEAK RESOURCES	TVD Reference:	KBE 25' @ 5610.00usft
Project:	ADAMS COUNTY	MD Reference:	KBE 25' @ 5610.00usft
Site:	SEC 28-T3S-R65W	North Reference:	True
Well:	FLORIDA 3-65 27-26 1BH	Survey Calculation Method:	Minimum Curvature
Wellbore:	OWB		
Design:	PROPOSAL 1		

Planned Survey										
Measured Depth (usft)	Inclination (°)	Azimuth (°)	Vertical Depth (usft)	+N/-S (usft)	+E/-W (usft)	Vertical Section (usft)	Dogleg Rate (°/100ft)	Build Rate (°/100ft)	Turn Rate (°/100ft)	
17,200.00	90.00	93.23	7,690.00	1,718.63	9,567.40	9,717.63	0.00	0.00	0.00	
17,300.00	90.00	93.23	7,690.00	1,713.00	9,667.24	9,815.44	0.00	0.00	0.00	
17,400.00	90.00	93.23	7,690.00	1,707.36	9,767.08	9,913.25	0.00	0.00	0.00	
17,500.00	90.00	93.23	7,690.00	1,701.73	9,866.92	10,011.06	0.00	0.00	0.00	
17,600.00	90.00	93.23	7,690.00	1,696.09	9,966.76	10,108.87	0.00	0.00	0.00	
17,700.00	90.00	93.23	7,690.00	1,690.45	10,066.61	10,206.68	0.00	0.00	0.00	
17,800.00	90.00	93.23	7,690.00	1,684.82	10,166.45	10,304.49	0.00	0.00	0.00	
17,900.00	90.00	93.23	7,690.00	1,679.18	10,266.29	10,402.30	0.00	0.00	0.00	
18,000.00	90.00	93.23	7,690.00	1,673.55	10,366.13	10,500.11	0.00	0.00	0.00	
18,100.00	90.00	93.23	7,690.00	1,667.91	10,465.97	10,597.92	0.00	0.00	0.00	
18,200.00	90.00	93.23	7,690.00	1,662.27	10,565.81	10,695.73	0.00	0.00	0.00	
18,300.00	90.00	93.23	7,690.00	1,656.64	10,665.65	10,793.54	0.00	0.00	0.00	
18,341.87	90.00	93.23	7,690.00	1,654.28	10,707.46	10,834.49	0.00	0.00	0.00	
TD at 18341.87										

Design Targets										
Target Name	Dip Angle (°)	Dip Dir. (°)	TVD (usft)	+N/-S (usft)	+E/-W (usft)	Northing (usft)	Easting (usft)	Latitude	Longitude	
PBHL-FLORIDA 3-65 27 - hit/miss target - Shape - Point	0.00	0.00	7,690.00	1,654.28	10,707.46	1,158,166.83	3,246,565.81	39.764188°N	104.622909°W	
LP-FLORIDA 3-65 27-26 - plan hits target center - Point	0.00	0.00	7,690.00	2,215.88	758.74	1,158,634.28	3,236,612.29	39.765736°N	104.658298°W	

Formations							
Measured Depth (usft)	Vertical Depth (usft)	Name	Lithology	Dip (°)	Dip Direction (°)		
24.00	24.00	Denver					
760.36	760.00	Arapahoe					
1,426.04	1,410.00	Laramie-Fox Hills Formation					
2,006.19	1,960.00	Pierre Formation					
2,523.05	2,450.00	Upper Pierre aquifer					
3,219.23	3,110.00	Base of Upper Pierre aquifer					
4,342.61	4,175.00	Larimer ("Parkman") sandstone					
4,474.47	4,300.00	Pierre Formation					
5,476.54	5,250.00	Terry ("Sussex") sandstone					
5,682.23	5,445.00	Pierre Formation					
6,294.03	6,025.00	Hygiene ("Shannon") sandstone					
6,731.77	6,440.00	Pierre Formation					
8,105.47	7,630.00	Sharon Springs Member					
8,377.31	7,690.00	Niobrara Formation					

Civitas Resources

Planning Report

Database:	EDM	Local Co-ordinate Reference:	Well FLORIDA 3-65 27-26 1BH
Company:	CRESTONE PEAK RESOURCES	TVD Reference:	KBE 25' @ 5610.00usft
Project:	ADAMS COUNTY	MD Reference:	KBE 25' @ 5610.00usft
Site:	SEC 28-T3S-R65W	North Reference:	True
Well:	FLORIDA 3-65 27-26 1BH	Survey Calculation Method:	Minimum Curvature
Wellbore:	OWB		
Design:	PROPOSAL 1		

Plan Annotations				
Measured Depth (usft)	Vertical Depth (usft)	Local Coordinates		Comment
		+N/-S (usft)	+E/-W (usft)	
500.00	500.00	0.00	0.00	Start Build 2.00
1,427.63	1,411.51	148.34	12.66	Start 6054.93 hold at 1427.63 MD
7,482.56	7,151.77	2,067.89	176.54	Start DLS 10.00 TFO 88.44
8,377.31	7,690.00	2,215.88	758.74	Start 9964.56 hold at 8377.31 MD
18,341.87	7,690.00	1,654.28	10,707.46	TD at 18341.87