



DEPARTMENT OF NATURAL RESOURCES  
CONSERVATION COMMISSION  
STATE OF COLORADO

RECEIVED  
JUL 7 1970



COLO. OIL & GAS CONS. COMM. DESIGNATION AND SERIAL NO.

C-0126362

APPLICATION FOR PERMIT TO DRILL, DEEPEN, OR PLUG BACK

1a. TYPE OF WORK  
 DRILL ☒ DEEPEN ☐ PLUG BACK ☐  
 b. TYPE OF WELL  
 OIL WELL ☐ GAS WELL ☒ OTHER ☐ SINGLE ZONE ☒ MULTIPLE ZONE ☐  
 2. NAME OF OPERATOR Equity Oil Company  
 Shell Oil Company (Rocky Mountain Div. Production)  
 3. ADDRESS OF OPERATOR  
 1700 Broadway, Denver, Colorado 80202  
 4. LOCATION OF WELL (Report location clearly and in accordance with any State requirements.)  
 At surface 1980' FNL and 1980' FEL Sec 32  
 At proposed prod. zone

6. IF INDIAN, ALLOTTEE OR TRIBE NAME  
 7. UNIT AGREEMENT NAME  
 8. FARM OR LEASE NAME  
 Government  
 9. WELL NO.  
 32-32  
 10. FIELD AND POOL, OR WILDCAT  
 Blue Gravel Area (Wildcat)  
 11. SEC., T., R., M., OR BLK. AND SURVEY OR AREA  
 SW 1/4 NE 1/4 Section 32-  
 T 9N-R 90W  
 12. COUNTY  
 Moffat  
 13. STATE  
 Colorado

14. DISTANCE IN MILES AND DIRECTION FROM NEAREST TOWN OR POST OFFICE 13 mi N of Craig  
 on State Highway 13, 3/4 mi W of highway on existing road  
 15. DISTANCE FROM PROPOSED LOCATION TO NEAREST PROPERTY OR LEASE LINE, FT. (Also to nearest drig. line, if any) 660'  
 16. NO. OF ACRES IN LEASE \* Approx 314.57  
 17. NO. OF ACRES ASSIGNED TO THIS WELL --  
 18. DISTANCE FROM PROPOSED LOCATION TO NEAREST WELL, DRILLING, COMPLETED, OR APPLIED FOR, ON THIS LEASE, FT. 2 1/2 miles  
 19. PROPOSED DEPTH 4100'  
 20. ROTARY OR CABLE TOOLS Rotary  
 21. ELEVATIONS (Show whether DF, RT, GR, etc.) 6490 GL Lewis  
 22. APPROX. DATE WORK WILL START 7-20-70

23. PROPOSED CASING AND CEMENTING PROGRAM

SIZE OF HOLE	SIZE OF CASING	WEIGHT PER FOOT	SETTING DEPTH	QUANTITY OF CEMENT

\* DESCRIBE LEASE Lots 1, 2, 3, 6, 7, 8 and 10 and Lot 16 Sec 29-T 9N-R 90W

As per attached drilling prognosis and certified survey plat.  
 Designation of Operator from Equity Oil Company is attached.  
 Check in the amount of \$75.00 is enclosed for Permit to Drill.

*Waind*

DVR	
FJP	<input checked="" type="checkbox"/>
HHM	
JAM	<input checked="" type="checkbox"/>
JJD	<i>Plotter 7/7/70</i>

IN ABOVE SPACE DESCRIBE PROPOSED PROGRAM: If proposal is to deepen or plug back, give data on present productive zone and proposed new productive zone. If proposal is to drill or deepen directionally, give pertinent data on subsurface locations and measured and true vertical depths. Give blowout preventer program, if any.

24. SIGNED *J. C. Howell* TITLE Division Petroleum Engr. DATE July 6, 1970  
 (This space for Federal or State office use)

PERMIT NO. 70-311 APPROVAL DATE DIRECTOR  
 APPROVED BY *W. Rogers* TITLE O & G CONS. COMM. DATE JUL 7 1970  
 CONDITIONS OF APPROVAL, IF ANY:

See Instructions On Reverse Side

70-311  
 05 081 6114

RECEIVED

JUL 7 1970

COLO. OIL & GAS CONS. COMM.

R. 90 W

80.68

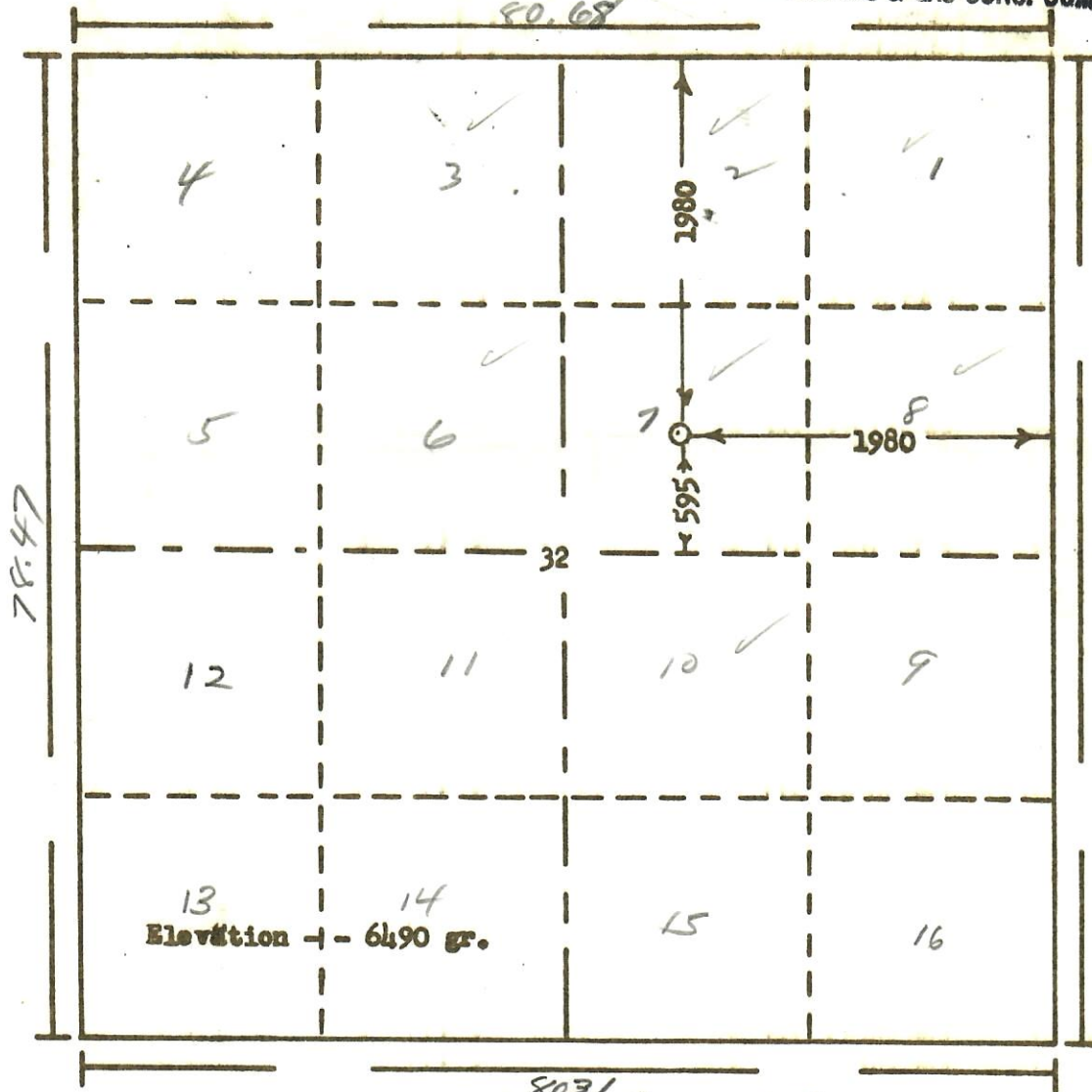

T. 9 N

Scale... 1" = 1000'

Powers Elevation Company, Inc. of Denver, Colorado  
has in accordance with a request from Z. W. Zeller  
for Shell Oil Company

determined the location of # 32-32 Shell & Equity  
to be 1980FE & 1980FE Section 32 Township 9 N  
Range 90 W of the Sixth Principal Meridian  
Moffat County, Colorado

I hereby certify that this plat is an  
accurate representation of a correct  
survey showing the location of

# 32-32 Shell & Equity

Date: 7-2-70

*Thomas L. Sheldon*

Licensed Land Surveyor No. 9981  
State of Colorado

