

RECEIVED

JUL 28 1967

COLO. OIL &amp; GAS CONS. COM.

T 6N, R 87 W, 6th PM

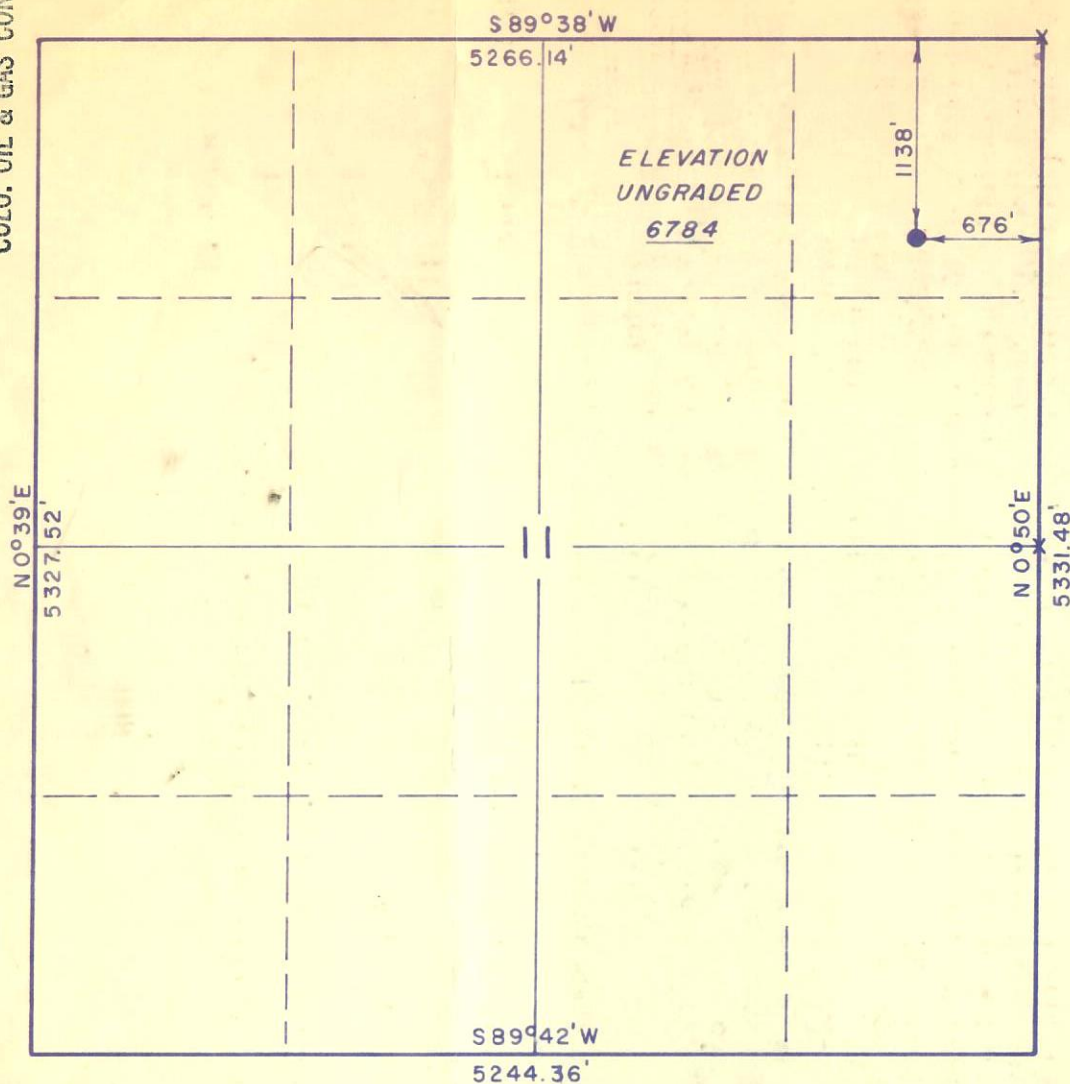

X = Corners Located (Brass Caps)

PROJECT

KENNETH D. LUFF

LUFF-MARTINETTS-ALPINE #1 C.JONES ETAL.  
 WELL LOCATION AS SHOWN IN THE NE 1/4-  
NE 1/4, SEC. 11, T6N, R87W, 6th P.M. ROUTE  
COUNTY, COLORADO.

CERTIFICATE

THIS IS TO CERTIFY THAT THE ABOVE PLAT WAS PREPARED  
 FROM FIELD NOTES OF ACTUAL SURVEYS MADE BY ME OR UNDER  
 MY SUPERVISION AND THAT THE SAME ARE TRUE AND CORRECT  
 TO THE BEST OF MY KNOWLEDGE AND BELIEF.

*John D. Luff*  
 REGISTERED LAND SURVEYOR  
 REGISTRATION NO 5839 COLO.

Uintah Engineering & Land Surveying  
 BOX Q  
 VERNAL, UTAH

SCALE  
 1" = 1000'

PARTY  
 GS - RW

WEATHER  
 Clear - Hot

DATE  
 24 July, 1967

REFERENCES  
 GLO Township Plat

FILE  
 LUFF