

RECEIVED

DEC 31 1981

WUL. OIL & GAS CONS. COMM.

CERTIFICATE OF SURVEY

I, JAMES W. JOY, A REGISTERED PROFESSIONAL LAND SURVEYOR IN THE STATE OF COLORADO DO HEREBY CERTIFY THAT A SURVEY OF;

DRILLHOLE WILLIAM G. BUSH 11-1 LYING IN THE SW¹/₄ SE¹/₄ OF SECTION 11, T1N, R94W OF THE 6th P.M., COUNTY OF RIO BLANCO, STATE OF COLORADO

WAS MADE DECEMBER 14, 1981 UNDER MY DIRECT SUPERVISION AND THAT THIS PLAT IS A TRUE REPRESENTATION THEREOF.

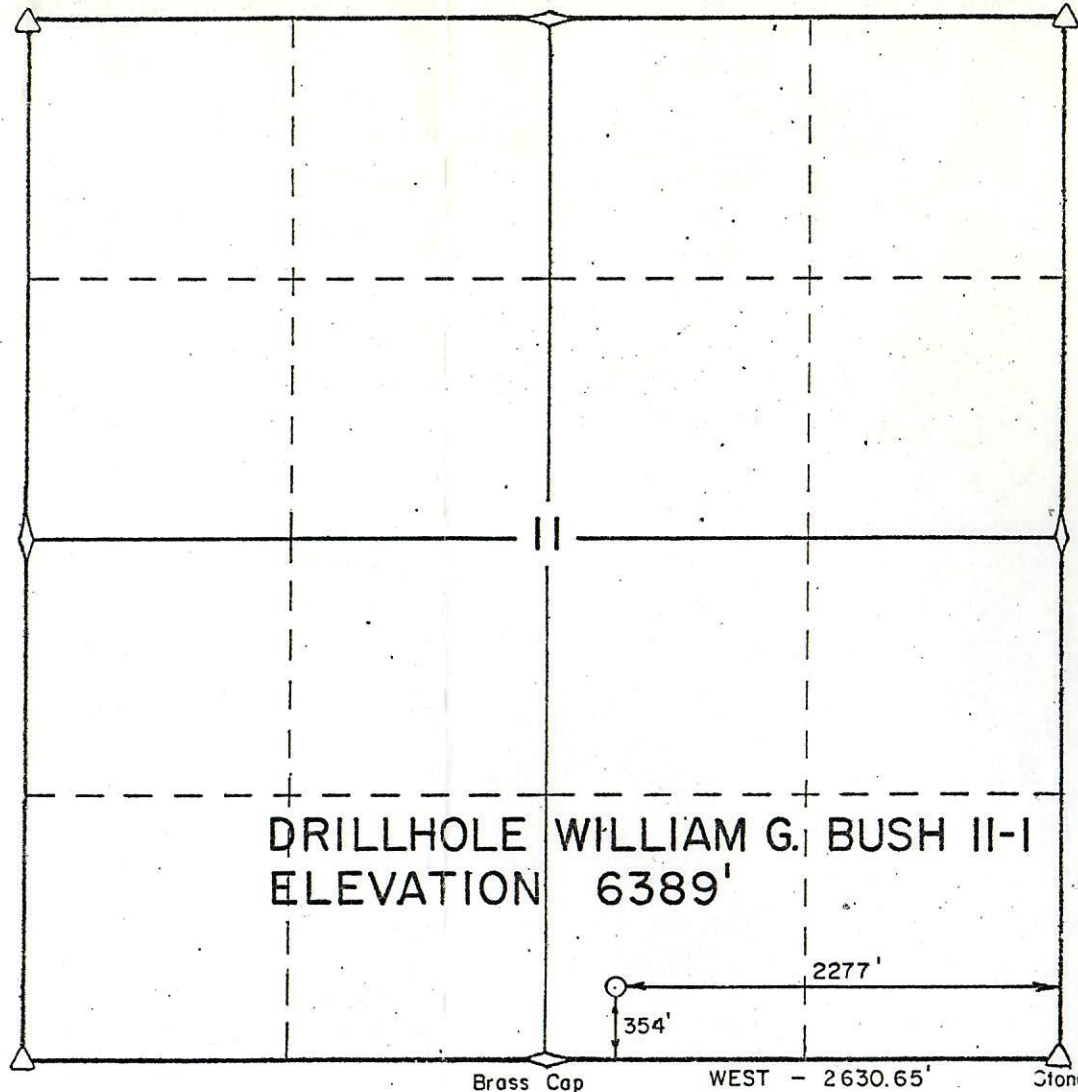
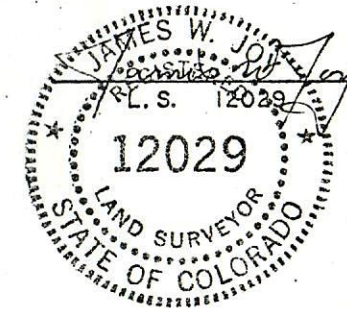

DRILLHOLE WILLIAM G. BUSH II-I
ELEVATION 6389'

2277'
354'
Brass Cap WEST - 2630.65' Stone

ELEVATION BASE: AP2TR46 PER MEEKER, COLO. QUADRANGLE

BEST COPY
AVAILABLE

SCALE
1" = 1000'



WILLIAM G. BUSH II-1

354' N.S.L.

2277' W.E.L.

FRONTIER DRILLING, INC.

THE SURVEYORS INC.

878 - 5292

BOX 1153

MEEKER, COLO.

81641

Drawn By
S.E.C.

Date
12-14-81

Job No.
484

Sheet
1 of 1

