

RECEIVED

DEC 22 1967

COLO. OIL & GAS CONS. COMM.

T1N, R103W, 6th P.M.

PROJECT

CHEVRON OIL COMPANY - CHEVRON PAN AMERICAN AMERADA FEDERAL #1 WELL LOCATION - LOCATED AS SHOWN IN THE SW 1/4 SW 1/4 SECTION 15, T1N, R103W, 6th P.M., RIO BLANCO COUNTY COLORADO.

NOTES:

Elev. top 300' West Ref. = 5272.2'

Elev. top 250' West Ref. = 5272.7'

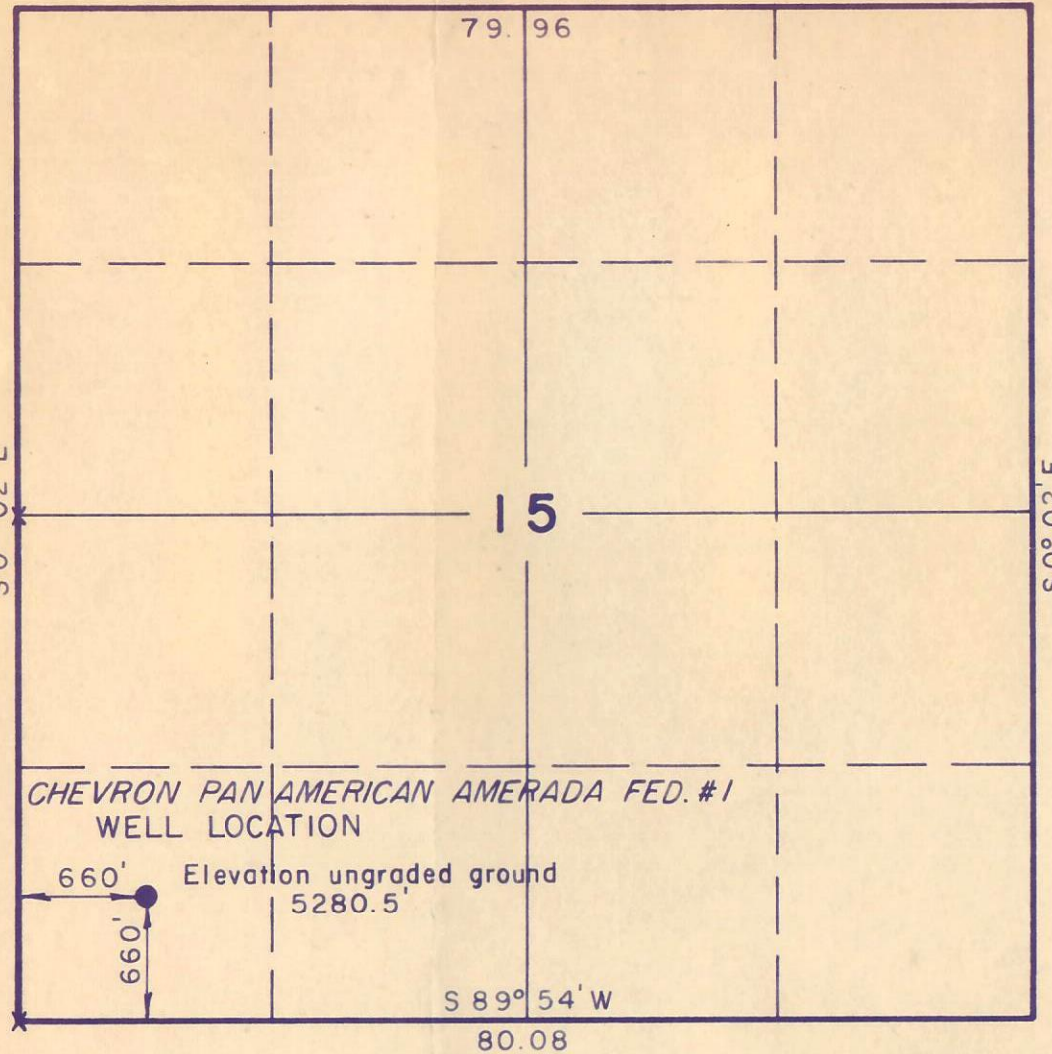

X = Corners found & used.

CERTIFICATE

THIS IS TO CERTIFY THAT THE ABOVE PLAT WAS PREPARED FROM FIELD NOTES OF ACTUAL SURVEYS MADE BY ME OR UNDER MY SUPERVISION AND THAT THE SAME ARE TRUE AND CORRECT TO THE BEST OF MY KNOWLEDGE AND BELIEF.

*Nelson J. Marshall*  
REGISTERED LAND SURVEYOR  
REGISTRATION NO 5839 Colorado

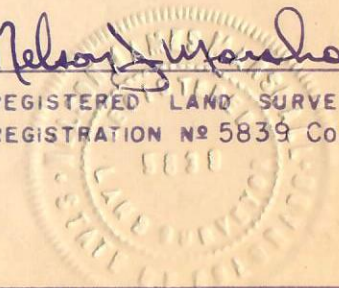

|  |                             |                        |
|--|-----------------------------|------------------------|
| Uintah Engineering & Land Surveying<br>BOX Q<br>VERNAL, UTAH | SCALE<br>1" = 1000'         | DATE<br>7 DEC., 1967   |
|  | PARTY<br>NJM HM             | REFERENCES<br>GLO PLAT |
|  | WEATHER<br>CLOUDY-Very Cold | FILE<br>CHEVRON        |



825 49