

Interim Reclamation and Stormwater Inspection

Date: 10/26/2023

Operator: FUNDARE RESOURCES OPERATING
COMPANY LLC - 10773

Location ID: 435861

Inspection Document #: 708200649

Weld County, CO

Dylan Edwardson
Reclamation Specialist, ECMC



COLORADO
Energy & Carbon Management
Commission
Department of Natural Resources

Inspection Photos
Location Name: Horsetail 29G Pad
Location ID: 435861



Photo 1. Taken from the southern portion of the location, near the entrance. Photo illustrates non-uniform vegetative cover resulting in areas of bare/exposed soils.

Inspection Photos
Location Name: Horsetail 29G Pad
Location ID: 435861



Photo 2. Taken near the southwest corner of the location. See comments in Photo 1.

Inspection Photos
Location Name: Horsetail 29G Pad
Location ID: 435861



Photo 3. Taken from the western portion of the location. See comments in Photo 1.

Inspection Photos
Location Name: Horsetail 29G Pad
Location ID: 435861



Photos 4 & 5. Taken near the northwest corner of the location. Photo illustrates non-uniform vegetative cover and the presence of trash on location (red arrow).

Inspection Photos
Location Name: Horsetail 29G Pad
Location ID: 435861



Photos 6 & 7. Taken from the northern portion of the location. Photo illustrates non-uniform vegetative cover resulting in bare/exposed soils, and the presence of undesirable vegetation (e.g. russian thistle).

Inspection Photos
Location Name: Horsetail 29G Pad
Location ID: 435861



Photo 8. Taken near the northeast corner. Photo illustrates non-uniform vegetative cover resulting in bare/exposed soils, and the presence of undesirable vegetation (e.g. russian thistle).

Inspection Photos
Location Name: Horsetail 29G Pad
Location ID: 435861



Photo 9. Taken from the eastern portion of the location. Photo illustrates undesirable vegetation (e.g. russian thistle) throughout the topsoil stockpile area.

Inspection Photos
Location Name: Horsetail 29G Pad
Location ID: 435861

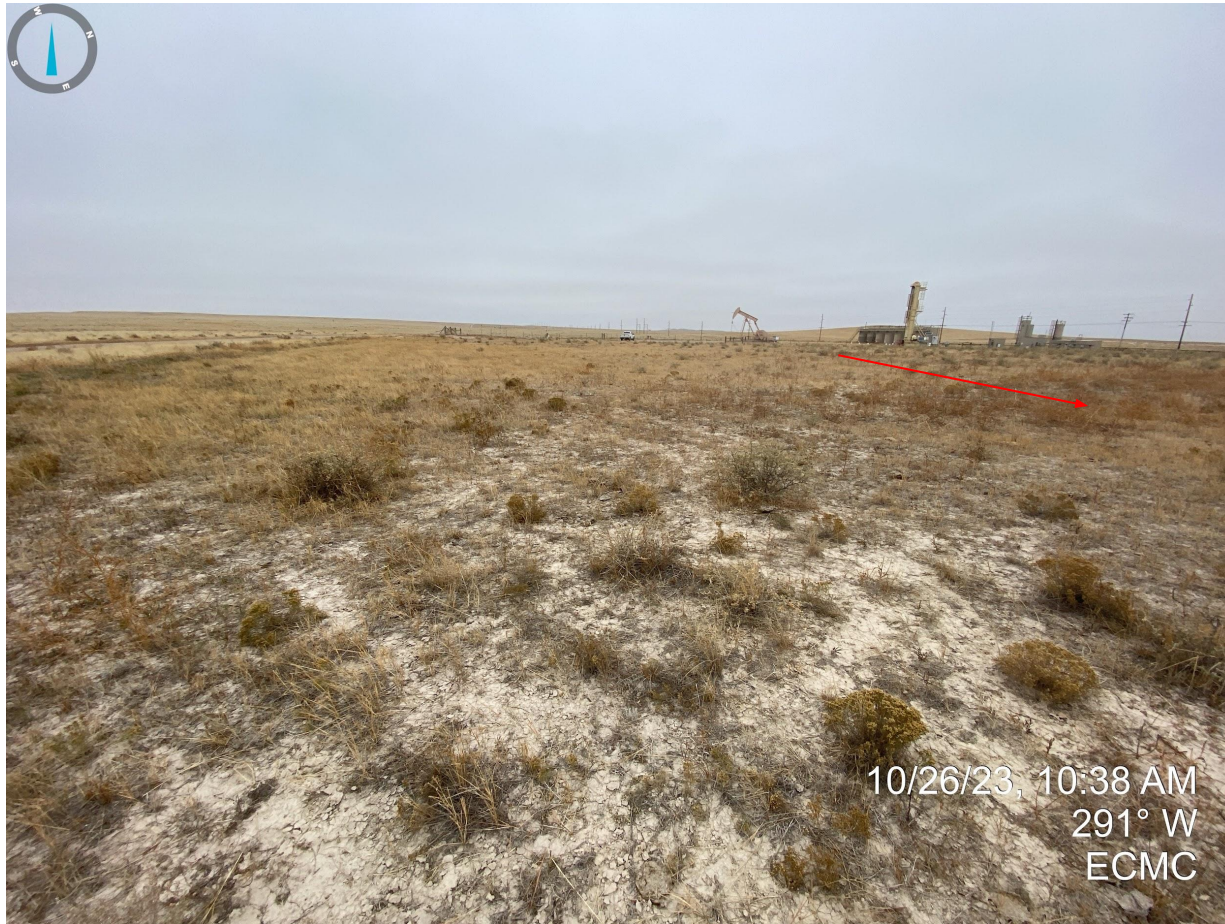

Photo 10. Taken near the southeast corner of the location. Photo illustrates non-uniform vegetative cover resulting in bare/exposed soils, and the presence of undesirable vegetation (e.g. russian thistle indicated by red arrow).