



00650697

## WELL LOCATION

BARCUS No. 1 & No. 2  
SEC. 11, T2N R3W UTE M

1317.02  
151.52  
1975.55

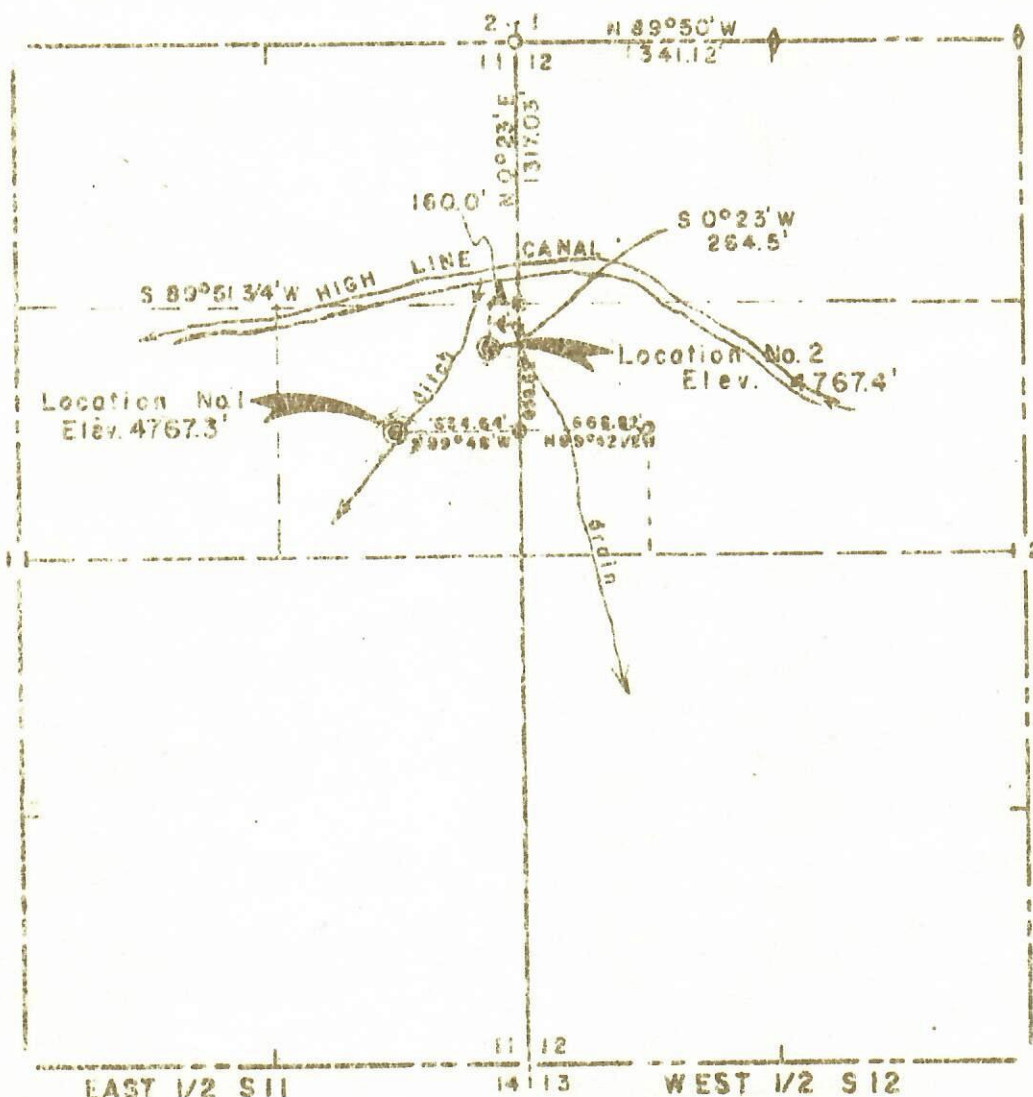

N

Scale 1"=1000'

NOTE - Elevations from USGS Datum.

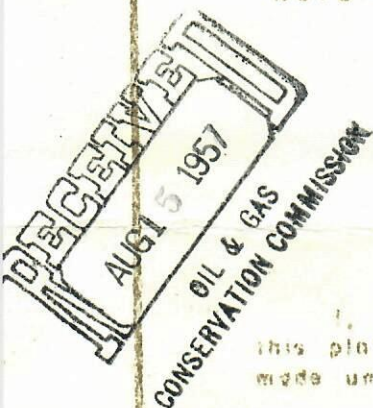

I, Richard J. Mondavilla, do hereby certify that this plat was plotted from notes of a field survey made under my supervision on Aug. 8, 1957.

*Richard J. Mondavilla*  
Registered Engineer & Land Surveyor

WESTERN ENGINEERS  
WELL LOCATIONS

BARCUS No. 1 & No. 2  
MESA COUNTY, COLO.

SURVEYED - *E. J. D.*  
DRAWN - *E. J. D.*  
GRAND JURY, COLO.