

YY18-07 PAD
DIRECTIONAL WELL PLAT

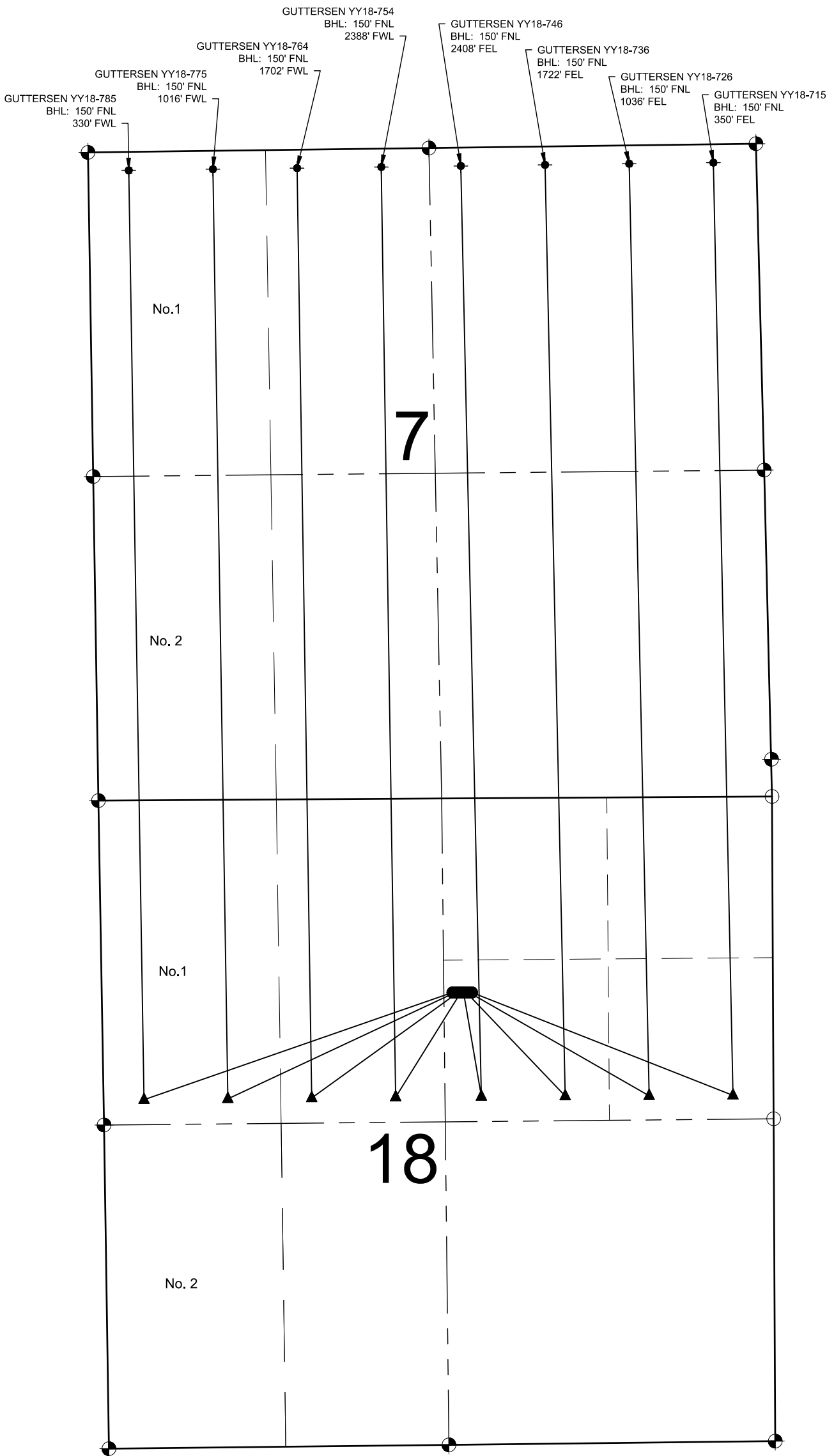

NOTES:

1. THIS FIELD SURVEY CONFORMS TO THE MINIMUM STANDARDS SET BY THE COGCC, RULE NO. 216.
2. ALL DISTANCES AND BEARINGS SHOWN HEREON ARE GROUND VALUES AS GPS MEASURED IN THE FIELD, WITH TIES TO WELLS MEASURED PERPENDICULAR TO LINES SHOWN HEREON.
3. FIELD VERIFICATION OF MONUMENTS COMPLETED WITHIN 1 YEAR OF SIGNATURE DATE, UNLESS OTHERWISE NOTED.

NOTES:

- GUTTERSEN YY18-785 TO BE AT 1582' FNL & 2611' FEL.
BOTTOM HOLE AT 150' FNL & 330' FWL, SEC. 7
GUTTERSEN YY18-775 TO BE AT 1582' FNL & 2588' FEL.
BOTTOM HOLE AT 150' FNL & 1016' FWL, SEC. 7
GUTTERSEN YY18-764 TO BE AT 1582' FNL & 2566' FEL.
BOTTOM HOLE AT 150' FNL & 1702' FWL, SEC. 7
GUTTERSEN YY18-754 TO BE AT 1582' FNL & 2543' FEL.
BOTTOM HOLE AT 150' FNL & 2388' FWL, SEC. 7
GUTTERSEN YY18-746 TO BE AT 1582' FNL & 2521' FEL.
BOTTOM HOLE AT 150' FNL & 2408' FEL, SEC. 7
GUTTERSEN YY18-736 TO BE AT 1582' FNL & 2498' FEL.
BOTTOM HOLE AT 150' FNL & 1722' FEL, SEC. 7
GUTTERSEN YY18-726 TO BE AT 1583' FNL & 2476' FEL.
BOTTOM HOLE AT 150' FNL & 1036' FEL, SEC. 7
GUTTERSEN YY18-715 TO BE AT 1583' FNL & 2453' FEL.
BOTTOM HOLE AT 150' FNL & 350' FEL, SEC. 7

LEGEND

- = EXISTING MONUMENT
- = CALCULATED POSITION
- = PROPOSED WELL
- ◆ = BOTTOM HOLE
- ▲ = LANDING POINT
- ◆ = EXISTING WELL
- LP = LANDING POINT
- BHL = BOTTOM HOLE

