



00043982

RECEIVED

SEP 21 1970

COLO. OIL & GAS CONS. COMM.

N
—
Z
—

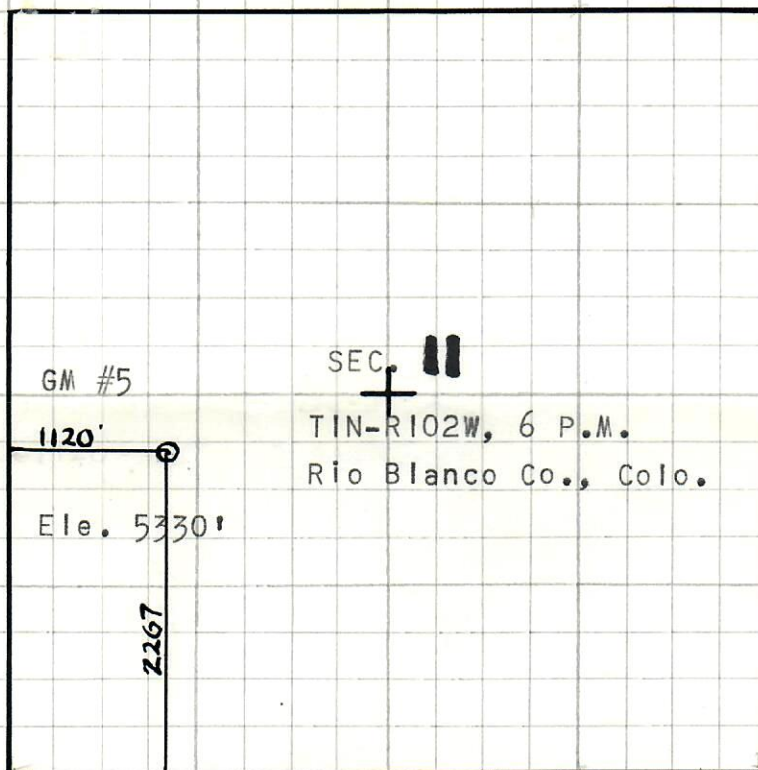

This will certify that to the best of my knowledge the
above plat and location being:

1120' FWL and 2267' FSL Sec. 11, TIN-R102W, 6 P.M.
is true and correct.

Date: 10 September 1970



Graham S. Campbell
Graham S. Campbell
Certified Professional Geologist and
Geological Engineer

