



FORM F-106

RECEIVED

DEC 13 1978

COLO. OIL & GAS COM. CHART

R. 46W

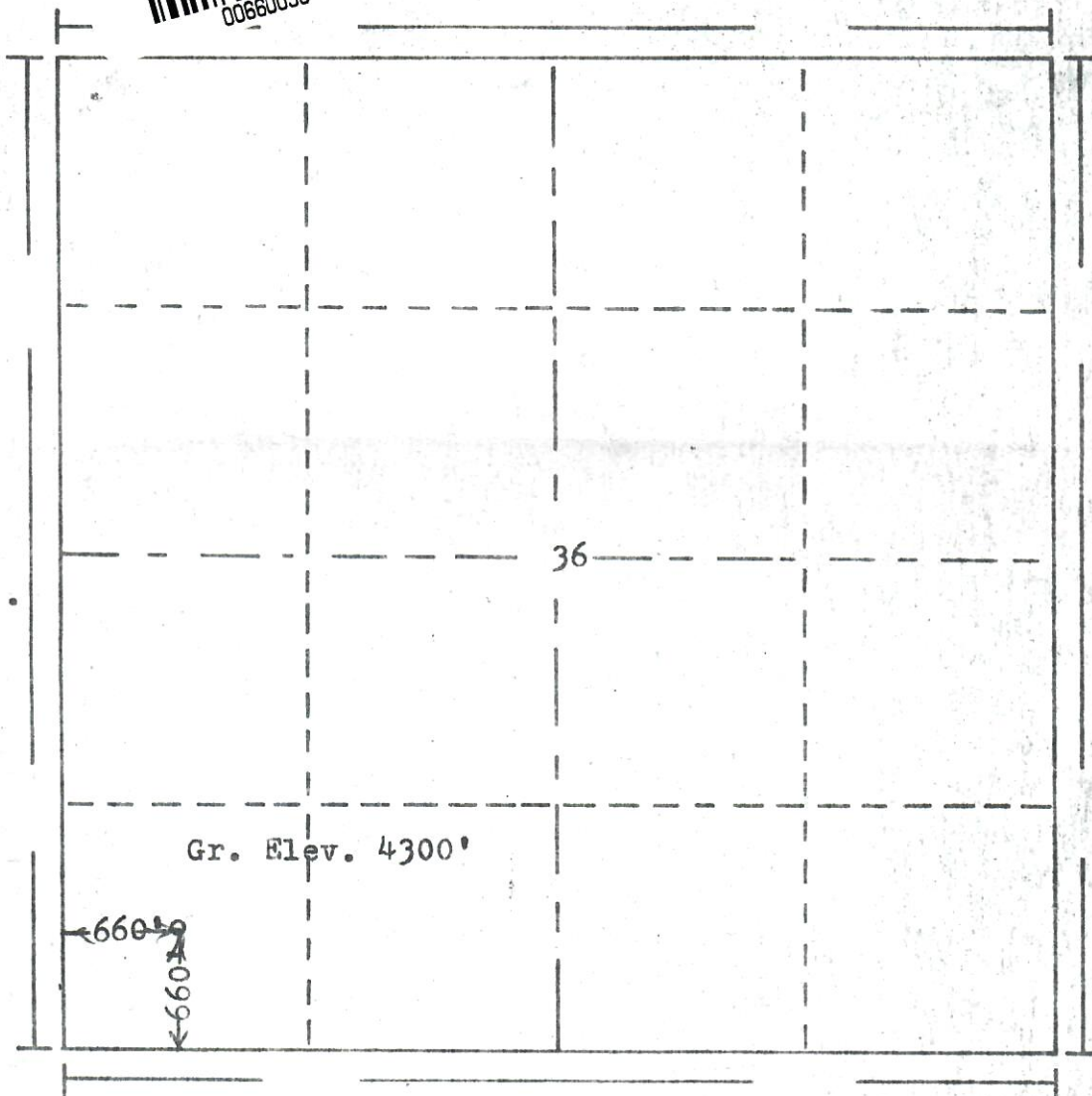

Scale... 1" = 1000'

Powers Elevation Company, Inc. of Denver, Colorado
has in accordance with a request from Mr. Fabian
for Wexpro Co.

determined the location of No. 1-36 Williams
to be CSW SW Section 36 Township 33S
Range 46W of the 6th Principal Meridian
Baca County, Colorado

I hereby certify that this plat is an
accurate representation of a correct
survey showing the location of

Date: 11-30-78

B. J. H. H. H.
Licensed Land Surveyor No. 2853
State of Colorado