



RECEIVED

SEP 10 1968

COLO. OIL &amp; GAS CONS. COMM.

R. 41 W

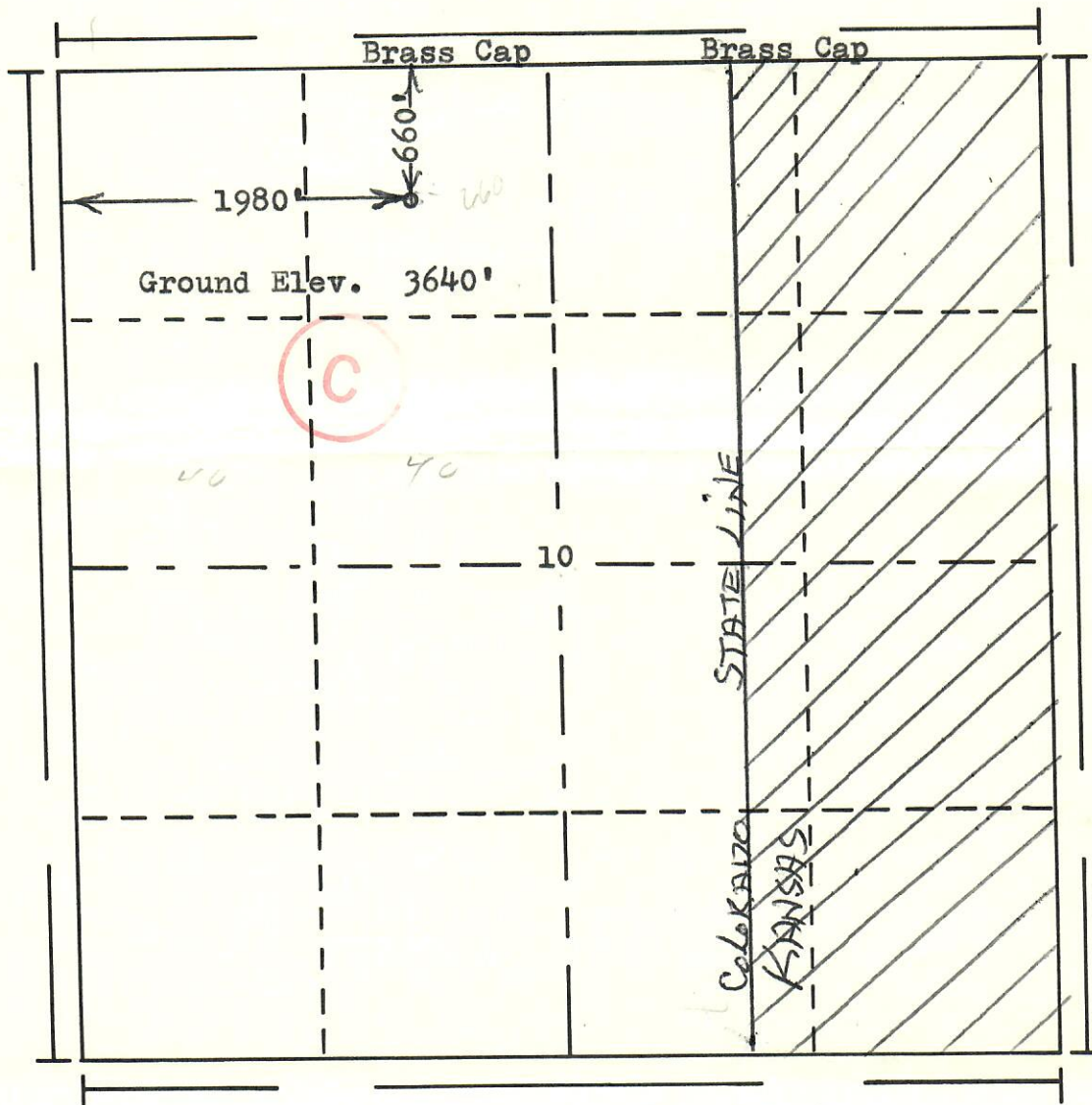

Scale... 1" = 1000'

Powers Elevation Company, Inc. of Denver, Colorado  
has in accordance with a request from Mr. Goosetree  
for Midwest Oil Corp.

determined the location of No. 1 Mayberry  
to be CNE NW Section 10 Township 34S  
Range 41W of the 6th Principal Meridian  
Baca County, Colorado

I hereby certify that this plat is an  
accurate representation of a correct  
survey showing the location of

Date: 9-6-68

Billy G. Hollman  
Licensed Land Surveyor No. 2853  
State of Colorado