

Wellhead Closure Checklist

COGCC Rule 911.a.(4) Environmental Site Closure Assessment Field Form

Additional attachments (optional):		Pit Closure		Tank Battery Closure		Flowline Closure		Partially Buried Vault Closure
Site Name & COGCC Facility Number: Armstrong #2-16 G5		Date: 12-29-21					Remediation Project #: 20986	
Associated Wells: 05-123-18603		Age of Site: years					Number of Photos Attached: 1	
Location: (GPS coordinates of wellhead or southeastern most wellhead for multiple)							Estimated Facility Size (acres):	
40.510353/-104.622366								
General Condition of Site: (General observations regarding housekeeping, corrosion, waste management, etc.)								
Good Condition								
USCS Soil Type: SW				Estimated Depth to Groundwater: >2.0'				
Hydrocarbon Impacted Soils / Spills: (Note estimated size and if impact appears to be surficial or extends to an unknown depth)								
None observed								
Salt Crusted Soils or Impacted Vegetation: (Note estimated size and if impact appears to be surficial or extends to an unknown depth)								
None observed								
Wellhead(s)								
Well API	05-123							
Age	years							
Condition of surface around wellhead	Good- Per Crew							
PID Readings	N/A- Excavated upon arrival							
Condition of subsurface (obtaining present)	Good- no staining / no odor							
PID Readings	7.8	8.9	9.3	7.4	11.9			
Sample taken? Location/Sample ID#	WH-SS-01 @ 4'	WH-SS-02 @ 4'	WH-SS-03 @ 4'	WH-SS-04 @ 4'	WH-SS-01 @ 5'			
Photo Number(s)	See photolog							
Other observations regarding wellheads:								
Summary								
Was impacted soil identified?								
<input checked="" type="radio"/> No Yes - less than 10 cubic yards Yes - more than 10 cubic yards								
Total number of samples field screened: 5				Total number of samples collected: 5				
Highest PID Reading: 11.9				Total number of samples submitted to lab for analysis: 1				
If more than 10 cubic yards of impacted soil were observed:								
Vertical extent:				Estimated spill volume:				
Lateral extent: N/A				Volume of soil removed:				
Is additional investigation required?								
Was groundwater encountered during the investigation?								
<input checked="" type="radio"/> No Yes - not impacted or in contact with impacted soils Yes - groundwater impacted and/or in contact with impacted soils								
Measured depth to groundwater:				Was remedial groundwater removal conducted? Yes No				
Date Groundwater was encountered:				Commencement date of removal:				
Sheen on groundwater? Yes No				Volume of groundwater removed prior to sampling:				
Free product observed? Yes No				Volume of groundwater removed post sampling:				
Total number of samples collected:				Total Volume of groundwater removed:				
Total number of samples submitted to lab for analysis:								



FIGURES

Figure 1: Topographic Site Location Map

Figure 2: Aerial Site Location Map

Figure 3: Soil Analytical Map

Figure 4: Polycyclic Aromatic Hydrocarbons Map

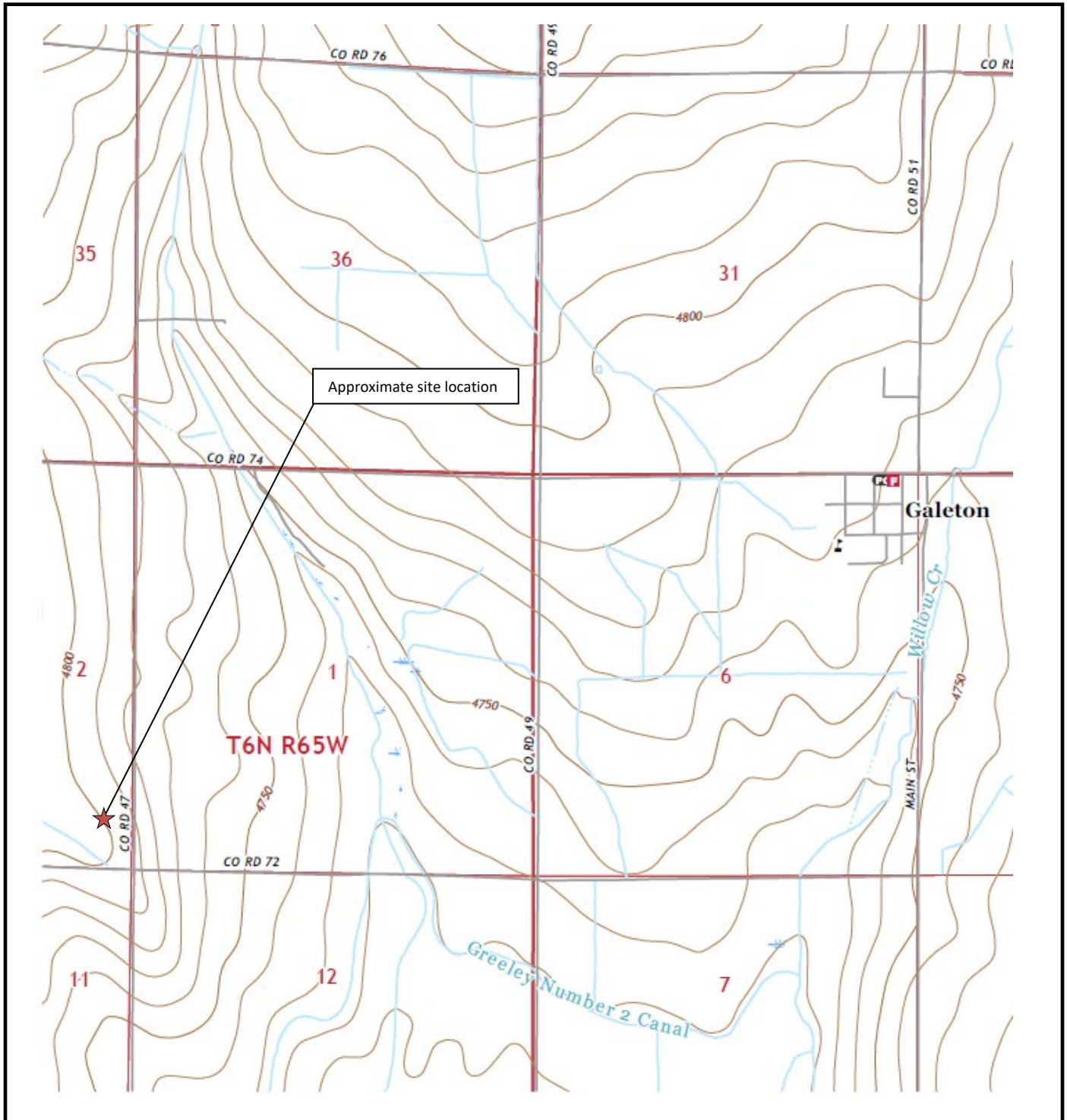

Topographic Site Location Map
 Armstrong #2-16G5
 Closure Assessment
 40.510353 / -104.622366
 SE¼ SE¼ SEC.2 T6N R65W 6PM
 Weld County, Colorado
 API # 05-123-18603
 Remediation # 20986



EAGLE
 ENVIRONMENTAL
 CONSULTING, INC.

Source: USGS 7.5 Minute Topographic
 Map, Galeton, CO Quadrangle 2019

Figure 1



LEGEND

- FORMER ARMSTRONG #2-16G5 WELLHEAD (PLUGGED AND ABANDONED)
- ASSOCIATED SEPARATOR
- APPROXIMATE FLOWLINE LOCATION

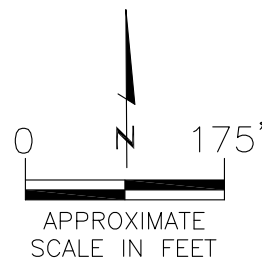

AERIAL SITE LOCATION MAP
 ARMSTRONG #2-16G5
 CLOSURE ASSESSMENT
 40.510353 / -104.622366
 SE¼ SE¼ SEC.2 T6N R65W 6PM
 WELD COUNTY, COLORADO
 API # 05-123-18603
 REMEDIATION # 20986

DATE: 03/30/22

FIG. NO.
2

DRAWN BY:
GEC



EAGLE
 ENVIRONMENTAL
 CONSULTING, INC.
 8000 W 44th Ave, Wheat Ridge, CO 80033
 Ph: 303-433-0479 • F: 303-325-5449

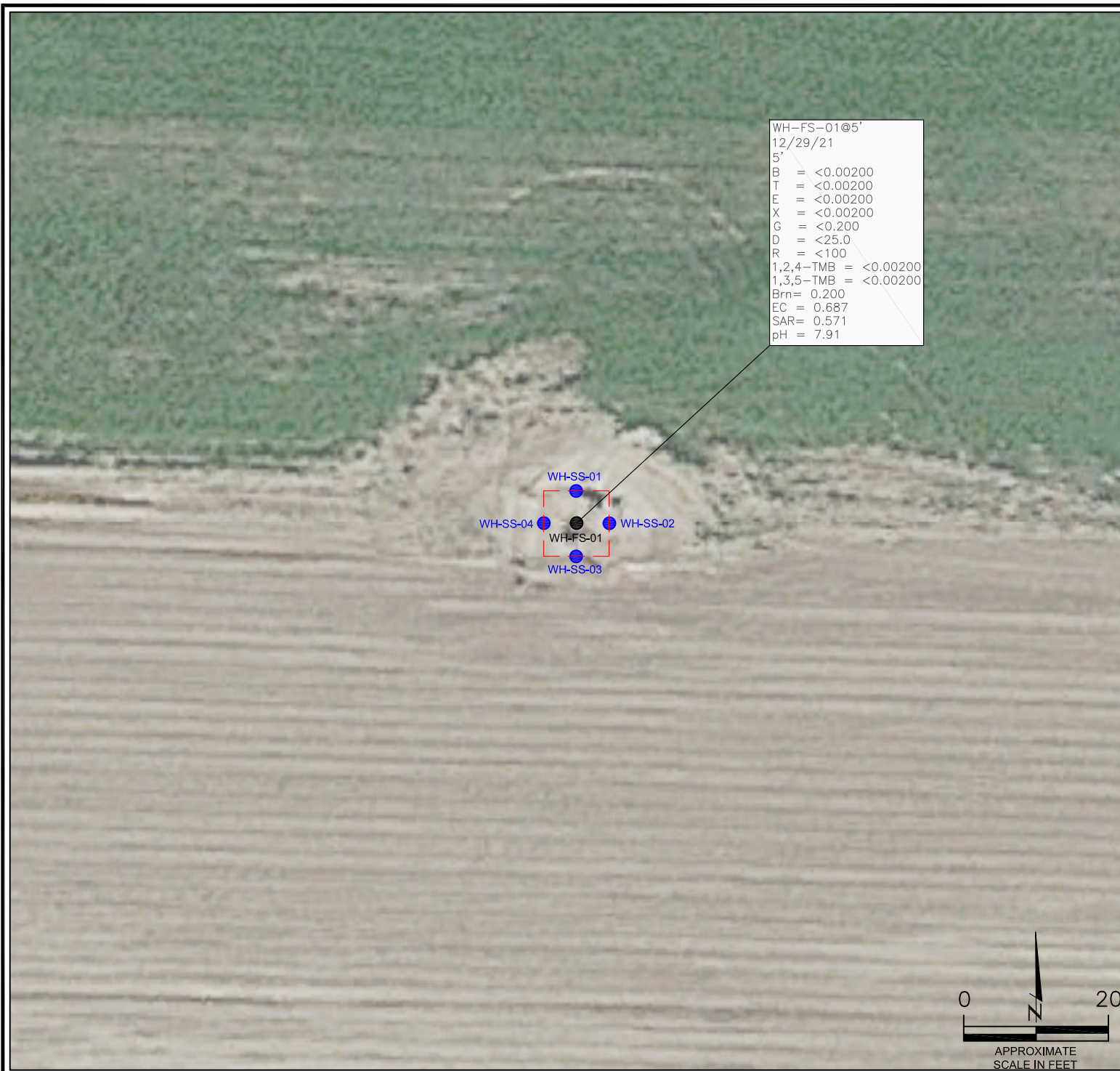

WH-FS-01@5'
12/29/21
5'
B = <0.00200
T = <0.00200
E = <0.00200
X = <0.00200
G = <0.200
D = <25.0
R = <100
1,2,4-TMB = <0.00200
1,3,5-TMB = <0.00200
Brn = 0.200
EC = 0.687
SAR = 0.571
pH = 7.91

LEGEND

- INITIAL ASSESSMENT BOUNDARIES
- SS-02 APPROXIMATE LOCATION OF SOIL SAMPLES FIELD SCREENED, ONLY, WITH PHOTOIONIZATION DETECTOR
- SS-02 APPROXIMATE LOCATION OF SOIL SAMPLES SUBMITTED FOR LABORATORY ANALYSIS

PARAMETERS

SAMPLE LOCATION
DATE
DEPTH (FEET)
B = BENZENE (mg/kg)
T = TOLUENE (mg/kg)
E = ETHYLBENZENE (mg/kg)
X = TOTAL XYLENES (mg/kg)
G = TPH-GRO (mg/kg)
D = TPH-DRO (mg/kg)
R = TPH-RRO (mg/kg)
1,2,4-TMB = 1,2,4 TRIMETHYLBENZENE (mg/kg)
1,3,5-TMB = 1,3,5 TRIMETHYLBENZENE (mg/kg)
Brn = BORON (mg/L)
EC = SPECIFIC CONDUCTANCE (mmhos/cm)
SAR = SODIUM ADSORPTION RATIO
pH = pH (pH UNITS)

mg/kg = MILLIGRAMS PER KILOGRAM
mg/L = MILLIGRAMS PER LITER
mmhos/cm = MILLIMHOS PER CENTIMETER

TPH-GRO = TOTAL PETROLEUM HYDROCARBONS - GASOLINE RANGE ORGANICS
TPH-DRO = TOTAL PETROLEUM HYDROCARBONS - DIESEL RANGE ORGANICS
TPH-RRO = TOTAL PETROLEUM HYDROCARBONS - RESIDUAL RANGE ORGANICS

NOTES:
VALUES PRESENTED WITH A LESS THAN SYMBOL (<) DID NOT CONTAIN CONCENTRATIONS AT OR ABOVE LABORATORY DETECTION LIMITS

VALUES PRESENTED IN **BOLD** VALUES CONTAIN CONCENTRATIONS THAT EXCEED COGCC TABLE 915-1 REGULATORY LIMITS FOR THAT COMPOUND.

COGCC = COLORADO OIL AND GAS CONSERVATION COMMISSION

SOIL ANALYTICAL MAP
ARMSTRONG #2-16G5
CLOSURE ASSESSMENT
40.510353 / -104.622366
SE¼ SE¼ SEC.2 T6N R65W 6PM
WELD COUNTY, COLORADO
API # 05-123-18603
REMEDIATION # 20986

DATE:
03/30/22
DRAWN BY:
GEC

FIG.
NO. 3



EAGLE
ENVIRONMENTAL
CONSULTING, INC.
8000 W 44th Ave, Wheat Ridge, CO 80033
Ph: 303-433-0479 • F: 303-325-5449



WH-FS-01@5'
 12/29/21
 5'
 ND = <0.00067
 1-Methylnaphthalene = ND
 2-Methylnaphthalene = ND
 Acenaphthene = ND
 Anthracene = ND
 Benzo(a)anthracene = ND
 Benzo(a)pyrene = ND
 Benzo(b)fluoranthene = ND
 Benzo(k)fluoranthene = ND
 Chrysene = ND
 Dibenzo(a,h)anthracene = ND
 Fluoranthene = ND
 Fluorene = ND
 Indeno(1,2,3-CD)pyrene = 0.000351
 Naphthalene = ND
 Pyrene = ND

LEGEND

- INITIAL ASSESSMENT BOUNDARIES
- SS-02 APPROXIMATE LOCATION OF SOIL SAMPLES FIELD SCREENED, ONLY, WITH PHOTOIONIZATION DETECTOR
- SS-02 APPROXIMATE LOCATION OF SOIL SAMPLES SUBMITTED FOR LABORATORY ANALYSIS

PARAMETERS

SAMPLE LOCATION
 DATE SAMPLE COLLECTED
 APPROXIMATE DEPTH
 POLYCYCLIC AROMATIC HYDROCARBONS (PAHs)

NOTE:
 CONCENTRATIONS PRESENTED IN mg/kg

mg/kg = MILLIGRAMS PER KILOGRAM

ND = NON-DETECT

NOTE:
 VALUES PRESENTED WITH A LESS THAN SYMBOL (<) DID NOT CONTAIN CONCENTRATIONS AT OR ABOVE LABORATORY DETECTION LIMITS

VALUES PRESENTED IN **BOLD** VALUES CONTAIN CONCENTRATIONS EXCEEDING COGCC TABLE 915-1 REGULATORY LIMITS.

COGCC = COLORADO OIL AND GAS CONSERVATION COMMISSION

POLYCYCLIC AROMATIC HYDROCARBONS MAP
 ARMSTRONG #2-16G5
 CLOSURE ASSESSMENT
 40.510353 / -104.622366
 SE¼ SE¼ SEC.2 T6N R65W 6PM
 WELD COUNTY, COLORADO
 API # 05-123-18603
 REMEDIATION # 20986

DATE:
 03/30/22
 DRAWN BY:
 GEC

FIG.
 NO. 4

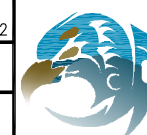

EAGLE
 ENVIRONMENTAL
 CONSULTING, INC.
 8000 W 44th Ave, Wheat Ridge, CO 80033
 Ph: 303-433-0479 • F: 303-325-5449



TABLES

Table 1: Photoionization Detector Reading Summary

Table 2: Soil Analytical Results Summary

Table 3: Polycyclic Aromatic Hydrocarbons Analytical Results Summary

TABLE 1
 PHOTOIONIZATION DETECTOR READING SUMMARY
 ARMSTRONG #2-16G5
 CLOSURE ASSESSMENT
 40.510353 / -104.622366
 SE1/4 SE1/4 SEC.2 T6N R65W 6PM
 WELD COUNTY, COLORADO
 API # 05-123-18603
 REMEDIATION # 20986

Sample Location (Latitude/Longitude)	Date	Approximate Depth (feet)	PID Reading (ppm-v)	Lab Submission (Y/N)
WH-SS-01 @ 4' (40.510380 / -104.622362)	12/29/21	4	7.8	N
WH-SS-02 @ 4' (40.510365 / -104.622337)	12/29/21	4	8.9	N
WH-SS-03 @ 4' (40.510349 / -104.622361)	12/29/21	4	9.3	N
WH-SS-04 @ 4' (40.510365 / -104.622388)	12/29/21	4	7.4	N
WH-FS-01 @ 5' (40.510366 / -104.622360)	12/29/21	5	11.9	Y
(Y/N) = Yes or No ppm-v = parts per million by volume PID = photoionization detector				

TABLE 2
SOIL ANALYTICAL RESULTS SUMMARY
ARMSTRONG #2-16G5
CLOSURE ASSESSMENT
40.510353 / -104.622366
SE1/4 SE1/4 SEC.2 T6N R65W 6PM
WELD COUNTY, COLORADO
API # 05-123-18603
REMEDATION # 20986

Sample Location (Latitude/Longitude)	Date	Approximate Depth (feet)	PID Reading (ppm-v)	Benzene (mg/kg)	Toluene (mg/kg)	Ethylbenzene (mg/kg)	Total Xylenes (mg/kg)	TPH-GRO (mg/kg)	TPH-DRO (mg/kg)	TPH-RRO (mg/kg)	1,2,4-TMB (mg/kg)	1,3,5-TMB (mg/kg)	Boron (mg/L)	Specific Conductance (mmhos/cm)	pH (pH units)	SAR
COGCC Table 915-1 Residential Screening Levels (mg/kg)				1.20	490	5.8	58	500			30	27	2	<4	6-8.3	<6
COGCC Table 915-1 Protection of Groundwater Soil Screening Levels				0.0026	0.69	0.78	9.9	--			0.0081	0.0087	--	--	--	--
WH-FS-01 @ 5' (40.510366 / -104.622360)	12/29/21	5	11.9	<0.00200	<0.00200	<0.00200	<0.00200	<0.200	<25.0	<100	<0.00200	<0.00200	0.200	0.687	7.91	0.571
<div>COGCC = Colorado Oil and Gas Conservation Commission</div> <div>mg/kg = milligrams per kilogram</div> <div>mmhos/cm = millimhos per centimeter</div> <div>PID = Photoionization Detector</div> <div>ppm-v = parts per million by volume</div> <div>mg/L = milligrams per liter</div> <div>SAR = Sodium Adsorption Ratio</div> <div>Note: Values presented with a less than symbol (<) did not contain concentrations at or above the laboratory MDL and/or reporting limit.</div> <div>Note: Values presented in BOLD contained concentrations exceeding COGCC Table 915-1 Regulatory Limits</div> <div>TPH-GRO = Total Petroleum Hydrocarbons - Gasoline Range Organics</div> <div>TPH-DRO = Total Petroleum Hydrocarbons - Diesel Range Organics</div> <div>TPH-RRO = Total Petroleum Hydrocarbons - Residual Range Organics</div> <div>1,2,4-TMB = 1,2,4-Trimethybenzene</div> <div>1,3,5-TMB = 1,3,5-Trimethybenzene</div> <div>MDL = Minimum Detection Limits</div>																

TABLE 3
POLYCYCLIC AROMATIC HYDROCARBONS ANALYTICAL RESULTS SUMMARY
ARMSTRONG #2-16G5
CLOSURE ASSESSMENT
40.510353 / -104.622366
SE1/4 SE1/4 SEC.2 T6N R65W 6PM
WELD COUNTY, COLORADO
API # 05-123-18603
REMEDATION # 20986

Sample Location (Latitude/Longitude)	Date	Approximate Depth (feet)	PID Reading (ppm-v)	1-Methyl- naphthalene (mg/kg)	2-Methyl- naphthalene (mg/kg)	Acenaphthene (mg/kg)	Anthracene (mg/kg)	Benzo(a)-anthracene (mg/kg)	Benzo(a)- pyrene (mg/kg)	Benzo(b)- fluoranthene (mg/kg)	Benzo(k)- fluoranthene (mg/kg)	Chrysene (mg/kg)	Dibenzo(a,h)- anthracene (mg/kg)	Fluoranthene (mg/kg)	Fluorene (mg/kg)	Indeno(1,2,3- cd)-pyrene (mg/kg)	Naphthalene (mg/kg)	Pyrene (mg/kg)
COGCC Table 915-1 Residential Screening Levels				18	24	360	1,800	1.1	0.11	1.1	11	110	0.11	240	240	1.1	2	180
COGCC Table 915-1 Protection of Groundwater Soil Screening Levels				0.006	0.019	0.55	5.8	0.011	0.24	0.3	2.9	9	0.096	8.9	0.54	0.98	0.0038	1.3
WH-FS-01 @ 5' (40.510366 / -104.622360)	12/29/21	5	11.9	<0.00067	<0.00067	<0.00067	<0.00067	<0.00067	<0.00067	<0.00067	<0.00067	<0.00067	<0.00067	<0.00067	<0.00067	0.000351	<0.00067	<0.00067
COGCC = Colorado Oil and Gas Conservation Commission PID = Photoionization Detector mg/kg = milligrams per kilogram ppm-v = parts per million by volume MDL - Minimum Detection Limit Note: Values presented with a less than symbol (<) did not contain concentrations at or above the laboratory MDL and/or reporting limit. Note: Values presented in BOLD contained concentrations exceeding COGCC Table 915-1 Regulatory Limits																		



ATTACHMENT A

Photo Log

Armstrong #2-16G5

API # 05-123-18603

Remediation # 20986

Closure Assessment

December 2021



EAGLE
ENVIRONMENTAL
CONSULTING, INC.
8000 W 44th Ave, Wheat Ridge, CO 80033
Ph: 303-433-0479 • F: 303-325-5449



Wellhead Excavation – 12/29/21



Looking west

No petroleum hydrocarbon staining or odor observed



ATTACHMENT B

Laboratory Analytical Report



January 07, 2022

Eagle Environmental Consulting, Inc.

Martin C Eckert III

8000 W 44th Ave

Wheat Ridge CO 80033

Project Name - Noble - Armstrong #2-16G5

Project Number - -

Attached are your analytical results for Noble - Armstrong #2-16G5 received by Origins Laboratory, Inc. December 30, 2021. This project is associated with Origins project number Y112662-01.

The analytical results in the following report were analyzed under the guidelines of EPA Methods. These methods are identified as follows; "SW" are defined in SW-846, "EPA" are defined in 40CFR part 136 and "SM" are defined in the most current revision of Standard Methods For the Examination of Water and Wastewater.

The analytical results apply specifically to the samples and analyses specified per the attached Chain of Custody. As such, this report shall not be reproduced except in full, without the written approval of Origin's laboratory.

Unless otherwise noted, the analytical results for all soil samples are reported on a wet weight basis. All analytical analyses were performed under NELAP guidelines unless noted by a data qualifier.

Any holding time exceedances, deviations from the method specifications or deviations from Origins Laboratory's Standard Operating Procedures are outlined in the case narrative.

Thank you for selecting Origins for your analytical needs. Please contact us with any questions concerning this report, or if we can help with anything at all.

Origins Laboratory, Inc.
303.433.1322
o-squad@oelabinc.com



1725 Elk Place, Denver, CO 80211 | Phone: 303.433.1322 | Fax: 303.265.9645

Eagle Environmental Consulting, Inc.

8000 W 44th Ave

Wheat Ridge CO 80033

Martin C Eckert III

Project Number: -

Project: Noble - Armstrong #2-16G5

CROSS REFERENCE REPORT

Sample ID	Laboratory ID	Matrix	Date Sampled	Date Received
WH-FS-01@5'	Y112662-01	Soil	December 29, 2021 16:23	12/30/2021 08:48

Origins Laboratory, Inc.



The results in this report apply to the samples analyzed in accordance with the chain of custody document. This analytical report must be reproduced in its entirety.

Eagle Environmental Consulting, Inc.
8000 W 44th Ave
Wheat Ridge CO 80033

Martin C Eckert III
Project Number: -
Project: Noble - Armstrong #2-16G5

Origins Laboratory

F-012207-01-R1
Effective Date: 01/09/12

Sample Receipt Checklist

Origins Work Order: 41126662

Client: Eagle

Client Project ID: Armstrong #2-16G5

Checklist Completed by: QH

Shipped Via: TD

(UPS, FedEx, Hand Delivered, Pick-up, etc.)

Date/time completed: 12/30/11

Airbill #: 1A

Matrix(s) Received: (Check all that apply): ☒ Soil/Solid ☐ Water ☐ Other: _____

Cooler Number/Temperature: 1 12.5 °C 1 °C 1 °C (Describe) 1 °C

Thermometer ID: TD03

Requirement Description	Yes	No	N/A	Comments (if any)
If samples require cooling, was the temperature between 0°C to ≤ 6°C ⁽¹⁾ ?	<input checked="" type="checkbox"/>	<input type="checkbox"/>	<input type="checkbox"/>	
Is there ice present (document if blue ice is used)	<input checked="" type="checkbox"/>	<input type="checkbox"/>	<input type="checkbox"/>	
Are custody seals present on cooler? (if so, document in comments if they are signed and dated, broken or intact)	<input type="checkbox"/>	<input checked="" type="checkbox"/>	<input type="checkbox"/>	
Are custody seals present on each sample container? (if so, document in comments if they are signed and dated, broken or intact)	<input type="checkbox"/>	<input checked="" type="checkbox"/>	<input type="checkbox"/>	
Were all samples received intact ⁽¹⁾ ?	<input checked="" type="checkbox"/>	<input type="checkbox"/>	<input type="checkbox"/>	
Was adequate sample volume provided ⁽¹⁾ ?	<input checked="" type="checkbox"/>	<input type="checkbox"/>	<input type="checkbox"/>	
Are short holding time analytes or samples with HTs due within 48 hours present ⁽¹⁾ ?	<input type="checkbox"/>	<input checked="" type="checkbox"/>	<input type="checkbox"/>	
Is a chain-of-custody (COC) present and filled out completely ⁽¹⁾ ?	<input checked="" type="checkbox"/>	<input type="checkbox"/>	<input type="checkbox"/>	
Does the COC agree with the number and type of sample bottles received ⁽¹⁾ ?	<input checked="" type="checkbox"/>	<input type="checkbox"/>	<input type="checkbox"/>	
Do the sample IDs on the bottle labels match the COC ⁽¹⁾ ?	<input checked="" type="checkbox"/>	<input type="checkbox"/>	<input type="checkbox"/>	
Is the COC properly relinquished by the client with date and time recorded ⁽¹⁾ ?	<input checked="" type="checkbox"/>	<input type="checkbox"/>	<input type="checkbox"/>	
For volatiles in water – is there headspace (> ¼ inch bubble) present? If yes, contact client and note in narrative.	<input type="checkbox"/>	<input type="checkbox"/>	<input checked="" type="checkbox"/>	
Are samples preserved that require preservation and was it checked ⁽¹⁾ ? (note ID of confirmation instrument used in comments) / (preservation is not confirmed for subcontracted analyses in order to insure sample integrity)(pH < 2 for samples preserved with HNO ₃ , HCL, H ₂ SO ₄) / (pH > 10 for samples preserved with NaAsO ₂ +NaOH, ZnAc+NaOH)	<input type="checkbox"/>	<input type="checkbox"/>	<input checked="" type="checkbox"/>	
Additional Comments (if any):				

⁽¹⁾If NO, then contact the client before proceeding with analysis and note date/time and person contacted as well as the corrective action to in the additional comments (above) and the case narrative.

Reviewed by (Project Manager) JP

Date/Time Reviewed 1/3/12

Origins Laboratory, Inc.

Jordan A. Merrill

The results in this report apply to the samples analyzed in accordance with the chain of custody document. This analytical report must be reproduced in its entirety.

Eagle Environmental Consulting, Inc.
8000 W 44th Ave
Wheat Ridge CO 80033

Martin C Eckert III
Project Number: -
Project: Noble - Armstrong #2-16G5

WH-FS-01@5'

12/29/2021 4:23:00PM

Analyte	Result	Reporting Limit	Units	Dilution	Batch	Analyst	Prepared	Analyzed	Notes
---------	--------	-----------------	-------	----------	-------	---------	----------	----------	-------

Origins Laboratory, Inc.
Y112662-01 (Soil)

Boron (DTPA Sorbitol)

Boron	0.200	0.200	mg/L	1	B2A0302	CJM	01/03/2022	01/03/2022	
-------	-------	-------	------	---	---------	-----	------------	------------	--

DRO/ORO by EPA 8015D

Diesel (C10-C28)	ND	25.0	mg/kg	1	B1L3006	EPC	12/30/2021	12/31/2021	U
Residual Range Organics (C28-C40)	ND	100	"	"	"	EPC	"	"	U

Surrogate: o-Terphenyl	65.1 %	50-150			"	"	"	
------------------------	--------	--------	--	--	---	---	---	--

GBTEX+TMBs by 8260D

1,2,4-Trimethylbenzene	ND	0.00200	mg/kg	1	B1L3005	ZZZ	12/30/2021	01/02/2022	U
1,3,5-Trimethylbenzene	ND	0.00200	"	"	"	ZZZ	"	"	U
Benzene	ND	0.00200	"	"	"	ZZZ	"	"	U
Ethylbenzene	ND	0.00200	"	"	"	ZZZ	"	"	U
Toluene	ND	0.00200	"	"	"	ZZZ	"	"	U
Xylenes, total	ND	0.00200	"	"	"	ZZZ	"	"	U
Gasoline Range Hydrocarbons	ND	0.200	"	"	"	ZZZ	"	"	U

Surrogate: 1,2-Dichloroethane-d4	97.8 %	70-130			"	"	"	
Surrogate: Toluene-d8	97.5 %	70-130			"	"	"	
Surrogate: 4-Bromofluorobenzene	97.5 %	70-130			"	"	"	

Metals by Saturated Paste by EPA 6010

Origins Laboratory, Inc.



The results in this report apply to the samples analyzed in accordance with the chain of custody document. This analytical report must be reproduced in its entirety.

Eagle Environmental Consulting, Inc.
8000 W 44th Ave
Wheat Ridge CO 80033

Martin C Eckert III
Project Number: -
Project: Noble - Armstrong #2-16G5

WH-FS-01@5'

12/29/2021 4:23:00PM

Analyte	Result	Reporting Limit	Units	Dilution	Batch	Analyst	Prepared	Analyzed	Notes
---------	--------	-----------------	-------	----------	-------	---------	----------	----------	-------

Origins Laboratory, Inc.
Y112662-01 (Soil)

Metals by Saturated Paste by EPA 6010

Calcium	3.07	0.499	meq/L	10	[CALC]	CJM	01/03/2022	01/04/2022
Magnesium	1.30	0.823	"	"	"	CJM	"	"
Sodium	0.844	0.435	"	"	"	CJM	"	"

PAH by 8270D SIM

1-Methylnaphthalene	ND	0.00067	mg/Kg	1	L592919		01/04/2022	01/05/2022
2-Methylnaphthalene	ND	0.00067	"	"	"		"	"
Acenaphthene	ND	0.00067	"	"	"		"	"
Anthracene	ND	0.00067	"	"	"		"	"
Benzo(a)anthracene	ND	0.00067	"	"	"		"	"
Benzo(a)pyrene	ND	0.00067	"	"	"		"	"
Benzo(b)fluoranthene	ND	0.00067	"	"	"		"	"
Benzo(k)fluoranthene	ND	0.00067	"	"	"		"	"
Chrysene	ND	0.00067	"	"	"		"	"
Dibenz(a,h)anthracene	ND	0.00067	"	"	"		"	"
Fluoranthene	ND	0.00067	"	"	"		"	"
Fluorene	ND	0.00067	"	"	"		"	"
Indeno(1,2,3-cd)pyrene	0.000351	0.00067	"	"	"		"	"
Naphthalene	ND	0.00067	"	"	"		"	"
Pyrene	ND	0.00067	"	"	"		"	"

Origins Laboratory, Inc.



The results in this report apply to the samples analyzed in accordance with the chain of custody document. This analytical report must be reproduced in its entirety.

Eagle Environmental Consulting, Inc.
8000 W 44th Ave
Wheat Ridge CO 80033

Martin C Eckert III
Project Number: -
Project: Noble - Armstrong #2-16G5

WH-FS-01@5'

12/29/2021 4:23:00PM

Analyte	Result	Reporting Limit	Units	Dilution	Batch	Analyst	Prepared	Analyzed	Notes
---------	--------	-----------------	-------	----------	-------	---------	----------	----------	-------

Waypoint Analytical, Inc.
Y112662-01 (Soil)

PAH by 8270D SIM

Surrogate: 2-Fluorobiphenyl	55.9 %	33-115			L5929 19	01/04/2022	01/05/2022
Surrogate: 4-Terphenyl-d14	58 %	33-122			"	"	"
Surrogate: Nitrobenzene-d5	39.3 %	29-110			"	"	"

pH in Soil by 9045D

pH	7.91	pH Units	1	B2A0304	ACC	01/03/2022	01/04/2022
----	------	----------	---	---------	-----	------------	------------

SAR by 20B Saturated Paste

SAR	0.571	SAR	1	B2A0301	CJM	01/03/2022	01/04/2022
-----	-------	-----	---	---------	-----	------------	------------

Specific Conductance Mod. 9050A

Specific Conductance (EC)	0.687	0.00500 mmhos/cm	1	B2A0303	ACC	01/03/2022	01/04/2022
---------------------------	-------	------------------	---	---------	-----	------------	------------

Origins Laboratory, Inc.



The results in this report apply to the samples analyzed in accordance with the chain of custody document. This analytical report must be reproduced in its entirety.

Eagle Environmental Consulting, Inc.
8000 W 44th Ave
Wheat Ridge CO 80033

Martin C Eckert III
Project Number: -
Project: Noble - Armstrong #2-16G5

Volatile Organic Compounds by GC/MS SW846 8260D - Quality Control
Origins Laboratory, Inc.

Analyte	Result	Reporting Limit	Units	Spike Level	Source Result	%REC	%REC Limits	RPD	RPD Limit	Notes
Batch B1L3005 - EPA 5030 (soil)										
Blank (B1L3005-BLK1)					Prepared: 12/30/2021 Analyzed: 01/02/2022					
1,2,4-Trimethylbenzene	ND	0.00200	mg/kg							U
Naphthalene	ND	0.0100	"							U
1,3,5-Trimethylbenzene	ND	0.00200	"							U
Benzene	ND	0.00200	"							U
Ethylbenzene	ND	0.00200	"							U
Toluene	ND	0.00200	"							U
Xylenes, total	ND	0.00200	"							U
Gasoline Range Hydrocarbons	ND	0.200	"							U
Surrogate: 1,2-Dichloroethane-d4	0.11		"	0.125		85.7	70-130			
Surrogate: Toluene-d8	0.12		"	0.125		95.6	70-130			
Surrogate: 4-Bromofluorobenzene	0.13		"	0.125		102	70-130			

Origins Laboratory, Inc.



The results in this report apply to the samples analyzed in accordance with the chain of custody document. This analytical report must be reproduced in its entirety.

Eagle Environmental Consulting, Inc.
8000 W 44th Ave
Wheat Ridge CO 80033

Martin C Eckert III
Project Number: -
Project: Noble - Armstrong #2-16G5

Volatile Organic Compounds by GC/MS SW846 8260D - Quality Control
Origins Laboratory, Inc.

Analyte	Result	Reporting Limit	Units	Spike Level	Source Result	%REC	%REC Limits	RPD	RPD Limit	Notes
Batch B1L3005 - EPA 5030 (soil)										
LCS (B1L3005-BS1)					Prepared: 12/30/2021 Analyzed: 01/02/2022					
1,2,4-Trimethylbenzene	0.0847	0.00200	mg/kg	0.100		84.7	70-130			
Naphthalene	0.0752	0.0100	"	0.100		75.2	70-130			
1,3,5-Trimethylbenzene	0.0856	0.00200	"	0.100		85.6	70-130			
Benzene	0.0869	0.00200	"	0.100		86.9	70-130			
Ethylbenzene	0.0852	0.00200	"	0.100		85.2	70-130			
m,p-Xylene	0.168	0.00400	"	0.200		84.0	70-130			
o-Xylene	0.0847	0.00200	"	0.100		84.7	70-130			
Toluene	0.0874	0.00200	"	0.100		87.4	70-130			
Surrogate: 1,2-Dichloroethane-d4	0.11		"	0.125		84.1	70-130			
Surrogate: Toluene-d8	0.12		"	0.125		95.0	70-130			
Surrogate: 4-Bromofluorobenzene	0.13		"	0.125		100	70-130			

Origins Laboratory, Inc.



The results in this report apply to the samples analyzed in accordance with the chain of custody document. This analytical report must be reproduced in its entirety.

Eagle Environmental Consulting, Inc.
8000 W 44th Ave
Wheat Ridge CO 80033

Martin C Eckert III
Project Number: -
Project: Noble - Armstrong #2-16G5

Volatile Organic Compounds by GC/MS SW846 8260D - Quality Control
Origins Laboratory, Inc.

Analyte	Result	Reporting Limit	Units	Spike Level	Source Result	%REC	%REC Limits	RPD	RPD Limit	Notes
Batch B1L3005 - EPA 5030 (soil)										
Matrix Spike (B1L3005-MS1)		Source: Y112612-01			Prepared: 12/30/2021 Analyzed: 01/02/2022					
1,2,4-Trimethylbenzene	0.0903	0.00200	mg/kg	0.100	0.000860	89.5	70-130			
Naphthalene	0.0847	0.0100	"	0.100	0.00152	83.2	70-130			
1,3,5-Trimethylbenzene	0.0888	0.00200	"	0.100	0.000800	88.0	70-130			
Benzene	0.0845	0.00200	"	0.100	0.000660	83.8	70-130			
Ethylbenzene	0.0828	0.00200	"	0.100	0.000700	82.1	70-130			
m,p-Xylene	0.167	0.00400	"	0.200	0.00166	82.8	70-130			
o-Xylene	0.0865	0.00200	"	0.100	0.000820	85.7	70-130			
Toluene	0.0853	0.00200	"	0.100	ND	85.3	70-130			
Surrogate: 1,2-Dichloroethane-d4	0.11		"	0.125		84.4	70-130			
Surrogate: Toluene-d8	0.12		"	0.125		96.4	70-130			
Surrogate: 4-Bromofluorobenzene	0.13		"	0.125		101	70-130			

Origins Laboratory, Inc.



The results in this report apply to the samples analyzed in accordance with the chain of custody document. This analytical report must be reproduced in its entirety.

Eagle Environmental Consulting, Inc.
8000 W 44th Ave
Wheat Ridge CO 80033

Martin C Eckert III
Project Number: -
Project: Noble - Armstrong #2-16G5

Volatile Organic Compounds by GC/MS SW846 8260D - Quality Control
Origins Laboratory, Inc.

Analyte	Result	Reporting Limit	Units	Spike Level	Source Result	%REC	%REC Limits	RPD	RPD Limit	Notes
Batch B1L3005 - EPA 5030 (soil)										
Matrix Spike Dup (B1L3005-MSD1)		Source: Y112612-01		Prepared: 12/30/2021 Analyzed: 01/02/2022						
1,2,4-Trimethylbenzene	0.0947	0.00200	mg/kg	0.100	0.000860	93.9	70-130	4.78	20	
Naphthalene	0.0908	0.0100	"	0.100	0.00152	89.3	70-130	7.00	20	
1,3,5-Trimethylbenzene	0.0942	0.00200	"	0.100	0.000800	93.4	70-130	5.90	20	
Benzene	0.0902	0.00200	"	0.100	0.000660	89.6	70-130	6.59	20	
Ethylbenzene	0.0868	0.00200	"	0.100	0.000700	86.1	70-130	4.72	20	
m,p-Xylene	0.176	0.00400	"	0.200	0.00166	87.3	70-130	5.17	20	
o-Xylene	0.0914	0.00200	"	0.100	0.000820	90.6	70-130	5.48	20	
Toluene	0.0910	0.00200	"	0.100	ND	91.0	70-130	6.42	20	
Surrogate: 1,2-Dichloroethane-d4	0.10		"	0.125		82.6	70-130			
Surrogate: Toluene-d8	0.12		"	0.125		95.9	70-130			
Surrogate: 4-Bromofluorobenzene	0.12		"	0.125		99.1	70-130			

Origins Laboratory, Inc.



The results in this report apply to the samples analyzed in accordance with the chain of custody document. This analytical report must be reproduced in its entirety.

Eagle Environmental Consulting, Inc.
8000 W 44th Ave
Wheat Ridge CO 80033

Martin C Eckert III
Project Number: -
Project: Noble - Armstrong #2-16G5

Volatile Organic Compounds by GC/MS SW846 8260D - Quality Control
Origins Laboratory, Inc.

Analyte	Result	Reporting Limit	Units	Spike Level	Source Result	%REC	%REC Limits	RPD	RPD Limit	Notes
Batch B1L3006 - EPA 3550B										
Blank (B1L3006-BLK1)					Prepared: 12/30/2021 Analyzed: 12/31/2021					
Diesel (C10-C28)	ND	25.0	mg/kg							U
Residual Range Organics (C28-C40)	ND	100	"							U
Surrogate: o-Terphenyl	19		"	24.9		76.1	50-150			

Origins Laboratory, Inc.



The results in this report apply to the samples analyzed in accordance with the chain of custody document. This analytical report must be reproduced in its entirety.

Eagle Environmental Consulting, Inc.

8000 W 44th Ave

Wheat Ridge CO 80033

Martin C Eckert III

Project Number: -

Project: Noble - Armstrong #2-16G5

Extractable Petroleum Hydrocarbons by 8015D - Quality Control
Origins Laboratory, Inc.

Analyte	Result	Reporting Limit	Units	Spike Level	Source Result	%REC	%REC Limits	RPD	RPD Limit	Notes
---------	--------	-----------------	-------	-------------	---------------	------	-------------	-----	-----------	-------

Batch B1L3006 - EPA 3550B

LCS (B1L3006-BS1)

Prepared: 12/30/2021 Analyzed: 12/31/2021

Diesel (C10-C28)	809	50.0	mg/kg	1000		80.9	70-130			
Residual Range Organics (C28-C40)	830	200	"	1000		83.0	70-130			
Surrogate: o-Terphenyl	43		"	49.8		86.5	50-150			

Origins Laboratory, Inc.



The results in this report apply to the samples analyzed in accordance with the chain of custody document. This analytical report must be reproduced in its entirety.

Jordan A. Merrill, Project Manager

Eagle Environmental Consulting, Inc.

8000 W 44th Ave

Wheat Ridge CO 80033

Martin C Eckert III

Project Number: -

Project: Noble - Armstrong #2-16G5

Extractable Petroleum Hydrocarbons by 8015D - Quality Control

Origins Laboratory, Inc.

Analyte	Result	Reporting Limit	Units	Spike Level	Source Result	%REC	%REC Limits	RPD	RPD Limit	Notes
---------	--------	-----------------	-------	-------------	---------------	------	-------------	-----	-----------	-------

Batch B1L3006 - EPA 3550B

Matrix Spike (B1L3006-MS1)		Source: Y112626-01			Prepared: 12/30/2021 Analyzed: 12/31/2021					
Diesel (C10-C28)	731	50.0	mg/kg	1000	ND	73.1	70-130			
Residual Range Organics (C28-C40)	722	200	"	1000	ND	72.2	70-130			
Surrogate: o-Terphenyl	33		"	49.8		66.7	50-150			

Origins Laboratory, Inc.



The results in this report apply to the samples analyzed in accordance with the chain of custody document. This analytical report must be reproduced in its entirety.

Eagle Environmental Consulting, Inc.

8000 W 44th Ave

Wheat Ridge CO 80033

Martin C Eckert III

Project Number: -

Project: Noble - Armstrong #2-16G5

Extractable Petroleum Hydrocarbons by 8015D - Quality Control

Origins Laboratory, Inc.

Analyte	Result	Reporting Limit	Units	Spike Level	Source Result	%REC	%REC Limits	RPD	RPD Limit	Notes
---------	--------	-----------------	-------	-------------	---------------	------	-------------	-----	-----------	-------

Batch B1L3006 - EPA 3550B

Matrix Spike Dup (B1L3006-MSD1)		Source: Y112626-01			Prepared: 12/30/2021 Analyzed: 12/31/2021					
Diesel (C10-C28)	755	50.0	mg/kg	1000	ND	75.5	70-130	3.35	35	
Residual Range Organics (C28-C40)	739	200	"	1000	ND	73.9	70-130	2.24	35	
Surrogate: o-Terphenyl	35		"	49.8		69.5	50-150			

Origins Laboratory, Inc.



The results in this report apply to the samples analyzed in accordance with the chain of custody document. This analytical report must be reproduced in its entirety.

Jordan A. Merrill, Project Manager

Eagle Environmental Consulting, Inc.
8000 W 44th Ave
Wheat Ridge CO 80033

Martin C Eckert III
Project Number: -
Project: Noble - Armstrong #2-16G5

Extractable Petroleum Hydrocarbons by 8015D - Quality Control

Origins Laboratory, Inc.

Analyte	Result	Reporting Limit	Units	Spike Level	Source Result	%REC	%REC Limits	RPD	RPD Limit	Notes
---------	--------	-----------------	-------	-------------	---------------	------	-------------	-----	-----------	-------

Saturated Paste - Quality Control

Origins Laboratory, Inc.

Analyte	Result	Reporting Limit	Units	Spike Level	Source Result	%REC	%REC Limits	RPD	RPD Limit	Notes
---------	--------	-----------------	-------	-------------	---------------	------	-------------	-----	-----------	-------

Batch B2A0303 - NO PREP

Blank (B2A0303-BLK1)

Prepared: 01/03/2022 Analyzed: 01/04/2022

Specific Conductance (EC) 0.000900 0.00500 mmhos/cm

Duplicate (B2A0303-DUP1)

Source: Y112660-01

Prepared: 01/03/2022 Analyzed: 01/04/2022

Specific Conductance (EC) 0.786 0.00500 mmhos/cm 0.759 3.49 25

Batch B2A0304 - NO PREP

Duplicate (B2A0304-DUP1)

Source: Y112660-01

Prepared: 01/03/2022 Analyzed: 01/04/2022

pH 7.64 pH Units 8.39 9.36 25

Origins Laboratory, Inc.



The results in this report apply to the samples analyzed in accordance with the chain of custody document. This analytical report must be reproduced in its entirety.

Eagle Environmental Consulting, Inc.
8000 W 44th Ave
Wheat Ridge CO 80033

Martin C Eckert III
Project Number: -
Project: Noble - Armstrong #2-16G5

PAH by 8270D SIM - Quality Control
Waypoint Analytical, Inc.

Analyte	Result	Reporting Limit	Units	Spike Level	Source Result	%REC	%REC Limits	RPD	RPD Limit	Notes
---------	--------	-----------------	-------	-------------	---------------	------	-------------	-----	-----------	-------

Batch L592919 - 3550B

MSD (L 97048-MSD-L592919)		Source: 97048			Prepared: 01/04/2022 Analyzed: 01/05/2022					
Chrysene	0.132	0.00027	mg/Kg	0.166	0.00177	78.4	30-130	2.2	30	
1-Methylnaphthalene	0.117	0.00033	"	0.166	<0.000330	70.4	30-130	1.7	30	
2-Methylnaphthalene	0.117	0.00039	"	0.166	<0.000390	70.4	30-130	0	30	
Acenaphthene	0.118	0.0003	"	0.166	<0.000300	71	30-130	0	30	
Anthracene	0.123	0.00033	"	0.166	<0.000330	74	30-130	2.4	30	
Benzo(a)anthracene	0.127	0.00041	"	0.166	0.000442	76.5	30-130	0.7	30	
Pyrene	0.125	0.00059	"	0.166	0.00156	74.3	30-130	1.6	30	
Naphthalene	0.106	0.000467	"	0.166	<0.000467	63.8	30-130	0	30	
Indeno(1,2,3-cd)pyrene	0.14	0.00029	"	0.166	0.00139	83.5	30-130	14.5	30	
Fluorene	0.128	0.00029	"	0.166	<0.000290	77.1	30-130	0	30	
Fluoranthene	0.136	0.00039	"	0.166	0.00093	81.3	30-130	1.4	30	
Dibenz(a,h)anthracene	0.159	0.00036	"	0.166	0.000675	95.3	30-130	14.1	30	
Benzo(b)fluoranthene	0.102	0.00021	"	0.166	0.00106	60.8	30-130	3.6	30	
Benzo(k)fluoranthene	0.111	0.00013	"	0.166	0.000589	66.8	30-130	9.4	30	
Benzo(a)pyrene	0.138	0.00024	"	0.166	0.00159	82.1	30-130	4.4	30	
Surrogate: 2-Fluorobiphenyl	61.4		"	0.332	194	61.4	33-115			
Surrogate: 4-Terphenyl-d14	65.3		"	0.332	207	65.3	33-122			
Surrogate: Nitrobenzene-d5	43.6		"	0.332	140	43.6	29-110			

MS (L 97048-MS-L592919)		Source: 97048			Prepared: 01/04/2022 Analyzed: 01/05/2022					
Benzo(a)pyrene	0.132	0.00024	mg/Kg	0.164	0.00159	79.5	30-130			
Chrysene	0.129	0.00027	"	0.164	0.00177	77.5	30-130			
Pyrene	0.123	0.00059	"	0.164	0.00156	74	30-130			
Naphthalene	0.106	0.000467	"	0.164	<0.000467	64.6	30-130			
Indeno(1,2,3-cd)pyrene	0.121	0.00029	"	0.164	0.00139	72.9	30-130			
Fluorene	0.128	0.00029	"	0.164	<0.000290	78	30-130			
Fluoranthene	0.134	0.00039	"	0.164	0.00093	81.1	30-130			

Origins Laboratory, Inc.



The results in this report apply to the samples analyzed in accordance with the chain of custody document. This analytical report must be reproduced in its entirety.

Eagle Environmental Consulting, Inc.
8000 W 44th Ave
Wheat Ridge CO 80033

Martin C Eckert III
Project Number: -
Project: Noble - Armstrong #2-16G5

PAH by 8270D SIM - Quality Control
Waypoint Analytical, Inc.

Analyte	Result	Reporting Limit	Units	Spike Level	Source Result	%REC	%REC Limits	RPD	RPD Limit	Notes
---------	--------	-----------------	-------	-------------	---------------	------	-------------	-----	-----------	-------

Batch L592919 - 3550B

MS (L 97048-MS-L592919)		Source: 97048			Prepared: 01/04/2022 Analyzed: 01/05/2022					
Dibenz(a,h)anthracene	0.138	0.00036	mg/Kg	0.164	0.000675	83.7	30-130			
Benzo(b)fluoranthene	0.0983	0.00021	"	0.164	0.00106	59.2	30-130			
Benzo(a)anthracene	0.126	0.00041	"	0.164	0.000442	76.8	30-130			
Anthracene	0.12	0.00033	"	0.164	<0.000330	73.1	30-130			
Acenaphthene	0.118	0.0003	"	0.164	<0.000300	71.9	30-130			
2-Methylnaphthalene	0.117	0.00039	"	0.164	<0.000390	71.3	30-130			
Benzo(k)fluoranthene	0.101	0.00013	"	0.164	0.000589	61.5	30-130			
1-Methylnaphthalene	0.115	0.00033	"	0.164	<0.000330	70.1	30-130			
Surrogate: Nitrobenzene-d5	43.7		"	0.329	140	43.7	29-110			
Surrogate: 2-Fluorobiphenyl	60.7		"	0.329	194	60.7	33-115			
Surrogate: 4-Terphenyl-d14	65.3		"	0.329	207	65.3	33-122			

LCS (LCS-L592919)

Prepared: 01/04/2022 Analyzed: 01/05/2022

Dibenz(a,h)anthracene	0.0651	0.00036	mg/Kg	0.167		38.9	30-130			
Fluoranthene	0.13	0.00039	"	0.167		77.8	30-130			
Pyrene	0.118	0.00059	"	0.167		70.6	30-130			
Fluorene	0.125	0.00029	"	0.167		74.8	30-130			
Indeno(1,2,3-cd)pyrene	0.0953	0.00029	"	0.167		57	30-130			
Chrysene	0.127	0.00027	"	0.167		76	30-130			
Naphthalene	0.0995	0.000467	"	0.167		59.5	30-130			
Benzo(b)fluoranthene	0.1	0.00021	"	0.167		59.8	30-130			
Benzo(a)pyrene	0.128	0.00024	"	0.167		76.6	30-130			
Benzo(a)anthracene	0.121	0.00041	"	0.167		72.4	30-130			
Acenaphthene	0.115	0.0003	"	0.167		68.8	30-130			
2-Methylnaphthalene	0.107	0.00039	"	0.167		64	30-130			
1-Methylnaphthalene	0.108	0.00033	"	0.167		64.6	30-130			
Anthracene	0.121	0.00033	"	0.167		72.4	30-130			

Origins Laboratory, Inc.



The results in this report apply to the samples analyzed in accordance with the chain of custody document. This analytical report must be reproduced in its entirety.

Eagle Environmental Consulting, Inc.
8000 W 44th Ave
Wheat Ridge CO 80033

Martin C Eckert III
Project Number: -
Project: Noble - Armstrong #2-16G5

PAH by 8270D SIM - Quality Control
Waypoint Analytical, Inc.

Analyte	Result	Reporting Limit	Units	Spike Level	Source Result	%REC	%REC Limits	RPD	RPD Limit	Notes
Batch L592919 - 3550B										
LCS (LCS-L592919)					Prepared: 01/04/2022 Analyzed: 01/05/2022					
Benzo(k)fluoranthene	0.101	0.00013	mg/Kg	0.167		60.4	30-130			
Surrogate: Nitrobenzene-d5	42		"	0.333		42	29-110			
Surrogate: 4-Terphenyl-d14	61.5		"	0.333		61.5	33-122			
Surrogate: 2-Fluorobiphenyl	55.8		"	0.333		55.8	33-115			
LRB (LRB-L592919)					Prepared: 01/04/2022 Analyzed: 01/05/2022					
Chrysene	ND	0.00067	mg/Kg				-			
Dibenz(a,h)anthracene	ND	0.00067	"				-			
Fluoranthene	ND	0.00067	"				-			
Fluorene	ND	0.00067	"				-			
Benzo(k)fluoranthene	ND	0.00067	"				-			
Naphthalene	ND	0.00067	"				-			
Indeno(1,2,3-cd)pyrene	ND	0.00067	"				-			
Benzo(b)fluoranthene	ND	0.00067	"				-			
Benzo(a)pyrene	ND	0.00067	"				-			
Benzo(a)anthracene	ND	0.00067	"				-			
Acenaphthene	ND	0.00067	"				-			
2-Methylnaphthalene	ND	0.00067	"				-			
1-Methylnaphthalene	ND	0.00067	"				-			
Pyrene	ND	0.00067	"				-			
Anthracene	ND	0.00067	"				-			
Surrogate: Nitrobenzene-d5	40.5		"	0.333		40.5	29-110			
Surrogate: 4-Terphenyl-d14	66.3		"	0.333		66.3	33-122			
Surrogate: 2-Fluorobiphenyl	57.3		"	0.333		57.3	33-115			

Origins Laboratory, Inc.



The results in this report apply to the samples analyzed in accordance with the chain of custody document. This analytical report must be reproduced in its entirety.

Eagle Environmental Consulting, Inc.

8000 W 44th Ave

Wheat Ridge CO 80033

Martin C Eckert III

Project Number: -

Project: Noble - Armstrong #2-16G5

Notes and Definitions

U Sample is Non-Detect.

J Estimated Value. Analyte below reported quantitation limit.

ND Analyte NOT DETECTED at or above the reporting limit

RPD Relative Percent Difference

All soil results are reported at a wet weight basis.

Origins Laboratory, Inc.



The results in this report apply to the samples analyzed in accordance with the chain of custody document. This analytical report must be reproduced in its entirety.