



00834312

AUG 29 1966

OIL & GAS
CONSERVATION COMMISSION

R. 55W

T.
38

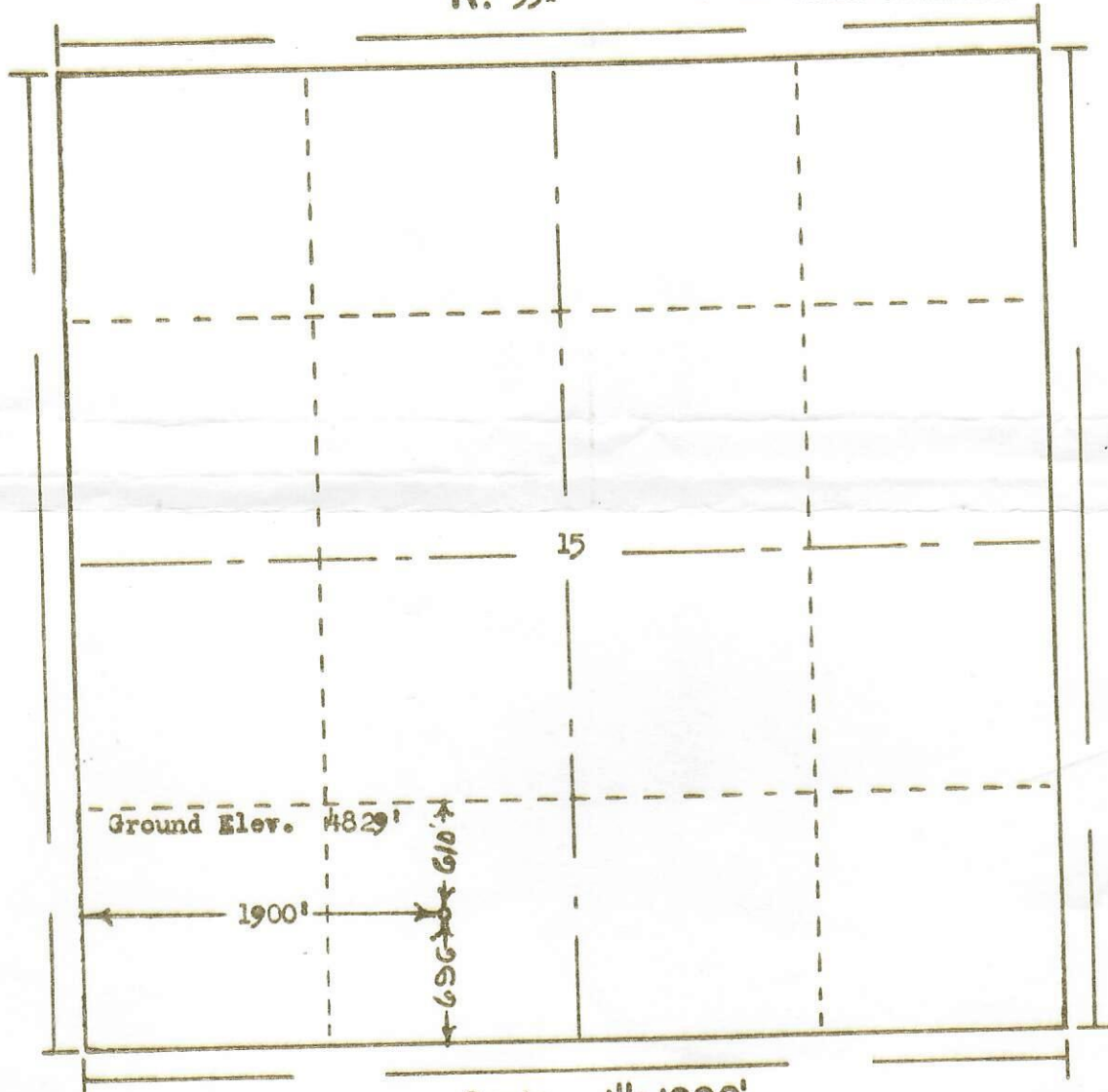

Scale ... 1" = 1000'

Powers Surveyors, Inc. of Denver, Colorado
has in accordance with a request from Mr. Simpson
for Union Texas Petroleum determined the
Location of No. 1 Stenback Etal
to be 696'RS & 1900'FW Section 15 Township 38
Range 55W of the 6th Principal Meridian
Washington County, Colorado

I hereby certify that this plat is an
accurate representation of a correct
survey showing the location of

66 334

Date: 8-3-66

Billy G. Hollaway
Licensed Land Surveyor No. 2853
State of Colorado