



99999999

R. 55W

COLO. OIL &amp; GAS CONS. COMM.

RECEIVED

DEC 14 1970

N

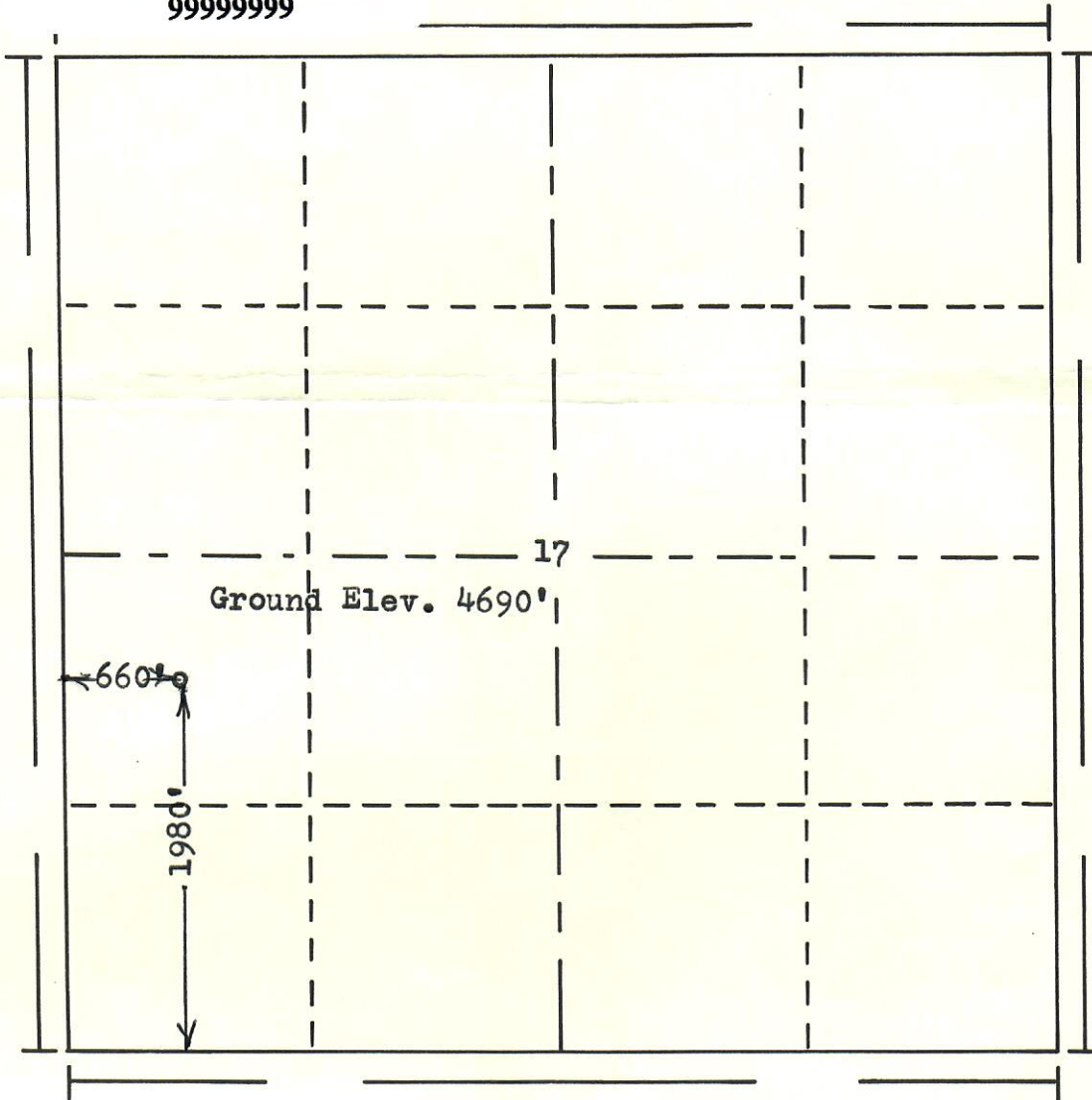
T.  
3  
S

Scale... 1" = 1000'

Powers Elevation Company, Inc. of Denver, Colorado  
has in accordance with a request from Shauna  
for Ed O'Hara

determined the location of No. 1 Landacre  
to be CNW SW Section 17 Township 3S  
Range 55W of the 6th Principal Meridian  
Washington County, Colorado



00325554

I hereby certify that this plat is an  
accurate representation of a correct  
survey showing the location of

Date: 12-9-70

Licensed Land Surveyor No. 2853  
State of Colorado