

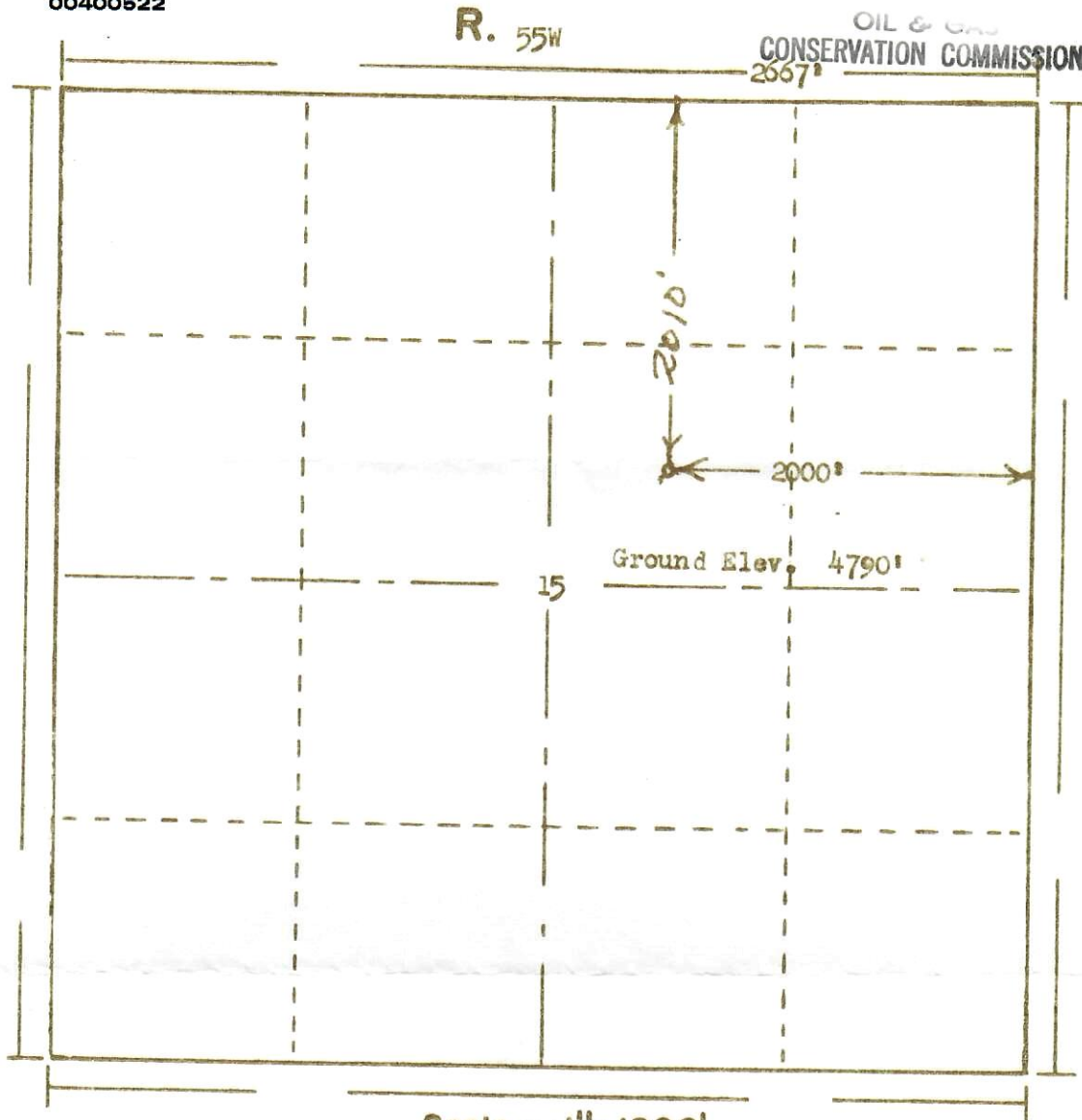

00400522

RECEIVED
JUL 22 1966T.
3
S

Scale ... 1" = 1000'

Powers Surveyors, Inc. of Denver, Colorado
has in accordance with a request from Mr. Lowe
for Consolidated Oil & Gas Inc. determined the
Location of No. 1-B Hass
to be CSW NE Section 15 Township 38
Range 55W of the 6th Principal Meridian
Washington County, Colorado

I hereby certify that this plat is an
accurate representation of a correct
survey showing the location of

Date: 7-15-66

Ree. G. Holloway
Licensed Land Surveyor No. 853
State of Colorado