



FORM F-106



00400551

R. 55W

RECEIVED

SEP 18 1981

COLO. OIL &amp; GAS CONS. COMM.

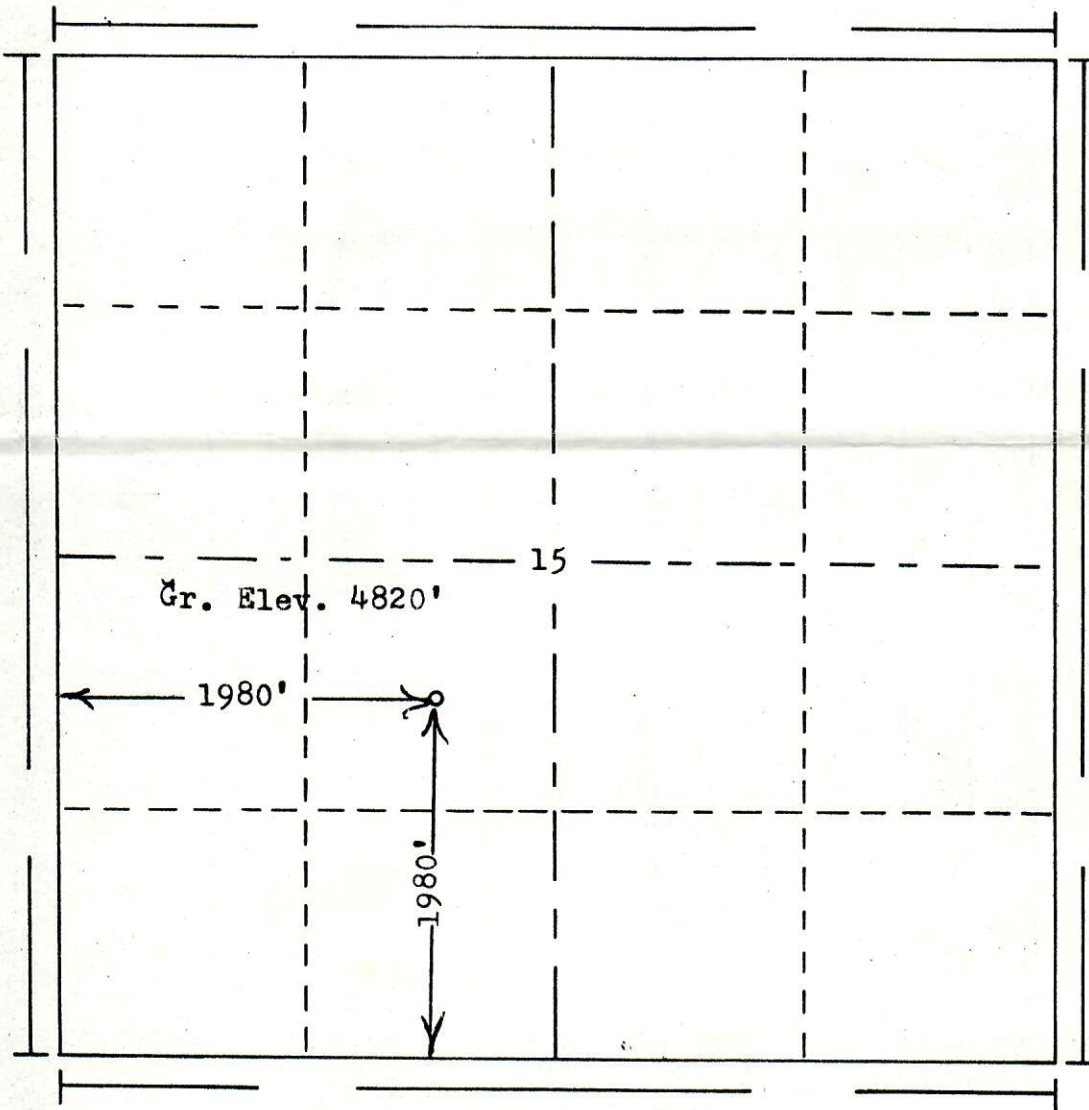

Scale... 1" = 1000'

Powers Elevation of Denver, Colorado  
has in accordance with a request from Mr. Nylund  
for J.W. Nylund  
determined the location of No.1 Hass  
to be CNE SW Section 15 Township 3S  
Range 55W of the 6th Principal Meridian  
Washington County, Colorado

I hereby certify that this plat is an  
accurate representation of a correct  
survey showing the location of

Date: 9-11-81

Ray J. Harty  
Licensed Land Surveyor No. 2853  
State of Colorado

RECEIVED

SEP 17 1981

32



10/27/83

Plugging description  
not complete -  
Called for revised rept.

H.

Hold for rept nhl

32