



00400508

RECEIVED

NOV 6 1968

COLO. OIL & GAS CONS. COMM.

R.55 W

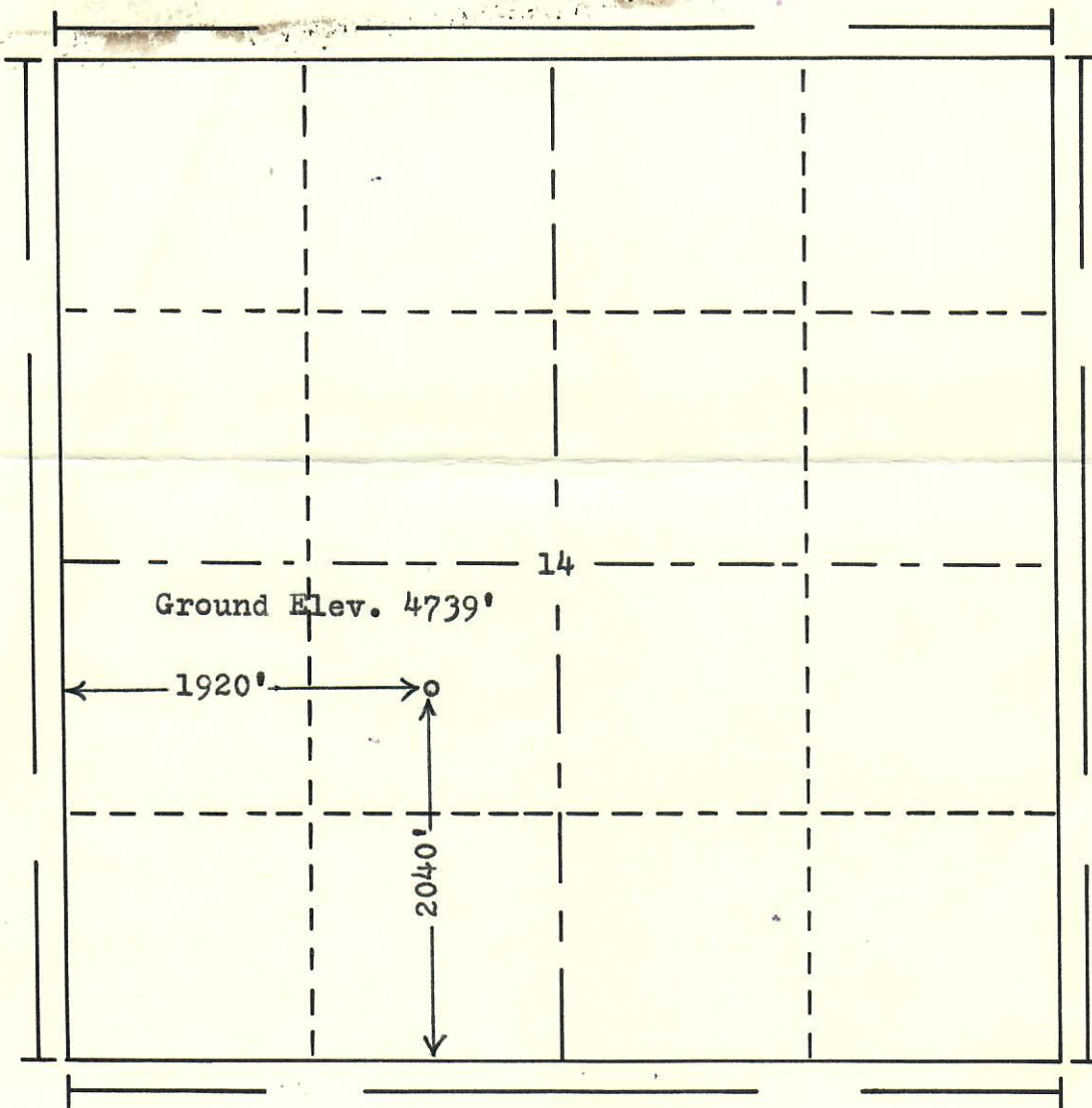
T.
3
S

Scale... 1" = 1000'

Powers Elevation Company, Inc. of Denver, Colorado
has in accordance with a request from Mr. Brown
for Curran & Co.

determined the location of No.23-14 Hass
to be 1920'FW & 2040'FS Section 14 Township 3 South
Range 55 West of the 6th Principal Meridian
Washington County, Colorado

I hereby certify that this plat is an
accurate representation of a correct
survey showing the location of

Date: 11-2-68

Billy S. Holloway
Licensed Land Surveyor No.2853
State of Colorado

