

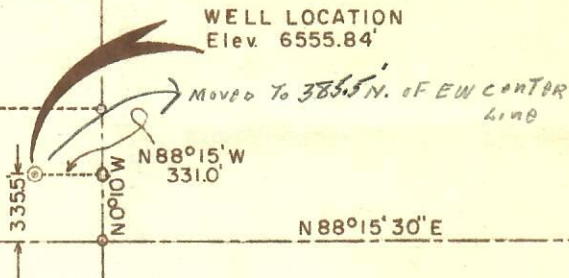

00197581

R. 87 W. R. 86 W.

Sec. 12 Sec. 7
Sec. 13 Sec. 18N88°12'E
5256.2'Sec. 7 Sec. 8
Sec. 18 Sec. 17NORTH
5360.5'

T. 6 N.

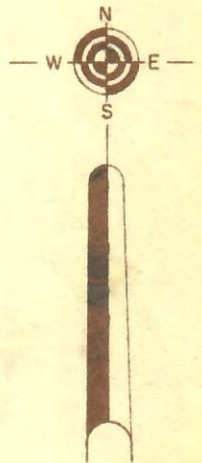
Sec. 13 Sec. 18
Sec. 24 Sec. 19Sec. 18 Sec. 17
Sec. 19 Sec. 20

NOTE: Elevations run from Texas Company Quaintance
Hocking Lease Well No. 10 offset stake (elev. 6508)

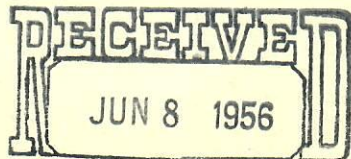
5360
335
1025

CONSULTING COMMISSION

I, Richard J. Mandeville, do hereby certify that this
plat was plotted from notes of a true and accurate survey
made under my supervision.

Richard J. Mandeville
Registered Engineer & Land Surveyor

Coburn Expl. Corp.
State - 2
Tow Creek

SCALE 1"=1000'

WESTERN ENGINEERS
WELL LOCATION

Center SE 1/4 SE 1/4 NW 1/4 Sec. 18
T. 6 N., R. 86 W. 6th Principal Meridian
Routt County, Colorado

SURVEYED *C.B. 5/27/56* DRAWN *L.B.P.*

GRAND JUNCTION, COLORADO

MAY 28, 1956