



FORM F-106



00238417

RECEIVED

OCT 9 1973

COLO. OIL & GAS CONS. COMM.

R. 53W

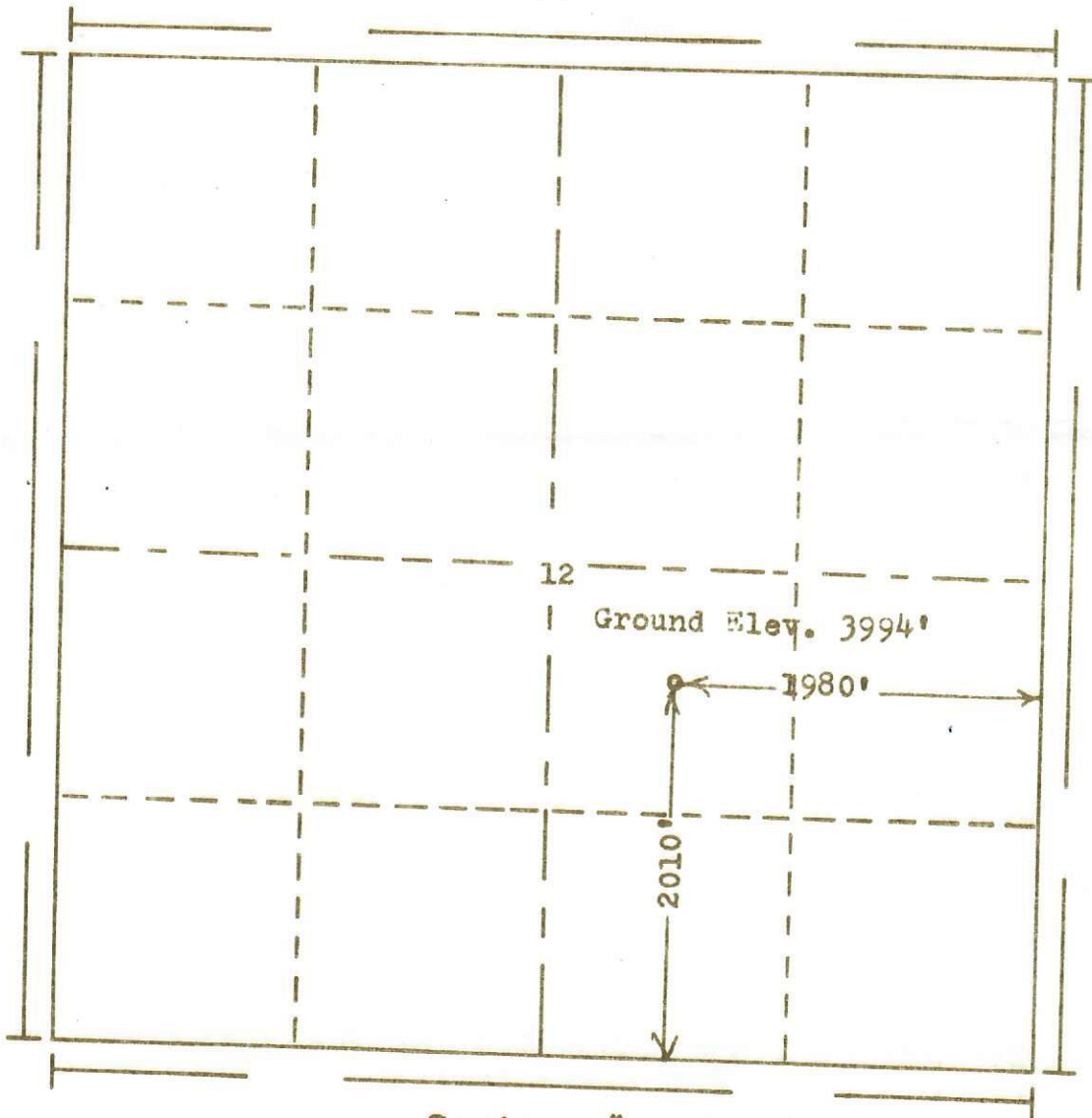
T.
9
N2010
1980
30

Scale... 1" = 1000'

Powers Elevation Company, Inc. of Denver, Colorado
has in accordance with a request from Mr. Gear
for W.W. Ferris et al

determined the location of No.1 Parks
to be CNW SE Section 12 Township 9N
Range 53W of the 6th Principal Meridian
Logan County, Colorado

I hereby certify that this plat is an
accurate representation of a correct
survey showing the location of

Date: 9-20-73

Brian H. Hallen
Licensed Land Surveyor No. 2853
State of Colorado