



00213229

Deakins #1

C-09222

6-7-89  
notes  
Don't know why I didn't  
get this on original notes  
about that  
I'm, your right. Field  
show plug tagged at 4220'.  
Sorry  
& Eubank

RECEIVED  
1989 JUN -7 P 2:41  
BUREAU OF LAND MANAGEMENT  
CRAIG, CO. 81625-1129

ATTENTION:

If any information comes in  
on this well

bring it immediately

before processing to:

PATTI

waiting  
for Brian  
to inspect

NWSESE  
23-6N-80W

---

(print your name)

10-4-81

---

(today's date)



Deakins #1 C-09222 5-19-89 P+A

Pump and packer stuck in hole. Managed to get pump out. Cut tubing at 4600', 100' plug set in the P.M. at 4600' on 5-20-89.

5-21-89 Arrived 8:00 AM to tag plug. Not there - water level dropped approximately 90' so we figured plug was 90' further down than anticipated. Another 100' plug set at approx. 4300.

5-22-89 Tagged plug w/ pressure drop on gauge of approx. 500 pounds. 70 stands of pipe pulled out of the hole. <sup>assume 2 ft per stand</sup>  $70 \times 2 \times 30' = 4200'$  tagged 8B via Rippy on 6-12-89.

5-23-89 Bill Rippy shot casing at approximately 2880. Couldn't pull his casing. Spotted 35 sacks of cement at 2880.

5-25-89 Bill Rippy said approx. 2000' of casing pulled from hole on 5-24-89.



January 15-1958  
2466 South Humboldt St.  
Denver 10. Colo.

Oil & Gas Conservation Comm.,  
116 2 1/2 Elati St., Denver, Colo.

Gentlemen - We have oil  
rights to some land in North-  
Western Colorado, now leased to  
Malco Ref. Inc.

We want to know if according  
to the spacing order we should  
get benefit from the <sup>oil</sup> well brought  
in last summer on land de-  
scribed as follows: NW, SE, SE,  
Section 23 T6 N. R 90 W of 6 P. M.

The well is Federal #1 on Lot 16.  
It is very close to our holdings  
the lot numbers of which are  
1, 2, 3, 6, 7 Sec. 23.

We are enclosing a drawing.

Mrs. Arthur D. Davis



UNITED STATES  
DEPARTMENT OF THE INTERIOR  
BUREAU OF LAND MANAGEMENT

SUBMIT IN TR. (CATE)  
(Other instructions on re-  
verse side)

Form approved.  
Budget Bureau No. 1004-0135  
Expires August 31, 1985

SUNDRY NOTICES AND REPORTS ON WELLS

(Do not use this form for proposals to drill or to deepen or plug back to a different reservoir.  
1989 MAY 16 12 04

1. OIL WELL <input checked="" type="checkbox"/> GAS WELL <input type="checkbox"/>	2. NAME OF OPERATOR CRAIG CO. 81625 1129	3. ADDRESS OF OPERATOR 5005 Tule Lake Dr. Littleton, CO 80123	4. LOCATION OF WELL (Report location clearly and in accordance with any State requirements.* See also space 17 below.) At surface NWSESE Sec 23- 6N- 90W Moffat, CO	5. LEASE DESIGNATION AND SERIAL NO. C-09222	6. IF INDIAN, ALLOTTEE OR TRIBE NAME	7. UNIT AGREEMENT NAME	8. FARM OR LEASE NAME Federal Deakins	9. WELL NO. #1	10. FIELD AND POOL, OR WILDCAT Buck Peak	11. SEC., T., R., M., OR BLK. AND SURVEY OR AREA Sec 23-6N-90W	12. COUNTY OR PARISH Moffat	13. STATE CO
14. PERMIT NO.	15. ELEVATIONS (Show whether DF, RT, GR, etc.)											

Check Appropriate Box To Indicate Nature of Notice, Report, or Other Data

NOTICE OF INTENTION TO:

TEST WATER SHUT-OFF

FRACTURE TREAT

SHOOT OR ACIDIZE

REPAIR WELL

(Other)

PULL OR ALTER CASING

MULTIPLE COMPLETE

ABANDON\*

CHANGE PLANS

SUBSEQUENT REPORT OF:

WATER SHUT-OFF

FRACTURE TREATMENT

SHOOTING OR ACIDIZING

(Other)

REPAIRING WELL

ALTERING CASING

ABANDONMENT\*

(NOTE: Report results of multiple completion on Well Completion or Recombination Report and Log form.)

17. DESCRIBE PROPOSED OR COMPLETED OPERATIONS (Clearly state all pertinent details, and give pertinent dates, including estimated date of starting any proposed work. If well is directionally drilled, give subsurface locations and measured and true vertical depths for all markers and zones pertinent to this work.)

Packer could be stuck in hole. ( 5226'?)

Pump & a few rods also stuck?

1. POH w/ packer & tubing.

2. RIH w/ tubing & spot 100' plug 50' in & 50' out of liner top. 6325' to 6225'. Tag this plug to ensure placement & integrity.

3. If packer cannot be pulled. Cut off tubing as deep as possible & spot 100' plug on top of cut off. This plug will be tagged.

4. Cut & pull 7" casing from free point.

5. Spot 100' plug 50' in & 50' out of 7" stub.

6. Spot 100' plug 50' out & 50' in of bottom of surface casing. 191' to 91'

7. Spot 50' plug at surface & weld plate over surface & erect regulation marker.

8. Rehab as required.

8.6# mud will be circulated between plugs.

Type 1 cement will be used.

Will contact Little Snake River Area office 24 hrs prior to commencement of operations & 24 hrs prior to reclamation.

5a. Spot 100' plug (2880'-2980') to isolate/protect Mesaverde coals and fresh water resources.

18. I hereby certify that the foregoing is true and correct

SIGNED William J. Rappaport

TITLE Agent

DATE 5/16/89

(This space for Federal or State office use)

APPROVED BY KENNETH P. SMITH

TITLE Acting District Manager

DATE MAY 16 1989

CONDITIONS OF APPROVAL, IF ANY:

\*See Instructions on Reverse Side

Title 18 U.S.C. Section 1001, makes it a crime for any person knowingly and willfully to make to any department or agency of the United States any false, fictitious or fraudulent statements or representations as to any matter within its jurisdiction.

Do you want to  
accept this as  
CV?  
yes! *Julio*  
B + SP ✓

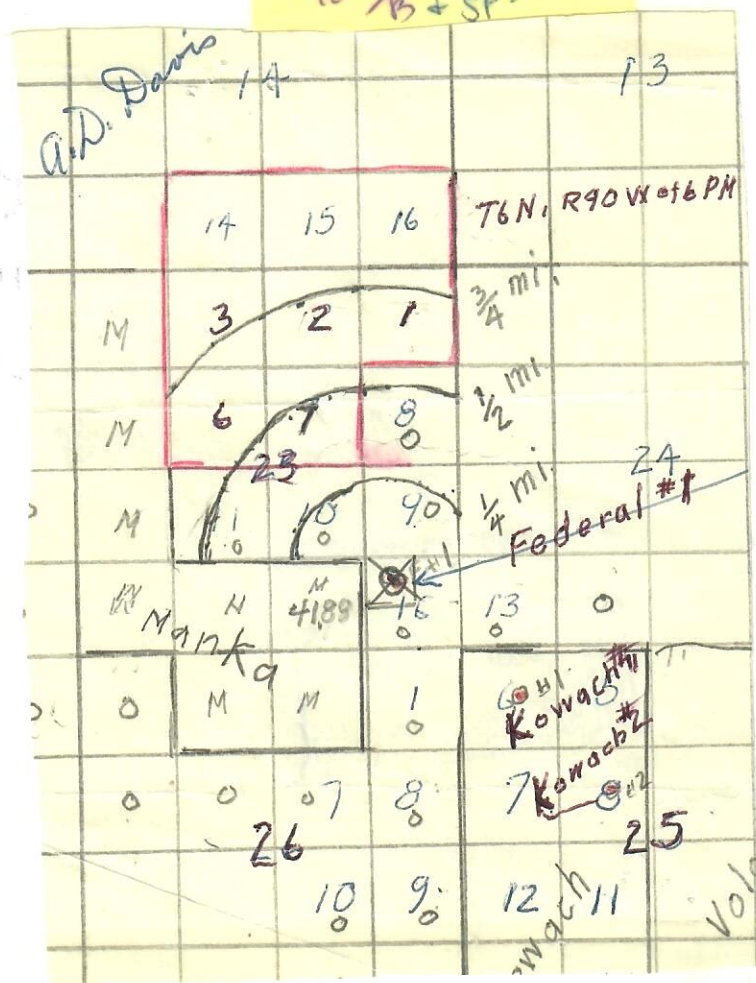



No. 1  
 NW SESE 23-6N-70W  
 C-09222

Spud 6/57

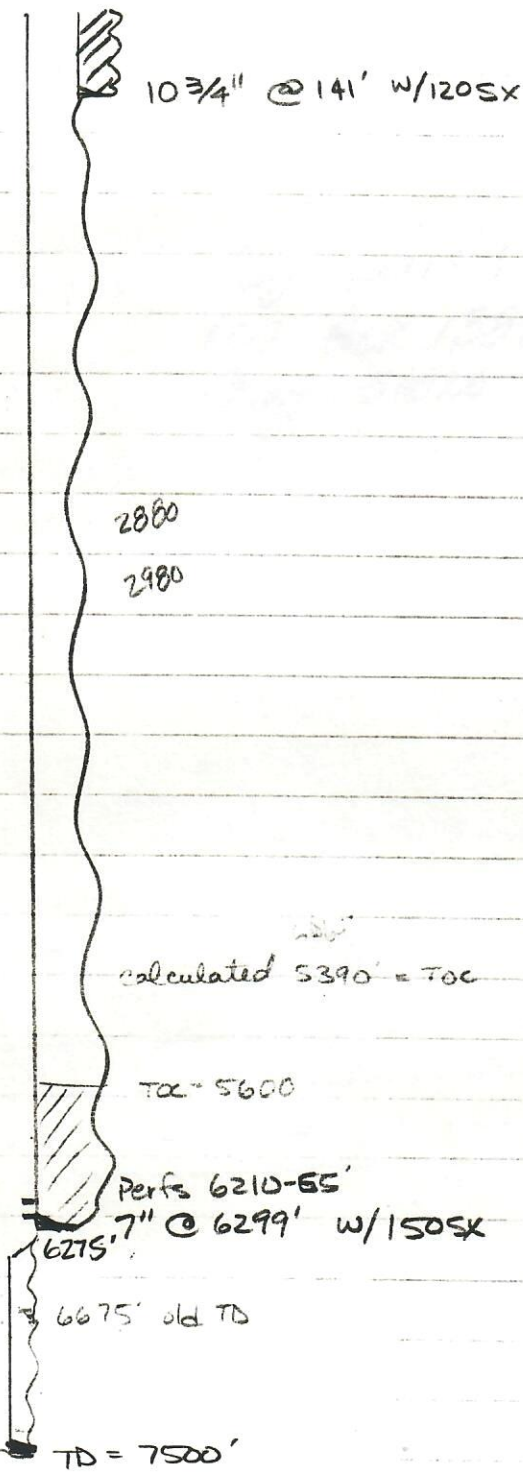
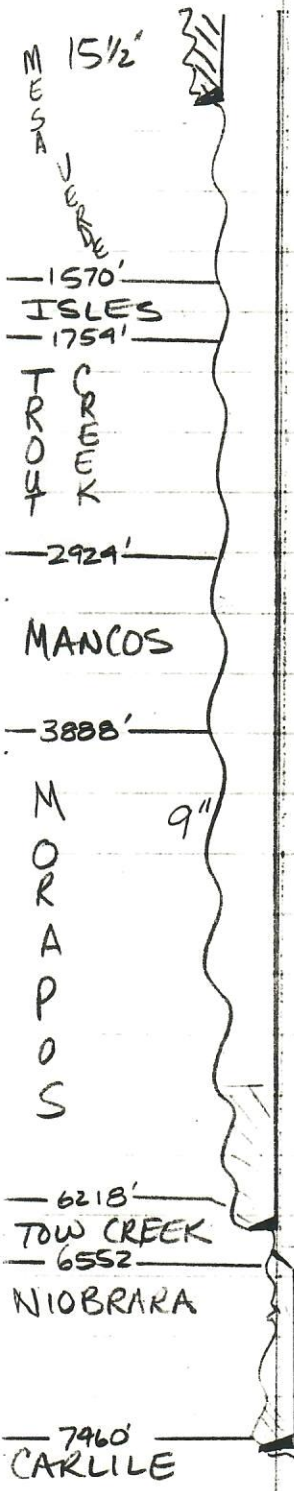

Hole in 7" above 5226' (packer)

Csg.

7" 20-26 1/2 ft

# IMPORTANT MESSAGE

FOR John  
DATE 6/26 TIME 11:01 A.M.  
M Roger Gerard P.M.  
OF \_\_\_\_\_  
PHONE 824-3231  
AREA CODE NUMBER EXTENSION

TELEPHONED		PLEASE CALL	<input checked="" type="checkbox"/>
CAME TO SEE YOU		WILL CALL AGAIN	
WANTS TO SEE YOU		RUSH	
RETURNED YOUR CALL		SPECIAL ATTENTION	

MESSAGE Led lease #1

NWSESE Sec 236N  
cat moffat county 906  
Letter Katy sent

SIGNED \_\_\_\_\_  
LITHO IN U.S.A.



GEOLOGIC EVALUATION  
FOR  
PLUG AND ABANDONMENTS

OPERATOR : ARCO  
WELL NO. : #1  
LOCATION : NWSESE S. 23 T. 6N. R 90W.  
LEASE NO. : C-09222

FORMATION AND/OR MEMBER	LOG DEPTH (IN FEET)	SUBSURFACE MINERAL RESOURCES	LOG INTERVAL (IN FEET)
Williams Fork (MV)	0'	coal / water	0' - 1570'
Isles Fm. (MV)	1570'	coal / water	1570' - 2928'
Mancos Sh	2928'		
Morapas Mbr.	3888'		
Tow Creek Mmb	6218	oil and gas	} 6210' - 6675'
Niobrara	6552	oil and gas	
Carlisle Sh	7460		

SUMMARY OF SUBSURFACE CONCERNS AND MINERAL RESOURCE PROTECTION:

Place a plug at 2928' in order to ensure protection of any fresh water and coal zones within the Mesaverde rocks (MV).

SIGNATURE: Frederick W. Combs DATE: 5/15/89

ROGER I. GERRARD  
B.Sc., M.B.A., J.D.

Attorney-at-Law  
11 West Victory Way, Ste. 8  
P. O. Box 1382  
Craig, Colorado 81626  
(303) 824-3231

February 21, 1990

Colorado Oil and Gas Commission  
1580 Logan Street, Ste. 380  
Denver, CO 80202

Re: Federal Deakins #1  
NWSESE Sec. 23-6N-90W  
Moffat County, Colorado

USA #1-22  
SENE 1990° FNL & 690 FEL Sec 22-6N-90W  
Moffat County, Colorado

Dear Sir/Madam:

Enclosed you will find the Plugging Report and Abandonment of these two wells as filed with the Bureau of Land Management. Complete reclamation of the surface is awaiting approval of the surface owner.

If there are any further questions please contact me at your earliest convenience.

Thank you.

Very truly yours,

  
Roger I. Gerrard

:rnw  
encl

**RECEIVED**

FEB 26 1990

COLO.OIL & GAS CONS.COMM.