



RECEIVED

MAR 11 1969

COLO. OIL &amp; GAS CONS. COMM.

R. 48W

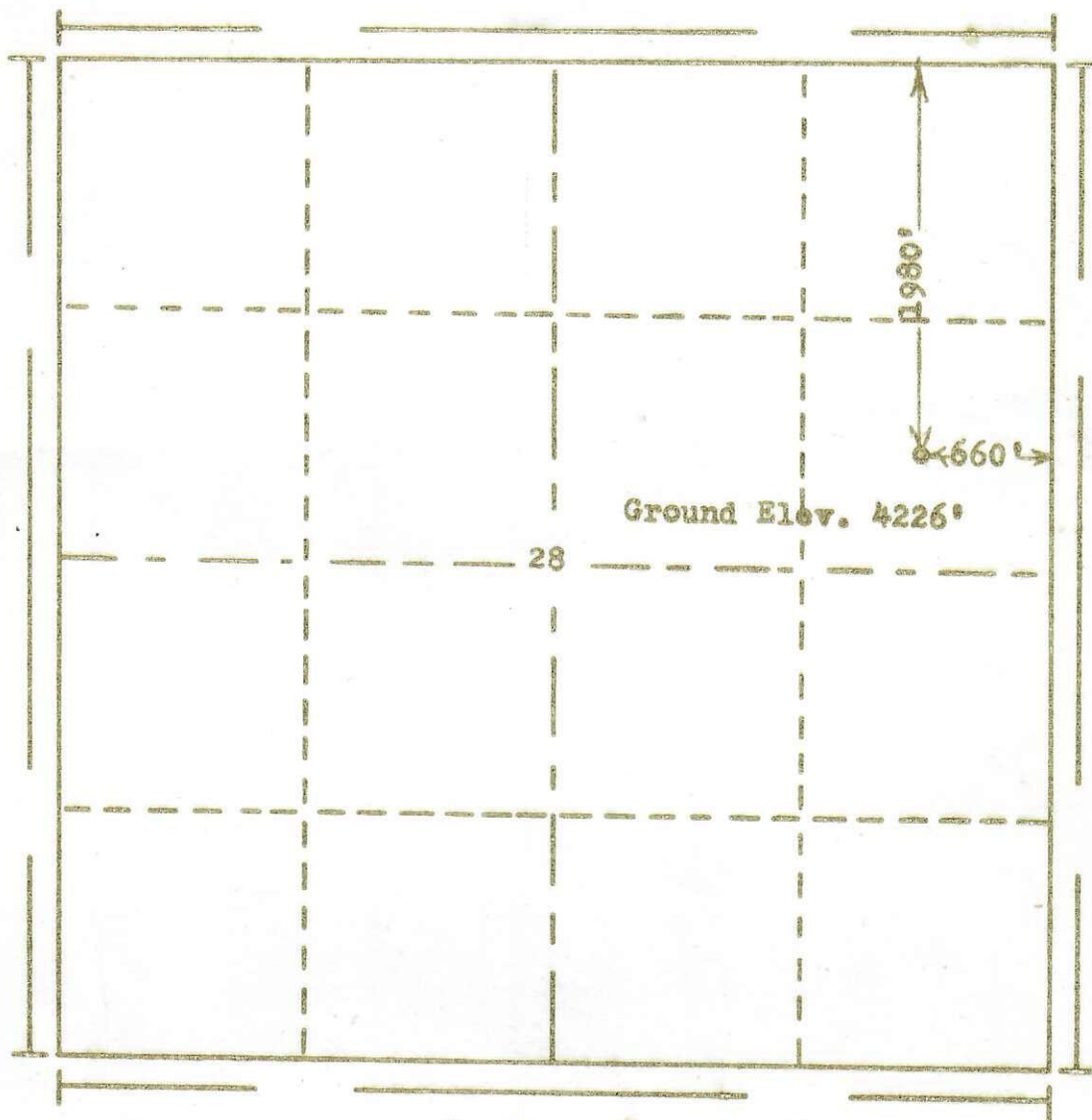

Scale... 1" = 1000'

Powers Elevation Company, Inc. of Denver, Colorado  
has in accordance with a request from Mr. Dew  
for Trend Exploration Ltd.

determined the location of No. 1 I. Kleiboecker  
to be CSE NE Section 28 Township 16S  
Range 48W of the 6th Principal Meridian  
Cheyenne County, Colorado

I hereby certify that this plat is an  
accurate representation of a correct  
survey showing the location of

Date: 2-18-69

Brian D. Hallen  
Licensed Land Surveyor No. 2853  
State of Colorado