

82-1592 RC



Fd 1½" pipe
5.7' up.

R 59 W

Fd 6½" pipe
3' up

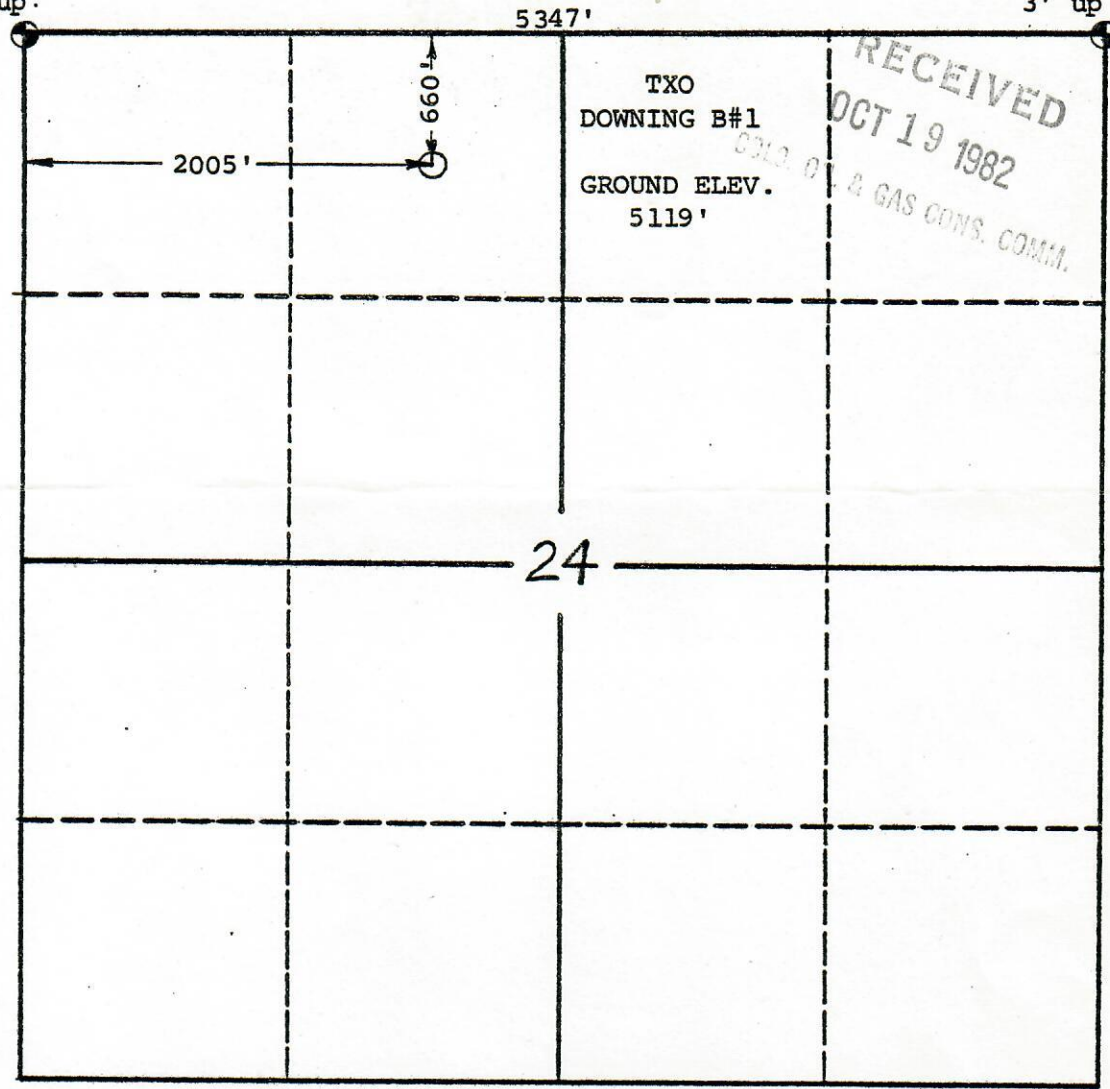

SCALE: 1" = 1000'

Flatirons Surveying has in accordance with a request from TXO Production determined the location of Downing B#1 to be 660' more or less FNL, 2005' more or less FWL of Section 24, T3S, R59W, Sixth Principal Meridian, Adams County, Colorado, located as shown above. The ground elevation is based on USGS elevations at the NE and NW corners of Section 24, from USGS Poison Springs, Colo., 7½' Quadrangle map, 1973.

September 29, 1982



FLATIRONS SURVEYING

855 Broadway
Boulder, Colorado 80302