

UNITED STATES  
DEPARTMENT OF THE INTERIOR  
BUREAU OF LAND MANAGEMENT  
**ENVIRONMENTAL SURFACE (ES) INSPECTION FORM**

**Inspection Header**

<b>Inspection Target</b>	<input type="checkbox"/>	Support Facility(s)								
		Name		Number		Type		Status		
	<input type="checkbox"/>	Production Facility(s)								
		Name / Number				Status				
	<input checked="" type="checkbox"/>	Well(s)								
		Well Name		Well Number		US Well Number		Lease		Well Status
	Federal		26-2		0507708535		COC14172		ABD	
Inspection Target Details										
Operator Caerus Piceance LLC			Case		Latitude -108.186		Longitude 39.240		Priority High	
Aliquot SESW	Lot	Tract	Section 26	Township 9S	Range 97W	Meridian 6th	County Mesa	State CO		

**Inspection Details**

New <input checked="" type="checkbox"/> Follow-up <input type="checkbox"/>				Partial Inspection - Yes <input type="checkbox"/> No <input checked="" type="checkbox"/>			
Open Date: 10/14/2022		Inspection Date: 10/17/2022		Close Date: 10/20/2022		AFMSS Date: 10/20/2022	
Activity	Inspector	Contractor	Open	Close	Office	Travel	Inspection
SA	Toews		10/17/2022	10/17/2022	6	1	1
SA	Freitag		10/17/2022	10/17/2022	1	1	1

**Inspection Footer**

Operations are in Conformance with Permit Requirements: YES <input checked="" type="checkbox"/> NO <input type="checkbox"/> (REQUIRED FOR ALL INSPECTIONS)			
Follow-up Requirements: (select all that apply)		<input checked="" type="checkbox"/> NONE	<input type="checkbox"/> VERBAL
		<input type="checkbox"/> ORDER	<input type="checkbox"/> INC
General Remarks: Visited the site with BLM staff including Lindsey Freitag, BLM Ecologist in response to FAN sundry submitted by Caerus. Access to site is along BLM Big Park Allotment Road south of De Beque, CO through unlocked gate. Road is reclaimed from where the allotment access road makes a left turn. The first section of the pad access road will remain open for permitted allotment and BLM access. The reclaimed section of road is blocked with large rocks to prevent any access. Pit record is closed on the COGCC website. Desirable vegetation (grasses, shrubs, and forbs) is established. C-listed halogeton and field bindweed were noted. The site blends well with surrounding landscape, and the site sign has been removed. The reclaim is dominated by 4-wing saltbush and has greater diversity than the reference area which is dominated by Wyoming big basin sagebrush. 2014 and 2019 seed tags were requested and are attached. A reference transect was not completed on the road but given the short road segment and its vegetation similarity to the pad, it is deemed satisfactory. Overall the data shows that the site meets 80% of reference criteria and is acceptable for approving the FAN.			
FAN Approval Recommendation: (select only one)		<input checked="" type="checkbox"/> APPROVE	<input type="checkbox"/> DENY
		<input type="checkbox"/> NA	
Follow-up Remarks: Vegetation transect monitoring completed by WestWater in July 2022 demonstrated that the site meets BLM reclamation standards and the BLM concurs that the site has acceptably achieved final reclamation. Notified Lynae Rogers, GJFO Range CON on 10/18/2022 that the gate did not have a lock.			
Next ES Date:			

SURFACE INSPECTION FORM (Continued)

SC / SD / SP Checklist		Key: Met ( / ) Not Met ( X ) Not Applicable ( O ) Uninspected (Blank)	
<b>Location (Pad)</b>		<b>Equipment (Drilling and/or Production)</b>	
<b>L1.</b> Location properly signed: (43 CFR 3162.6) Well Number, Survey Location, Operator, Serial Number		<b>E1.</b> Paint/Screening Blends with the Background	
		<b>E2.</b> Hazardous Material Labeled and Maintained	
<b>L2.</b> Topsoil/Spoils: Segregation, Placement, Volumes, and Signing		<b>E3.</b> Secondary Containment: Maintained and Adequate Capacity	
<b>L3.</b> Noxious Weed and Vegetation Control		<b>E4.</b> Drip Pans	
<b>L4.</b> General Housekeeping		<b>E5.</b> Erosion and Stormwater Control	
<b>L5.</b> Erosion and Stormwater Control		<b>E6.</b> Emissions Control	
<b>L6.</b> Free of Spills or Leaks		<b>E7.</b> Exhaust Stacks: Constructed to Prevent Bird/Bat Mortality	
<b>L7.</b> Dust Abatement		<b>E8.</b> Flow Back Containment	
<b>L8.</b> Other:		<b>E9.</b> Other:	
<b>Roads</b>		<b>Pits, Ponds, and Tanks</b>	
<b>R1.</b> Culverts, Waterdips, and Other Water Crossings		<b>P1.</b> Pit/Pond – Type(s):	
<b>R2.</b> Drainage and Ditches		<b>P2.</b> Closure	
<b>R3.</b> Noxious Weed Control		<b>P3.</b> Fenced and/or Netted	
<b>R4.</b> Cattleguards		<b>P4.</b> Freeboard – 2 feet or more	
<b>R5.</b> Gates		<b>P5.</b> Erosion and Stormwater Control	
<b>R6.</b> Dust Abatement		<b>P6.</b> Liner Condition / No Visible Leaks or Failures	
<b>R7.</b> Surface Material		<b>P7.</b> Leak Detection	
<b>R8.</b> Maintenance Needs		<b>P8.</b> Free of Oil, Trash, Wildlife, and Livestock	
<b>R9.</b> Other:		<b>P9.</b> Other:	
<b>Utilities</b>		<b>Other</b>	
<b>U1.</b> Pipeline Markers		<b>O1.</b> Natural Watercourses Free of Development-related Debris and Erosion	
<b>U2.</b> Topsoil/Spoils Segregation, Placement, Volumes, and Signing		<b>O2.</b> Construction/Drilling Contractor has a Copy of the Approved APD	
<b>U3.</b> Noxious Weed Control		<b>O3.</b> Other:	
<b>U4.</b> Power Lines and Poles		<b>O4.</b> Other:	
<b>U5.</b> Erosion and Stormwater Control			
<b>U6.</b> Other			

IR Checklist		Key: Met ( / ) Not Met ( X ) Not Applicable ( O ) Uninspected (Blank)	
<b>IR1.</b> Size and Shape		<b>IR2.</b> Noxious Weed Control	
<b>IR3.</b> Recontouring		<b>IR4.</b> Free of Oil or Salt Contaminated Soil	
<b>IR5.</b> Surface Roughness/Soil Preparation		<b>IR6.</b> Erosion and Stormwater Control	
<b>IR7.</b> Topsoil		<b>IR8.</b> Reclamation Fence	
<b>IR9.</b> Mulch/Amendments		<b>IR10.</b> Rat and Mouse Holes Closed	
<b>IR11.</b> Seeding		<b>IR12.</b> Pit Closure/Remediation	
<b>IR13.</b> Revegetation Success		<b>IR14.</b> Well Cellar Excludes Wildlife & Livestock	
<b>IR15.</b> Successful IR		<b>IR16.</b> Other:	
<b>IR17.</b> Original Disturbance Acres:		<b>IR18.</b> Interim Reclaimed Acres:	

SA Checklist		Key: Met ( / ) Not Met ( X ) Not Applicable ( O ) Uninspected (Blank)	
<b>A1.</b> Topsoil/Spoils Surface <input type="checkbox"/> Subsurface <input type="checkbox"/> Waived <input type="checkbox"/>	0	<b>A2.</b> All Equipment Removed for Final Reclamation (Examples: pipes, signs, fences, culverts, and trash)	/
<b>A3.</b> Recontouring	/	<b>A4.</b> Noxious Weed Control	/
<b>A5.</b> Surface Roughness/Seedbed Preparation	/	<b>A6.</b> Erosion and Stormwater Control	/
<b>A7.</b> Topsoil Redistributed	0	<b>A8.</b> Reclamation Fence	0
<b>A9.</b> Mulch/Amendments	/	<b>A10.</b> Pit Closure/Remediation	/
<b>A11.</b> Seeding	/	<b>A12.</b> Free of Oil or Salt Contaminated Soil	/
<b>A13.</b> Revegetation Success	/	<b>A14.</b> Split Estate - Surface Owner Consultation/Concurrence	0
<b>A15.</b> Other:		<b>A16.</b> Other:	



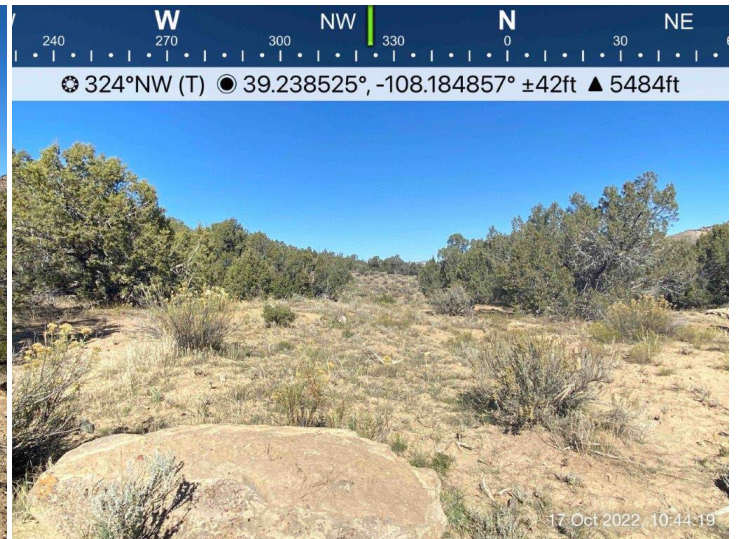

(left) View of gate on road section that is admin use. (right) View of start of road reclaim.

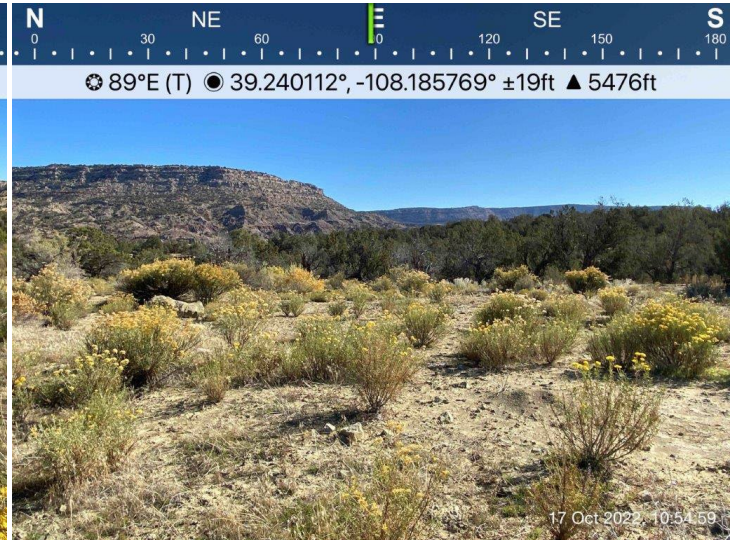
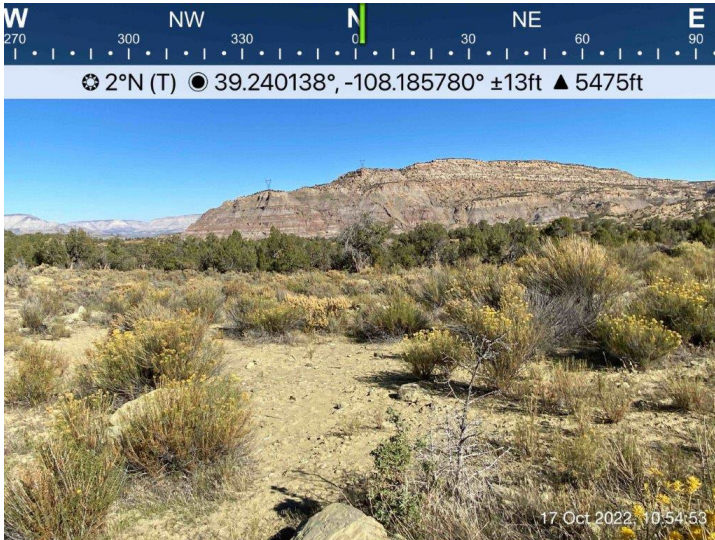

(left) View of reclaimed area. (right) View of reclaimed area.

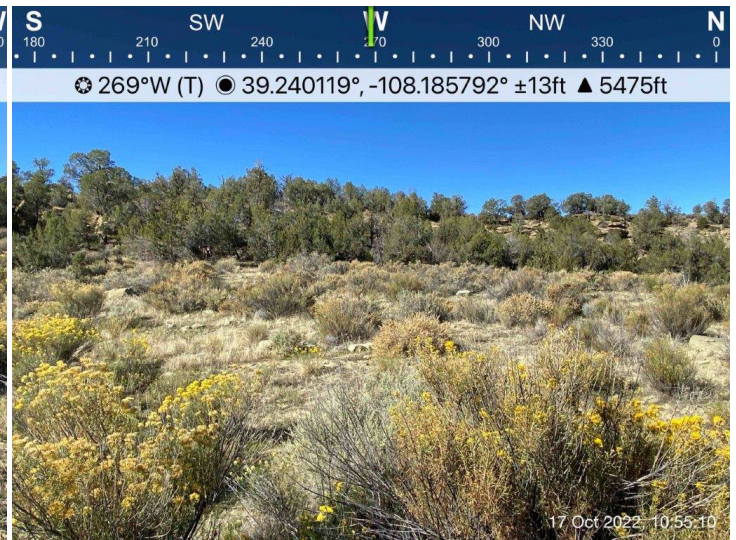

(left) View of reclaimed area. (right) View of reclaimed area.



From: Granite Seed - Lehi  
1697 W 2100 N  
Lehi, UT 84043

Mix Name: Shire Gulch 26-2 PJW w/Forbs and Shrubs 1-28322  
Mix # 148674 Shire Gulch 26-2 PJW w/Forbs and Shrubs Br

% Pure Common Name	Variety	G + D or H	Origin
16.81 SLENDER WHEATGRASS	San Luis	95 + 0 = 95	WY
15.69 THICKSPIKE WHEATGRASS	Critana	96 -TZ	WA
12.97 INDIAN RICEGRASS	Rimrock	95	UT
11.06 WINTERPAT	VNS	99 -TZ	WA
9.71 WESTERN WHEATGRASS	Rosana	89 + 5 = 94	WA
5.07 SALTBUUSH, FOURMING	VNS	90 -TZ	NM
4.85 HAIRY GOLDASTER	VNS	47 -TZ	CO
4.70 JAMES' GALLETA	VNS	97 + 0 = 97	TX
2.38 BEE PLANT, ROCKY MOUNTAIN	VNS	96 -TZ	CO
1.54 NEEDLE & THREAD GRASS	VNS	89 -TZ	WY
1.44 BLUEGRASS, SANDBERG	UP/Colorado Plateau	95 -TZ	WA
0.95 BROOM SNAKEWEED	VNS	96 -TZ	WA
0.48 SAND DROPSEED	VNS	96 -TZ	CO

0.10 Other Crop Date Tested 12-FEB-14

11.37 Inert Matter % Hard Seed 0.00

0.36 Weed Seed Noxious Weed None

Net Weight 35.60 Lbs PLS 43.83 Lbs Bulk

Coverage: 1 Acre

#### NOTICE TO BUYER LIMITATIONS OF WARRANTIES AND REMEDIES

Crop yield and quality are dependent upon many factors beyond the control of the labeled seller and NO WARRANTY is made for crop yield and quality. The labeled seller warrants that all seed sold has been labeled as required under applicable state and federal seed law and that the seed conforms to the label description, within recognized tolerances. THIS WARRANTY IS IN LIEU OF ALL OTHER WARRANTIES, EXPRESS OR IMPLIED, INCLUDING WARRANTIES OF MERCHANTABILITY AND FITNESS FOR A PARTICULAR PURPOSE. THERE ARE NO WARRANTIES WHICH EXTEND BEYOND THE DESCRIPTION ON THE LABEL.

No claim shall be asserted against the labeled seller unless Buyer reports to the labeled seller within a reasonable period after discovery (not to exceed thirty days), any condition that might lead to a complaint. BUYER'S EXCLUSIVE REMEDY FOR ANY CLAIM OR LOSS RESULTING FROM BREACH OF WARRANTY, BREACH OF CONTRACT OR NEGLIGENCE (INCLUDING BUT NOT LIMITED TO INCIDENTAL OR CONSEQUENTIAL DAMAGES) SHALL BE LIMITED TO REPAYMENT OF THE PURCHASE PRICE.

By acceptance of the seed, Buyer agrees the terms and conditions stated above are a benefit to the bargain and constitute the entire agreement between Buyer and the labeled seller. Buyer shall return the original unopened seed package to the labeled seller within twenty days of receipt for a refund of the purchase price if not accepted under these terms.

#### NOTICE: REQUIRED ARBITRATION / CONCILIATION / MEDIATION

The seed laws of several states including Arkansas, California, Colorado, Florida, Georgia, Idaho, Illinois, Indiana, Minnesota, Mississippi, Montana, North Dakota, South Carolina (Section 46-21-260), South Dakota, Texas and Washington require arbitration, conciliation or mediation of disputes involving alleged defective seed before certain legal actions may be maintained against a seller. North Carolina offers an alternative to court action that allows claims to be investigated and heard before the Special Seed Board. A complaint (except for AR, CO, FL, IL, IN, MN, MS, MT, NC, SC, TX, WA, signed only, CA, GA, ID, ND, SD) must be filed with the Department of Agriculture or Seed Commissioner (IN) or State Plant Board (AR) or Commissioner of Agriculture (NC) within such time to permit an inspection of seed, crops or plants by an Arbitration Committee - AR, ID, MS, SC. In NC, failure to follow this procedure will limit the amount of damages recoverable. Certified copy of complaint must be sent by registered mail to the labeled seller as provided in individual state law. Information about these requirements may be obtained from the state Department of Agriculture.

Ship To  
Triton Environmental  
3017 Hwy 50  
Grand Junction, CO 81503

From: Granite Seed - Lehi  
1697 W 2100 N  
Lehi, UT 84043

Mix Name: Shire Gulch 26-2 PJW w/Forbs and Shrubs 1-28322  
Mix # 148674 Shire Gulch 26-2 PJW w/Forbs and Shrubs Br

% Pure Common Name	Variety	G + D or H	Origin
16.81 SLENDER WHEATGRASS	San Luis	95 + 0 = 95	WY
15.69 THICKSPIKE WHEATGRASS	Critana	96 -TZ	WA
12.97 INDIAN RICEGRASS	Rimrock	95	UT
11.06 WINTERPAT	VNS	99 -TZ	WA
9.71 WESTERN WHEATGRASS	Rosana	89 + 5 = 94	WA
5.07 SALTBUUSH, FOURMING	VNS	90 -TZ	NM
4.85 HAIRY GOLDASTER	VNS	47 -TZ	CO
4.70 JAMES' GALLETA	VNS	97 + 0 = 97	TX
2.38 BEE PLANT, ROCKY MOUNTAIN	VNS	96 -TZ	CO
1.54 NEEDLE & THREAD GRASS	VNS	89 -TZ	WY
1.44 BLUEGRASS, SANDBERG	UP/Colorado Plateau	95 -TZ	WA
0.95 BROOM SNAKEWEED	VNS	96 -TZ	WA
0.48 SAND DROPSEED	VNS	96 -TZ	CO

0.10 Other Crop Date Tested 12-FEB-14

11.37 Inert Matter % Hard Seed 0.00

0.36 Weed Seed Noxious Weed None

Net Weight 35.60 Lbs PLS 43.83 Lbs Bulk

Coverage: 1 Acre

#### NOTICE TO BUYER LIMITATIONS OF WARRANTIES AND REMEDIES

Crop yield and quality are dependent upon many factors beyond the control of the labeled seller and NO WARRANTY is made for crop yield and quality. The labeled seller warrants that all seed sold has been labeled as required under applicable state and federal seed law and that the seed conforms to the label description, within recognized tolerances. THIS WARRANTY IS IN LIEU OF ALL OTHER WARRANTIES, EXPRESS OR IMPLIED, INCLUDING WARRANTIES OF MERCHANTABILITY AND FITNESS FOR A PARTICULAR PURPOSE. THERE ARE NO WARRANTIES WHICH EXTEND BEYOND THE DESCRIPTION ON THE LABEL.

No claim shall be asserted against the labeled seller unless Buyer reports to the labeled seller within a reasonable period after discovery (not to exceed thirty days), any condition that might lead to a complaint. BUYER'S EXCLUSIVE REMEDY FOR ANY CLAIM OR LOSS RESULTING FROM BREACH OF WARRANTY, BREACH OF CONTRACT OR NEGLIGENCE (INCLUDING BUT NOT LIMITED TO INCIDENTAL OR CONSEQUENTIAL DAMAGES) SHALL BE LIMITED TO REPAYMENT OF THE PURCHASE PRICE.

By acceptance of the seed, Buyer agrees the terms and conditions stated above are a benefit to the bargain and constitute the entire agreement between Buyer and the labeled seller. Buyer shall return the original unopened seed package to the labeled seller within twenty days of receipt for a refund of the purchase price if not accepted under these terms.

#### NOTICE: REQUIRED ARBITRATION / CONCILIATION / MEDIATION

The seed laws of several states including Arkansas, California, Colorado, Florida, Georgia, Idaho, Illinois, Indiana, Minnesota, Mississippi, Montana, North Dakota, South Carolina (Section 46-21-260), South Dakota, Texas and Washington require arbitration, conciliation or mediation of disputes involving alleged defective seed before certain legal actions may be maintained against a seller. North Carolina offers an alternative to court action that allows claims to be investigated and heard before the Special Seed Board. A complaint (except for AR, CO, FL, IL, IN, MN, MS, MT, NC, SC, TX, WA, signed only, CA, GA, ID, ND, SD) must be filed with the Department of Agriculture or Seed Commissioner (IN) or State Plant Board (AR) or Commissioner of Agriculture (NC) within such time to permit an inspection of seed, crops or plants by an Arbitration Committee - AR, ID, MS, SC. In NC, failure to follow this procedure will limit the amount of damages recoverable. Certified copy of complaint must be sent by registered mail to the labeled seller as provided in individual state law. Information about these requirements may be obtained from the state Department of Agriculture.

Ship To  
Triton Environmental  
3017 Hwy 50  
Grand Junction, CO 81503

Mix Name: PJ Woodland w/Forbs and Shrubs Drill 3-1910  
Mix # 147552 PJ Woodland w/Forbs and Shrubs Drill

% Pure Common	Name	variety	G + D or H	Origin
18.98	SLENDER WHEATGRASS	San Luis	95 + 0 = 95	WY
18.89	THICKSKIN WHEATGRASS	Orinda	88 + 2 = 90	WY
14.64	INDIAN RICEGRASS	Brinlock	95 + 12	WA
10.96	WESTERN WHEATGRASS	Pomona	89 + 5 = 94	WA
9.91	SALTBUSH FLOURING	WNS	52 + 12	UT
5.48	HAIRY GOLD-STAR	WNS	47 + 12	CO
5.31	JAMES GALLI ET A	Wva	97 + 0 = 97	TX
2.68	BEE PLANT, ROCKY MOUNTAIN	WNS	96 + 12	CO
1.74	NEEDLE & TI READ GRASS	WNS	99 + 12	WY
1.63	BLUEGRASS, SANDEBERG	UPColorado Plateau	95 + 12	WA
0.53	SAND DROPLEED	WNS	97 + 12	CO

0.00	Other Crop	Date Tested	12-FEB-14
0.00	Inert Matter	% Hard Seed	0.00
0.34	Weed Seed		

Net Weight	15 20	Lbs PLS	1941	Lbs Bulk
------------	-------	---------	------	----------

Coverage: 1 Acre

**NOTICE TO BUYER LIMITATIONS OF WARRANTIES AND REMEDIES**

Crop yield and quality are dependent upon many factors beyond the control of the labeled seller and NO WARRANTY is made for the seed sold and quality. The labeled seller warrants that all seed sold has been labeled as required under applicable state and federal seed laws and that a "seal of purity" is the "gold standard" for seed quality. THIS WARRANTY IS IN FAVOR OF ALL OTHER WARRANTIES EXPRESS OR IMPLIED, INCLUDING WARRANTIES OF MERCHANTABILITY AND FITNESS FOR A PARTICULAR PURPOSE. THERE ARE NO WARRANTIES WHICH EXTEND BEYOND THE DESCRIPTION ON THE LABEL.

No claim shall be asserted against the labeled seller unless Buyer reports to the labeled seller within a reasonable period after receipt (not to exceed thirty days) any condition that might lead to a complaint. BUYER'S EXCLUSIVE REMEDY FOR ANY CLAIM OR LOSS RESULTING FROM BREACH OF WARRANTY, BREACH OF CONTRACT OR NEGLIGENCE (INCLUDING NEGLIGENCE OF UNLITED TOL INCIDENTAL OR CONSEQUENTIAL DAMAGES) SHALL BE LIMITED TO REPAYMENT OF THE PURCHASE PRICE.

Buyer's acceptance of the seed. Buyer agrees the terms and conditions stated above are a benefit to the bargain and constitute the entire agreement between Buyer and the labeled seller. Buyer shall return the original unpopened seed package to the labeled seller within twenty days of receipt for a refund of the purchase price if not accepted under these terms.

## NOTICE: REQUIRED ARBITRATION / CONCILIATION / MEDIATION

[illegible]

Kevin 970-999-1931  
869 Mosher

Job: SG26SW 1.5 ACRE TABLE 3 PJ MIX

Lot #: G-190727

Bag Wt: 35.80#

Bulk #Ac 47.69

Mixture/Variety:

4-Wing Saltbush VNS  
Western Wheatgrass, Arriba  
Indian Ricegrass, Rimrock  
Thickspike Wheatgrass, Critiana  
Slender Wheatgrass, San Luis  
Winter Fat VNS  
Arrowleaf Balsamroot, VNS  
Basin Wildrye, Maguar  
Blanketflower VNS  
Lewis Blue Flax VNS  
Sandberg Bluegrass, Mountain Home  
Sant Drupstand VNS  
Western Yarrow VNS

Seed Total

Inert %  
Weed %  
Crop %

% Mix:

27.25%  
16.41%  
12.76%  
10.81%  
6.85%  
6.85%  
5.41%  
4.41%  
2.43%  
1.96%  
1.32%  
0.44%  
0.09%  
96.91%

Germ:

60.00%  
92.00%  
92.00%  
97.00%  
98.00%  
98.00%  
93.00%  
95.00%  
86.00%  
90.00%  
95.00%  
95.00%  
93.00%

Origin:

NM  
WY  
WA  
WY  
WY  
NM  
UT  
WY  
KS

MAC TRANSFLO  
63264004 SUM

Noxious Weed: None

Tested: 2/2019

Buffalo BRAND SEED

TRITON ENVIRONMENTAL

BUFFALO BRAND SEED

GREELEY, CO 80634

970.356.4710



From: Granite Seed - Lehi  
1697 W 2100 N  
Lehi, UT 84043

Mix Name: Shire Gulch 26-2 PJW w/Forbs and Shrubs 1-28322

Mix # 148674 Shire Gulch 26-2 PJW w/Forbs and Shrubs Br

% Pure	Common Name	Variety	G + D or H	Origin
16.81	SLENDER WHEATGRASS	San Luis	95 + 0 = 95	WY
15.69	THICKSPIKE WHEATGRASS	Critana	96 -TZ	WA
12.97	INDIAN RICEGRASS	Rimrock	95	WA
11.06	WINTERFAT	VNS	99 -TZ	UT
9.71	WESTERN WHEATGRASS	Rosana	89 + 5 = 94	WA
5.07	SALTBUSH, FOURWING	VNS	90 -TZ	NM
4.85	HAIRY GOLDASTER	VNS	47 -TZ	CO
4.70	JAMES' G. ALLETA	VNS	97 + 0 = 97	TX
2.38	BEE PLANT, ROCKY MOUNTAIN	VNS	96 -TZ	CO
1.54	NEEDLE & THREAD GRASS	VNS	89 -TZ	WY
1.44	BLUEGRASS, SANDBERG	UP/Colorado Plateau	95 -TZ	WA
0.95	BROOM SNAKEWEED	VNS	96 -TZ	WA
0.48	SAND DROPSEED	VNS	96 -TZ	CO

0.10 Other Crop Date Tested 12-FEB-14  
11.37 Inert Matter % Hard Seed 0.00  
0.36 Weed Seed Noxious Weed: None

Net Weight 35.60 Lbs PLS 43.83 Lbs Bulk

Coverage: 1 Acre

#### NOTICE TO BUYER LIMITATIONS OF WARRANTIES AND REMEDIES

Crop yield and quality are dependent upon many factors beyond the control of the labeled seller and NO WARRANTY is made for crop yield and quality. The labeled seller warrants that all seed sold has been labeled as required under applicable state and federal seed law and that the seed conforms to the label description, within recognized tolerances. THIS WARRANTY IS IN LIEU OF ALL OTHER WARRANTIES, EXPRESS OR IMPLIED, INCLUDING WARRANTIES OF MERCHANTABILITY AND FITNESS FOR A PARTICULAR PURPOSE. THERE ARE NO WARRANTIES WHICH EXTEND BEYOND THE DESCRIPTION ON THE LABEL.

No claim shall be asserted against the labeled seller unless Buyer reports to the labeled seller within a reasonable period after discovery (not to exceed thirty days) any condition that might lead to a complaint. BUYER'S EXCLUSIVE REMEDY FOR ANY CLAIM OR LOSS RESULTING FROM BREACH OF WARRANTY, BREACH OF CONTRACT OR NEGLIGENCE (INCLUDING BUT NOT LIMITED TO INCIDENTAL OR CONSEQUENTIAL DAMAGES) SHALL BE LIMITED TO REPAYMENT OF THE PURCHASE PRICE.

By acceptance of the seed, Buyer agrees the terms and conditions stated above are a benefit to the bargain and constitute the entire agreement between Buyer and the labeled seller. Buyer shall return the original unopened seed package to the labeled seller within twenty days of receipt for a refund of the purchase price if not accepted under these terms.

#### NOTICE: REQUIRED ARBITRATION / CONCILIATION / MEDIATION

The seed laws of several states including Arkansas, California, Colorado, Florida, Georgia, Idaho, Illinois, Indiana, Minnesota, Mississippi, Montana, North Dakota, South Carolina (Section 46-21-260), South Dakota, Texas and Washington require arbitration, conciliation or mediation of disputes involving alleged defective seed before certain legal actions may be maintained against a seller. North Carolina offers an alternative to court action that allows claims to be investigated and heard before the Special Seed Board. A complaint (sworn for AR, CO, FL, IL, IN, MN, MS, MT, NC, SC, TX, VA, signed only, CA, GA, ID, ND, SD) must be filed with the Department of Agriculture or Seed Commissioner (IN) or State Plant Board (AR) or Commissioner of Agriculture (NC) within such time to permit an inspection of seed, crops or plants (by an Arbitration Committee - AR, ID, MS, SC). In NC, failure to follow this procedure will limit the amount of damages recoverable. Certified copy of complaint must be sent by registered mail to the labeled seller as provided in individual state law. Information about these requirements may be obtained from the state Department of Agriculture.

Ship To  
Triton Environmental  
3017 Hwy 50  
Grand Junction, CO 81503

From: Granite Seed - Lehi  
1697 W 2100 N  
Lehi, UT 84043

2 of 2

Mix Name: Shire Gulch 26-2 PJW w/Forbs and Shrubs 1-28322

Mix # 148674 Shire Gulch 26-2 PJW w/Forbs and Shrubs Br

% Pure	Common Name	Variety	G + D or H	Origin
16.81	SLENDER WHEATGRASS	San Luis	95 + 0 = 95	WY
15.69	THICKSPIKE WHEATGRASS	Critana	96 -TZ	WA
12.97	INDIAN RICEGRASS	Rimrock	95	WA
11.06	WINTERFAT	VNS	99 -TZ	UT
9.71	WESTERN WHEATGRASS	Rosana	89 + 5 = 94	WA
5.07	SALTBUSH, FOURWING	VNS	90 -TZ	NM
4.85	HAIRY GOLDASTER	VNS	47 -TZ	CO
4.70	JAMES' GALLETA	VNS	97 + 0 = 97	TX
2.38	BEE PLANT, ROCKY MOUNTAIN	VNS	96 -TZ	CO
1.54	NEEDLE & THREAD GRASS	VNS	89 -TZ	WY
1.44	BLUEGRASS, SANDBERG	UP/Colorado Plateau	95 -TZ	WA
0.95	BROOM SNAKEWEED	VNS	96 -TZ	WA
0.48	SAND DROPSEED	VNS	96 -TZ	CO

0.10 Other Crop Date Tested 12-FEB-14  
11.37 Inert Matter % Hard Seed 0.00  
0.36 Weed Seed Noxious Weed: None

Net Weight 35.60 Lbs PLS 43.83 Lbs Bulk

Coverage: 1 Acre

#### NOTICE TO BUYER LIMITATIONS OF WARRANTIES AND REMEDIES

Crop yield and quality are dependent upon many factors beyond the control of the labeled seller and NO WARRANTY is made for crop yield and quality. The labeled seller warrants that all seed sold has been labeled as required under applicable state and federal seed law and that the seed conforms to the label description, within recognized tolerances. THIS WARRANTY IS IN LIEU OF ALL OTHER WARRANTIES, EXPRESS OR IMPLIED, INCLUDING WARRANTIES OF MERCHANTABILITY AND FITNESS FOR A PARTICULAR PURPOSE. THERE ARE NO WARRANTIES WHICH EXTEND BEYOND THE DESCRIPTION ON THE LABEL.

No claim shall be asserted against the labeled seller unless Buyer reports to the labeled seller within a reasonable period after discovery (not to exceed thirty days) any condition that might lead to a complaint. BUYER'S EXCLUSIVE REMEDY FOR ANY CLAIM OR LOSS RESULTING FROM BREACH OF WARRANTY, BREACH OF CONTRACT OR NEGLIGENCE (INCLUDING BUT NOT LIMITED TO INCIDENTAL OR CONSEQUENTIAL DAMAGES) SHALL BE LIMITED TO REPAYMENT OF THE PURCHASE PRICE.

By acceptance of the seed, Buyer agrees the terms and conditions stated above are a benefit to the bargain and constitute the entire agreement between Buyer and the labeled seller. Buyer shall return the original unopened seed package to the labeled seller within twenty days of receipt for a refund of the purchase price if not accepted under these terms.

#### NOTICE: REQUIRED ARBITRATION / CONCILIATION / MEDIATION

The seed laws of several states including Arkansas, California, Colorado, Florida, Georgia, Idaho, Illinois, Indiana, Minnesota, Mississippi, Montana, North Dakota, South Carolina (Section 46-21-260), South Dakota, Texas and Washington require arbitration, conciliation or mediation of disputes involving alleged defective seed before certain legal actions may be maintained against a seller. North Carolina offers an alternative to court action that allows claims to be investigated and heard before the Special Seed Board. A complaint (sworn for AR, CO, FL, IL, IN, MN, MS, MT, NC, SC, TX, VA, signed only, CA, GA, ID, ND, SD) must be filed with the Department of Agriculture or Seed Commissioner (IN) or State Plant Board (AR) or Commissioner of Agriculture (NC) within such time to permit an inspection of seed, crops or plants (by an Arbitration Committee - AR, ID, MS, SC). In NC, failure to follow this procedure will limit the amount of damages recoverable. Certified copy of complaint must be sent by registered mail to the labeled seller as provided in individual state law. Information about these requirements may be obtained from the state Department of Agriculture.

Ship To  
Triton Environmental  
3017 Hwy 50  
Grand Junction, CO 81503

From: Granite Seed  
490 East 76th Ave  
Denver, CO 80229

2 of 2

Mix Name: PJ Woodland w/Forbs and Shrubs Drill 3-1910

Mix # 147552 PJ Woodland w/Forbs and Shrubs Drill

% Pure	Common Name	Variety	G + D or H	Origin
18.98	SLENDER WHEATGRASS	San Luis	95 + 0 = 95	WY
18.89	THICKSPIKE WHEATGRASS	Critana	88 + 2 = 90	WY
14.64	INDIAN RICEGRASS	Rimrock	95 -TZ	WA
10.96	WESTERN WHEATGRASS	Rosana	89 + 5 = 94	WA
9.91	SALT BUSH, FOURWING	VNS	52 -TZ	UT
5.48	HAIRY GOLDASTER	VNS	47 -TZ	CO
5.31	JAMES' GALLIETA	Viva	97 + 0 = 97	TX
2.68	BEE PLANT, ROCKY MOUNTAIN	VNS	96 -TZ	CO
1.74	NEEDLE & THREAD GRASS	VNS	89 -TZ	WY
1.63	BLUEGRASS, SANDBERG	UP/Colorado Plateau	95 -TZ	WA
0.53	SAND DROPSEED	VNS	97 -TZ	CO

0.00 Other Crop Date Tested: 12-FEB-14  
8.88 Inert Matter % Hard Seed 0.00  
0.34 Weed Seed Noxious Weed: None

Net Weight 15.20 Lbs PLS 19.41 Lbs Bulk

Coverage: 1 Acre

#### NOTICE TO BUYER LIMITATIONS OF WARRANTIES AND REMEDIES

Crop yield and quality are dependent upon many factors beyond the control of the labeled seller and NO WARRANTY is made for crop yield and quality. The labeled seller warrants that all seed sold has been labeled as required under applicable state and federal seed law and that the seed conforms to the label description, which includes varietal name. THIS WARRANTY IS IN LIEU OF ALL OTHER WARRANTIES, EXPRESS OR IMPLIED, INCLUDING WARRANTIES OF MERCHANTABILITY AND FITNESS FOR A PARTICULAR PURPOSE. THERE ARE NO WARRANTIES WHICH EXTEND BEYOND THE DESCRIPTION ON THE LABEL.

No claim shall be asserted against the labeled seller unless Buyer reports to the labeled seller within a reasonable period after discovery (not to exceed thirty days), any condition that might lead to a complaint. BUYER'S EXCLUSIVE REMEDY FOR ANY CLAIM OR LOSS RESULTING FROM BREACH OF WARRANTY, BREACH OF CONTRACT OR NEGLIGENCE (INCLUDING BUT NOT LIMITED TO INCIDENTAL OR CONSEQUENTIAL DAMAGES) SHALL BE LIMITED TO REPAYMENT OF THE PURCHASE PRICE.

By acceptance of this seed, Buyer agrees the terms and conditions stated above are a benefit to the bargain and constitute the entire agreement between Buyer and the labeled seller. Buyer shall return the original unopened seed package to the labeled seller within twenty days of receipt for a refund of the purchase price if not accepted under these terms.

#### NOTICE: REQUIRED ARBITRATION / CONCILIATION / MEDIATION

The seed laws of several states including Arkansas, California, Colorado, Florida, Georgia, Idaho, Illinois, Indiana, Minnesota, Mississippi, Montana, North Dakota, South Carolina (Section 48-1-280), South Dakota, Texas and Washington require arbitration, conciliation or mediation of disputes involving alleged defective seed before certain legal actions may be maintained against a seller. North Carolina offers an alternative to court action that allows claims to be investigated and heard before the Special Seed Board. A complaint (available for AR, CO, FL, IL, IN, MN, MS, MT, NC, SC, TX, WA, signed only, CA, GA, ID, ND, SD) must be filed with the Department of Agriculture or Seed Commissioner (IN) or State Plant Board (AR) or Commissioner of Agriculture (NC) within sixty days to permit an inspection of seed, crops or plants (by an Arbitration Committee - AR, ID, MS, SC) in the event of a failure to grow. This procedure will limit the amount of damages recoverable. Certified copy of complaint must be sent by registered mail to the labeled seller as provided in individual state law. Information about these requirements may be obtained from the state Department of Agriculture.

Sharon  
Tilden Environmental  
Kevin 970-983-1431  
369 Mosier  
Parachute



Job: SG26SW 1.5 ACRE TABLE 1-3 PJ MIX

Bag Wt: 35.80#

Lot #: G-190727

Bulk #/Ac 47.69

Mixture/Variety:	% Mix:	Germ:	Origin:
4-Wing Saltbush, VNS	27.25%	60.00%	NM
Western Wheatgrass, Arriba	16.41%	92.00%	WY
Indian Ricegrass, Rimrock	12.76%	92.00%	WA
Thickspike Wheatgrass, Critana	10.81%	97.00%	WY
Slender Wheatgrass, San Luis	6.85%	98.00%	WY
Winter Fat, VNS	6.85%	98.00%	NM
Arrowleaf Balsamroot, VNS	5.41%	93.00%	UT
Basin Wildrye, Magnar	4.41%	95.00%	WY
Blanketflower, VNS	2.43%	86.00%	KS
Lewis Blue Flax, VNS	1.86%	90.00%	
Sandberg Bluegrass, Mountain Home	1.32%	95.00%	
Sand Drupseed, VNS	0.44%	95.00%	
Western Yarrow, VNS	0.09%	93.00%	
Seed Total	96.91%		
Inert %	3.05%		
Weed %	0.03%		
Crab %	0.01%		

Noxious Weed: None

Tested: 2/2019

TRITON ENVIRONMENTAL

**Buffalo** BRAND SEED

BUFFALO BRAND SEED

GREELEY, CO 80634

970.356.4710

NO TRANSFER  
63264004 SUM