

POINT	NAD 83	NAD 27
SURFACE HOLE LOCATION	N: 1476229.34	N: 476228.90
	E: 3350297.64	E: 2350446.85
	LAT: N40.6338025	LAT: N40.6338187
	LONG: W104.2378501	LONG: W104.2373458
LANDING POINT LOCATION	N: 1476149.52	N: 476149.02
	E: 3354150.28	E: 2354299.60
	LAT: N40.6334321	LAT: N40.6334481
	LONG: W104.2239748	LONG: W104.2234705
BOTTOM OF PRODUCTION ZONE	N: 1483486.40	N: 483485.76
	E: 3354151.57	E: 2354300.82
	LAT: N40.6535685	LAT: N40.6535845
	LONG: W104.2235896	LONG: W104.2230855
BOTTOM HOLE LOCATION	N: 1483576.41	N: 483575.77
	E: 3354151.59	E: 2354300.83
	LAT: N40.6538156	LAT: N40.6538315
	LONG: W104.2235849	LONG: W104.2230808

LEGEND

SECTION LINE  
QUARTER SECTION LINE  
SIXTEENTH SECTION LINE  
POINT OF INTERSECTION  
MONUMENT FOUND  
CALCULATED CORNER

T

TOPOGRAPHIC

LOYALTY INNOVATION LEGACY

520 STACY COURT, UNIT B • LAFAYETTE, CO 80026  
TELEPHONE: (303) 666-0379 • FAX (303) 665-6320  
WWW.TOPOGRAPHIC.COM

SURVEYOR'S STATEMENT  
THE UNDERSIGNED HEREBY STATES THAT THE WELL LOCATION SHOWN HEREON WAS STAKED ON THE GROUND BASED ON EXISTING MONUMENTATION AND/OR PHYSICAL EVIDENCE FOUND IN THE FIELD AND IS CORRECT TO THE BEST OF MY KNOWLEDGE, INFORMATION AND BELIEF.

- NOTES
- HORIZONTAL (NAD 83) AND VERTICAL (NAVD 88) DATUM IS BASED ON THE TRIMBLE VRS NETWORK. THE LINEAL UNITS OF MEASUREMENT ARE U.S. SURVEY FEET.
  - ALL DIRECTIONS, DISTANCES, AND DIMENSIONS SHOWN HEREON ARE BASED ON COORDINATES FROM THE "COLORADO COORDINATE SYSTEM OF 1983 NORTH ZONE" (TITLE 38, ARTICLE 52 C.R.S.).
  - ALL SECTION LINE DIMENSIONS SHOWN HEREON ARE BASED ON FIELD MEASUREMENTS OF EXISTING MONUMENTS AND/OR PHYSICAL EVIDENCE FOUND IN THE FIELD UNLESS OTHERWISE INDICATED.
  - PHYSICAL FEATURES SHOWN HEREON ARE FOR GRAPHICAL REPRESENTATION ONLY.
  - SEE FORM 2A FOR VISIBLE IMPROVEMENTS WITHIN 500' OF WELLHEAD.
  - DISTANCES TO NEAREST SECTION LINES ARE MEASURED PERPENDICULARLY.
  - THIS IS NOT A LAND SURVEY NOR LAND SURVEY PLAT.
- PDOP READING: 1.3 INSTRUMENT OPERATOR: Joe Phillips

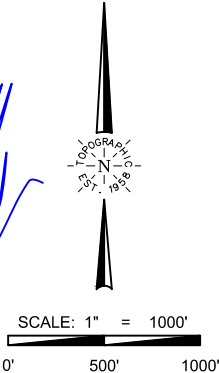
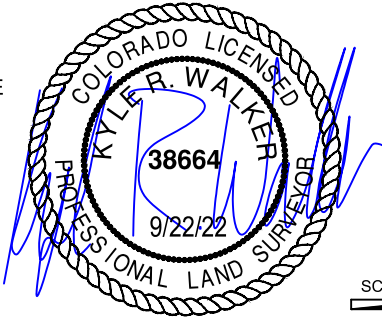

VERDAD RESOURCES GAFFNEY 2920-07H			
FIELD	08/23/2022	DRAFT	MML
REV 1	09/22/2022	CHECK	ZAK
SHEET : 1 OF 1		JOB: 115766	

WELL LOCATION MAP  
S.H.L. SW/4 NW/4, SECTION 29 T8N R61W 6TH PM  
LP SE/4 NE/4, SECTION 29 T8N R61W 6TH PM  
BPZ NE/4 NE/4, SECTION 20 T8N R61W 6TH PM  
BHL NE/4 NE/4, SECTION 20 T8N R61W 6TH PM  
WELD COUNTY, COLORADO