



FORM F-106

RECEIVED

OCT 13 1977

GOLD, OIL & GAS CONS. COMM.

R. 54W



00255768

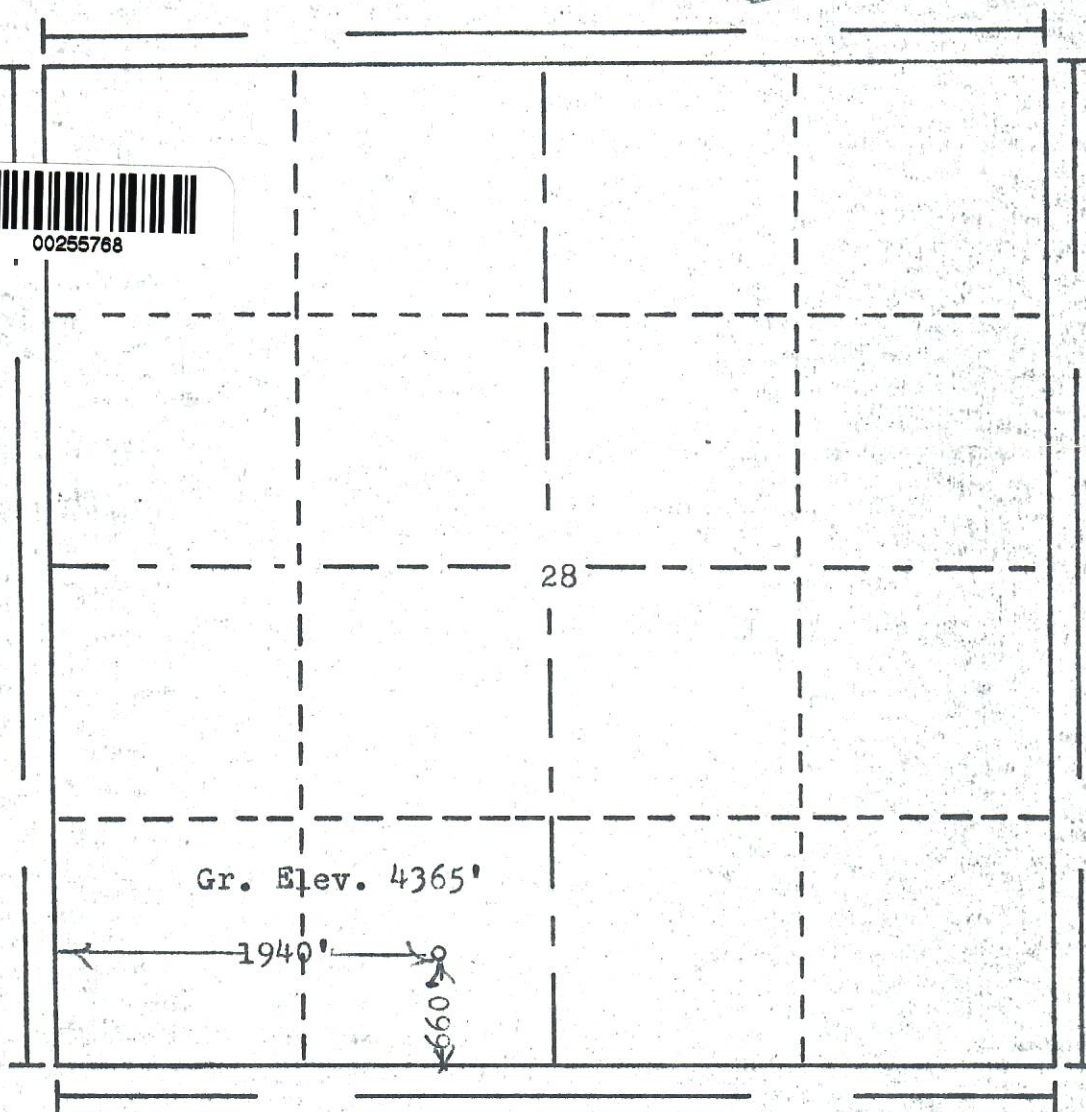

Scale... 1" = 1000'

Powers Elevation Company, Inc. of Denver, Colorado
has in accordance with a request from Shirley
for Toltek Drlg. Co.

determined the location of No. 28-14 C.F.E.E.

to be CSE SW

Section 28 Township 9N

Range 54W

of the 6th Principal

Meridian

Logan

County, Colorado

I hereby certify that this plat is an
accurate representation of a correct
survey showing the location of

Date: 10-3-77

Reid D. Hollman
Licensed Land Surveyor No. 2853
State of Colorado