



Geodetic System: US State Plane 1983
Datum: North American Datum 1983
Ellipsoid: GRS 1980
Zone: Colorado Central Zone
System Datum: Mean Sea Level

Name	TVĐ	+N/-S	+E/-W	Northing	Easting	Latitude	Longitude	Shape
RG 434-11-298 - VP	7848.00	1382.02	-2710.09	1760225.91	2198579.10	39.886047	-108.356196	Circle (Radius: 100.00)
RG 434-11-298 - PBHL	11628.00	1382.02	-2710.09	1760225.91	2198579.10	39.886047	-108.356196	Point

Co-ordinate (N/E) Reference: Well RG 434-11-298 - Slot RG 434-11-298, True North
Vertical (TVD) Reference: KB=30' @ 6648.00usft (H&P #329)
Section (VS) Reference: Slot - RG 434-11-298(0.00N, 0.00E)
Measured Depth Reference: KB=30' @ 6648.00usft (H&P #329)
Calculation Method: Minimum Curvature

MD	Inc	Azi	TVD	+N/-S	+E/-W	VSec	Departure	Annotation
120.00	0.00	0.00	120.00	0.00	0.00	0.00	0.00	Start Build 2.00
1432.36	26.25	297.02	1386.94	134.19	-263.14	295.38	295.38	Start 5320.36 hold at 1432.36 MD
6752.73	26.25	297.02	6158.74	1203.10	-2359.24	2648.29	2648.29	Start Drop -1.50
8502.55	0.00	0.00	7848.00	1382.02	-2710.09	3042.13	3042.13	Start 3780.00 hold at 8502.55 MD
12282.55	0.00	0.00	11628.00	1382.02	-2710.09	3042.13	3042.13	TD at 12282.55

		Ground Elev: 6618.00				
+N/-S	+E/-W	Northing	Easting	Latitude	Longitude	Slot
0.00	0.00	1758759.67	2201244.56	39.882253	-108.346539	RG 434-11-298

TVD	MD	Name	Size
1330.00	1369.21	13 3/8" Surface Casing	13-3/8
3040.00	3275.46	9 5/8" Intermediate Casing	9-5/8

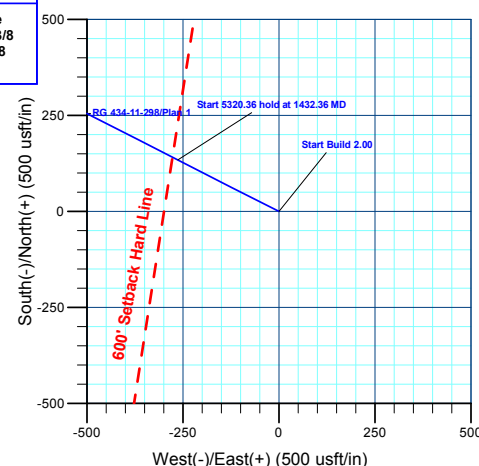

TVDPath	MDPath	Formation
30.00	30.00	UINTA
880.00	889.21	GRRV
1030.00	1046.04	GRRV_A_GROOVE
1220.00	1249.00	GRRV_B_GROOVE
1530.00	1591.87	GRRV_DISSOLUTION_SURF
2260.00	2405.79	GARDEN_GULCH
2460.00	2628.38	GRRV_ORANGE
2540.00		U_WSCH
4700.00	5126.29	G_SAND
5115.00	5589.00	FRUN
5900.00	6464.24	L_WSCH
6328.00	6939.27	OCRK
7048.00	7696.58	U_MVRD
7848.00	8502.55	TOP GAS
9418.00	10072.55	CMEQ
10148.00	10802.55	RLNS
10298.00	10952.55	CZT
10623.00	11277.55	CRCN
10883.00	11537.55	SEGO
11128.00	11782.55	SEGO_LOWER
11628.00	12282.55	TD

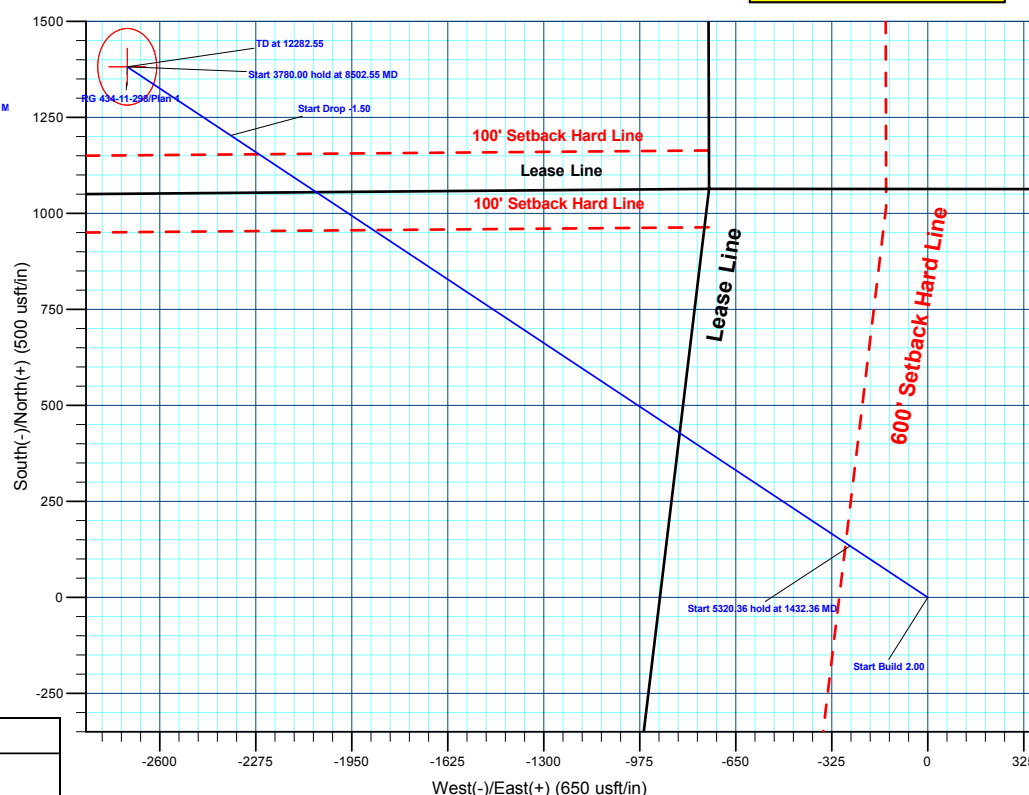
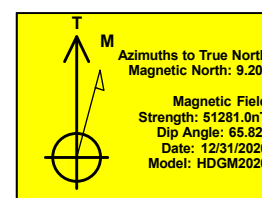

Created By: Chase Chambers Date: 13:23, May 04 2022



Terra Energy Partners, LLP

Rio Blanco County, CO

RG 11-13-298

RG 434-11-298 - Slot RG 434-11-298

Wellbore #1

Plan: Plan 1

KLX Well Planning Report

04 May, 2022



Database:	EDM 5000.1 Single User Db	Local Co-ordinate Reference:	Well RG 434-11-298 - Slot RG 434-11-298
Company:	Terra Energy Partners, LLP	TVD Reference:	KB=30' @ 6648.00usft (H&P #329)
Project:	Rio Blanco County, CO	MD Reference:	KB=30' @ 6648.00usft (H&P #329)
Site:	RG 11-13-298	North Reference:	True
Well:	RG 434-11-298	Survey Calculation Method:	Minimum Curvature
Wellbore:	Wellbore #1		
Design:	Plan 1		

Project	Rio Blanco County, CO		
Map System:	US State Plane 1983	System Datum:	Mean Sea Level
Geo Datum:	North American Datum 1983		
Map Zone:	Colorado Central Zone		

Site	RG 11-13-298				
Site Position:		Northing:	1,758,713.60 usft	Latitude:	39.882127
From:	Map	Easting:	2,201,243.58 usft	Longitude:	-108.346538
Position Uncertainty:	0.00 usft	Slot Radius:	13-3/16 "	Grid Convergence:	-1.80 °

Well	RG 434-11-298 - Slot RG 434-11-298					
Well Position	+N/-S	46.08 usft	Northing:	1,758,759.67 usft	Latitude:	39.882254
	+E/-W	-0.46 usft	Easting:	2,201,244.56 usft	Longitude:	-108.346540
Position Uncertainty		0.00 usft	Wellhead Elevation:		Ground Level:	6,618.00 usft

Wellbore	Wellbore #1				
Magnetics	Model Name	Sample Date	Declination (°)	Dip Angle (°)	Field Strength (nT)
	HDGM2020	12/31/2020	9.20	65.82	51,281.00000000

Design	Plan 1			
Audit Notes:				
Version:	Phase:	PLAN	Tie On Depth:	0.00
Vertical Section:	Depth From (TVD) (usft)	+N/-S (usft)	+E/-W (usft)	Direction (°)
	0.00	0.00	0.00	297.02

Plan Sections										
Measured Depth (usft)	Inclination (°)	Azimuth (°)	Vertical Depth (usft)	+N/-S (usft)	+E/-W (usft)	Dogleg Rate (°/100usft)	Build Rate (°/100usft)	Turn Rate (°/100usft)	TFO (°)	Target
0.00	0.00	0.00	0.00	0.00	0.00	0.00	0.00	0.00	0.00	
120.00	0.00	0.00	120.00	0.00	0.00	0.00	0.00	0.00	0.00	
1,432.36	26.25	297.02	1,386.94	134.19	-263.14	2.00	2.00	0.00	297.02	
6,752.73	26.25	297.02	6,158.74	1,203.10	-2,359.24	0.00	0.00	0.00	0.00	
8,502.55	0.00	0.00	7,848.00	1,382.02	-2,710.09	1.50	-1.50	0.00	180.00	RG 434-11-298 - VP
12,282.55	0.00	0.00	11,628.00	1,382.02	-2,710.09	0.00	0.00	0.00	0.00	RG 434-11-298 - PBH

Database:	EDM 5000.1 Single User Db	Local Co-ordinate Reference:	Well RG 434-11-298 - Slot RG 434-11-298
Company:	Terra Energy Partners, LLP	TVD Reference:	KB=30' @ 6648.00usft (H&P #329)
Project:	Rio Blanco County, CO	MD Reference:	KB=30' @ 6648.00usft (H&P #329)
Site:	RG 11-13-298	North Reference:	True
Well:	RG 434-11-298	Survey Calculation Method:	Minimum Curvature
Wellbore:	Wellbore #1		
Design:	Plan 1		

Planned Survey									
Measured Depth (usft)	Inclination (°)	Azimuth (°)	Vertical Depth (usft)	+N/-S (usft)	+E/-W (usft)	Vertical Section (usft)	Dogleg Rate (°/100usft)	Build Rate (°/100usft)	Turn Rate (°/100usft)
0.00	0.00	0.00	0.00	0.00	0.00	0.00	0.00	0.00	0.00
UINTA									
30.00	0.00	0.00	30.00	0.00	0.00	0.00	0.00	0.00	0.00
100.00	0.00	0.00	100.00	0.00	0.00	0.00	0.00	0.00	0.00
Start Build 2.00									
120.00	0.00	0.00	120.00	0.00	0.00	0.00	0.00	0.00	0.00
200.00	1.60	297.02	199.99	0.51	-1.00	1.12	2.00	2.00	0.00
300.00	3.60	297.02	299.88	2.57	-5.04	5.65	2.00	2.00	0.00
400.00	5.60	297.02	399.55	6.21	-12.18	13.67	2.00	2.00	0.00
500.00	7.60	297.02	498.89	11.43	-22.42	25.17	2.00	2.00	0.00
600.00	9.60	297.02	597.76	18.23	-35.74	40.12	2.00	2.00	0.00
700.00	11.60	297.02	696.05	26.58	-52.13	58.51	2.00	2.00	0.00
800.00	13.60	297.02	793.63	36.49	-71.56	80.33	2.00	2.00	0.00
GRRV									
889.21	15.38	297.02	880.00	46.63	-91.45	102.65	2.00	2.00	0.00
900.00	15.60	297.02	890.40	47.94	-94.01	105.53	2.00	2.00	0.00
1,000.00	17.60	297.02	986.23	60.92	-119.46	134.10	2.00	2.00	0.00
GRRV_A_GROOVE									
1,046.04	18.52	297.02	1,030.00	67.40	-132.18	148.37	2.00	2.00	0.00
1,100.00	19.60	297.02	1,081.00	75.41	-147.88	165.99	2.00	2.00	0.00
1,200.00	21.60	297.02	1,174.60	91.39	-179.22	201.18	2.00	2.00	0.00
GRRV_B_GROOVE									
1,249.00	22.58	297.02	1,220.00	99.76	-195.63	219.60	2.00	2.00	0.00
1,300.00	23.60	297.02	1,266.92	108.85	-213.45	239.60	2.00	2.00	0.00
13 3/8" Surface Casing									
1,369.21	24.98	297.02	1,330.00	121.79	-238.82	268.08	2.00	2.00	0.00
1,400.00	25.60	297.02	1,357.83	127.76	-250.53	281.23	2.00	2.00	0.00
Start 5320.36 hold at 1432.36 MD									
1,432.36	26.25	297.02	1,386.94	134.19	-263.14	295.38	2.00	2.00	0.00
1,500.00	26.25	297.02	1,447.60	147.78	-289.78	325.29	0.00	0.00	0.00
GRRV DISSOLUTION SURF									
1,591.87	26.25	297.02	1,530.00	166.23	-325.98	365.92	0.00	0.00	0.00
1,600.00	26.25	297.02	1,537.29	167.87	-329.18	369.51	0.00	0.00	0.00
1,700.00	26.25	297.02	1,626.98	187.96	-368.58	413.74	0.00	0.00	0.00
1,800.00	26.25	297.02	1,716.67	208.05	-407.98	457.96	0.00	0.00	0.00
1,900.00	26.25	297.02	1,806.36	228.14	-447.38	502.19	0.00	0.00	0.00
2,000.00	26.25	297.02	1,896.05	248.23	-486.77	546.41	0.00	0.00	0.00
2,100.00	26.25	297.02	1,985.74	268.32	-526.17	590.64	0.00	0.00	0.00
2,200.00	26.25	297.02	2,075.43	288.41	-565.57	634.86	0.00	0.00	0.00
2,300.00	26.25	297.02	2,165.12	308.50	-604.97	679.09	0.00	0.00	0.00
2,400.00	26.25	297.02	2,254.81	328.59	-644.36	723.31	0.00	0.00	0.00
GARDEN_GULCH									
2,405.79	26.25	297.02	2,260.00	329.76	-646.64	725.87	0.00	0.00	0.00
2,500.00	26.25	297.02	2,344.50	348.69	-683.76	767.54	0.00	0.00	0.00
2,600.00	26.25	297.02	2,434.19	368.78	-723.16	811.76	0.00	0.00	0.00
GRRV_ORANGE									
2,628.78	26.25	297.02	2,460.00	374.56	-734.50	824.49	0.00	0.00	0.00
2,700.00	26.25	297.02	2,523.88	388.87	-762.56	855.99	0.00	0.00	0.00
U_WSCH									
2,717.98	26.25	297.02	2,540.00	392.48	-769.64	863.94	0.00	0.00	0.00
2,800.00	26.25	297.02	2,613.57	408.96	-801.95	900.21	0.00	0.00	0.00
2,900.00	26.25	297.02	2,703.26	429.05	-841.35	944.43	0.00	0.00	0.00
3,000.00	26.25	297.02	2,792.94	449.14	-880.75	988.66	0.00	0.00	0.00

Database:	EDM 5000.1 Single User Db	Local Co-ordinate Reference:	Well RG 434-11-298 - Slot RG 434-11-298
Company:	Terra Energy Partners, LLP	TVD Reference:	KB=30' @ 6648.00usft (H&P #329)
Project:	Rio Blanco County, CO	MD Reference:	KB=30' @ 6648.00usft (H&P #329)
Site:	RG 11-13-298	North Reference:	True
Well:	RG 434-11-298	Survey Calculation Method:	Minimum Curvature
Wellbore:	Wellbore #1		
Design:	Plan 1		

Planned Survey									
Measured Depth (usft)	Inclination (°)	Azimuth (°)	Vertical Depth (usft)	+N/-S (usft)	+E/-W (usft)	Vertical Section (usft)	Dogleg Rate (°/100usft)	Build Rate (°/100usft)	Turn Rate (°/100usft)
3,100.00	26.25	297.02	2,882.63	469.23	-920.15	1,032.88	0.00	0.00	0.00
3,200.00	26.25	297.02	2,972.32	489.32	-959.54	1,077.11	0.00	0.00	0.00
9 5/8" Intermediate Casing									
3,275.46	26.25	297.02	3,040.00	504.48	-989.27	1,110.48	0.00	0.00	0.00
3,300.00	26.25	297.02	3,062.01	509.41	-998.94	1,121.33	0.00	0.00	0.00
3,400.00	26.25	297.02	3,151.70	529.50	-1,038.34	1,165.56	0.00	0.00	0.00
3,500.00	26.25	297.02	3,241.39	549.59	-1,077.74	1,209.78	0.00	0.00	0.00
3,600.00	26.25	297.02	3,331.08	569.69	-1,117.14	1,254.01	0.00	0.00	0.00
3,700.00	26.25	297.02	3,420.77	589.78	-1,156.53	1,298.23	0.00	0.00	0.00
3,800.00	26.25	297.02	3,510.46	609.87	-1,195.93	1,342.46	0.00	0.00	0.00
3,900.00	26.25	297.02	3,600.15	629.96	-1,235.33	1,386.68	0.00	0.00	0.00
4,000.00	26.25	297.02	3,689.84	650.05	-1,274.73	1,430.91	0.00	0.00	0.00
4,100.00	26.25	297.02	3,779.53	670.14	-1,314.12	1,475.13	0.00	0.00	0.00
4,200.00	26.25	297.02	3,869.22	690.23	-1,353.52	1,519.35	0.00	0.00	0.00
4,300.00	26.25	297.02	3,958.91	710.32	-1,392.92	1,563.58	0.00	0.00	0.00
4,400.00	26.25	297.02	4,048.60	730.41	-1,432.32	1,607.80	0.00	0.00	0.00
4,500.00	26.25	297.02	4,138.29	750.50	-1,471.71	1,652.03	0.00	0.00	0.00
4,600.00	26.25	297.02	4,227.97	770.60	-1,511.11	1,696.25	0.00	0.00	0.00
4,700.00	26.25	297.02	4,317.66	790.69	-1,550.51	1,740.48	0.00	0.00	0.00
4,800.00	26.25	297.02	4,407.35	810.78	-1,589.91	1,784.70	0.00	0.00	0.00
4,900.00	26.25	297.02	4,497.04	830.87	-1,629.30	1,828.93	0.00	0.00	0.00
5,000.00	26.25	297.02	4,586.73	850.96	-1,668.70	1,873.15	0.00	0.00	0.00
5,100.00	26.25	297.02	4,676.42	871.05	-1,708.10	1,917.38	0.00	0.00	0.00
G_SAND									
5,126.29	26.25	297.02	4,700.00	876.33	-1,718.46	1,929.00	0.00	0.00	0.00
5,200.00	26.25	297.02	4,766.11	891.14	-1,747.50	1,961.60	0.00	0.00	0.00
5,300.00	26.25	297.02	4,855.80	911.23	-1,786.89	2,005.83	0.00	0.00	0.00
5,400.00	26.25	297.02	4,945.49	931.32	-1,826.29	2,050.05	0.00	0.00	0.00
5,500.00	26.25	297.02	5,035.18	951.41	-1,865.69	2,094.27	0.00	0.00	0.00
FRUN									
5,589.00	26.25	297.02	5,115.00	969.29	-1,900.75	2,133.63	0.00	0.00	0.00
5,600.00	26.25	297.02	5,124.87	971.50	-1,905.09	2,138.50	0.00	0.00	0.00
5,700.00	26.25	297.02	5,214.56	991.60	-1,944.49	2,182.72	0.00	0.00	0.00
5,800.00	26.25	297.02	5,304.25	1,011.69	-1,983.88	2,226.95	0.00	0.00	0.00
5,900.00	26.25	297.02	5,393.94	1,031.78	-2,023.28	2,271.17	0.00	0.00	0.00
6,000.00	26.25	297.02	5,483.63	1,051.87	-2,062.68	2,315.40	0.00	0.00	0.00
6,100.00	26.25	297.02	5,573.31	1,071.96	-2,102.08	2,359.62	0.00	0.00	0.00
6,200.00	26.25	297.02	5,663.00	1,092.05	-2,141.47	2,403.85	0.00	0.00	0.00
6,300.00	26.25	297.02	5,752.69	1,112.14	-2,180.87	2,448.07	0.00	0.00	0.00
6,400.00	26.25	297.02	5,842.38	1,132.23	-2,220.27	2,492.30	0.00	0.00	0.00
L_WSCH									
6,464.24	26.25	297.02	5,900.00	1,145.14	-2,245.58	2,520.71	0.00	0.00	0.00
6,500.00	26.25	297.02	5,932.07	1,152.32	-2,259.67	2,536.52	0.00	0.00	0.00
6,600.00	26.25	297.02	6,021.76	1,172.41	-2,299.06	2,580.75	0.00	0.00	0.00
6,700.00	26.25	297.02	6,111.45	1,192.50	-2,338.46	2,624.97	0.00	0.00	0.00
Start Drop -1.50									
6,752.73	26.25	297.02	6,158.74	1,203.10	-2,359.24	2,648.29	0.00	0.00	0.00
6,800.00	25.54	297.02	6,201.27	1,212.48	-2,377.63	2,668.93	1.50	-1.50	0.00
6,900.00	24.04	297.02	6,292.05	1,231.52	-2,414.97	2,710.86	1.50	-1.50	0.00
OCRK									
6,939.27	23.45	297.02	6,328.00	1,238.71	-2,429.06	2,726.67	1.50	-1.50	0.00
7,000.00	22.54	297.02	6,383.90	1,249.48	-2,450.19	2,750.39	1.50	-1.50	0.00
7,100.00	21.04	297.02	6,476.76	1,266.34	-2,483.26	2,787.51	1.50	-1.50	0.00

Database:	EDM 5000.1 Single User Db	Local Co-ordinate Reference:	Well RG 434-11-298 - Slot RG 434-11-298
Company:	Terra Energy Partners, LLP	TVD Reference:	KB=30' @ 6648.00usft (H&P #329)
Project:	Rio Blanco County, CO	MD Reference:	KB=30' @ 6648.00usft (H&P #329)
Site:	RG 11-13-298	North Reference:	True
Well:	RG 434-11-298	Survey Calculation Method:	Minimum Curvature
Wellbore:	Wellbore #1		
Design:	Plan 1		

Planned Survey									
Measured Depth (usft)	Inclination (°)	Azimuth (°)	Vertical Depth (usft)	+N/-S (usft)	+E/-W (usft)	Vertical Section (usft)	Dogleg Rate (°/100usft)	Build Rate (°/100usft)	Turn Rate (°/100usft)
7,200.00	19.54	297.02	6,570.55	1,282.10	-2,514.15	2,822.18	1.50	-1.50	0.00
7,300.00	18.04	297.02	6,665.22	1,296.73	-2,542.84	2,854.39	1.50	-1.50	0.00
7,400.00	16.54	297.02	6,760.70	1,310.23	-2,569.31	2,884.11	1.50	-1.50	0.00
7,500.00	15.04	297.02	6,856.92	1,322.59	-2,593.55	2,911.31	1.50	-1.50	0.00
7,600.00	13.54	297.02	6,953.83	1,333.80	-2,615.54	2,935.99	1.50	-1.50	0.00
U_MVRD									
7,696.58	12.09	297.02	7,048.00	1,343.53	-2,634.62	2,957.41	1.50	-1.50	0.00
7,700.00	12.04	297.02	7,051.34	1,343.85	-2,635.25	2,958.13	1.50	-1.50	0.00
7,800.00	10.54	297.02	7,149.41	1,352.75	-2,652.69	2,977.70	1.50	-1.50	0.00
7,900.00	9.04	297.02	7,247.95	1,360.47	-2,667.84	2,994.70	1.50	-1.50	0.00
8,000.00	7.54	297.02	7,346.90	1,367.02	-2,680.68	3,009.12	1.50	-1.50	0.00
8,100.00	6.04	297.02	7,446.20	1,372.39	-2,691.21	3,020.93	1.50	-1.50	0.00
8,200.00	4.54	297.02	7,545.77	1,376.58	-2,699.42	3,030.15	1.50	-1.50	0.00
8,300.00	3.04	297.02	7,645.55	1,379.58	-2,705.30	3,036.76	1.50	-1.50	0.00
8,400.00	1.54	297.02	7,745.46	1,381.39	-2,708.86	3,040.75	1.50	-1.50	0.00
Start 3780.00 hold at 8502.55 MD - TOP GAS									
8,502.55	0.00	0.00	7,848.00	1,382.02	-2,710.09	3,042.13	1.50	-1.50	0.00
8,600.00	0.00	0.00	7,945.45	1,382.02	-2,710.09	3,042.13	0.00	0.00	0.00
8,700.00	0.00	0.00	8,045.45	1,382.02	-2,710.09	3,042.13	0.00	0.00	0.00
8,800.00	0.00	0.00	8,145.45	1,382.02	-2,710.09	3,042.13	0.00	0.00	0.00
8,900.00	0.00	0.00	8,245.45	1,382.02	-2,710.09	3,042.13	0.00	0.00	0.00
9,000.00	0.00	0.00	8,345.45	1,382.02	-2,710.09	3,042.13	0.00	0.00	0.00
9,100.00	0.00	0.00	8,445.45	1,382.02	-2,710.09	3,042.13	0.00	0.00	0.00
9,200.00	0.00	0.00	8,545.45	1,382.02	-2,710.09	3,042.13	0.00	0.00	0.00
9,300.00	0.00	0.00	8,645.45	1,382.02	-2,710.09	3,042.13	0.00	0.00	0.00
9,400.00	0.00	0.00	8,745.45	1,382.02	-2,710.09	3,042.13	0.00	0.00	0.00
9,500.00	0.00	0.00	8,845.45	1,382.02	-2,710.09	3,042.13	0.00	0.00	0.00
9,600.00	0.00	0.00	8,945.45	1,382.02	-2,710.09	3,042.13	0.00	0.00	0.00
9,700.00	0.00	0.00	9,045.45	1,382.02	-2,710.09	3,042.13	0.00	0.00	0.00
9,800.00	0.00	0.00	9,145.45	1,382.02	-2,710.09	3,042.13	0.00	0.00	0.00
9,900.00	0.00	0.00	9,245.45	1,382.02	-2,710.09	3,042.13	0.00	0.00	0.00
10,000.00	0.00	0.00	9,345.45	1,382.02	-2,710.09	3,042.13	0.00	0.00	0.00
CMEO									
10,072.55	0.00	0.00	9,418.00	1,382.02	-2,710.09	3,042.13	0.00	0.00	0.00
10,100.00	0.00	0.00	9,445.45	1,382.02	-2,710.09	3,042.13	0.00	0.00	0.00
10,200.00	0.00	0.00	9,545.45	1,382.02	-2,710.09	3,042.13	0.00	0.00	0.00
10,300.00	0.00	0.00	9,645.45	1,382.02	-2,710.09	3,042.13	0.00	0.00	0.00
10,400.00	0.00	0.00	9,745.45	1,382.02	-2,710.09	3,042.13	0.00	0.00	0.00
10,500.00	0.00	0.00	9,845.45	1,382.02	-2,710.09	3,042.13	0.00	0.00	0.00
10,600.00	0.00	0.00	9,945.45	1,382.02	-2,710.09	3,042.13	0.00	0.00	0.00
10,700.00	0.00	0.00	10,045.45	1,382.02	-2,710.09	3,042.13	0.00	0.00	0.00
10,800.00	0.00	0.00	10,145.45	1,382.02	-2,710.09	3,042.13	0.00	0.00	0.00
RLNS									
10,802.55	0.00	0.00	10,148.00	1,382.02	-2,710.09	3,042.13	0.00	0.00	0.00
10,900.00	0.00	0.00	10,245.45	1,382.02	-2,710.09	3,042.13	0.00	0.00	0.00
CZZT									
10,952.55	0.00	0.00	10,298.00	1,382.02	-2,710.09	3,042.13	0.00	0.00	0.00
11,000.00	0.00	0.00	10,345.45	1,382.02	-2,710.09	3,042.13	0.00	0.00	0.00
11,100.00	0.00	0.00	10,445.45	1,382.02	-2,710.09	3,042.13	0.00	0.00	0.00
11,200.00	0.00	0.00	10,545.45	1,382.02	-2,710.09	3,042.13	0.00	0.00	0.00
CRCN									
11,277.55	0.00	0.00	10,623.00	1,382.02	-2,710.09	3,042.13	0.00	0.00	0.00
11,300.00	0.00	0.00	10,645.45	1,382.02	-2,710.09	3,042.13	0.00	0.00	0.00

Database:	EDM 5000.1 Single User Db	Local Co-ordinate Reference:	Well RG 434-11-298 - Slot RG 434-11-298
Company:	Terra Energy Partners, LLP	TVD Reference:	KB=30' @ 6648.00usft (H&P #329)
Project:	Rio Blanco County, CO	MD Reference:	KB=30' @ 6648.00usft (H&P #329)
Site:	RG 11-13-298	North Reference:	True
Well:	RG 434-11-298	Survey Calculation Method:	Minimum Curvature
Wellbore:	Wellbore #1		
Design:	Plan 1		

Planned Survey									
Measured Depth (usft)	Inclination (°)	Azimuth (°)	Vertical Depth (usft)	+N/-S (usft)	+E/-W (usft)	Vertical Section (usft)	Dogleg Rate (°/100usft)	Build Rate (°/100usft)	Turn Rate (°/100usft)
11,400.00	0.00	0.00	10,745.45	1,382.02	-2,710.09	3,042.13	0.00	0.00	0.00
11,500.00	0.00	0.00	10,845.45	1,382.02	-2,710.09	3,042.13	0.00	0.00	0.00
SEGO									
11,537.55	0.00	0.00	10,883.00	1,382.02	-2,710.09	3,042.13	0.00	0.00	0.00
11,600.00	0.00	0.00	10,945.45	1,382.02	-2,710.09	3,042.13	0.00	0.00	0.00
11,700.00	0.00	0.00	11,045.45	1,382.02	-2,710.09	3,042.13	0.00	0.00	0.00
SEGO_LOWER									
11,782.55	0.00	0.00	11,128.00	1,382.02	-2,710.09	3,042.13	0.00	0.00	0.00
11,800.00	0.00	0.00	11,145.45	1,382.02	-2,710.09	3,042.13	0.00	0.00	0.00
11,900.00	0.00	0.00	11,245.45	1,382.02	-2,710.09	3,042.13	0.00	0.00	0.00
12,000.00	0.00	0.00	11,345.45	1,382.02	-2,710.09	3,042.13	0.00	0.00	0.00
12,100.00	0.00	0.00	11,445.45	1,382.02	-2,710.09	3,042.13	0.00	0.00	0.00
12,200.00	0.00	0.00	11,545.45	1,382.02	-2,710.09	3,042.13	0.00	0.00	0.00
TD at 12282.55 - TD									
12,282.55	0.00	0.00	11,628.00	1,382.02	-2,710.09	3,042.13	0.00	0.00	0.00

Design Targets									
Target Name - hit/miss target - Shape	Dip Angle (°)	Dip Dir. (°)	TVD (usft)	+N/-S (usft)	+E/-W (usft)	Northing (usft)	Easting (usft)	Latitude	Longitude
RG 434-11-298 - VP - plan hits target center - Circle (radius 100.00)	0.00	0.00	7,848.00	1,382.02	-2,710.09	1,760,225.91	2,198,579.10	39.886047	-108.356196
RG 434-11-298 - PBHL - plan hits target center - Point	0.00	0.00	11,628.00	1,382.02	-2,710.09	1,760,225.91	2,198,579.10	39.886047	-108.356196

Casing Points					
Measured Depth (usft)	Vertical Depth (usft)	Name	Casing Diameter (")	Hole Diameter (")	
1,369.21	1,330.00	13 3/8" Surface Casing	13-3/8	17-1/2	
3,275.46	3,040.00	9 5/8" Intermediate Casing	9-5/8	12-1/4	

Database:	EDM 5000.1 Single User Db	Local Co-ordinate Reference:	Well RG 434-11-298 - Slot RG 434-11-298
Company:	Terra Energy Partners, LLP	TVD Reference:	KB=30' @ 6648.00usft (H&P #329)
Project:	Rio Blanco County, CO	MD Reference:	KB=30' @ 6648.00usft (H&P #329)
Site:	RG 11-13-298	North Reference:	True
Well:	RG 434-11-298	Survey Calculation Method:	Minimum Curvature
Wellbore:	Wellbore #1		
Design:	Plan 1		

Formations						
Measured Depth (usft)	Vertical Depth (usft)	Name	Lithology	Dip (°)	Dip Direction (°)	
30.00	30.00	UINTA				
889.21	880.00	GRRV				
1,046.04	1,030.00	GRRV_A_GROOVE				
1,249.00	1,220.00	GRRV_B_GROOVE				
1,591.87	1,530.00	GRRV DISSOLUTION_SURF				
2,405.79	2,260.00	GARDEN_GULCH				
2,628.78	2,460.00	GRRV_ORANGE				
2,717.98	2,540.00	U__WSCH				
5,126.29	4,700.00	G_SAND				
5,589.00	5,115.00	FRUN				
6,464.24	5,900.00	L__WSCH				
6,939.27	6,328.00	OCRK				
7,696.58	7,048.00	U__MVRD				
8,502.55	7,848.00	TOP GAS				
10,072.55	9,418.00	CMEO				
10,802.55	10,148.00	RLNS				
10,952.55	10,298.00	CZZT				
11,277.55	10,623.00	CRCN				
11,537.55	10,883.00	SEGO				
11,782.55	11,128.00	SEGO_LOWER				
12,282.55	11,628.00	TD				

Plan Annotations					
Measured Depth (usft)	Vertical Depth (usft)	Local Coordinates			
		+N/-S (usft)	+E/-W (usft)	Comment	
120.00	120.00	0.00	0.00	Start Build 2.00	
1,432.36	1,386.94	134.19	-263.14	Start 5320.36 hold at 1432.36 MD	
6,752.73	6,158.74	1,203.10	-2,359.24	Start Drop -1.50	
8,502.55	7,848.00	1,382.02	-2,710.09	Start 3780.00 hold at 8502.55 MD	
12,282.55	11,628.00	1,382.02	-2,710.09	TD at 12282.55	