

CONFLUENCE RESOURCES

Location: COLORADO Slot: SLOT#14 CANAL 22-1-3L (185°FSL & 1346°FWL,SEC.22)
Field: WELD COUNTY (NAD83, TRUE NORTH) Well: CANAL 22-1-3L
Facility: SEC.22-T01N-R65W Wellbore: CANAL 22-1-3L PWB

Plot reference wellpath is CANAL 22-1-3L PWP Rev-A.0	Grid System: NAD83 / Lambert Colorado SP, Northern Zone (501), US feet
True vertical depths are referenced to Rig (23) (KB)	North Reference: True north
Reference wellpath measured depths are referenced to Rig (23) (KB)	Scale: True distance
Rig (23) (KB) to Mean Sea Level: 5118 feet	Coordinates are in feet referenced to Slot
Mean Sea Level to Mud line (At Slot: SLOT#14 CANAL 22-1-3L (185°FSL & 1346°FWL,SEC.22)): 0 feet	Depths are in feet
Offset wellpath MDs are referenced to each path's default MD datum	Created by: painsetr on 2021-09-08, Database: WellArchitectDB

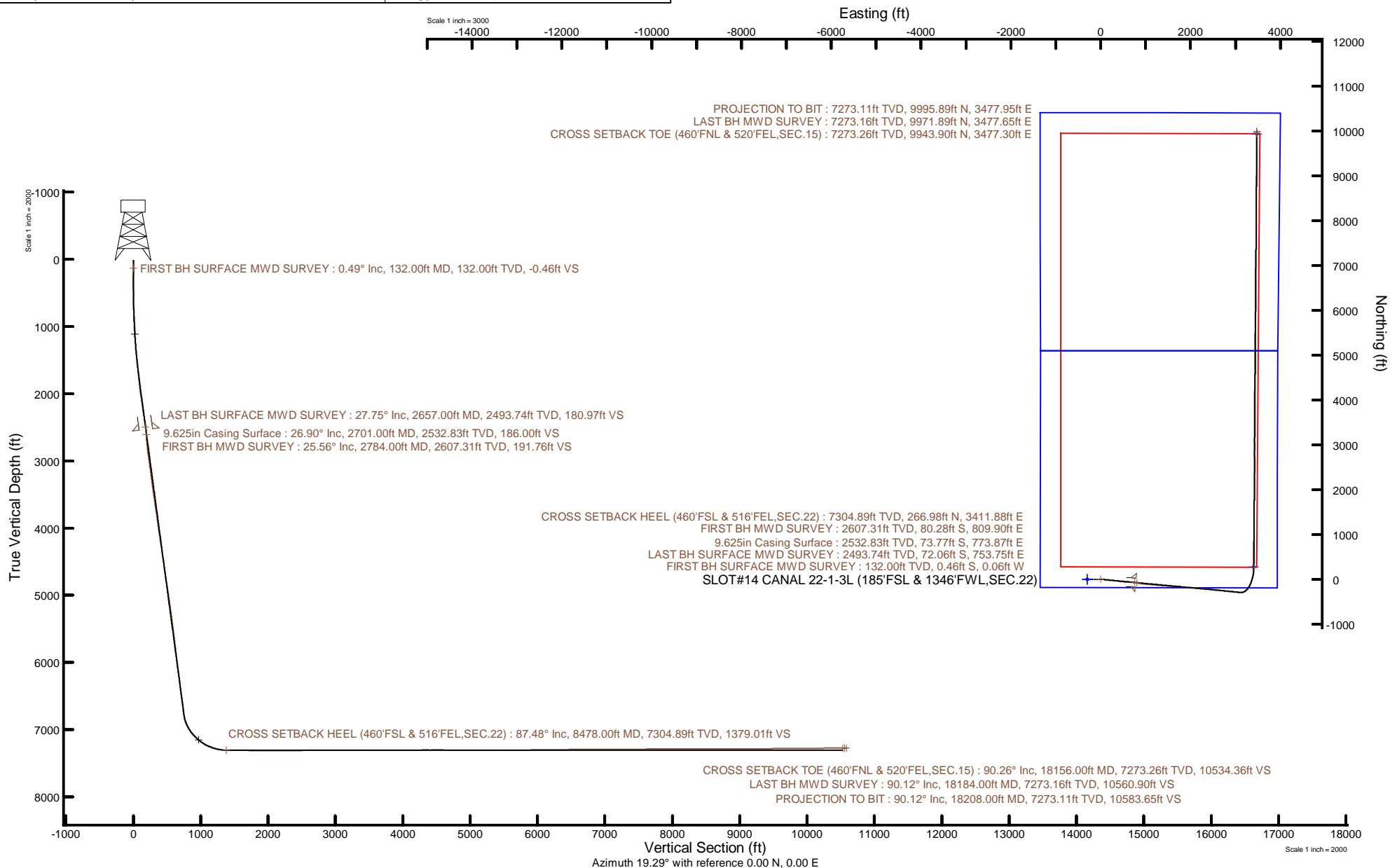



Actual Wellpath Report

CANAL 22-1-3L AWP

Page 1 of 11



REFERENCE WELLPATH IDENTIFICATION

Operator	CONFLUENCE RESOURCES	Well	CANAL 22-1-3L
Field	WELD COUNTY (NAD83, TRUE NORTH)	API	0512351590
Facility	SEC.22-T01N-R65W	Wellbore	CANAL 22-1-3L AWB
Slot	SLOT#14 CANAL 22-1-3L (185'FSL & 1346'FWL,SEC.22)		

REPORT SETUP INFORMATION

Projection System	NAD83 / Lambert Colorado SP, Northern Zone (501), US feet	Software System	WellArchitect® 6.0
North Reference	True	User	Painsetr
Scale	0.999964	Report Generated	9/8/2021 at 2:13:03 PM
Convergence at slot	0.55° East	Database	WellArchitectDB

WELLPATH LOCATION

	Local coordinates		Grid coordinates		Geographic coordinates	
	North[ft]	East[ft]	Easting[US ft]	Northing[US ft]	Latitude	Longitude
Slot Location	0.00	299.64	3236683.08	1254964.99	40.0301700°	-104.6547800°
Facility Reference Pt			3236383.46	1254962.14	40.0301700°	-104.6558500°
Field Reference Pt			3230456.90	1245096.09	40.0032400°	-104.6773400°

WELLPATH DATUM

Calculation method	Minimum curvature	Rig (23') (KB) to Facility Vertical Datum	5118.00ft
Horizontal Reference Pt	Slot	Rig (23') (KB) to Mean Sea Level	5118.00ft
Vertical Reference Pt	Rig (23') (KB)	Rig (23') (KB) to Mud Line at Slot (SLOT#14 CANAL 22-1-3L (185'FSL & 1346'FWL,SEC.22))	5118.00ft
MD Reference Pt	Rig (23') (KB)	Section Origin	N 0.00, E 0.00 ft
Field Vertical Reference	Mean Sea Level	Section Azimuth	19.29°



Actual Wellpath Report

CANAL 22-1-3L AWP

Page 2 of 11



REFERENCE WELLPATH IDENTIFICATION

Operator	CONFLUENCE RESOURCES	Well	CANAL 22-1-3L
Field	WELD COUNTY (NAD83, TRUE NORTH)	API	0512351590
Facility	SEC.22-T01N-R65W	Wellbore	CANAL 22-1-3L AWB
Slot	SLOT#14 CANAL 22-1-3L (185'FSL & 1346'FWL,SEC.22)		

WELLPATH DATA (208 stations) † = interpolated, ‡ = extrapolated station

MD [ft]	Inclination [°]	Azimuth [°]	TVD [ft]	Vert Sect [ft]	North [ft]	East [ft]	Grid East [US ft]	Grid North [US ft]	Latitude	Longitude	DLS [°/100ft]	Comments
0.00†	0.000	186.990	0.00	0.00	0.00	0.00	3236683.08	1254964.99	40.0301700	-104.6547800	0.00	
23.00	0.000	186.990	23.00	0.00	0.00	0.00	3236683.08	1254964.99	40.0301700	-104.6547800	0.00	
132.00	0.490	186.990	132.00	-0.46	-0.46	-0.06	3236683.03	1254964.53	40.0301687	-104.6547802	0.45	FIRST BH SURFACE MWD SURVEY
227.00	0.720	187.330	226.99	-1.44	-1.46	-0.18	3236682.91	1254963.53	40.0301660	-104.6547807	0.24	
317.00	0.450	189.830	316.99	-2.34	-2.37	-0.31	3236682.79	1254962.62	40.0301635	-104.6547811	0.30	
407.00	2.020	85.910	406.97	-2.06	-2.60	1.21	3236684.31	1254962.40	40.0301629	-104.6547757	2.41	
497.00	3.140	88.690	496.88	-0.56	-2.43	5.25	3236688.36	1254962.61	40.0301633	-104.6547612	1.25	
587.00	5.180	91.500	586.64	1.55	-2.48	11.78	3236694.88	1254962.62	40.0301632	-104.6547379	2.28	
676.00	7.030	92.560	675.13	4.34	-2.83	21.24	3236704.34	1254962.36	40.0301622	-104.6547042	2.08	
766.00	8.230	93.250	764.33	7.71	-3.44	33.17	3236716.28	1254961.87	40.0301606	-104.6546615	1.34	
856.00	9.190	90.850	853.29	11.76	-3.91	46.79	3236729.90	1254961.52	40.0301593	-104.6546129	1.14	
945.00	9.930	95.110	941.05	15.89	-4.70	61.54	3236744.66	1254960.87	40.0301571	-104.6545602	1.15	
1034.00	11.870	98.730	1028.45	19.45	-6.78	78.23	3236761.37	1254958.96	40.0301514	-104.6545006	2.31	
1124.00	13.760	98.950	1116.20	23.06	-9.85	97.96	3236781.12	1254956.08	40.0301430	-104.6544302	2.10	
1213.00	15.720	96.780	1202.27	27.57	-12.92	120.39	3236803.58	1254953.22	40.0301345	-104.6543501	2.29	
1303.00	17.950	94.850	1288.41	33.67	-15.53	146.32	3236829.53	1254950.86	40.0301274	-104.6542575	2.55	
1392.00	19.840	94.420	1372.61	40.97	-17.85	175.04	3236858.28	1254948.81	40.0301210	-104.6541549	2.13	
1482.00	20.460	93.510	1457.10	49.17	-19.99	205.97	3236889.22	1254946.96	40.0301151	-104.6540445	0.77	
1571.00	22.840	94.430	1539.81	57.83	-22.28	238.72	3236921.99	1254944.99	40.0301088	-104.6539275	2.70	
1660.00	25.060	97.310	1621.15	66.17	-26.01	274.64	3236957.95	1254941.60	40.0300986	-104.6537993	2.82	
1750.00	26.980	97.880	1702.02	74.16	-31.24	313.78	3236997.13	1254936.75	40.0300842	-104.6536595	2.15	
1840.00	28.450	98.540	1781.69	82.20	-37.22	355.20	3237038.61	1254931.16	40.0300678	-104.6535116	1.67	
1929.00	29.250	97.400	1859.65	90.63	-43.17	397.73	3237081.19	1254925.62	40.0300515	-104.6533597	1.09	
2019.00	30.780	98.110	1937.58	99.63	-49.25	442.34	3237125.85	1254919.96	40.0300348	-104.6532005	1.75	
2108.00	30.950	96.340	2013.97	109.17	-54.99	487.63	3237171.19	1254914.65	40.0300190	-104.6530387	1.04	
2197.00	30.140	92.820	2090.63	120.63	-58.62	532.69	3237216.29	1254911.46	40.0300091	-104.6528778	2.21	
2287.00	30.230	93.140	2168.43	133.34	-60.97	577.88	3237261.50	1254909.53	40.0300026	-104.6527164	0.20	
2376.00	28.530	94.520	2245.98	144.99	-63.87	621.45	3237305.08	1254907.05	40.0299946	-104.6525609	2.06	
2465.00	28.020	92.890	2324.36	156.31	-66.60	663.51	3237347.17	1254904.72	40.0299872	-104.6524107	1.04	
2555.00	28.330	93.860	2403.69	167.96	-69.10	705.93	3237389.61	1254902.62	40.0299803	-104.6522592	0.61	



Actual Wellpath Report

CANAL 22-1-3L AWP
Page 3 of 11



REFERENCE WELLPATH IDENTIFICATION

Operator	CONFLUENCE RESOURCES	Well	CANAL 22-1-3L
Field	WELD COUNTY (NAD83, TRUE NORTH)	API	0512351590
Facility	SEC.22-T01N-R65W	Wellbore	CANAL 22-1-3L AWB
Slot	SLOT#14 CANAL 22-1-3L (185'FSL & 1346'FWL,SEC.22)		

WELLPATH DATA (208 stations)

MD [ft]	Inclination [°]	Azimuth [°]	TVD [ft]	Vert Sect [ft]	North [ft]	East [ft]	Grid East [US ft]	Grid North [US ft]	Latitude	Longitude	DLS [°/100ft]	Comments
2645.00	27.770	93.290	2483.12	179.42	-71.75	748.17	3237431.87	1254900.38	40.0299730	-104.6521083	0.69	
2657.00	27.750	93.090	2493.74	180.97	-72.06	753.75	3237437.46	1254900.12	40.0299722	-104.6520884	0.79	LAST BH SURFACE MWD SURVEY
2784.00	25.560	103.990	2607.31	191.76	-80.28	809.90	3237493.68	1254892.44	40.0299496	-104.6518879	4.21	FIRST BH MWD SURVEY
2873.00	29.150	101.970	2686.34	196.29	-89.42	849.75	3237533.61	1254883.68	40.0299245	-104.6517456	4.17	
2964.00	29.190	98.060	2765.81	203.44	-97.13	893.41	3237577.34	1254876.39	40.0299033	-104.6515897	2.09	
3054.00	29.070	96.100	2844.43	212.70	-102.53	936.88	3237620.86	1254871.40	40.0298885	-104.6514345	1.07	
3143.00	28.120	94.870	2922.57	222.85	-106.61	979.28	3237663.29	1254867.73	40.0298773	-104.6512831	1.26	
3232.00	29.350	94.560	3000.61	233.62	-110.12	1021.92	3237705.96	1254864.62	40.0298676	-104.6511308	1.39	
3322.00	28.960	94.970	3079.21	244.62	-113.76	1065.61	3237749.69	1254861.39	40.0298576	-104.6509748	0.49	
3411.00	28.670	95.140	3157.19	255.17	-117.54	1108.34	3237792.45	1254858.02	40.0298473	-104.6508222	0.34	
3501.00	29.190	95.340	3235.96	265.73	-121.52	1151.70	3237835.84	1254854.46	40.0298363	-104.6506674	0.59	
3590.00	29.150	95.310	3313.67	276.20	-125.55	1194.89	3237879.07	1254850.84	40.0298253	-104.6505132	0.05	
3679.00	29.020	95.680	3391.45	286.52	-129.69	1237.95	3237922.17	1254847.11	40.0298139	-104.6503594	0.25	
3768.00	28.980	94.140	3469.29	297.23	-133.38	1280.94	3237965.18	1254843.83	40.0298038	-104.6502059	0.84	
3858.00	28.550	94.240	3548.18	308.51	-136.55	1324.13	3238008.40	1254841.08	40.0297951	-104.6500517	0.48	
3946.00	28.060	93.840	3625.66	319.48	-139.49	1365.76	3238050.05	1254838.53	40.0297870	-104.6499030	0.60	
4036.00	29.730	93.700	3704.45	331.12	-142.34	1409.15	3238093.47	1254836.09	40.0297791	-104.6497481	1.86	
4125.00	29.370	94.460	3781.88	342.64	-145.47	1452.93	3238137.28	1254833.39	40.0297706	-104.6495917	0.58	
4215.00	28.710	94.380	3860.56	353.84	-148.83	1496.49	3238180.86	1254830.43	40.0297613	-104.6494362	0.73	
4304.00	29.020	94.320	3938.50	364.92	-152.09	1539.33	3238223.73	1254827.58	40.0297524	-104.6492832	0.35	
4394.00	28.940	93.520	4017.24	376.48	-155.07	1582.83	3238267.26	1254825.02	40.0297442	-104.6491279	0.44	
4484.00	29.210	94.280	4095.89	388.08	-158.05	1626.47	3238310.92	1254822.46	40.0297360	-104.6489721	0.51	
4573.00	28.700	94.580	4173.77	399.13	-161.38	1669.42	3238353.90	1254819.54	40.0297269	-104.6488187	0.60	
4662.00	29.850	93.020	4251.40	410.76	-164.25	1712.85	3238397.35	1254817.08	40.0297190	-104.6486636	1.55	
4751.00	29.990	95.050	4328.54	422.44	-167.37	1757.12	3238441.65	1254814.38	40.0297104	-104.6485055	1.15	
4841.00	29.940	94.190	4406.51	433.82	-170.99	1801.93	3238486.49	1254811.18	40.0297004	-104.6483455	0.48	
4930.00	29.920	95.180	4483.64	445.02	-174.62	1846.18	3238530.77	1254807.98	40.0296905	-104.6481875	0.56	
5020.00	29.830	94.870	4561.68	456.06	-178.55	1890.84	3238575.46	1254804.48	40.0296797	-104.6480280	0.20	
5109.00	29.800	94.990	4638.90	467.03	-182.35	1934.93	3238619.58	1254801.10	40.0296692	-104.6478706	0.08	
5198.00	30.510	93.190	4715.86	478.76	-185.53	1979.52	3238664.20	1254798.34	40.0296605	-104.6477114	1.29	



Actual Wellpath Report

CANAL 22-1-3L AWP
Page 4 of 11



REFERENCE WELLPATH IDENTIFICATION

Operator	CONFLUENCE RESOURCES	Well	CANAL 22-1-3L
Field	WELD COUNTY (NAD83, TRUE NORTH)	API	0512351590
Facility	SEC.22-T01N-R65W	Wellbore	CANAL 22-1-3L AWB
Slot	SLOT#14 CANAL 22-1-3L (185'FSL & 1346'FWL,SEC.22)		

WELLPATH DATA (208 stations)

MD [ft]	Inclination [°]	Azimuth [°]	TVD [ft]	Vert Sect [ft]	North [ft]	East [ft]	Grid East [US ft]	Grid North [US ft]	Latitude	Longitude	DLS [°/100ft]	Comments
5288.00	29.300	94.450	4793.88	490.74	-188.51	2024.29	3238708.99	1254795.79	40.0296523	-104.6475515	1.51	
5377.00	29.240	95.140	4871.51	501.63	-192.15	2067.65	3238752.39	1254792.56	40.0296423	-104.6473967	0.39	
5466.00	29.240	92.980	4949.18	513.04	-195.23	2111.01	3238795.77	1254789.90	40.0296338	-104.6472418	1.19	
5556.00	29.160	93.440	5027.74	525.20	-197.69	2154.84	3238839.63	1254787.86	40.0296271	-104.6470853	0.26	
5646.00	28.960	94.350	5106.41	536.81	-200.65	2198.46	3238883.27	1254785.31	40.0296189	-104.6469296	0.54	
5736.00	28.920	95.050	5185.17	547.78	-204.22	2241.86	3238926.70	1254782.15	40.0296091	-104.6467746	0.38	
5826.00	28.930	94.820	5263.94	558.57	-207.97	2285.23	3238970.10	1254778.82	40.0295988	-104.6466197	0.12	
5915.00	28.720	96.050	5341.92	568.84	-212.03	2327.94	3239012.85	1254775.17	40.0295877	-104.6464672	0.71	
6005.00	28.680	96.830	5420.86	578.45	-216.88	2370.89	3239055.84	1254770.73	40.0295743	-104.6463138	0.42	
6095.00	28.840	96.030	5499.76	588.09	-221.73	2413.92	3239098.91	1254766.29	40.0295610	-104.6461602	0.46	
6185.00	28.790	95.290	5578.61	598.31	-226.00	2457.09	3239142.12	1254762.43	40.0295493	-104.6460060	0.40	
6274.00	28.790	95.700	5656.61	608.53	-230.11	2499.75	3239184.82	1254758.73	40.0295380	-104.6458537	0.22	
6364.00	28.760	96.560	5735.50	618.39	-234.73	2542.83	3239227.93	1254754.51	40.0295253	-104.6456999	0.46	
6455.00	28.620	96.710	5815.33	627.96	-239.78	2586.22	3239271.37	1254749.88	40.0295114	-104.6455449	0.17	
6544.00	28.450	96.820	5893.52	637.18	-244.79	2628.44	3239313.63	1254745.27	40.0294977	-104.6453942	0.20	
6633.00	28.870	96.020	5971.61	646.69	-249.56	2670.86	3239356.09	1254740.91	40.0294845	-104.6452427	0.64	
6723.00	28.760	96.330	6050.47	656.53	-254.23	2713.98	3239399.26	1254736.65	40.0294717	-104.6450887	0.21	
6813.00	29.040	96.030	6129.26	666.40	-258.91	2757.23	3239442.54	1254732.38	40.0294589	-104.6449343	0.35	
6903.00	28.850	96.140	6208.02	676.35	-263.53	2800.54	3239485.90	1254728.18	40.0294462	-104.6447796	0.22	
6993.00	28.960	96.290	6286.81	686.19	-268.23	2843.78	3239529.18	1254723.88	40.0294332	-104.6446252	0.15	
7083.00	28.930	96.680	6365.56	695.84	-273.15	2887.06	3239572.50	1254719.38	40.0294197	-104.6444707	0.21	
7172.00	28.900	95.910	6443.47	705.51	-277.87	2929.83	3239615.32	1254715.07	40.0294067	-104.6443179	0.42	
7261.00	28.700	96.380	6521.46	715.26	-282.46	2972.46	3239657.99	1254710.88	40.0293941	-104.6441657	0.34	
7351.00	29.080	95.520	6600.26	725.30	-286.97	3015.71	3239701.27	1254706.79	40.0293818	-104.6440113	0.63	
7440.00	28.590	96.100	6678.23	735.30	-291.31	3058.41	3239744.01	1254702.86	40.0293698	-104.6438588	0.63	
7530.00	28.160	96.750	6757.41	744.83	-296.09	3100.92	3239786.56	1254698.48	40.0293567	-104.6437070	0.59	
7620.00	28.940	82.110	6836.57	759.40	-295.60	3143.63	3239829.26	1254699.38	40.0293580	-104.6435545	7.81	
7709.00	31.460	65.570	6913.61	785.34	-283.02	3186.18	3239871.70	1254712.37	40.0293925	-104.6434025	9.74	
7799.00	34.430	52.380	6989.23	822.94	-257.73	3227.78	3239913.05	1254738.04	40.0294619	-104.6432540	8.61	
7889.00	41.030	41.070	7060.46	871.80	-219.84	3267.44	3239952.34	1254776.31	40.0295659	-104.6431124	10.60	



Actual Wellpath Report

CANAL 22-1-3L AWP

Page 5 of 11



REFERENCE WELLPATH IDENTIFICATION

Operator	CONFLUENCE RESOURCES	Well	CANAL 22-1-3L
Field	WELD COUNTY (NAD83, TRUE NORTH)	API	0512351590
Facility	SEC.22-T01N-R65W	Wellbore	CANAL 22-1-3L AWB
Slot	SLOT#14 CANAL 22-1-3L (185'FSL & 1346'FWL,SEC.22)		

WELLPATH DATA (208 stations) † = interpolated, ‡ = extrapolated station

MD [ft]	Inclination [°]	Azimuth [°]	TVD [ft]	Vert Sect [ft]	North [ft]	East [ft]	Grid East [US ft]	Grid North [US ft]	Latitude	Longitude	DLS [°/100ft]	Comments
7978.00	47.280	28.710	7124.40	931.35	-169.00	3302.43	3239986.85	1254827.48	40.0297055	-104.6429874	11.93	
8068.00	54.420	22.570	7181.22	1000.63	-106.09	3332.42	3240016.23	1254890.67	40.0298782	-104.6428803	9.53	
8157.00	60.850	19.290	7228.85	1075.72	-35.90	3359.18	3240042.32	1254961.11	40.0300708	-104.6427847	7.87	
8247.00	70.840	15.010	7265.64	1157.65	42.48	3383.24	3240065.63	1255039.71	40.0302860	-104.6426987	11.91	
8337.00	79.820	8.500	7288.44	1243.81	127.60	3400.85	3240082.43	1255124.99	40.0305196	-104.6426358	12.18	
8426.00	83.950	3.690	7301.00	1329.55	215.17	3410.18	3240090.93	1255212.64	40.0307600	-104.6426024	7.08	
8478.00†	87.476	0.065	7304.89	1379.01	266.98	3411.88	3240092.13	1255264.46	40.0309022	-104.6425963	9.71	CROSS SETBACK HEEL (460'FSL & 516'FEL,SEC.22)
8516.00	90.060	357.430	7305.71	1414.58	304.95	3411.05	3240090.93	1255302.43	40.0310065	-104.6425993	9.71	
8605.00	89.780	357.930	7305.83	1497.32	393.88	3407.44	3240086.48	1255391.31	40.0312506	-104.6426121	0.64	
8695.00	89.940	359.420	7306.05	1581.56	483.85	3405.36	3240083.55	1255481.26	40.0314976	-104.6426195	1.67	
8785.00	88.710	359.660	7307.11	1666.26	573.84	3404.64	3240081.97	1255571.23	40.0317446	-104.6426220	1.39	
8875.00	89.350	1.430	7308.64	1751.47	663.82	3405.50	3240081.96	1255661.21	40.0319916	-104.6426189	2.09	
8965.00	88.980	0.790	7309.95	1836.97	753.79	3407.24	3240082.85	1255751.20	40.0322386	-104.6426127	0.82	
9055.00	89.970	0.790	7310.77	1922.31	843.78	3408.48	3240083.23	1255841.19	40.0324856	-104.6426082	1.10	
9144.00	89.940	1.070	7310.84	2006.78	932.77	3409.92	3240083.83	1255930.18	40.0327299	-104.6426030	0.32	
9234.00	90.000	0.480	7310.89	2092.12	1022.76	3411.14	3240084.19	1256020.18	40.0329769	-104.6425986	0.66	
9324.00	90.370	0.240	7310.60	2177.26	1112.76	3411.71	3240083.90	1256110.17	40.0332240	-104.6425965	0.49	
9413.00	90.310	0.570	7310.07	2261.47	1201.75	3412.34	3240083.68	1256199.17	40.0334683	-104.6425942	0.38	
9502.00	90.250	0.300	7309.64	2345.69	1290.75	3413.01	3240083.51	1256288.16	40.0337126	-104.6425918	0.31	
9592.00	90.620	0.550	7308.95	2430.85	1380.74	3413.68	3240083.31	1256378.16	40.0339596	-104.6425894	0.50	
9681.00	90.680	0.890	7307.94	2515.21	1469.73	3414.80	3240083.58	1256467.15	40.0342039	-104.6425853	0.39	
9771.00	90.830	1.130	7306.76	2600.67	1559.71	3416.38	3240084.31	1256557.13	40.0344509	-104.6425796	0.31	
9861.00	89.850	0.180	7306.22	2685.95	1649.70	3417.41	3240084.48	1256647.12	40.0346979	-104.6425759	1.52	
9950.00	90.150	0.590	7306.22	2770.14	1738.70	3418.01	3240084.23	1256736.12	40.0349422	-104.6425737	0.57	
10040.00	89.690	0.750	7306.35	2855.43	1828.69	3419.06	3240084.43	1256826.12	40.0351892	-104.6425699	0.54	
10129.00	90.550	0.880	7306.16	2939.85	1917.68	3420.33	3240084.85	1256915.11	40.0354335	-104.6425653	0.98	
10219.00	89.690	0.520	7305.97	3025.15	2007.67	3421.43	3240085.09	1257005.11	40.0356806	-104.6425614	1.04	
10308.00	90.400	1.280	7305.90	3109.61	2096.66	3422.83	3240085.64	1257094.10	40.0359248	-104.6425563	1.17	
10398.00	90.310	1.110	7305.35	3195.15	2186.64	3424.70	3240086.66	1257184.09	40.0361718	-104.6425496	0.21	
10487.00	90.830	1.310	7304.46	3279.76	2275.61	3426.58	3240087.69	1257273.08	40.0364161	-104.6425428	0.63	



Actual Wellpath Report

CANAL 22-1-3L AWP
Page 6 of 11



REFERENCE WELLPATH IDENTIFICATION

Operator	CONFLUENCE RESOURCES	Well	CANAL 22-1-3L
Field	WELD COUNTY (NAD83, TRUE NORTH)	API	0512351590
Facility	SEC.22-T01N-R65W	Wellbore	CANAL 22-1-3L AWB
Slot	SLOT#14 CANAL 22-1-3L (185'FSL & 1346'FWL,SEC.22)		

WELLPATH DATA (208 stations)

MD [ft]	Inclination [°]	Azimuth [°]	TVD [ft]	Vert Sect [ft]	North [ft]	East [ft]	Grid East [US ft]	Grid North [US ft]	Latitude	Longitude	DLS [°/100ft]	Comments
10577.00	90.180	0.890	7303.67	3365.25	2365.59	3428.31	3240088.56	1257363.06	40.0366631	-104.6425366	0.86	
10667.00	89.630	0.350	7303.82	3450.52	2455.59	3429.28	3240088.67	1257453.06	40.0369101	-104.6425331	0.86	
10757.00	89.420	359.790	7304.56	3535.50	2545.58	3429.39	3240087.93	1257543.05	40.0371572	-104.6425327	0.66	
10846.00	90.180	359.680	7304.87	3619.37	2634.58	3428.98	3240086.67	1257632.04	40.0374015	-104.6425341	0.86	
10936.00	89.910	359.760	7304.80	3704.17	2724.58	3428.54	3240085.37	1257722.02	40.0376485	-104.6425356	0.31	
11025.00	90.580	359.890	7304.42	3788.08	2813.58	3428.27	3240084.25	1257811.01	40.0378928	-104.6425365	0.77	
11115.00	90.370	0.600	7303.68	3873.15	2903.57	3428.66	3240083.78	1257901.00	40.0381399	-104.6425351	0.82	
11206.00	90.250	359.710	7303.18	3959.12	2994.57	3428.90	3240083.15	1257991.99	40.0383897	-104.6425342	0.99	
11295.00	90.150	359.580	7302.87	4042.94	3083.57	3428.35	3240081.75	1258080.98	40.0386340	-104.6425361	0.18	
11384.00	90.650	0.180	7302.25	4126.88	3172.57	3428.16	3240080.72	1258169.97	40.0388783	-104.6425368	0.88	
11474.00	90.280	0.040	7301.52	4211.88	3262.56	3428.34	3240080.04	1258259.96	40.0391253	-104.6425361	0.44	
11563.00	90.060	0.090	7301.26	4295.92	3351.56	3428.44	3240079.29	1258348.95	40.0393696	-104.6425357	0.25	
11652.00	89.910	359.390	7301.28	4379.79	3440.56	3428.03	3240078.04	1258437.94	40.0396139	-104.6425371	0.80	
11742.00	90.250	359.910	7301.15	4464.56	3530.56	3427.48	3240076.63	1258527.92	40.0398610	-104.6425390	0.69	
11832.00	90.090	359.830	7300.89	4549.44	3620.56	3427.28	3240075.57	1258617.91	40.0401080	-104.6425397	0.20	
11922.00	88.800	358.790	7301.76	4634.01	3710.54	3426.20	3240073.62	1258707.88	40.0403551	-104.6425435	1.84	
12011.00	90.000	359.760	7302.69	4717.63	3799.53	3425.07	3240071.65	1258796.85	40.0405993	-104.6425475	1.73	
12100.00	89.630	0.130	7302.98	4801.61	3888.53	3424.99	3240070.72	1258885.84	40.0408436	-104.6425478	0.59	
12190.00	90.000	0.830	7303.27	4886.80	3978.52	3425.74	3240070.61	1258975.84	40.0410907	-104.6425450	0.88	
12280.00	89.970	0.540	7303.29	4972.10	4068.52	3426.82	3240070.83	1259065.83	40.0413377	-104.6425411	0.32	
12369.00	89.750	0.850	7303.51	5056.45	4157.51	3427.89	3240071.06	1259154.83	40.0415820	-104.6425372	0.43	
12459.00	89.820	0.430	7303.85	5141.73	4247.50	3428.90	3240071.21	1259244.82	40.0418291	-104.6425336	0.47	
12549.00	90.220	0.910	7303.82	5227.02	4337.50	3429.95	3240071.40	1259334.82	40.0420761	-104.6425298	0.69	
12638.00	90.150	0.220	7303.53	5311.30	4426.49	3430.83	3240071.43	1259423.81	40.0423204	-104.6425266	0.78	
12727.00	89.910	0.290	7303.48	5395.44	4515.49	3431.23	3240070.98	1259512.81	40.0425647	-104.6425252	0.28	
12816.00	90.860	0.330	7302.88	5479.60	4604.49	3431.71	3240070.62	1259601.80	40.0428090	-104.6425234	1.07	
12906.00	89.690	0.280	7302.45	5564.70	4694.48	3432.19	3240070.24	1259691.80	40.0430560	-104.6425216	1.30	
12995.00	90.220	0.510	7302.52	5648.91	4783.48	3432.80	3240070.00	1259780.79	40.0433004	-104.6425194	0.65	
13085.00	90.000	0.660	7302.35	5734.15	4873.48	3433.72	3240070.06	1259870.79	40.0435474	-104.6425161	0.30	
13174.00	90.400	0.340	7302.04	5818.41	4962.47	3434.50	3240069.99	1259959.78	40.0437917	-104.6425133	0.58	



Actual Wellpath Report

CANAL 22-1-3L AWP
Page 7 of 11



REFERENCE WELLPATH IDENTIFICATION

Operator	CONFLUENCE RESOURCES	Well	CANAL 22-1-3L
Field	WELD COUNTY (NAD83, TRUE NORTH)	API	0512351590
Facility	SEC.22-T01N-R65W	Wellbore	CANAL 22-1-3L AWB
Slot	SLOT#14 CANAL 22-1-3L (185'FSL & 1346'FWL,SEC.22)		

WELLPATH DATA (208 stations)

MD [ft]	Inclination [°]	Azimuth [°]	TVD [ft]	Vert Sect [ft]	North [ft]	East [ft]	Grid East [US ft]	Grid North [US ft]	Latitude	Longitude	DLS [°/100ft]	Comments
13264.00	90.770	0.460	7301.12	5903.56	5052.46	3435.12	3240069.76	1260049.78	40.0440387	-104.6425110	0.43	
13354.00	90.580	0.460	7300.06	5988.74	5142.46	3435.85	3240069.63	1260139.77	40.0442858	-104.6425083	0.21	
13443.00	90.430	0.210	7299.28	6072.91	5231.45	3436.37	3240069.30	1260228.76	40.0445301	-104.6425064	0.33	
13532.00	90.650	0.490	7298.44	6157.09	5320.44	3436.91	3240068.99	1260317.75	40.0447744	-104.6425045	0.40	
13621.00	90.860	0.430	7297.26	6241.32	5409.43	3437.63	3240068.86	1260406.74	40.0450186	-104.6425019	0.25	
13710.00	90.580	0.720	7296.15	6325.60	5498.42	3438.52	3240068.90	1260495.73	40.0452629	-104.6424986	0.45	
13800.00	90.620	0.580	7295.20	6410.88	5588.41	3439.54	3240069.07	1260585.72	40.0455099	-104.6424949	0.16	
13890.00	90.460	0.100	7294.35	6496.00	5678.41	3440.07	3240068.74	1260675.71	40.0457570	-104.6424930	0.56	
13979.00	90.000	359.610	7294.00	6579.93	5767.40	3439.85	3240067.67	1260764.70	40.0460013	-104.6424937	0.76	
14068.00	90.890	0.460	7293.31	6663.95	5856.40	3439.90	3240066.88	1260853.69	40.0462456	-104.6424935	1.38	
14158.00	91.720	1.190	7291.26	6749.29	5946.37	3441.20	3240067.31	1260943.66	40.0464926	-104.6424888	1.23	
14248.00	90.800	0.430	7289.28	6834.63	6036.33	3442.47	3240067.73	1261033.63	40.0467395	-104.6424842	1.33	
14337.00	90.060	0.570	7288.61	6918.88	6125.33	3443.25	3240067.66	1261122.63	40.0469838	-104.6424814	0.85	
14427.00	90.000	0.070	7288.56	7003.99	6215.32	3443.75	3240067.30	1261212.62	40.0472309	-104.6424796	0.56	
14516.00	89.880	359.960	7288.66	7088.01	6304.32	3443.77	3240066.48	1261301.61	40.0474752	-104.6424795	0.18	
14605.00	90.150	0.530	7288.63	7172.13	6393.32	3444.15	3240066.01	1261390.61	40.0477195	-104.6424781	0.71	
14694.00	90.090	0.820	7288.45	7256.48	6482.32	3445.20	3240066.21	1261479.61	40.0479638	-104.6424743	0.33	
14784.00	90.060	0.440	7288.33	7341.75	6572.31	3446.19	3240066.34	1261569.60	40.0482108	-104.6424707	0.42	
14874.00	90.000	359.640	7288.28	7426.72	6662.31	3446.25	3240065.55	1261659.59	40.0484579	-104.6424704	0.89	
14963.00	90.030	359.480	7288.26	7510.49	6751.31	3445.57	3240064.01	1261748.58	40.0487022	-104.6424728	0.18	
15053.00	90.250	1.230	7288.04	7595.62	6841.30	3446.13	3240063.71	1261838.57	40.0489492	-104.6424708	1.96	
15143.00	90.090	1.670	7287.77	7681.29	6931.27	3448.41	3240065.13	1261928.55	40.0491962	-104.6424626	0.52	
15232.00	90.490	1.090	7287.32	7765.98	7020.25	3450.55	3240066.43	1262017.54	40.0494404	-104.6424549	0.79	
15322.00	90.490	1.320	7286.55	7851.53	7110.22	3452.44	3240067.46	1262107.53	40.0496874	-104.6424481	0.26	
15411.00	90.460	1.420	7285.81	7936.21	7199.19	3454.57	3240068.74	1262196.51	40.0499316	-104.6424404	0.12	
15500.00	90.920	1.520	7284.74	8020.94	7288.16	3456.85	3240070.18	1262285.49	40.0501759	-104.6424323	0.53	
15590.00	89.880	1.420	7284.11	8106.61	7378.12	3459.16	3240071.63	1262375.47	40.0504228	-104.6424240	1.16	
15680.00	90.090	1.640	7284.14	8192.33	7468.09	3461.56	3240073.18	1262465.45	40.0506698	-104.6424153	0.34	
15770.00	89.260	359.970	7284.65	8277.68	7558.08	3462.83	3240073.58	1262555.44	40.0509168	-104.6424108	2.07	
15859.00	89.720	0.690	7285.44	8361.85	7647.07	3463.34	3240073.25	1262644.44	40.0511611	-104.6424089	0.96	



Actual Wellpath Report

CANAL 22-1-3L AWP
Page 8 of 11



REFERENCE WELLPATH IDENTIFICATION

Operator	CONFLUENCE RESOURCES	Well	CANAL 22-1-3L
Field	WELD COUNTY (NAD83, TRUE NORTH)	API	0512351590
Facility	SEC.22-T01N-R65W	Wellbore	CANAL 22-1-3L AWB
Slot	SLOT#14 CANAL 22-1-3L (185'FSL & 1346'FWL,SEC.22)		

WELLPATH DATA (208 stations) † = interpolated, ‡ = extrapolated station

MD [ft]	Inclination [°]	Azimuth [°]	TVD [ft]	Vert Sect [ft]	North [ft]	East [ft]	Grid East [US ft]	Grid North [US ft]	Latitude	Longitude	DLS [°/100ft]	Comments
15949.00	90.220	0.270	7285.49	8447.04	7737.07	3464.09	3240073.14	1262734.43	40.0514081	-104.6424062	0.73	
16039.00	90.090	359.990	7285.24	8532.06	7827.07	3464.30	3240072.49	1262824.43	40.0516552	-104.6424054	0.34	
16128.00	90.150	0.200	7285.06	8616.11	7916.07	3464.45	3240071.79	1262913.42	40.0518995	-104.6424048	0.25	
16218.00	89.850	359.750	7285.06	8701.04	8006.07	3464.41	3240070.89	1263003.41	40.0521466	-104.6424049	0.60	
16308.00	89.660	359.570	7285.44	8785.81	8096.06	3463.87	3240069.50	1263093.40	40.0523936	-104.6424068	0.29	
16397.00	89.570	359.340	7286.04	8869.53	8185.06	3463.03	3240067.80	1263182.38	40.0526379	-104.6424097	0.28	
16487.00	90.220	0.230	7286.20	8954.37	8275.06	3462.69	3240066.61	1263272.36	40.0528850	-104.6424109	1.22	
16576.00	89.940	0.660	7286.08	9038.60	8364.05	3463.38	3240066.45	1263361.36	40.0531293	-104.6424084	0.58	
16666.00	90.060	0.450	7286.08	9123.83	8454.05	3464.25	3240066.47	1263451.35	40.0533763	-104.6424052	0.27	
16755.00	90.650	0.270	7285.53	9208.01	8543.05	3464.81	3240066.18	1263540.35	40.0536206	-104.6424032	0.69	
16844.00	90.580	0.470	7284.57	9292.20	8632.04	3465.39	3240065.90	1263629.34	40.0538649	-104.6424011	0.24	
16934.00	91.080	0.500	7283.27	9377.39	8722.03	3466.15	3240065.81	1263719.33	40.0541119	-104.6423983	0.56	
17024.00	91.020	0.320	7281.62	9462.53	8812.01	3466.79	3240065.59	1263809.31	40.0543589	-104.6423960	0.21	
17112.00	91.020	0.550	7280.05	9545.80	8899.99	3467.46	3240065.42	1263897.29	40.0546004	-104.6423936	0.26	
17201.00	91.140	0.620	7278.38	9630.08	8988.97	3468.37	3240065.48	1263986.27	40.0548447	-104.6423903	0.16	
17291.00	90.280	0.750	7277.26	9715.37	9078.96	3469.44	3240065.70	1264076.26	40.0550917	-104.6423864	0.97	
17380.00	89.940	0.460	7277.09	9799.68	9167.95	3470.38	3240065.79	1264165.26	40.0553360	-104.6423830	0.50	
17470.00	89.940	0.390	7277.18	9884.85	9257.95	3471.05	3240065.60	1264255.25	40.0555831	-104.6423805	0.08	
17559.00	90.060	0.530	7277.18	9969.09	9346.95	3471.77	3240065.47	1264344.25	40.0558274	-104.6423780	0.21	
17649.00	90.030	0.520	7277.11	10054.30	9436.94	3472.59	3240065.44	1264434.25	40.0560744	-104.6423750	0.04	
17738.00	91.050	0.240	7276.27	10138.50	9525.93	3473.18	3240065.18	1264523.24	40.0563187	-104.6423728	1.19	
17828.00	90.800	0.650	7274.82	10223.66	9615.92	3473.88	3240065.02	1264613.22	40.0565657	-104.6423703	0.53	
17917.00	89.880	0.420	7274.29	10307.93	9704.91	3474.71	3240065.00	1264702.22	40.0568100	-104.6423673	1.07	
18007.00	90.180	0.570	7274.25	10393.14	9794.91	3475.49	3240064.92	1264792.21	40.0570571	-104.6423644	0.37	
18097.00	90.550	0.760	7273.67	10478.42	9884.90	3476.53	3240065.11	1264882.21	40.0573041	-104.6423607	0.46	
18156.00†	90.258	0.726	7273.26	10534.36	9943.90	3477.30	3240065.31	1264941.20	40.0574660	-104.6423579	0.50	CROSS SETBACK TOE (460'FNL & 520'FEL,SEC.15)
18184.00	90.120	0.710	7273.16	10560.90	9971.89	3477.65	3240065.39	1264969.20	40.0575429	-104.6423566	0.50	LAST BH MWD SURVEY
18208.00‡	90.120	0.710	7273.11	10583.65	9995.89	3477.95	3240065.46	1264993.20	40.0576088	-104.6423555	0.00	PROJECTION TO BIT



Actual Wellpath Report

CANAL 22-1-3L AWP

Page 9 of 11



REFERENCE WELLPATH IDENTIFICATION

Operator	CONFLUENCE RESOURCES	Well	CANAL 22-1-3L
Field	WELD COUNTY (NAD83, TRUE NORTH)	API	0512351590
Facility	SEC.22-T01N-R65W	Wellbore	CANAL 22-1-3L AWB
Slot	SLOT#14 CANAL 22-1-3L (185'FSL & 1346'FWL,SEC.22)		

HOLE & CASING SECTIONS - Ref Wellbore: CANAL 22-1-3L AWB Ref Wellpath: CANAL 22-1-3L AWP

String/Diameter	Start MD [ft]	End MD [ft]	Interval [ft]	Start TVD [ft]	End TVD [ft]	Start N/S [ft]	Start E/W [ft]	End N/S [ft]	End E/W [ft]
9.625in Casing Surface	23.00	2701.00	2678.00	23.00	2532.83	0.00	0.00	-73.77	773.87

TARGETS

Name	TVD [ft]	North [ft]	East [ft]	Grid East [US ft]	Grid North [US ft]	Latitude	Longitude	Shape
SEC.15/22-T01N-R65W (SB 460')	6.50	0.00	-299.64	3236383.46	1254962.14	40.0301700	-104.6558500	polygon
	2D Polygon: dimensions not calculated							
SEC.15-T01N-R65W	10.00	0.00	-299.64	3236383.46	1254962.14	40.0301700	-104.6558500	polygon
	2D Polygon: dimensions not calculated							
SEC.22-T01N-R65W	10.00	0.00	-299.64	3236383.46	1254962.14	40.0301700	-104.6558500	polygon
	2D Polygon: dimensions not calculated							
CANAL 22-1-3L BHL REV-1(470'FNL & 520'FEL,SEC.15)	7305.00	9934.41	3476.71	3240064.81	1264931.71	40.0574400	-104.6423600	point
CANAL 22-1-3L LP REV-1(470'FSL & 520'FEL,SEC.22)	7305.00	277.09	3408.05	3240088.21	1255274.54	40.0309300	-104.6426100	point



Actual Wellpath Report

CANAL 22-1-3L AWP

Page 10 of 11



REFERENCE WELLPATH IDENTIFICATION

Operator	CONFLUENCE RESOURCES	Well	CANAL 22-1-3L
Field	WELD COUNTY (NAD83, TRUE NORTH)	API	0512351590
Facility	SEC.22-T01N-R65W	Wellbore	CANAL 22-1-3L AWB
Slot	SLOT#14 CANAL 22-1-3L (185'FSL & 1346'FWL,SEC.22)		

WELLPATH COMPOSITION - Ref Wellbore: CANAL 22-1-3L AWB Ref Wellpath: CANAL 22-1-3L AWP

Start MD [ft]	End MD [ft]	Positional Uncertainty Model	Log Name/Comment	Wellbore	Survey Date
23.00	2657.00	BH NaviTrak (2019) (Axial)	BH NaviTrak (2019) (Axial) 13-1/2" <132 - 2657>	CANAL 22-1-3L AWB	8/24/2021
2657.00	18208.00	BH AutoTrak Curve/eXpress (2019) (Short spacing)	BH AutoTrak Curve (2019) (Short spacing) 8-1/2" <2784 - 18184>	CANAL 22-1-3L AWB	9/7/2021



Actual Wellpath Report

CANAL 22-1-3L AWP

Page 11 of 11



REFERENCE WELLPATH IDENTIFICATION

Operator	CONFLUENCE RESOURCES	Well	CANAL 22-1-3L
Field	WELD COUNTY (NAD83, TRUE NORTH)	API	0512351590
Facility	SEC.22-T01N-R65W	Wellbore	CANAL 22-1-3L AWB
Slot	SLOT#14 CANAL 22-1-3L (185'FSL & 1346'FWL,SEC.22)		

WELLPATH COMMENTS

MD [ft]	Inclination [°]	Azimuth [°]	TVD [ft]	Comment
132.00	0.490	186.990	132.00	FIRST BH SURFACE MWD SURVEY
2657.00	27.750	93.090	2493.74	LAST BH SURFACE MWD SURVEY
2784.00	25.560	103.990	2607.31	FIRST BH MWD SURVEY
8478.00	87.476	0.065	7304.89	CROSS SETBACK HEEL (460'FSL & 516'FEL,SEC.22)
18156.00	90.258	0.726	7273.26	CROSS SETBACK TOE (460'FNL & 520'FEL,SEC.15)
18184.00	90.120	0.710	7273.16	LAST BH MWD SURVEY
18208.00	90.120	0.710	7273.11	PROJECTION TO BIT