



00278769

RECEIVED

APR 16 1969

COLO. OIL & GAS CONS. COMM.

R. 54W

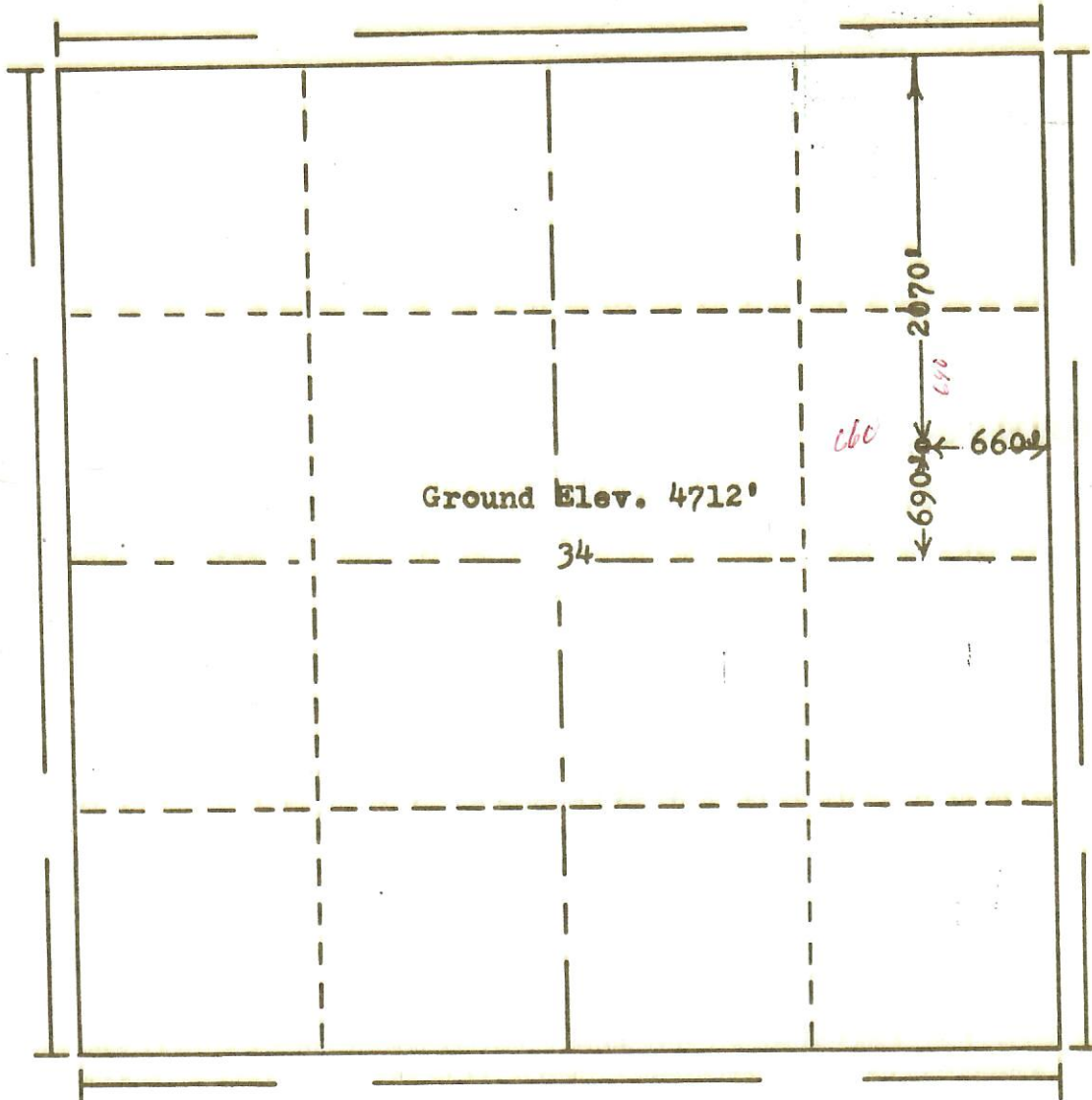

Scale... 1" = 1000'

Powers Elevation Company, Inc. of Denver, Colorado
 has in accordance with a request from Donna Bendixen
 for B.W. Drlg. Co., Inc.
 determined the location of No.1 Weeth
 to be CSE NE Section 34 Township 12N
 Range 54W of the 6th Principal Meridian
 Logan County, Colorado

I hereby certify that this plat is an
 accurate representation of a correct
 survey showing the location of

Date: 4-11-69

B. G. Hall
 Licensed Land Surveyor No. 2853
 State of Colorado