



FORM F-108

State of CO



RECEIVED

AUG 30 1971

COLO. OIL & GAS CONS. COMM.

R. 61 W

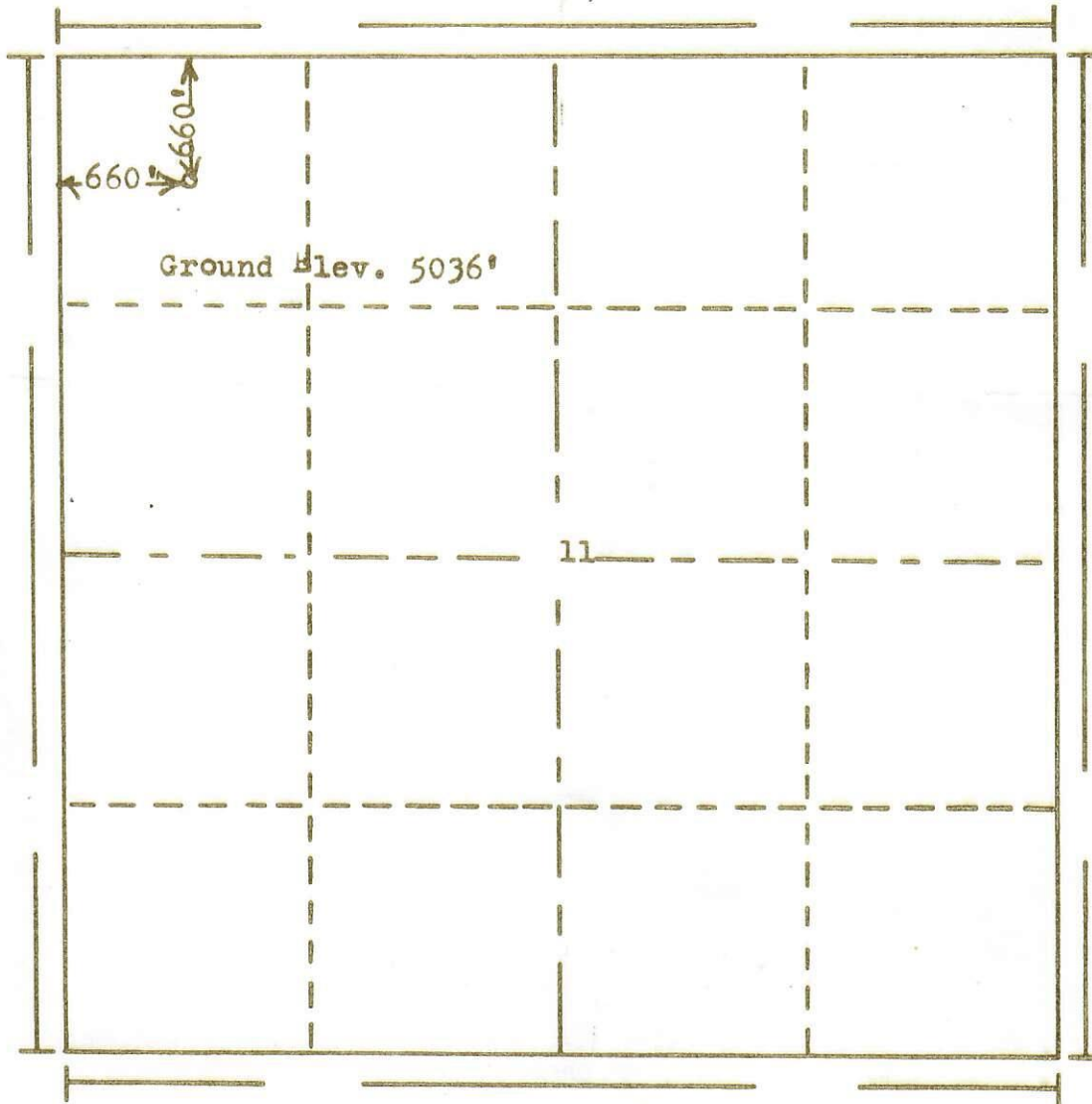

T.
3
S

Scale... 1" = 1000'

Powers Elevation Company, Inc. of Denver, Colorado
has in accordance with a request from Mr. Adams
for Toltek Drlg. Co.
determined the location of No. ? *Van Matre*
to be CNW NW Section 11 Township 3S
Range 61W of the 6th Principal Meridian
Adams County, Colorado

71 666

I hereby certify that this plat is an
accurate representation of a correct
survey showing the location of

Date: 8-24-71

Eric J. Hollen

Licensed Land Surveyor No. 2853
State of Colorado