

**Location Name: LaGARITA 42-20 WD, API #: 071-07045, Insp. #:695106268**



**PHOTO 1: LOCATION**





**EVERGREEN**

---

**NATURAL RESOURCES LLC**

**LaGARITA 42-20 WD**

**API 05-071-07045**

**SE NE SECTION 20-33S-66W**

**CR 41.7**

**LAT. 37.16027/LONG. -104.79696**

**EMERGENCY No. 911 or 719-846-7898 (24 Hrs)**





PHOTO 3: WELLHEAD AND EQUIPMENT



WGS84  
±28ft

37.16015, -104.79721

ft  
±37ft

7151

°M  
±19

NE73

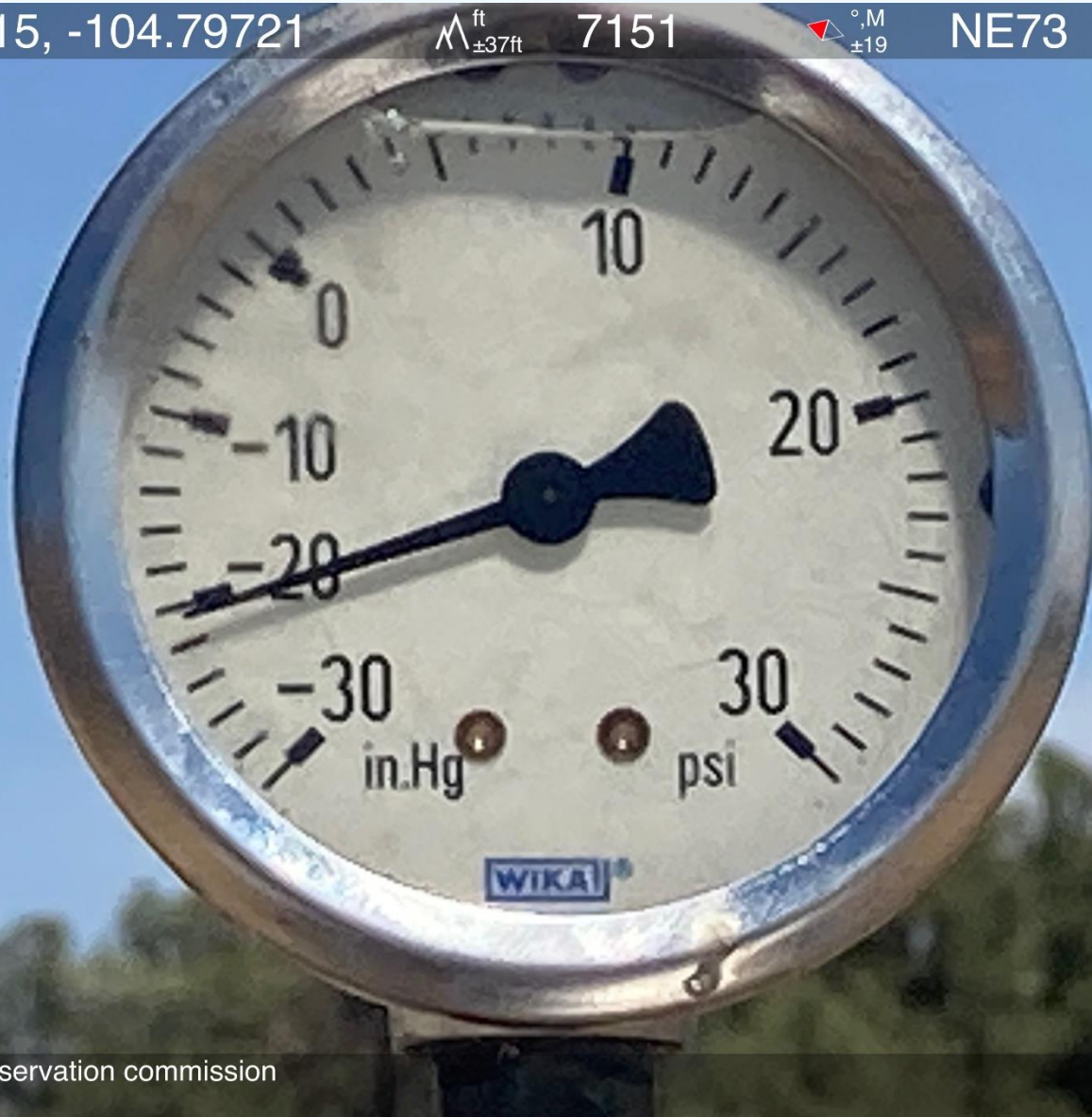

Colorado Oil & Gas Conservation commission  
© 10-May-22 13:32:47

WGS84  
±20ft

37.16016, -104.79723

ft  
±19ft

7151

°M  
±20

N2

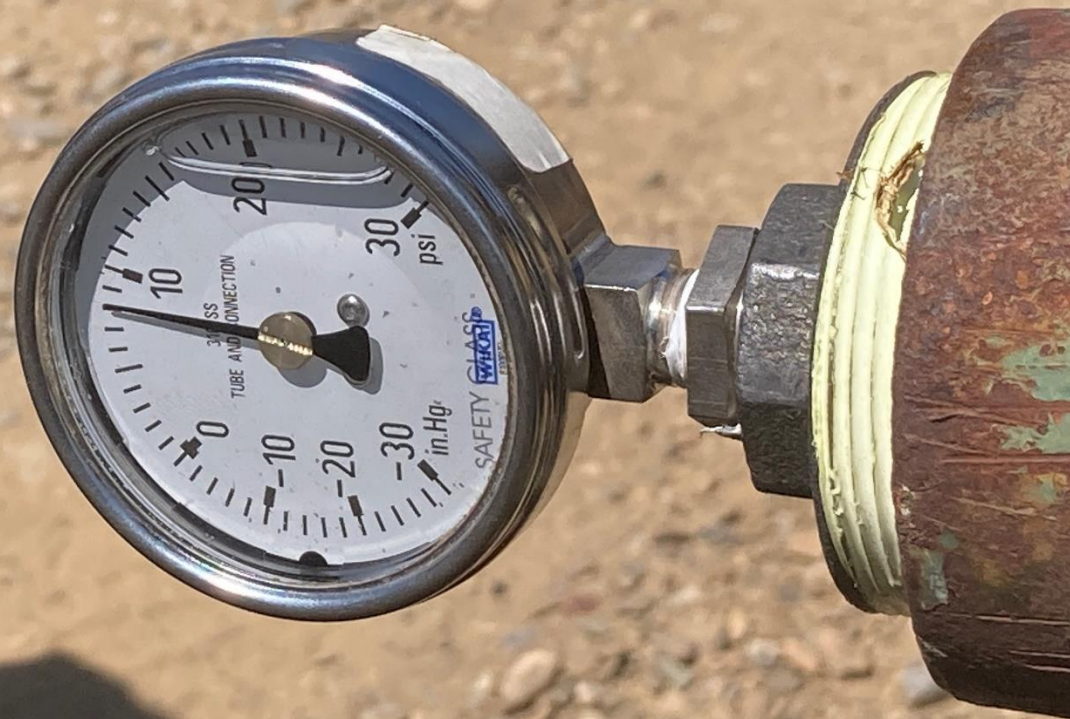

Colorado Oil & Gas Conservation commission  
© 10-May-22 13:34:14

**PHOTO 5: TBG/CSG ANNULUS PRESSURE 8 PSI.**



WGS84  
±27ft

37.16017, -104.79723

ft  
±42ft

7150

°M  
±20

N11



Colorado Oil & Gas Conservation commission  
© 10-May-22 13:34:32