

RIG LAYOUT

PROPOSED AREA OF DISTURBANCE: 7.2± ACRES
DRAINS TO WEST FORK PARACHUTE CREEK

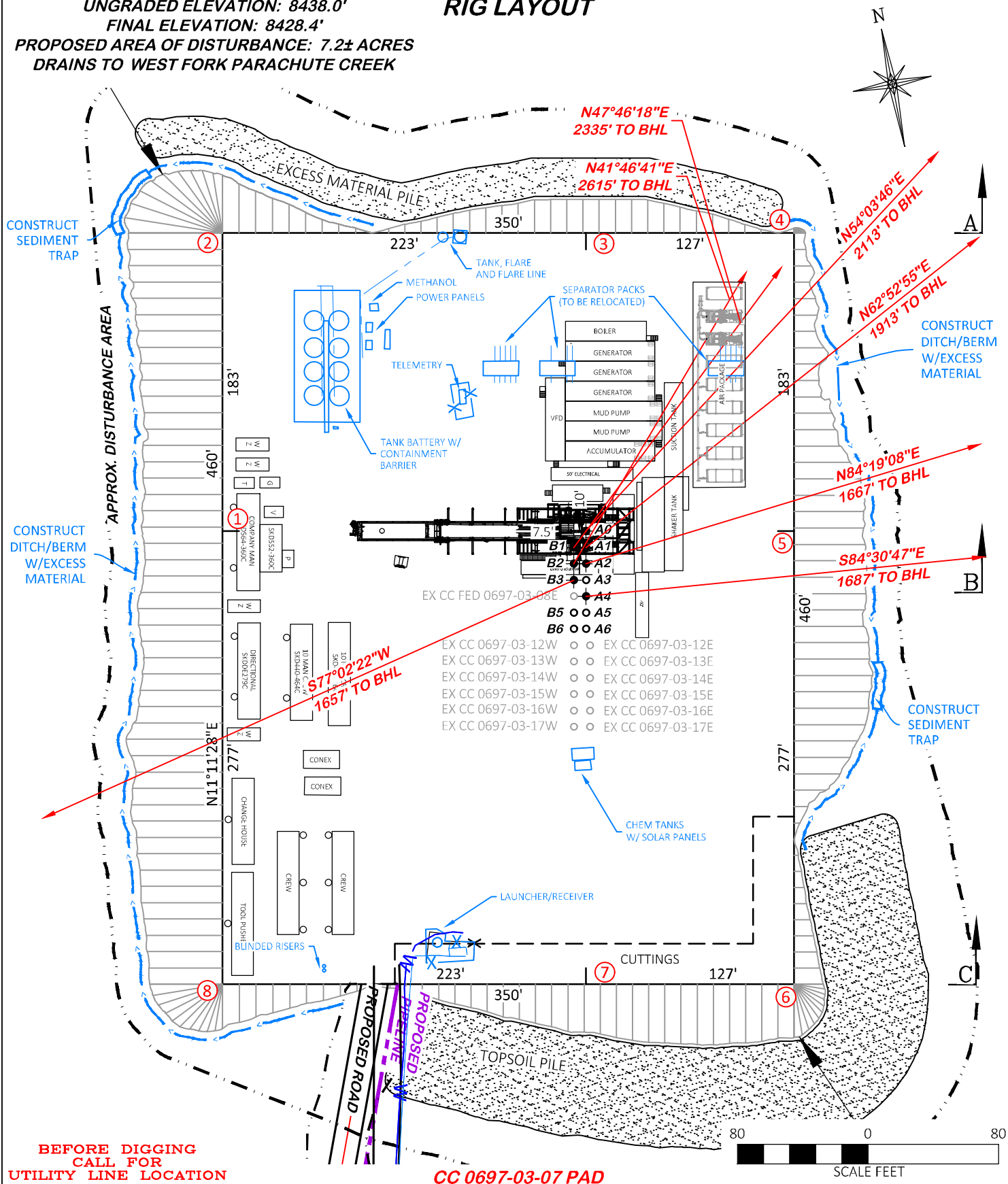

**BEFORE DIGGING
CALL FOR
UTILITY LINE LOCATION**

CC 0697-03-07 PAD

CONSTRUCTION LAYOUT DRAWING 2 OF 6

DRG

RIFFIN & ASSOCIATES, INC.

(307) 362-5028

1414 ELK ST., ROCK SPRINGS, WY 82901

DRAWN: 8/23/2017 - TCM

SCALE: 1" = 80'

REVISED: 3/23/2022 - DEH

DRG JOB No. 21295

RIG REVISIONS

02 RIG

***RIG LAYOUT
LARAMIE ENERGY, LLC.***

CC 0697-03-07

**LOT 11, SECTION 3, T.6 S., R.97 W., 6th P.M.,
GARFIELD COUNTY, COLORADO**

<i>RIG REVISIONS</i>	<i>02 RIG</i>
----------------------	---------------