

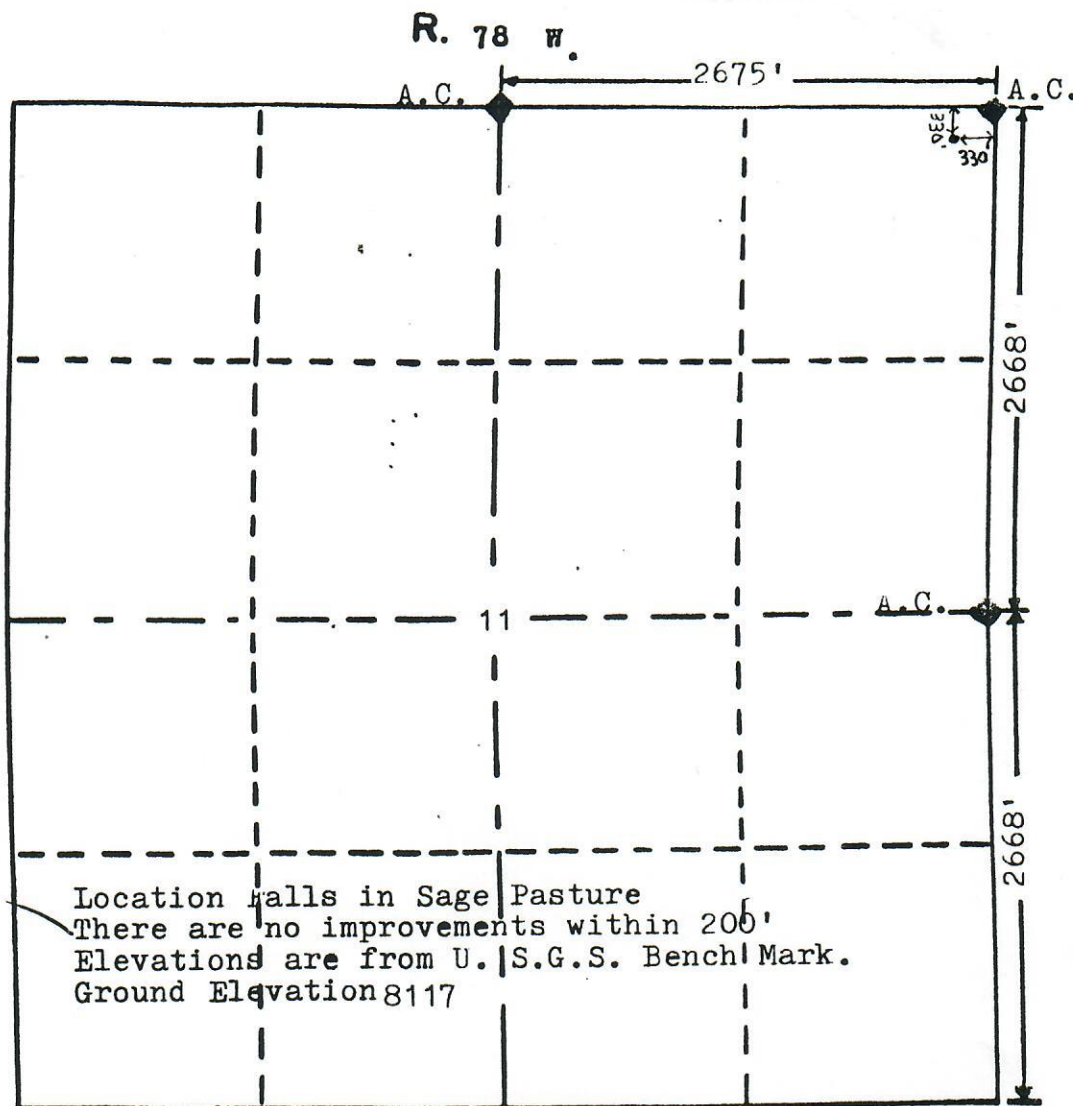

00272136



Scale... 1" = 1000'

We have determined the Location of #11-1 State to be
330' FNL & 330' FEL Section 11 Township 9N. Range 78W.
of the 6th Principal Meridian Jackson County, Colorado.

I hereby certify that this plat is an accurate
representation of a correct survey showing the
location of #11-1 State

Gil's Hot Oil Service

Date 8-7-95

By: B. West